

Bench Mark: Chiseled "□" on west end of southwest wingwall structure 093-0017, Elev. 398.80

Existing Structure: S.N. 093-0017 built 1922 as S.B.I. Route 1, Section 8-B, at Station 204+42.25.
Structure consists of one span steel through truss with reinforced concrete end spans on solid piers and closed abutments. 257'-6" back-to-back abutments. 20'-0" clear roadway width.
Existing structure to be removed and replaced. Road to be closed and traffic detoured during construction.

No salvage

STATE OF ILLINOIS
DEPARTMENT OF TRANSPORTATION

ROUTE NO.	SECTION	COUNTY	TOTAL SHEETS	SHEET NO.	SHEET NO. 1
S.B.I. 1	(8C)B-2	WABASH	36	12	21 SHEETS
FED. ROAD DIST. NO. 7	ILLINOIS	FED. AID PROJECT-			

Contract #94783

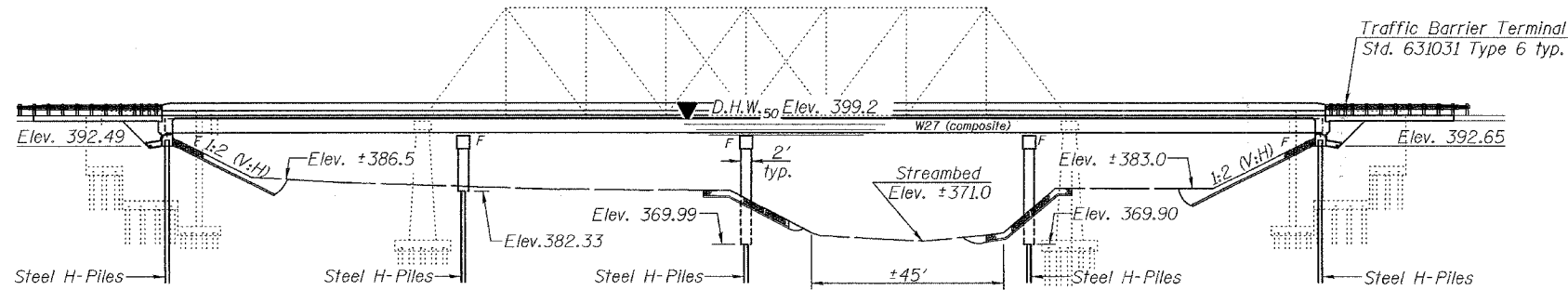

ELEVATION

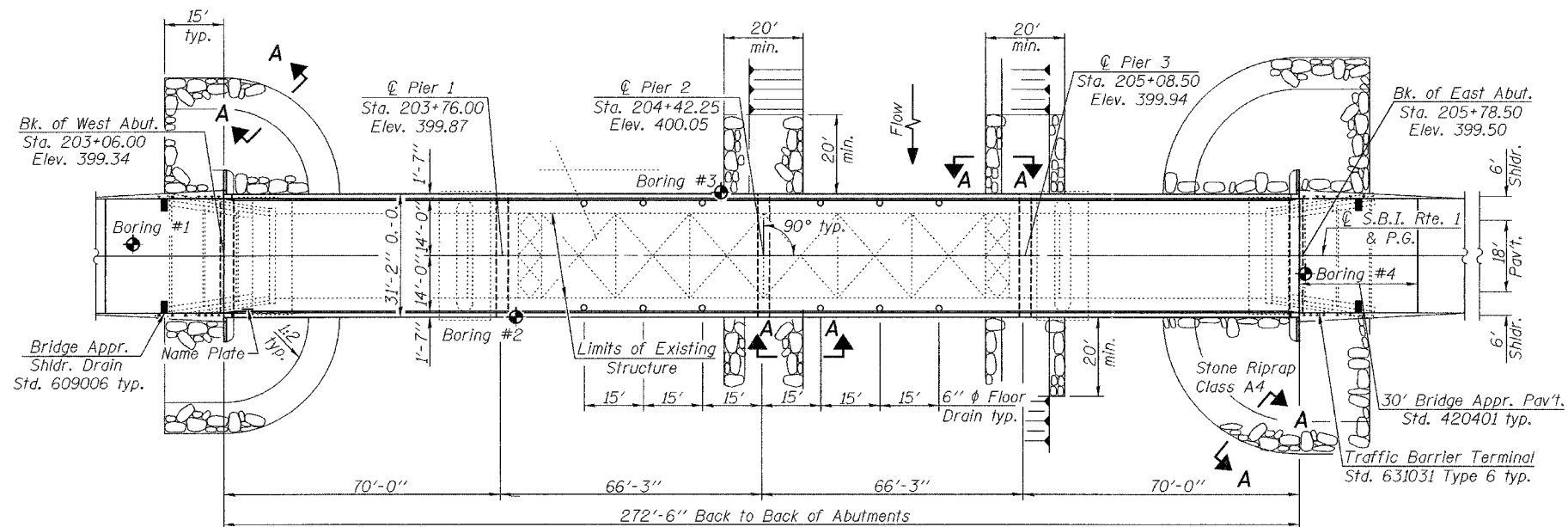

PLAN

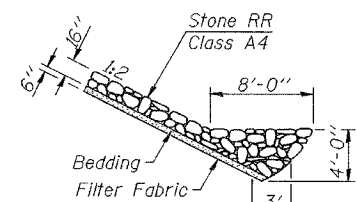

SECTION A-A

STATION 204+42.25
BUILT 200 BY
STATE OF ILLINOIS
S.B.I. RTE. 1 - SEC. (8C)B-2
LOADING HL93
STR. NO. 093-0022

NAME PLATE

See Std. 515001

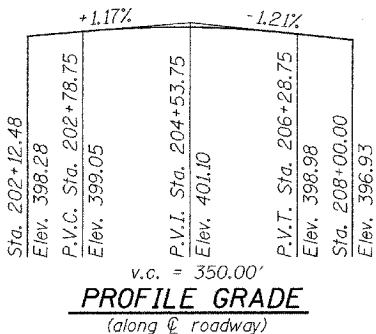

PROFILE GRADE
(along centerline roadway)

DESIGNED	Denny W. Coulter
CHECKED	Richard J. Chan
DRAWN	R. Sommer
CHECKED	DHC/CCC

September 18, 2004
EXAMINED
PASSED
ENGINEER OF BRIDGE DESIGN
ENGINEER OF BRIDGES AND STRUCTURES



Expires 11-30-2006

WATERWAY INFORMATION

Exist. Low Grade Elev. 394.7 @ Sta. 213+00/195+00
Prop. Low Grade Elev. 394.7 @ Sta. 213+00/195+00
Drainage Area = 237.6 mi²

Flood	Freq. Yr.	Q C.F.S.	Opening Sq. Ft.		Nat. H.W.E.		Head - Ft.		Headwater El.	
			Exist.	Prop.	Exist.	Prop.	Exist.	Prop.	Exist.	Prop.
10	5468	3540	3664	397.1	0.0	0.0	397.2	397.2		
Design	50	7579	3540	3664	399.2	0.1	0.1	399.3	399.3	
Base	100	8460	3540	3664	399.7	0.1	0.1	399.8	399.8	
Overtopping	6	4700	3200	3302	394.7	0.0	0.0	394.7	394.7	

10 Year Velocity through Existing Bridge = 1.5 fps 10 Year Velocity through Proposed Bridge = 1.5 fps

LOADING HL 93

Allow 50#/sq. ft. for future wearing surface.

DESIGN SPECIFICATIONS

1998 AASHTO LRFD with 1999 thru 2003 Interims

DESIGN STRESSES

FIELD UNITS

f_c = 3,500 psi
f_y = 60,000 psi (reinforcement)
f_y = 50,000 psi (AASHTO M270 Grade 50W)

SEISMIC DATA

Seismic Performance Zone (SPZ) = 2
Bedrock Acceleration Coefficient (A) = 9.25%g
Site Coefficient (S) = 1.2

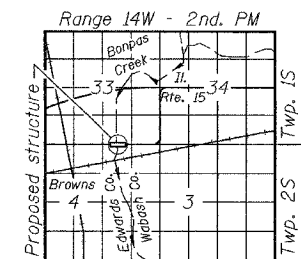

LOCATION SKETCH

GENERAL PLAN
BROWNS ROAD OVER
BONPAS CREEK
S.B.I. ROUTE 1 - SECTION (8C)B-2
WABASH COUNTY
STATION 204+42.25
STRUCTURE NO. 093-0022