

GENERAL NOTES

- ALL MATERIALS DEEMED SALVAGEABLE BY THE ENGINEER SHALL REMAIN THE PROPERTY OF THE CITY OF EAST ST. LOUIS, IL. ALL OTHER MATERIALS SHALL BE DISPOSED OF BY THE CONTRACTOR, AT HIS OWN EXPENSE.
- THE FOLLOWING ITEMS AND ESTIMATED QUANTITIES SHALL BE USED THROUGHOUT THIS PROJECT:

775 GALLONS, BITUMINOUS MATERIALS (PRIME COAT); 15 TON, AGGREGATE (PRIME COAT); 2 TON, MIXTURE FOR CRACKS, JOINTS AND FLANGEWAYS; 143 SQ. YD., TEMPORARY RAMP

- THE FOLLOWING UTILITY COMPANIES MAY HAVE FACILITIES LOCATED WITHIN THE LIMITS OF CONSTRUCTION.

SBC MIDWEST
203 GOETHE ST.
COLLINSVILLE, IL. 62234
(618) 482-6157

IL AMERICAN WATER CO.
300 N. WATER WORKS DR.
BELLEVILLE, IL 62223
(618)239-3261

AMEREN IP
1050 WEST BOULEVARD
BELLEVILLE, IL 62222
(618)236-6210

AMEREN UE
500 EAST BROADWAY
EAST ST. LOUIS, IL 62202
(618)482-2238

CITY OF EAST ST. LOUIS
PUBLIC WORKS DEPARTMENT
613 N. 20TH ST.
EAST ST. LOUIS, IL 62202
(618)482-6843

- THE FOLLOWING FACTORS WERE USED TO DETERMINE THE REQUIRED AMOUNT OF MATERIALS NEEDED.

BITUMINOUS CONC. SURFACE COURSE, SUPERPAVE, MIX "C", N70	112 LBS/SQ. YD. /IN. THK
LEVELING BINDER (MACHINE METHOD), SUPERPAVE N70	112 LBS/SQ. YD. /IN. THK
BITUMINOUS MATERIALS (PRIME COAT)	0.10 GAL/SQ. YD.
AGGREGATE (PRIME COAT)	4 LBS/SQ. YD.
INCIDENTAL BITUMINOUS SURFACING, SUPERPAVE	112 LBS/SQ. YD. /IN. THK

- THE FOLLOWING MIXTURE REQUIREMENTS ARE APPLICABLE FOR THIS PROJECT:

MIXTURE USE	SURFACE	LEVELING BINDER	INCIDENTAL
PG	PG 64-22	PG 64-22	PG 64-22
RAP % (MAX)	10%	15%	10%
DESIGN AIR VOIDS	4.0% @ Ndes =70	4.0% @ Ndes =70	4.0% @ Ndes =70
MIX COMPOSITION (GRADATION MIXTURE)	IL 9.5	IL 9.5	IL 9.5
FRICTION AGGREGATE	MIXTURE C	MIXTURE C	MIXTURE C

- ALL RAISED REFLECTIVE PAVEMENT MARKERS SHALL BE TWO-WAY AMBER. INSTALLED AS SHOWN ON STD. 781001

THERMOPLASTIC PAVEMENT MARKINGS				
LOCATION	DESCRIPTION	WIDTH (INCHES)	COLOR	LENGTH (FEET)
STA. 0+40.7 - STA. 21+36.6	NO PASSING ZONE (SB)	4	YELLOW	2096
STA. 0+40.7 - STA. 21+36.6	NO PASSING ZONE (NB)	4	YELLOW	2096
STA. 0+96 - STA. 6+73	RT EDGE LINE	4	WHITE	593
STA. 1+37 - STA. 6+44	LT EDGE LINE	4	WHITE	523
STA. 0+40.7	STOP BAR	24	WHITE	22
STA. 21+36.6	STOP BAR	24	WHITE	18
THERMOPLASTIC PAVEMENT MARKING - LINE 4"				5308
THERMOPLASTIC PAVEMENT MARKING - LINE 24"				40

RAISED REFLECTIVE PAVEMENT MARKERS		
LOCATION	SPACING (FOOT)	TWO - WAY AMBER (EACH)
STA. 0+40.7 - STA. 6+63.41	80	8
STA. 6+63.41 - STA. 10+07.61	40	9
STA. 10+07.61 - STA. 21+36.6	80	14
TOTAL		31

INCIDENTAL BITUMINOUS SURFACE		
LOCATION	QUANTITY (TON)	
ALLEY - STA 10+07.27 RT	0.4	
ENTRANCE - STA 11+68.22 LT	1.1	
CLEVELAND AVE - STA 11+70.56 RT	0.9	
ALLEY - STA 13+31.91 RT	0.4	
ENTRANCE - STA 14+69.22 LT	1.0	
ST LOUIS AVE - STA 15+05.44 RT	1.4	
ENTRANCE - STA 15+74.39 LT	0.6	
ALLEY - STA 16+77.44 RT	0.4	
ENTRANCE - STA 17+46.64 LT	0.1	
GATY AVE - STA 18+40.13 RT	0.8	
ENTRANCE - STA 18+40.85 LT	0.1	
ALLEY - STA 20+03.47 RT	0.3	
ENTRANCE - STA 20+81.83 LT	0.1	
ENTRANCE - STA 20+81.98 RT	0.1	
TOTAL		8.0

SECTION NO.	COUNTY HIGHWAY	COUNTY	SHEET OF SHEETS
05-00215-00-RS	N/A	ST. CLAIR	2 OF 9
ILLINOIS		FEDERAL AID PROJECT	
CONTRACT NO. 97283			

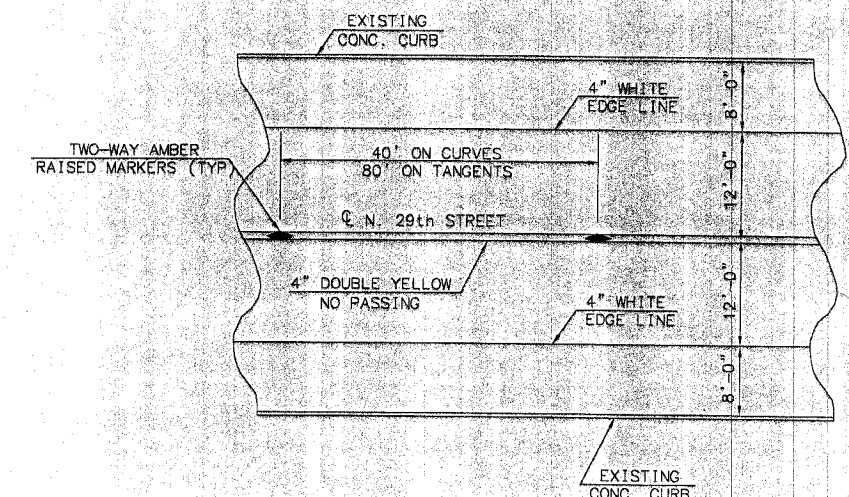
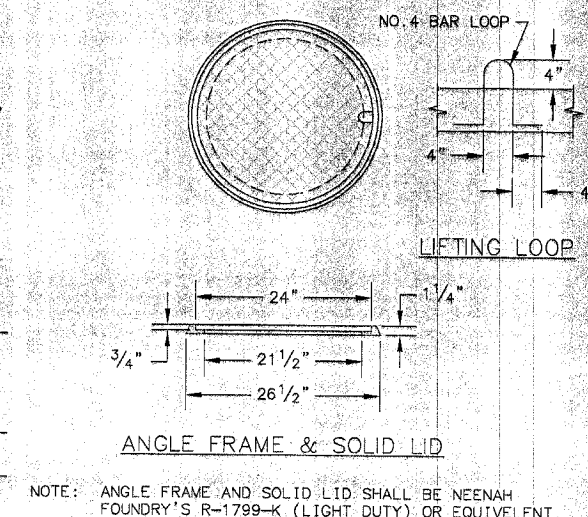
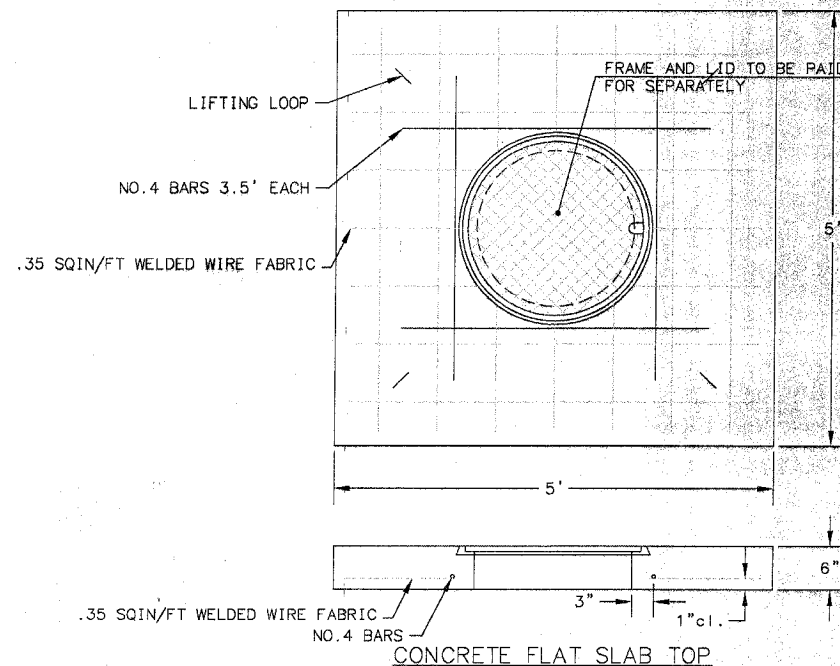

TYPICAL APPLICATION OF THERMOPLASTIC MARKINGS AND RAISED REFLECTIVE MARKERS
N.T.S.

INITIALS	DATE
DESIGNED R GEORGEN	8/05
CHECKED	
DRAWN DSENNE	8/05
CHECKED R GEORGEN	12/05
PREPARED BY ST. CLAIR COUNTY	
DRAWING FILE: GENNOTES	

SECTION NO.	COUNTY HIGHWAY	COUNTY	SHEET OF SHEETS
05-00215-00-RS	N/A	ST. CLAIR	3 OF 9
	ILLINOIS	FEDERAL AID PROJECT	
CONTRACT NO. 97283			

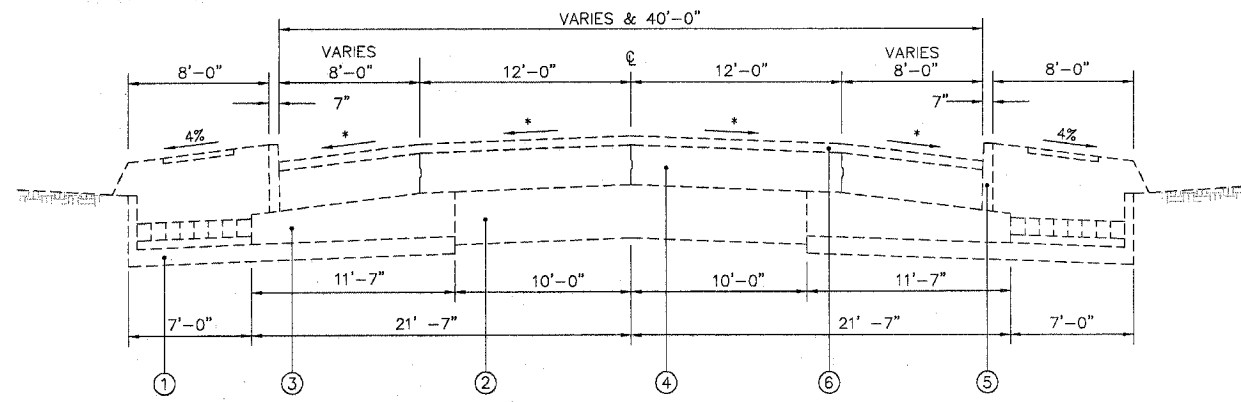

EXISTING TYPICAL SECTION
STA. 0+20.7 - STA. 0+68.6

* VARIABLE

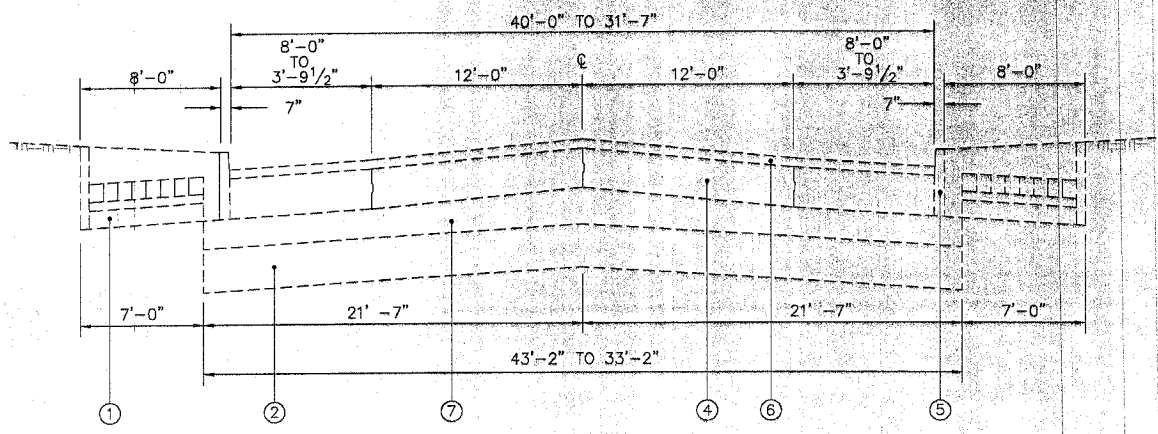

EXISTING TYPICAL SECTION
STA. 7+10.9 - STA. 9+41.2

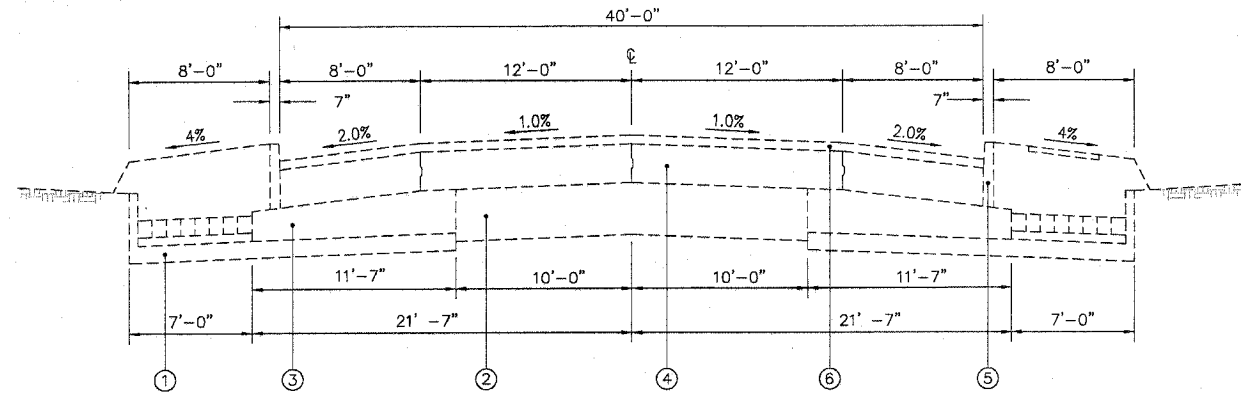

EXISTING TYPICAL SECTION
STA. 0+68.6 - STA. 7+10.9

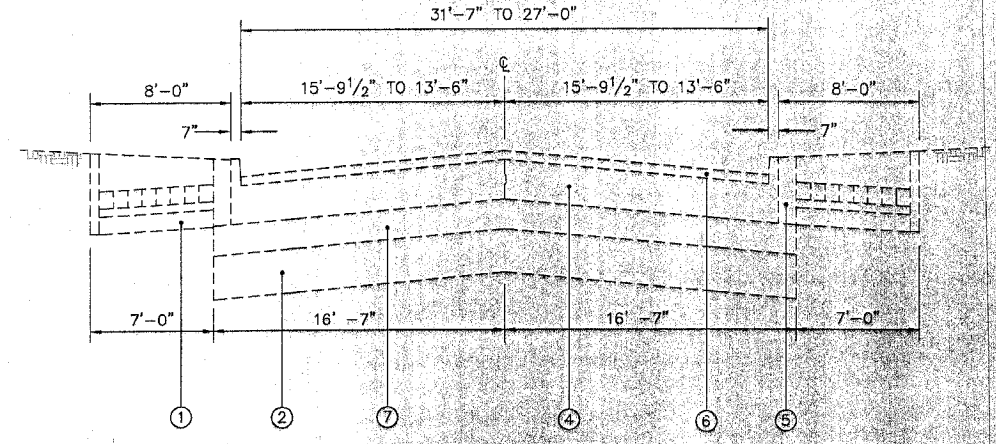

EXISTING TYPICAL SECTION
STA. 9+41.2 - STA. 10+17.3

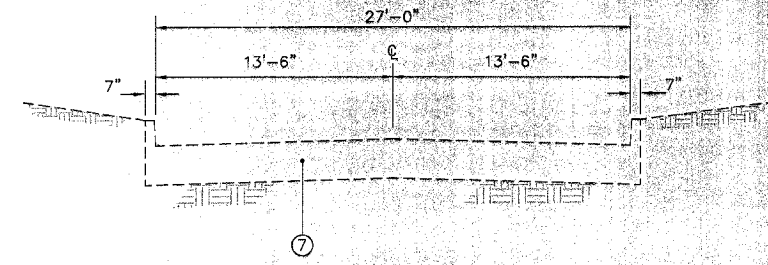

EXISTING TYPICAL SECTION
STA. 10+17.3 - STA. 21+46.6

STRUCTURAL DESIGN DATA

FLEXIBLE PAVEMENT DESIGN FOR CLASS III ROADWAY
 STRUCTURAL DESIGN TRAFFIC (S.D.T.) = 1954 SOT YEAR = 2017
 PV = 1720 (88%) SU = 137 (7%) MU = 97 (5%)
 TRAFFIC FACTOR (TF) = 0.42

PROPOSED PAVEMENT

LEVELING BINDER (MACHINE METHOD), SUPERPAVE N70, 3/4"
 BITUMINOUS CONCRETE SURFACE COURSE, SUPERPAVE, MIX "C", N50, 1 1/2"

PAVEMENT DESIGN IN ACCORDANCE WITH ARTICLE 2C
 OF THE IDOT BUREAU OF LOCAL ROADS AND STREETS
 "ADMINISTRATIVE POLICIES"

LEGEND

- ① EXISTING CONCRETE BASE
- ② EXISTING CRUSHED STONE
- ③ EXISTING GRANULAR BASE
- ④ EXISTING PORTLAND CEMENT CONCRETE PAVEMENT 9"
- ⑤ EXISTING CONCRETE CURB
- ⑥ EXISTING BITUMINOUS CONCRETE SURFACE COURSE, 1 3/4" (TO BE REMOVED)
- ⑦ EXISTING PORTLAND CEMENT CONCRETE PAVEMENT, 6"

	INITIALS	DATE
DESIGNED	RGEORGEN	8/05
CHECKED		
DRAWN	DSENNE	8/05
CHECKED	R GEORGEN	12/05
PREPARED BY ST. CLAIR COUNTY		
DRAWING FILE: TYPSECTIONS		

PLOT DATE:

EXISTING TYPICAL SECTIONS

SECTION NO.	COUNTY HIGHWAY	COUNTY	SHEET OF SHEETS
05-00215-00-RS	N/A	ST. CLAIR	4 OF 9
	ILLINOIS	FEDERAL AID PROJECT	
		CONTRACT NO. 97283	

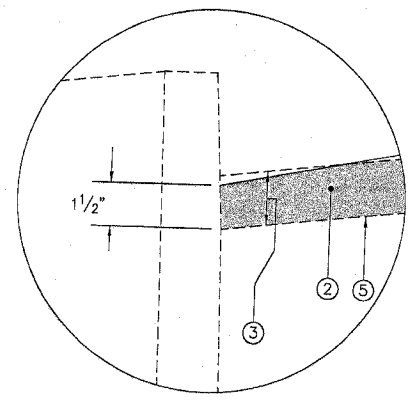

DETAIL A

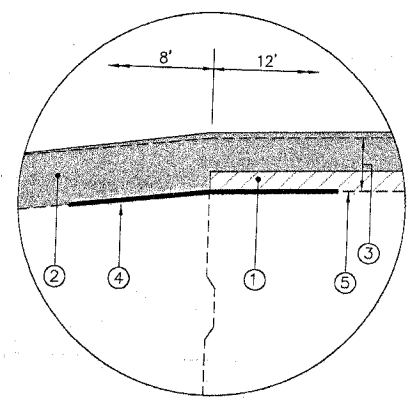

DETAIL B

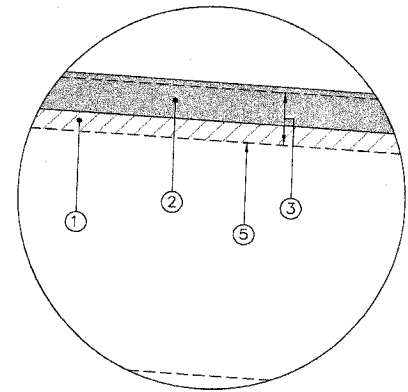

DETAIL C

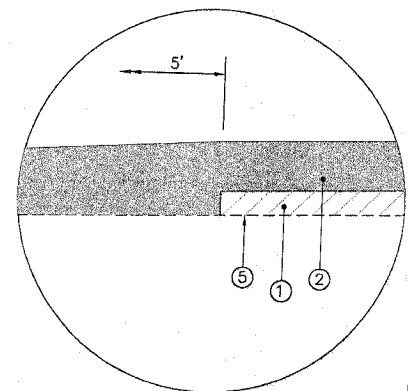

DETAIL D

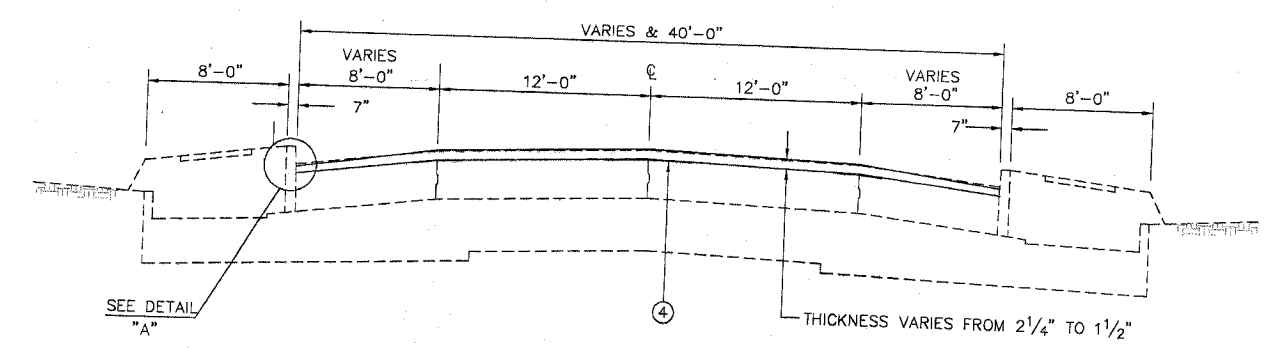

PROPOSED TYPICAL SECTION
STA. 0+20.7 - STA. 0+68.6

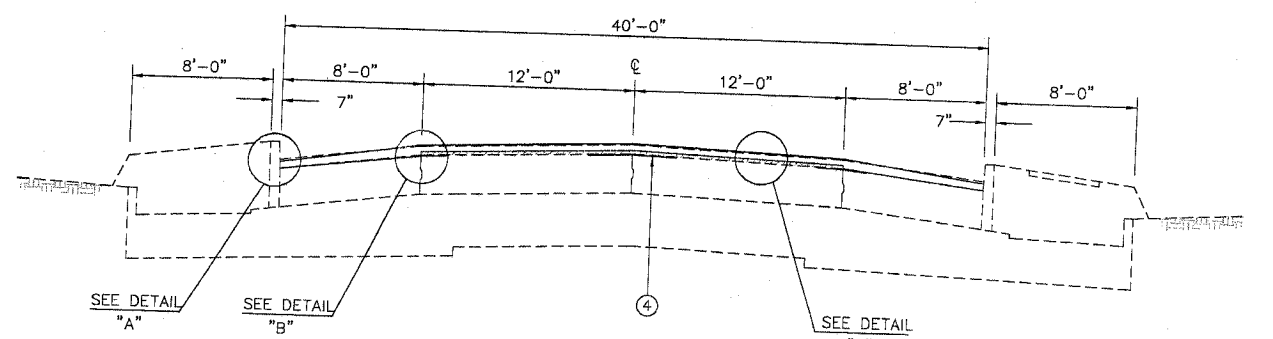

PROPOSED TYPICAL SECTION
STA. 0+68.6 - STA. 7+10.9

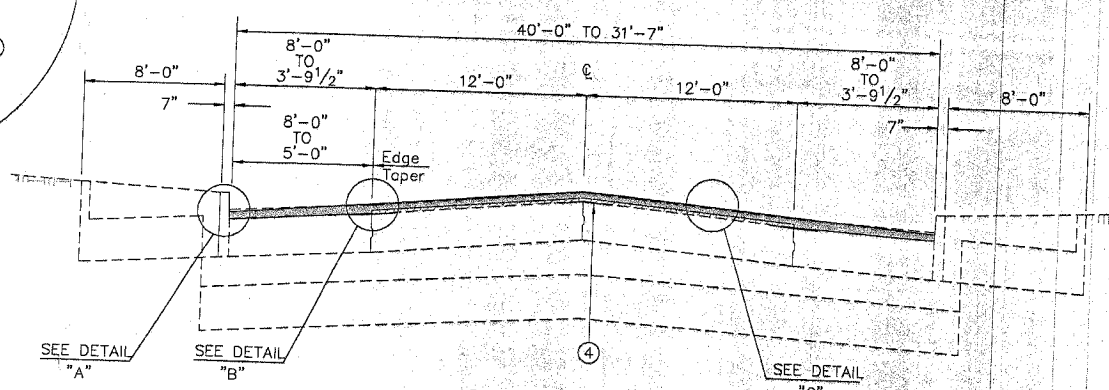

PROPOSED TYPICAL SECTION
STA. 7+10.9 - STA. 9+41.2

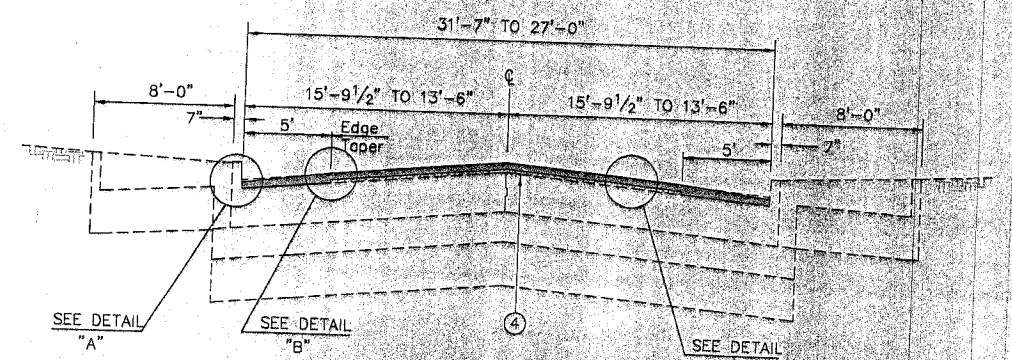

PROPOSED TYPICAL SECTION
STA. 9+41.2 - STA. 10+17.3

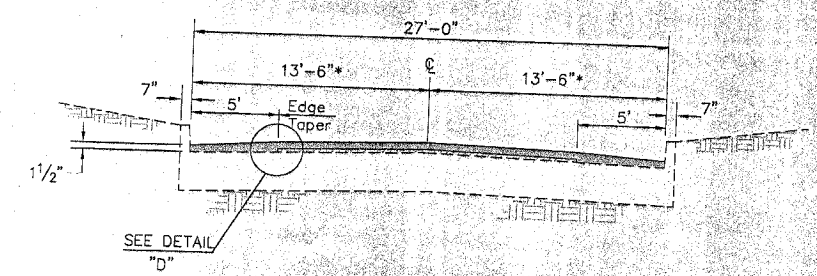

PROPOSED TYPICAL SECTION
STA. 10+17.3 - STA. 21+46.6
* : WIDTH VARIES FROM STA. 21+13.60 TO STA. 21+46.6

NOTE: SEE PLAN SHEETS FOR ADDITIONAL INFORMATION REGARDING AREA REFLECTIVE CRACK CONTROL TREATMENT

LEGEND

- ① LEVELING BINDER (MACHINE METHOD), SUPERPAVE N70, 3/4 INCH
- ② BITUMINOUS CONCRETE SURFACE COURSE, SUPERPAVE, MIX "C", N50, 1 1/2 INCH
- ③ BITUMINOUS CONCRETE SURFACE REMOVAL, 1 3/4
- ④ STRIP REFLECTIVE CRACK CONTROL TREATMENT
- ⑤ BITUMINOUS MATERIALS (PRIME COAT)/AGGREGATE (PRIME COAT)

	INITIALS	DATE
DESIGNED	RGEORGEN	8/05
CHECKED		
DRAWN	DSENNE	8/05
CHECKED	R GEORGEN	12/05
PREPARED BY ST. CLAIR COUNTY		
DRAWING FILE: TYPSECTIONS		

PROPOSED TYPICAL SECTIONS

SECTION NO.	COUNTY HIGHWAY	COUNTY	SHEET OF SHEETS
05-00215-00-RS	N/A	ST. CLAIR	5 OF 9
ILLINOIS		FEDERAL AID PROJECT	
CONTRACT NO. 97283			

NOTE: THE EXISTING R.O.W., AS SHOWN, IS FOR ILLUSTRATIVE PURPOSES ONLY AND SHOULD NOT BE CONSTRUED AS BEING EXACT.



[Hatched Box] : DENOTES PATCH

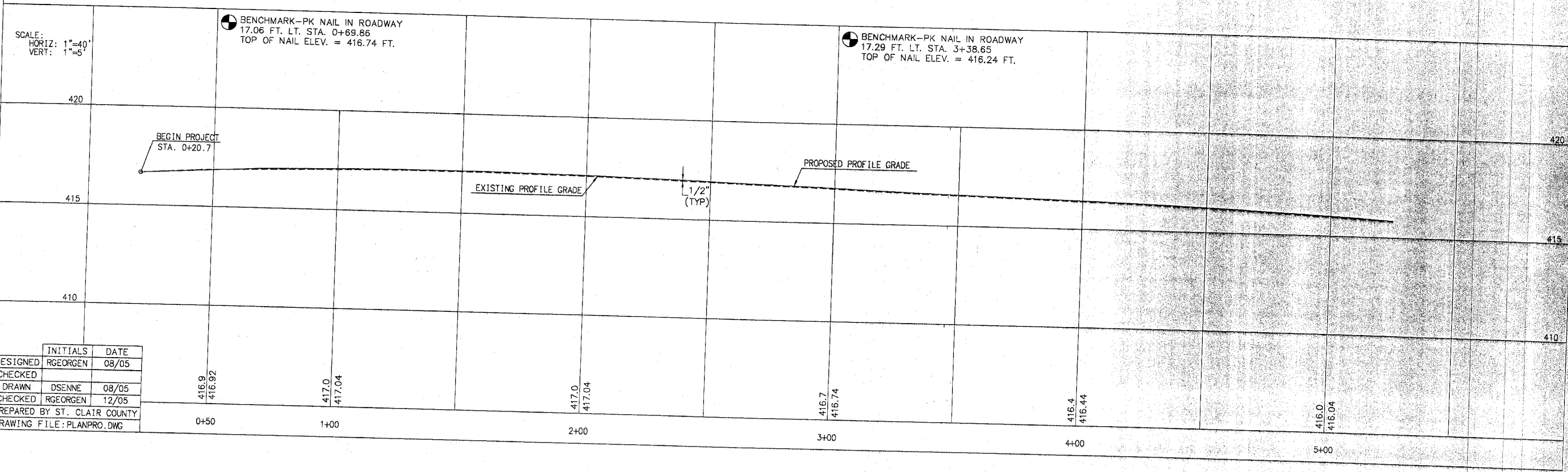
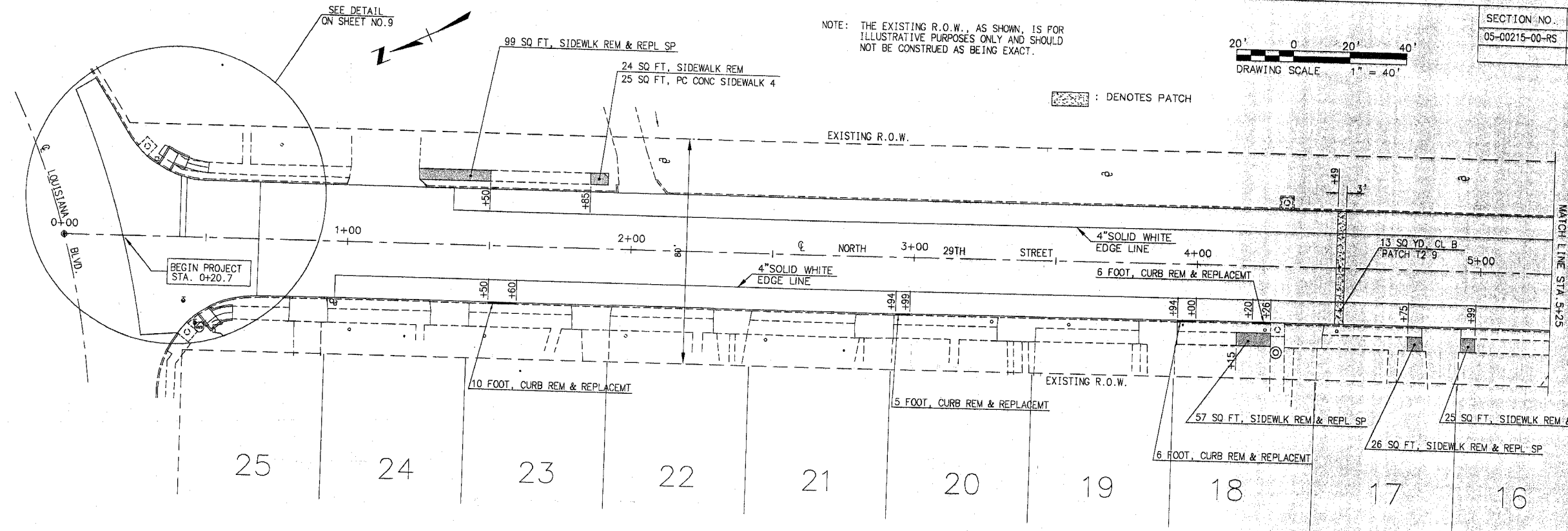

● BENCHMARK—PK NAIL IN ROADWAY
17.06 FT. LT. STA. 0+69.86
TOP OF NAIL ELEV. = 416.74 FT.

● BENCHMARK—PK NAIL IN ROADWAY
17.29 FT. LT. STA. 3+38.65
TOP OF NAIL ELEV. = 416.24 FT.

	INITIALS	DATE
DESIGNED	RGEORGEN	08/05
CHECKED		
DRAWN	DSENNE	08/05
CHECKED	RGEORGEN	12/05
PREPARED BY ST. CLAIR COUNTY		
DRAWING FILE: PLANPRO.DWG		

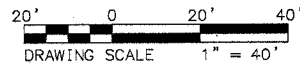

: DENOTES PATCH
 : DENOTES AREA REFLECTIVE CRACK CONTROL TREATMENT

@ CURVE DATA
 PI STA. 7+21
 $\Delta=25^{\circ}52'00''$
 $R=250.79$ FT
 $T=57.59$ FT
 $L=113.22$ FT
 $C=112.26$ FT
 PC STA. 6+63.41
 PT STA. 7+76.63

SECTION NO.	COUNTY HIGHWAY	COUNTY	SHEET OF SHEETS
05-00215-00-RS	N/A	ST. CLAIR	6 OF 9
ILLINOIS		FEDERAL AID PROJECT	
CONTRACT NO. 97283			

16

15

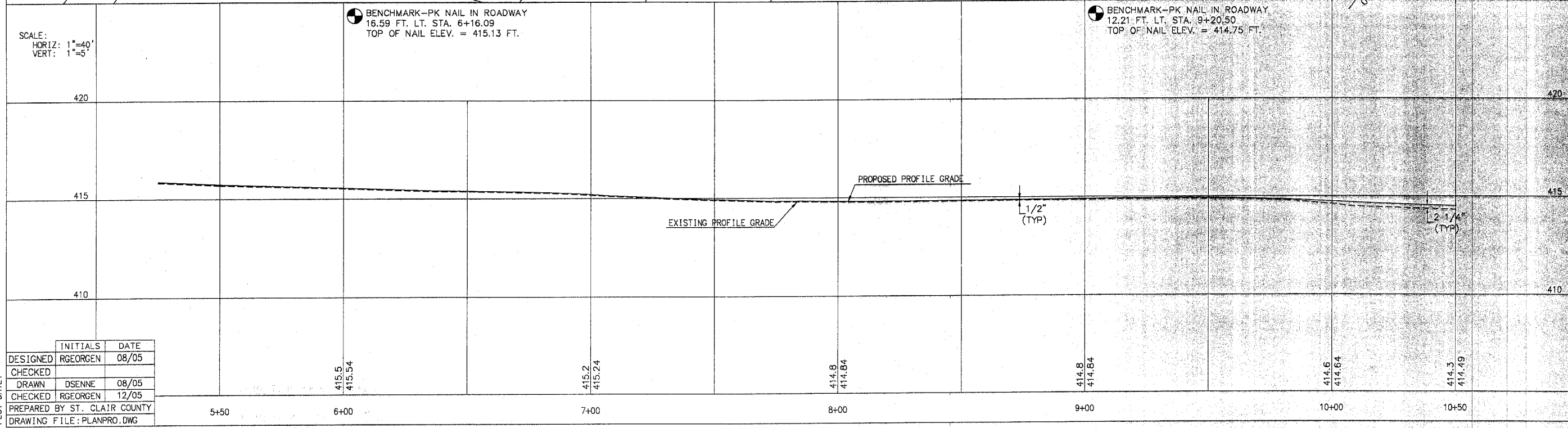
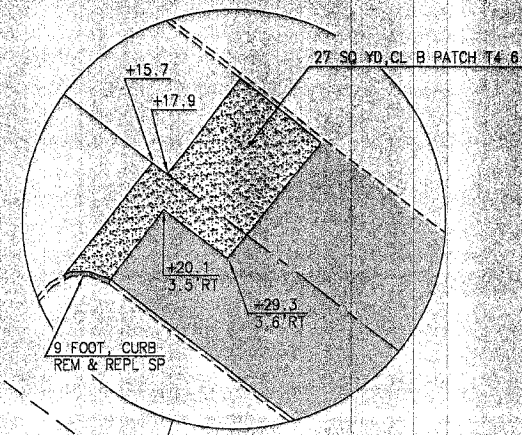
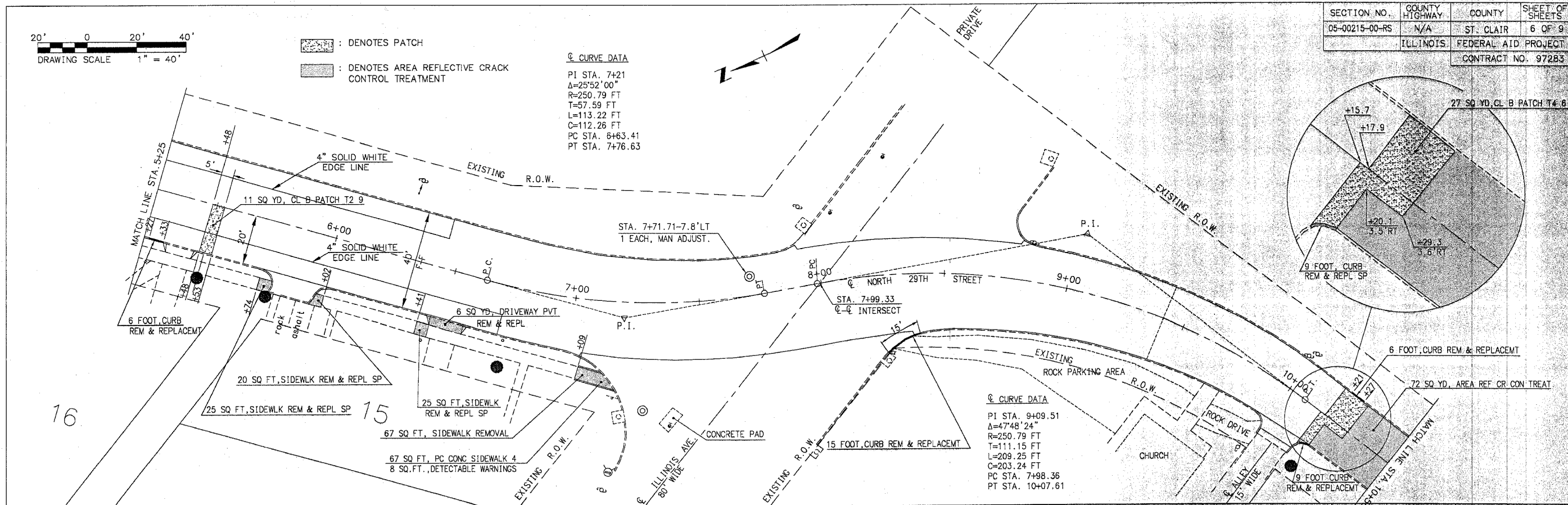

	INITIALS	DATE
DESIGNED	RGEORGEN	08/05
CHECKED		
DRAWN	DSENE	08/05
CHECKED	RGEORGEN	12/05
PREPARED BY ST. CLAIR COUNTY		
DRAWING FILE: PLANPRO.DWG		

SECTION NO.	COUNTY HIGHWAY	COUNTY	SHEET OF SHEETS
05-00215-00-RS	N/A	ST. CLAIR	7 OF 9
ILLINOIS		FEDERAL AID PROJECT	
CONTRACT NO. 97283			

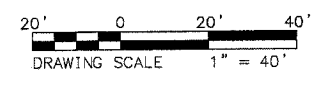

: DENOTES PATCH
 : DENOTES AREA REFLECTIVE CRACK CONTROL TREATMENT

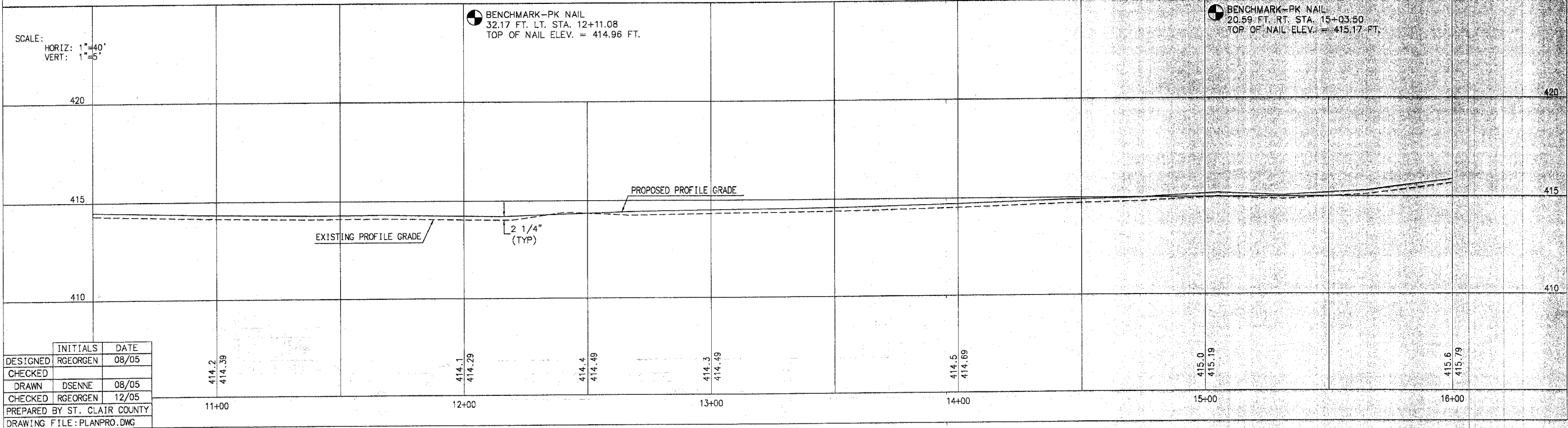
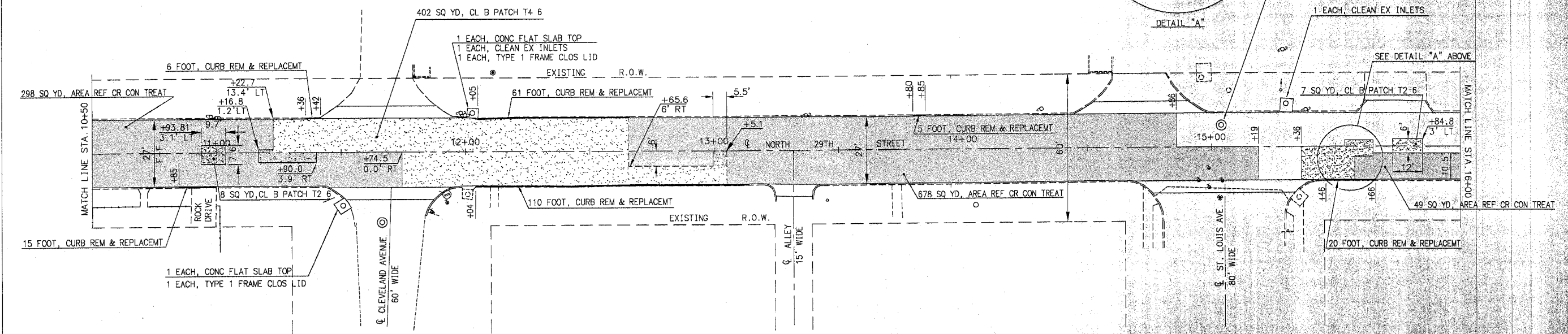
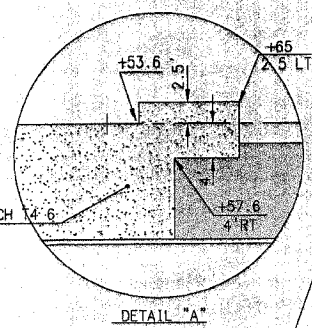

	INITIALS	DATE
DESIGNED	RGEORGEN	08/05
CHECKED		
DRAWN	DSENNE	08/05
CHECKED	RGEORGEN	12/05
PREPARED BY	ST. CLAIR COUNTY	
DRAWING FILE	PLANPRO.DWG	

	414.2 414.39	414.1 414.29	414.4 414.49	414.3 414.49	414.5 414.69	415.0 415.19	415.6 415.79			
11+00		12+00		13+00		14+00		15+00		16+00

SECTION NO.	COUNTY HIGHWAY	COUNTY	SHEET OF SHEETS
05-00215-00-RS	N/A	ST. CLAIR	8 OF 9
ILLINOIS		FEDERAL AID PROJECT	
CONTRACT NO. 97283			

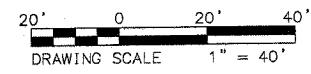

- : DENOTES PATCH
- : DENOTES AREA REFLECTIVE CRACK CONTROL TREATMENT
- : DENOTES PCC SURFACE REMOVAL (COLD MILLING)

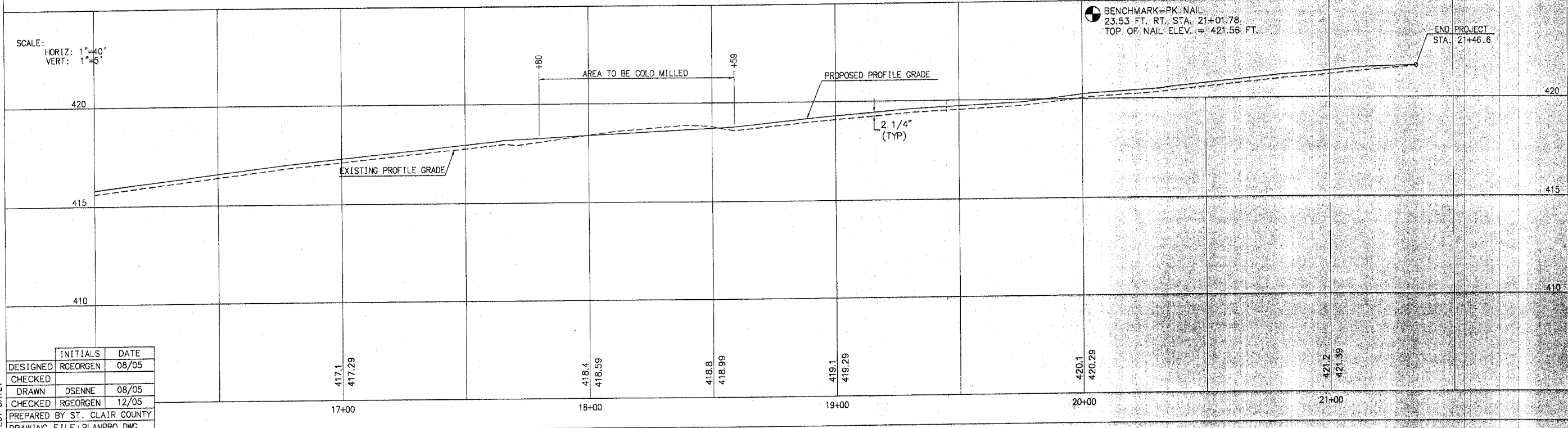
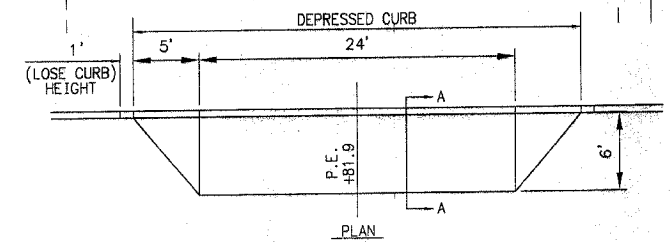
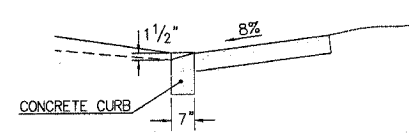
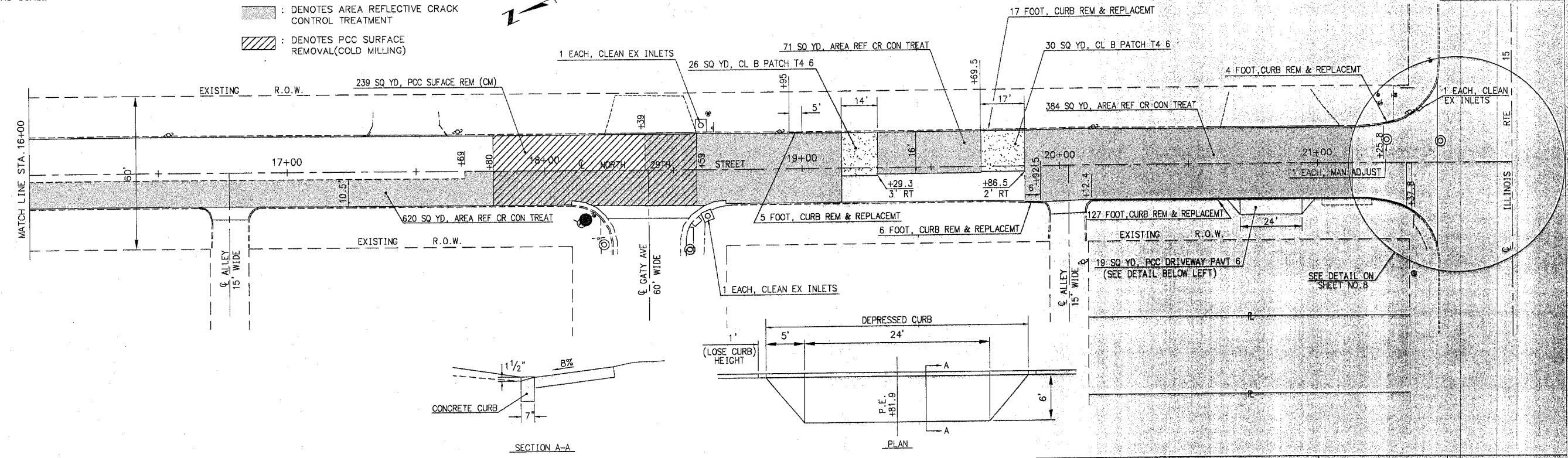

	INITIALS	DATE
DESIGNED	RGEORGEN	08/05
CHECKED		
DRAWN	DSENE	08/05
CHECKED	RGEORGEN	12/05
PREPARED BY ST. CLAIR COUNTY		
DRAWING FILE: PLANPRO.DWG		

SECTION NO.	COUNTY HIGHWAY	COUNTY	SHEET OF SHEETS
05-00215-00-RS	N/A	ST. CLAIR	9 OF 9
	ILLINOIS	FEDERAL AID PROJECT	
CONTRACT NO. 97283			

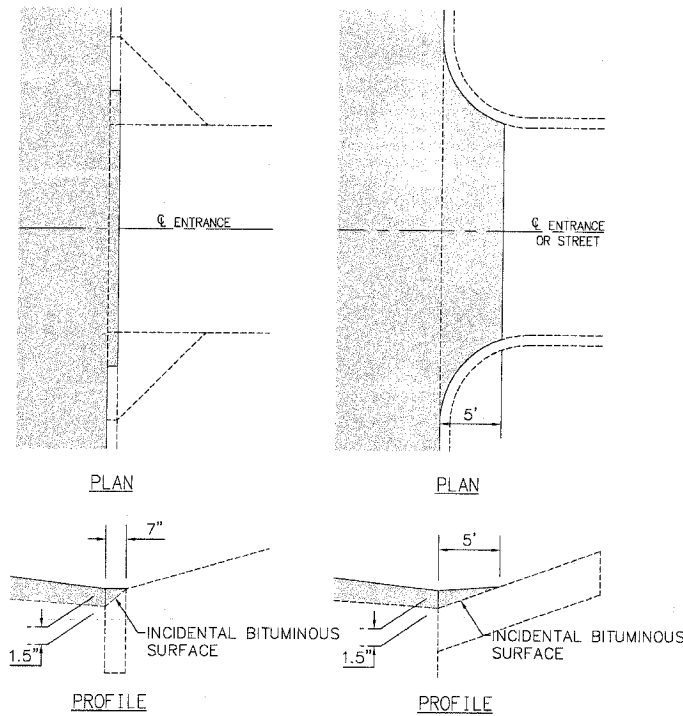

TYPICAL ENTRANCE DETAILS

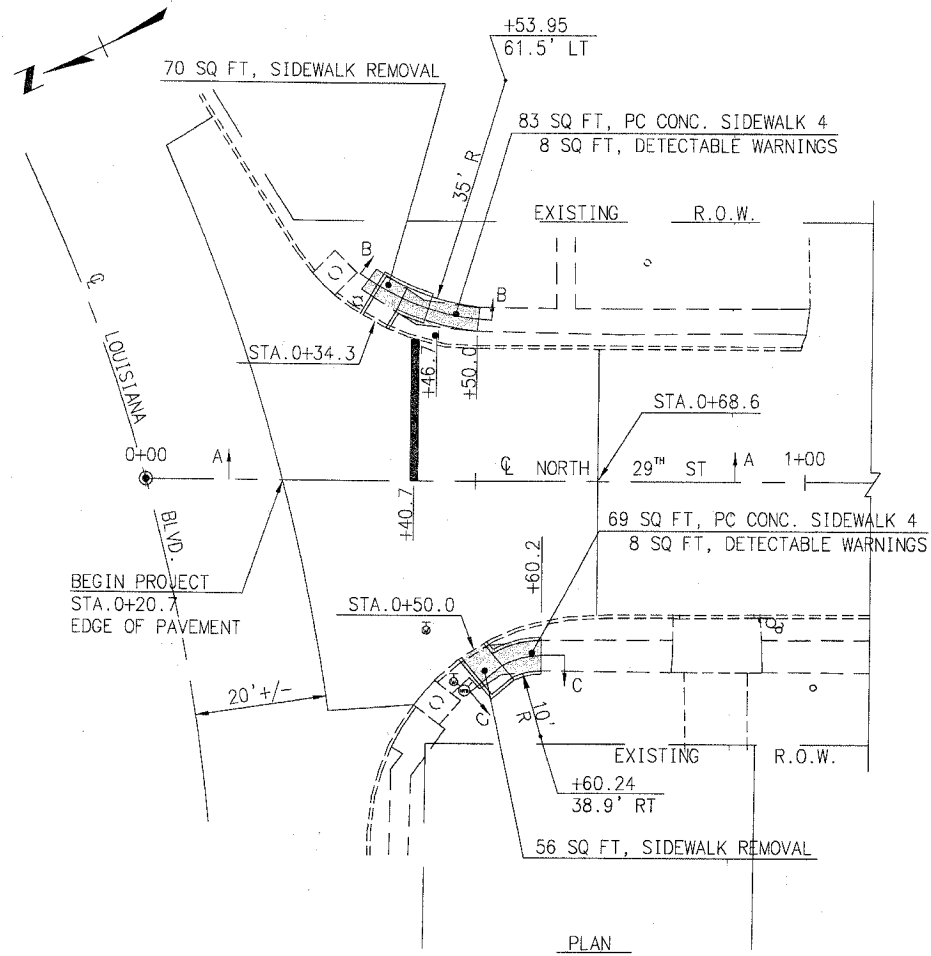

PLAN

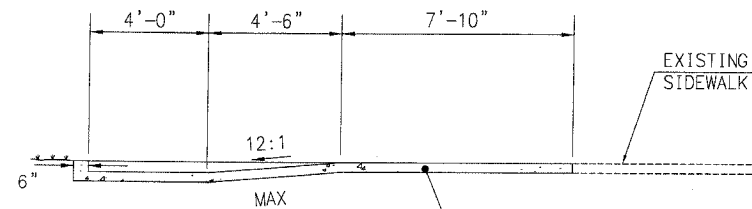

SECTION B-B

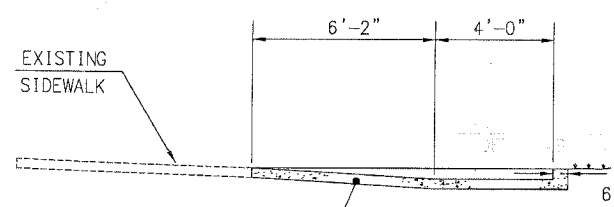

SECTION C-C

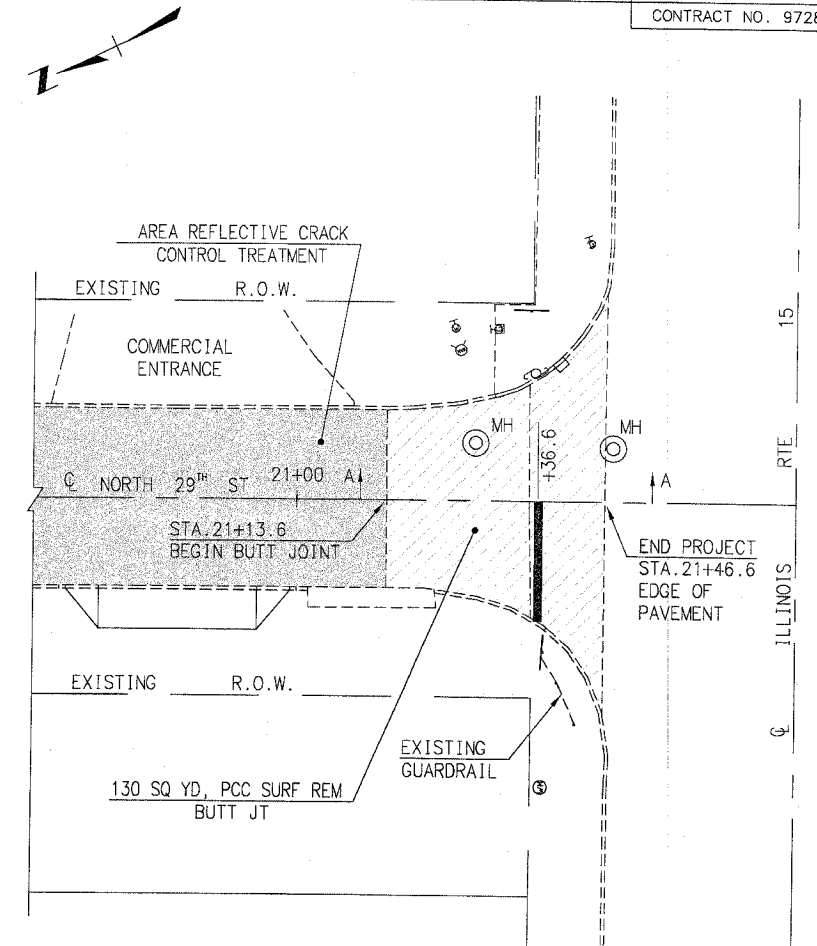

PLAN

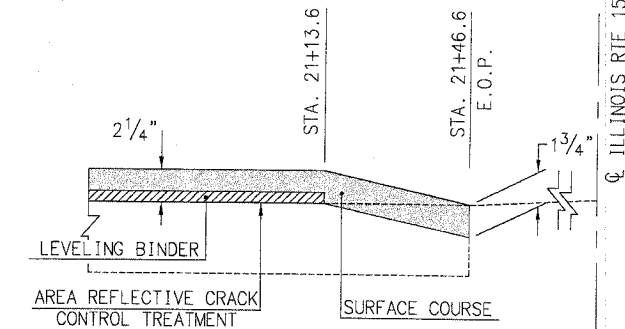

SECTION A-A

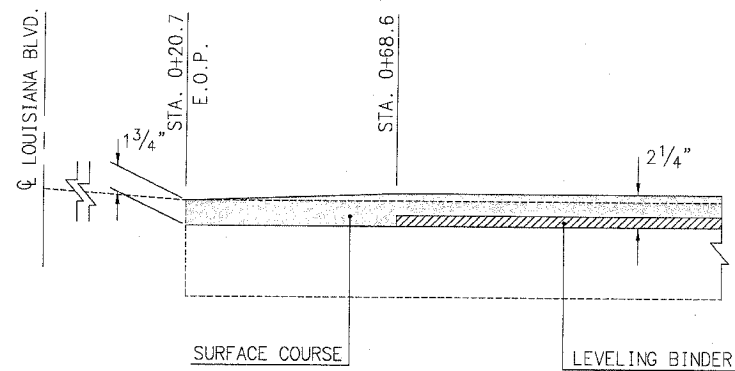

SECTION A-A

	INITIALS	DATE
DESIGNED	RGEORGEN	8/05
CHECKED		
DRAWN	DSENE	8/05
CHECKED	RGEORGEN	11/05
PREPARED BY ST. CLAIR COUNTY		
DRAWING FILE: DETAILS		

PLOT DATE: