

F.A.I. RTE.	SECTION	COUNTY	TOTAL SHEETS	SHEET NO.
57	44-1L, 44-3L	JOHNSON	15	1

*FAI 57 & FAI 24
**(44-1)L, (44-3)L

STATE OF ILLINOIS
DEPARTMENT OF TRANSPORTATION
DIVISION OF HIGHWAYS

**PROPOSED
HIGHWAY PLANS**

FAI 57 & FAI 24 (I-57 & I-24)
SECTION (44-1)L, (44-3)L
PROJECT: IM-000S(520)

JOHNSON COUNTY
C-99-048-06

D-99-040-06

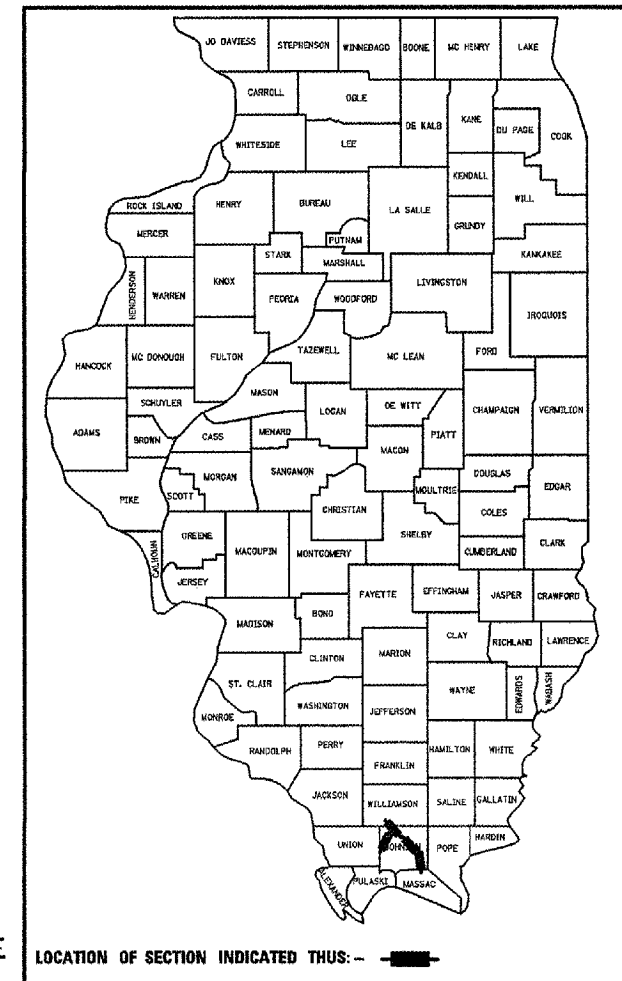

FOR INDEX OF SHEETS, SEE SHEET NO. 2

ADT (2005) I-57 AND GOREVILLE- ADT = 12,400 ON RAMPS - 40 ON FAS 1931 = 1150 TRUCK = 5650 (45.5%)	ADT (2005) I-24 (PULLEY'S MILL) ADT = 15,900 TRUCK = 35%
I-24 AND TUNNEL HILL- ADT = 15,900 ON RAMPS = 7 ON FAS 927 = 1250 TRUCK = 5700 (35.8%)	I-24 AND US 45 NORTH OF VIENNA (2005)- ADT = 15,500 TRUCK = 35%

LOCATION 4: FAI 24 - PROP. PAVEMENT SENSOR
REPAIR NEAR PULLEY'S MILL INTERCHANGE
IN JOHNSON CO.

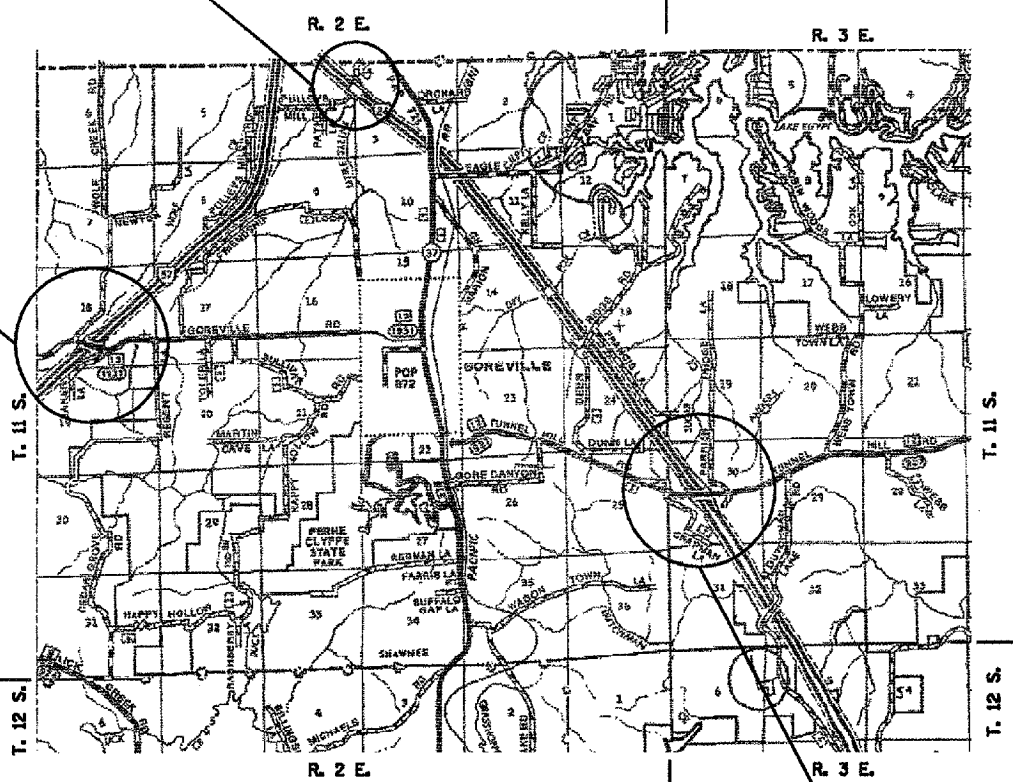

LOCATION 1: FAI 57 - PROP.
LIGHTING IMPROVEMENT
GOREVILLE INTERCHANGE IN
JOHNSON CO.

TOWNSHIPS: GOREVILLE, TUNNEL HILL
AND BLOOMFIELD

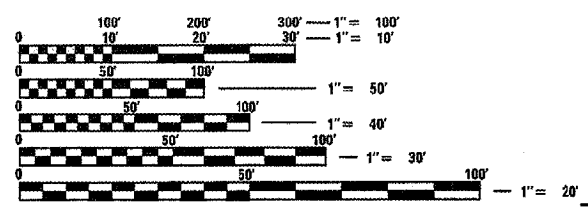

FULL SIZE PLANS HAVE BEEN PREPARED USING STANDARD
ENGINEERING SCALES. REDUCED SIZED PLANS WILL NOT
CONFORM TO STANDARD SCALES. IN MAKING MEASUREMENTS
ON REDUCED PLANS, THE ABOVE SCALES MAY BE USED.

J.U.I.E.
JOINT UTILITY LOCATION INFORMATION FOR EXCAVATION
1-800-892-0123

LOCATION 2: FAI 24 - PROP. LIGHTING IMPROVEMENT
TUNNEL HILL INTERCHANGE IN JOHNSON CO.

LOCATION 3: FAI 24 - PROP. LIGHTING
UNIT DUCT REPAIR AT US 45 INTERCHANGE

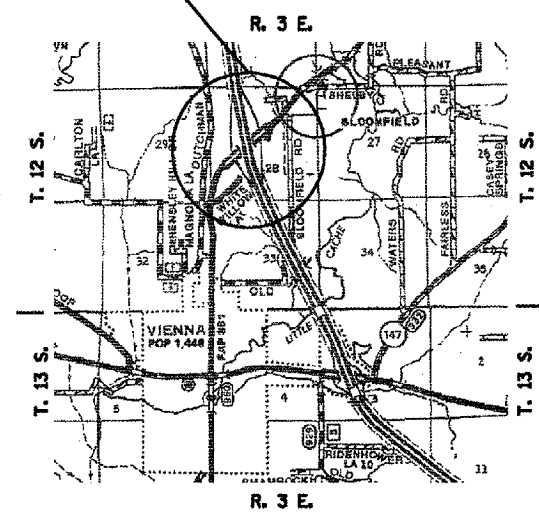

STATE OF ILLINOIS
DEPARTMENT OF TRANSPORTATION
DIVISION OF HIGHWAYS

SUBMITTED August 23, 2006
Mary C. Linnell
DEPUTY DIRECTOR OF HIGHWAYS, REGION ENGINEER

October 13, 2006
Mike Hene
ENGINEER OF DESIGN AND ENVIRONMENT

October 13, 2006
Milton R. Sees, P.E.
DIRECTOR OF HIGHWAYS, CHIEF ENGINEER

**PRINTED BY THE AUTHORITY
OF THE STATE OF ILLINOIS**

PROJECT ENGINEER: CHARLES STEIN - (618)351-5210
DESIGN TECHNICIAN: KATHI MCCORD - (618)351-5216

CONTRACT NO. 98981