

SECTION	DATE	BY	CHKD
2017-0191	09/25/17	DAVID CARL PUZEY	DAVID CARL PUZEY
STA. 11+22.25	NO. 16	NO. 16	NO. 8
TOTAL SHEETS		SHEET NO.	
16		8	

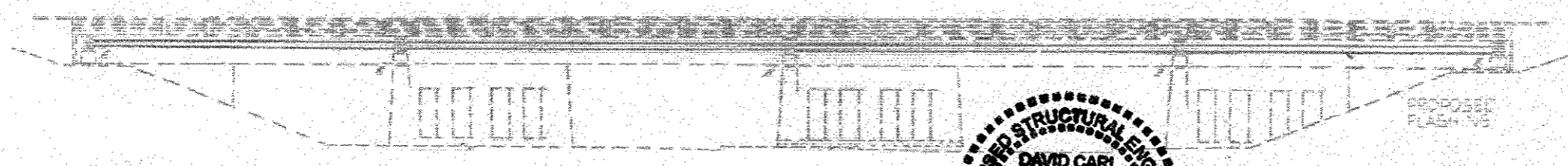

FOR TOTAL BILL OF MATERIALS
SEE SH. 3L

LINCOLN AVENUE
 EXISTING STRUCTURE NO. 016-0826 AT STA. 11+22.25 BUILT IN 1947 AS FEDERAL-AID HIGHWAY P.A. ROUTE 99
 PROJECT 2.1 106(29) EDENS EXPRESSWAY SECTION 0505.1 N.B.
 EXISTING WEARING SURFACE AND LONGITUDINAL JOINT TO BE REMOVED. EXISTING EXPANSION DEVICES TO BE
 REMOVED AND REPLACED WITH NEOPRENE EXPANSION JOINTS. EXISTING DECK TO BE REPAIRED AND OVERLAIN WITH PLASTICIZED BRIDGE DECK CONCRETE
 OVERLAY AS PER SPEC. 2.1. NEW DRIP PLATES TO BE PLACED. NEW DIAPHRAGMS TO BE PLACED. EXISTING
 PILES TO BE REPAIRED. EXISTING BEARINGS TO BE REPAIRED AND PAINTED. SOME BEARINGS REMOVED AND REPLACED.
 TWO WAY TRAFFIC SHALL BE MAINTAINED BY UTILIZING SKEW CONSTRUCTION.

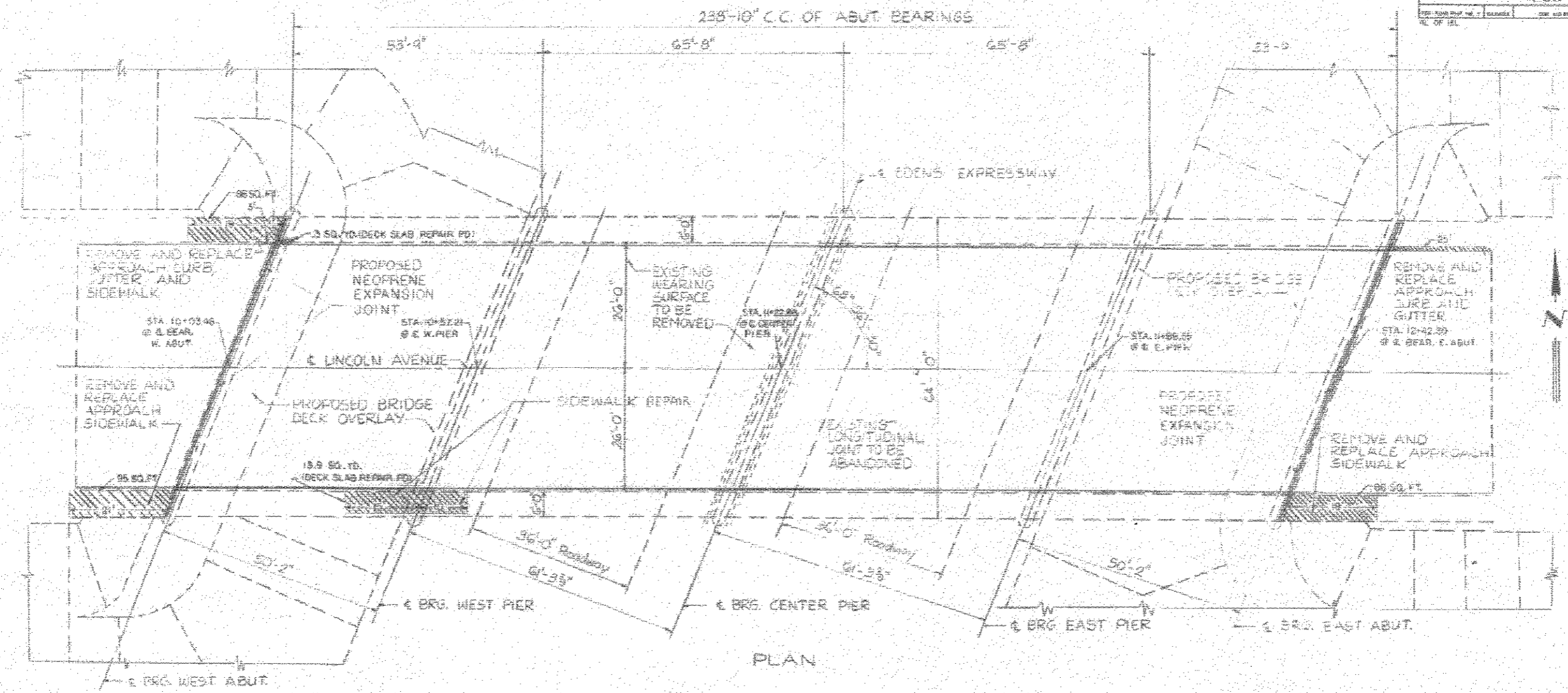

David Carl Puzey 9/25/17
 Expires 11/30/18

ILLINOIS DIVISION OF HIGHWAYS
**LINCOLN AVENUE OVER
 EDENS EXPRESSWAY**
 GENERAL PLAN

SCALE: 1/4" = 1'-0"
 DATE: 9/25/17
 DRAWN BY: S.M.
 CHECKED BY: J.M.

USER NAME = saintvich	DESIGNED - JAM	REVISED -
DRAWN -	REVISED -	REVISED -
PLOT SCALE = 100.0000" / 1"	CHECKED - VHU	REVISED -
PLOT DATE = 9/20/17	DATE -	REVISED -

STATE OF ILLINOIS
 DEPARTMENT OF TRANSPORTATION

I-94 EDENS EXPWY AT LINCOLN AVE. (SN 016-0826)
 PLAN AND PROFILE

SCALE:	SHEET	OF	SHEETS	STA.	TO	STA.
--------	-------	----	--------	------	----	------

F.A.I. RTE.	SECTION	COUNTY	TOTAL SHEETS	SHEET NO.
94	2017-0191	COOK	16	8
CONTRACT NO. 62F38				
ILLINOIS FED. AID PROJECT				

MODEL: Default
 FILE NAME: P:\11\0846EDENTS Illinois.gov\PROJECTS\DOT Documents\DOT Offices\BSP\11\0846EDENS\016-0826\016-0826.dwg