

DATE: 5/17/11

MICROFILM REQUEST

AS DESIGNED

AS BUILT

TRACIN

COUNTY: Cook

NAME OF ROADWAY: Oakton Street

LIMITS FROM: W. Frontage Rd.
TO: Gross Point Rd / Central Ave

BRIDGE: oakton st. OVER: I-94 (Edens)
BRIDGE ID #: 016-0827

REMARKS: _____

ROUTE # AND CONSTRUCTION SECTION	MICROFIL
<u>Oakton 263-0405.1 H/S (FA 99)</u>	<u>0-030 5-5i</u>
<u>Oakton 1978 1978-1A 2BR-78</u>	<u>Pilot 1/1055</u>
<u>Oakton 1998-0491</u>	<u>Microfilm PIPX</u>
<u>FAU 1332 3072RS-82</u>	<u>24092 & 508</u>

REQUESTORS NAME: Mike Phan, #4634

FLEX TIME REGULAR TIME

BUREAU: Programming PHONE: 4634

IF YOU ARE REQUESTING PLANS FOR A STATE CONSULTANT:

DEPARTMENT CONTACT: _____ (NAME)

CONTRACT NO.: _____

Microfilm

5) FAU 1332 3072RS 287X 0206 PILT

6) FAU 1332 3072ABR 82X 0173 PILT

7) ~~FAU 13~~ MISC VILL 83 00075 00 TL 0161 MNGR

District Bridge Microfilm List

Structure Number	Facility Carried	Feature Crossed	Const Type	Const. Year	Contract Number	Work Description	Constuct. Route	Constuction Section	Micro Original	Micro As-Built
										S-56
016-0821	Glenview Rd	I- 94 (Edens Expressway)	Orig	1949	----	Original Construction	FA 99	263-0808.1-15D		
016-0821	Glenview Rd	I- 94 (Edens Expressway)	Rehab	1984	38321	Conc Overlay	FAI 94	0808-1BR-84	Pilot	24066
016-0821	Glenview Rd	I- 94 (Edens Expressway)	Maint	1999	60582	Substructure Repairs	FAI94,290	1998-049I	No Film	PIPX
										S-54
016-0823	Old Orchard Rd	I- 94 (Edens Expressway)	Orig	1950	----	Original Construction	FA 99	263-0707.2-15D		
016-0823	Old Orchard Rd	I- 94 (Edens Expressway)	Rehab	1982	County	Widening & Rehab	---	263-0707.05I		C-93
016-0823	Old Orchard Rd	I- 94 (Edens Expressway)	Maint	1999	60582	Substructure Repairs	FAI94,290	1998-049I	No Film	PIPX
										S-54
016-0825	Church St	I- 94 (Edens Expressway)	Orig	1950	----	Original Construction	SA 263	263-0606.1 HB (FA 99)	0-030	S-54
016-0825	Church St	I- 94 (Edens Expressway)	Rehab	1984						
016-0825	Church St	I- 94 (Edens Expressway)	Maint	1999	60582	Substructure Repairs	FAI94,290	1998-049I	No Film	PIPX
016-0825	Church St	I- 94 (Edens Expressway)	Maint	2002	62347	Parapet Repair, Rail Install	FAI 94	2001-1641		
										S-57
016-0826	Lincoln Ave	I- 94 (Edens Expressway)	Orig	1950	----	Original Construction	SA 263	263-0505.1 HB (FA 99)	0-030	S-57
016-0826	Lincoln Ave	I- 94 (Edens Expressway)	Rehab	1984	36991	Conc Overlay	FAI 94	1978-143BR-78	Pilot	22407
016-0826	Lincoln Ave	I- 94 (Edens Expressway)	Maint	1999	60582	Substructure Repairs	FAI94,290	1998-049I	No Film	PIPX
016-0826	Lincoln Ave	I- 94 (Edens Expressway)	Maint	2002	62347	Parapet Repair, Rail Install	FAI 94	2001-1641		
										S-57
016-0827	Oakton St	I- 94 (Edens Expressway)	Orig	1950	----	Original Construction	SA 263	263-0405.1 HB (FA 99)	0-030	S-57
016-0827	Oakton St	I- 94 (Edens Expressway)	Rehab	1982	35404	R/R Bit Overlay	FAI 94	1978-142BR-78	Pilot	10552
016-0827	Oakton St	I- 94 (Edens Expressway)	Maint	1999	60582	Substructure Repairs	FAI94,290	1998-049I	No Film	PIPX
										S-57
016-0828	Oakton St	North Shore Channel	Orig	1957	----	Original Construction	SA 128	1617	CF	
016-0828	Oakton St	North Shore Channel	Rehab	2001	60221	Rehabilitation	FAU 1332	1617B-R		
016-0829	Touhy Ave	Des Plaines River	Orig	1955	----	Original Construction	SA 3A SA 130	109B-15B 130-2121	CF	C-57
016-0829	Touhy Ave	Des Plaines River		1980	34482		FA 525	1975-046-BR	Pilot	4397
016-0829	Touhy Ave	Des Plaines River	Maint	2003	62469	Debris Rmvl from Wtrway	Various	2002-061I		
							FA 99			
016-0831	Pratt Ave	I- 94 (Edens Expressway)	Orig	1949	----	Original Construction	SA 263	263-0303.1 HB	0-030	S-60
016-0831	Pratt Ave	I- 94 (Edens Expressway)	Rehab	1983	33983		FAI 94	1975-119-BR	Pilot	13182*
										S-60
016-0832	Devon Ave	Des Plaines River	Orig	1928	----	Original Construction	SA 98	1299	C58-49	
016-0832	Devon Ave	Des Plaines River		1979	33556		FAU 1349	1975152BR	Pilot	00501

DISTRICT 1 CITY MAINT. SECT. SKOKIE



MARKED ROUTE	CONSTRUCTED AS			TYPE	TOTAL WIDTH	CENTER MAINTAINED WIDTH	FEET	LANE MILES
	ROUTE	SECTION	YEAR					
SUB SECTION A20								
ILL. 58 (DEMPSTER ST.)	FA 99	0506.1H	'51-'91-'01	BC-CB	2@24'	2@24'	568	0.43
ILL. 58 (DEMPSTER ST.)	FA 99	0506.1H	'91-'01 '51-'64-'83	BC-CB	2@24'	2@24'	193	0.15
ILL. 58 (DEMPSTER ST.)	CH 123	3228B-15D-Z-1	'27-'64-'83	BC-CB	2@24'	2@24'	1,552	1.18
ILL. 58 (DEMPSTER ST.)	FAU 1324	1975-139W&RS, T	'83-'96	BC-CB	2@24'	2@24'	2,038	1.54
DEMPSTER ST.	FAU 1324	1975-139W&RS, T	'83-'96	BC-CB	1@23' 1@24'	1@23' 1@24'	703	0.53
DEMPSTER ST. (DEMPSTER ST.)	FAU 8526	1976-028-RS	'77-'96 '32-'53	BC-CB	2@23'	2@23'	4,260	3.28
DEMPSTER ST.	FAU 1324	585WRS-84	'32-'53-'86	BC-CB	2@23'	2@23'	2,424	1.84
DEMPSTER ST.	FAU 1324	585WRS-84	'26-'53-'86	BC-CB	2@23'	2@23'	2,121	1.61
DEMPSTER ST.	FAU 2832	(3839&4041) R-1(86)	1992	BC-BIT	2@24'	2@24'	638	0.48
DEMPSTER ST.	SA 123	123-0709MFT	'26-'53-'84	BC-*	40'	40'	283	0.21
ILL. 58 (DEMPSTER ST.)	FAI 94	0506.1R-85	'88-'91 '52-'71-'77	WFIB	2@38'	2@38'	262	0.20
DEMPSTER ST.	CHS 123	55-R-SDC-DR	'64-'69-'99	IB	44'	44'	158	0.12
					TOTAL		15,200	11.57

* = NO BASE PLANS	REVISED	APPROVED	COUNTY	MILES
			COOK	2.8788
			L.M.	11.57

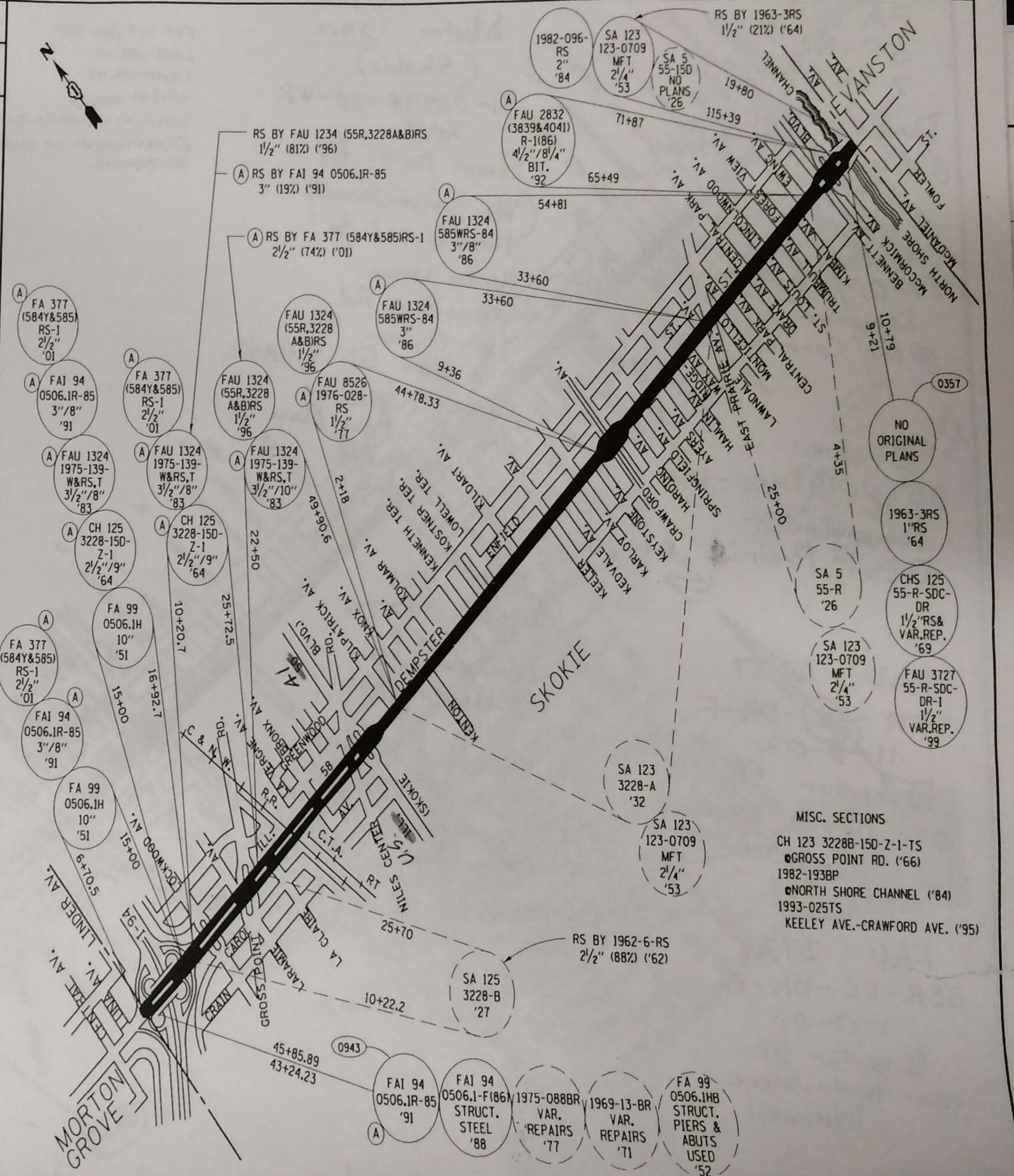

MISC. SECTIONS
 CH 123 3228B-15D-Z-1-TS
 @GROSS POINT RD. ('66)
 1982-193BP
 @NORTH SHORE CHANNEL ('84)
 1993-025TS
 KEELEY AVE.-CRAWFORD AVE. ('95)

FA 58
55-N
7-23-75

Dempster St.
@ Mc Cormick Blvd.

Skokie
77-00138-00-CG
Dempster St.
@ Mc Cormick Blvd.

Skokie
85-00191-00-PK
Dempster St.
@ East Prairie Ave.

FAU 3727
55R-DC-DR-F
11-8-02
Dempster St.
over North Shore
Channel

FAU 3727
55R-DC-DR-B
1-17-03
Dempster St.
over North Shore
Channel

Morton Grove
(Skokie)
01-00098-00-WR
2001
Gross Point Rd.
(We jurisdictionally
transferred to
Morton Grove:
Gross Point Rd.
from Oakton St.
to Main St. 9/18/01.
We are keeping
G.P. Rd. from Main St
to Lincoln Ave
in Skokie

FAP 377
2000-097TS
4-25-03
Dempster St.
@ Hamlin Ave.

VARIOUS
2009-074 I
5-14-10
Erosion control & bridge slope
repair

FAU 2832 | FAP 378
2010-006 TS
1-21-11
TRAFFIC SIGNAL INSTALLATION
VARIOUS INTERSECTIONS DEMPSTER ST.

FAP 377 / FAU 3727
2008-003 RS
DEMPSTER ST.
4/24/09 #60E22
1) US 41 TO MCLORMICK BLVD
2) CHICAGO AVE TO JUDSON AVE
RESURFACING

DISTRICT 1 CITY MAINT. SECT. MORTON GROVE

MISC. SECTIONS

CH 128 128-1113JMFT MAIN DRAIN
 OAKTON ST.(CHICAGO RIVER-
 MENARD AVE.) ('63)
 CH 128 128-1112CF MAIN DRAIN
 OAKTON ST.(WISNER ST.-
 CHICAGO RIVER) ('64)
 1977-339TS
 OAKTON ST. @MENARD AVE. ('79)
 (A) FAU 1332 3072TS
 OAKTON ST. @RIVER DR. ('97)

MARKED ROUTE	CONSTRUCTED AS			TYPE	TOTAL WIDTH	CENTER MAINT. WIDTH	FEET	LANE MILES	
	ROUTE	SECTION	YEAR						
SUB SECTION A99									
OAKTON ST.	CH 128	128-1113MFT	'67-'91 '29-'34	BC-CB	2@21'	2@21'	475	0.36	
OAKTON ST.	CH 128	128-1113MFT	.	BC-CB	2@21'	2@21'	5,698	4.32	
OAKTON ST.	FA 99	0405.1HB	'51-'87	BC-CB	2@21'	2@21'	637	0.48	
OAKTON ST.	FA 99	0405.1HB	'51-'87	BC-CB	2@24'	2@24'	422	0.32	
OAKTON ST.	SA 128	128-1416MFT	'27-'54-'87	BC-CB	2@24'	2@24'	194	0.15	
OAKTON ST.	SA 128	128-1416MFT	'27-'54-'87	BC-CB	42'	42'	1,026	0.78	
OAKTON ST.	FAU 1332	3072A-B-R	'27-'67-'87	IB	57'	57'	86	0.07	
OAKTON ST.	FA 99	0405.1HB	'51-'83	WFIB	2@24'	2@24'	226	0.17	
							TOTAL	8,764	6.65
							TOTAL	8,764	6.65

*=SEE BALLOONS FOR CONSTRUCTION SECTIONS

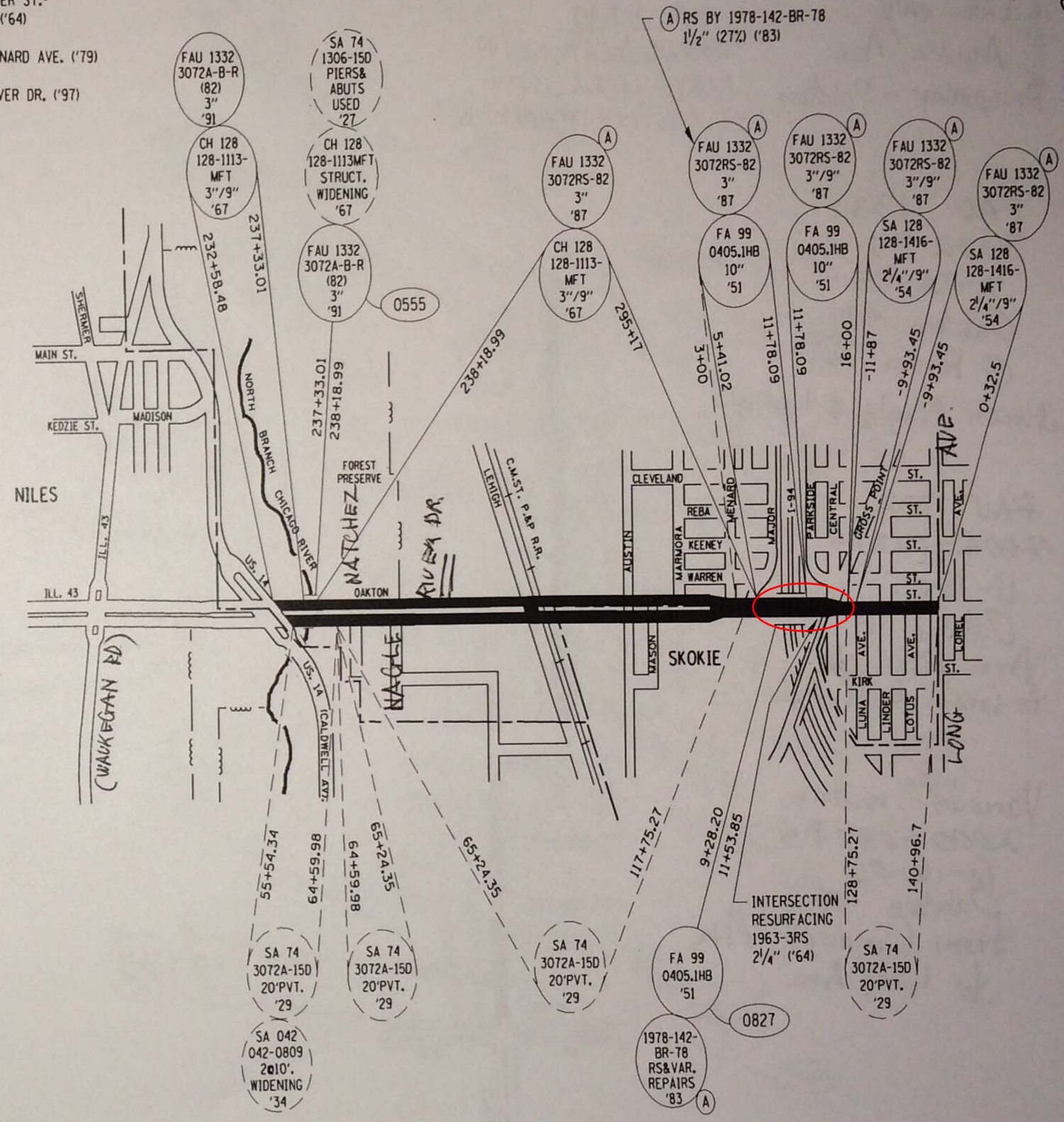

REVISD	APPROVED	COUNTY	MILES
06-01-02		COOK	1.6598
		L.M.	6.65

FAU 2791
1983-181RS
6-27-86
Info only
Austin Ave.
Dempster - Oakton

VARIOUS ROUTES
2011-212-I
04-27-12
VARIOUS LOCATIONS IN
NORTH COCK COUNTY
SCOUR COUNTERMEASURES

FAU 1332
3072 TS
2-24-95
Oakton St.
@ River Dr.
(between Nagle & Lehigh)

FAU 1332
2004-022TS
11-18-05
Oakton St.
from River Dr.
to Gross Point Rd.

Various routes
2000-037RS
6-16-06
Oakton St.
from Caldwell Ave
to Long Ave

FAU SECTION

DATE	TIME	LOCATION	TYPE	STATUS	REMARKS
01-15	07:30	1000	1000	01-15	
01-15	08:00	1000	1000	01-15	
01-15	08:30	1000	1000	01-15	
01-15	09:00	1000	1000	01-15	
01-15	09:30	1000	1000	01-15	
01-15	10:00	1000	1000	01-15	
01-15	10:30	1000	1000	01-15	
01-15	11:00	1000	1000	01-15	
01-15	11:30	1000	1000	01-15	
01-15	12:00	1000	1000	01-15	
01-15	12:30	1000	1000	01-15	
01-15	13:00	1000	1000	01-15	
01-15	13:30	1000	1000	01-15	
01-15	14:00	1000	1000	01-15	
01-15	14:30	1000	1000	01-15	
01-15	15:00	1000	1000	01-15	
01-15	15:30	1000	1000	01-15	
01-15	16:00	1000	1000	01-15	
01-15	16:30	1000	1000	01-15	
01-15	17:00	1000	1000	01-15	
01-15	17:30	1000	1000	01-15	
01-15	18:00	1000	1000	01-15	
01-15	18:30	1000	1000	01-15	
01-15	19:00	1000	1000	01-15	
01-15	19:30	1000	1000	01-15	
01-15	20:00	1000	1000	01-15	
01-15	20:30	1000	1000	01-15	
01-15	21:00	1000	1000	01-15	
01-15	21:30	1000	1000	01-15	
01-15	22:00	1000	1000	01-15	
01-15	22:30	1000	1000	01-15	
01-15	23:00	1000	1000	01-15	
01-15	23:30	1000	1000	01-15	
01-15	00:00	1000	1000	01-15	

ILLINOIS DEPARTMENT OF TRANSPORTATION BUREAU OF MAINTENANCE
 MASTER CROSS REFERENCE ROUTE

11/24/08 10:50
 DTGMPIRD MPIR1RD

MARK / COMM
 ROUTE

S
 C
 ROUTE
 TYPE
 N S
 U U
 M F
 B F
 E I
 R X

* EXTRACTED CONST SEC *
 * B A 1 1 2 2 3 *
 * S I E S E S E *
 * C X U X U X *
 * T F T F T *
 * S R F R F R *
 * E A I A I A *
 * C X X *
 * MICRO TRACING *
 * FILM BOX *
 * REEL *
 * * * * *

LOCATION OF FILES

MARKED PROPOSAL
 PLANS DESIGN
 CONST.
 FINAL
 FILES

* * * * *
 * B C D D K K L M W O *
 * O O E U A E A C I T *
 * O O K P N N K H L H *
 * N K A A E D E E L E *
 * E L G A N R *
 * B E L Y *
 * * * * *
 * 1 2 3 4 5 6 7 8 9 0 *

COMP YR/
 AUTH DATE

* A C
 * G A
 * R R
 * EXD
 * ER
 * MEF
 * EFI
 * N L
 * T E
 * S

MARK / COMM ROUTE	ROUTE TYPE	NS	UU	MF	BF	EI	RX	EXTRACTED CONST SEC	MICRO TRACING	MARKED PLANS	PROPOSAL DESIGN CONST. FINAL FILES	COMP YR/AUTH DATE	STATUS
OAKTON ST	5 FAU	1332						0407	PCCPP	MISS	FLRM		96
OAKTON ST	5 FAU	1332						0407	RS	MISS	CONS	06/07/03	01
OAKTON ST	5 FAU	1332						0407	RS 1				90
OAKTON ST	5 FAU	1332						0808	I 89	0222	FLRM		96 Y
OAKTON ST	5 FAU	1332						1300 B		0280	CONS		05 Y
OAKTON ST	5 FAU	1332						1617 B	R	0373	CONS		87
OAKTON ST	5 FAU	1332						3071	RS 83	0163	FLRM	03/19/04	
OAKTON ST	5 FAU	1332						3071	RS 3				87
OAKTON ST	5 FAU	1332						3071 A	RS 83	0163	FLRM	03/19/04	
OAKTON ST	5 FAU	1332						3071 A	RS 3				97 Y
OAKTON ST	5 FAU	1332						3072	TS	0298	FLRM		87 Y
OAKTON ST	5 FAU	1332						3072	RS 82	0161	FLRM		89
OAKTON ST	5 FAU	1332						3072	RS 2 87	0206	CONS	03/19/04	
OAKTON ST	5 FAU	1332						3072	RS 3				91
OAKTON ST	5 FAU	1332						3072 A	B R 82	0173	FLRM		82
OAKTON ST	5 FAU	1332						3941	TS 80	0152	FLRM		87
OAKTON ST	8 FAU *	1331						1983 169	WRS	P483	BLRS		80
OAKTON ST	8 FAU *	1332						1977 264	TS	0133	FLRM		79
OAKTON ST	8 FAU *	1332						1977 339	TS	0133	FLRM		
OAKTON ST	8 FAU *	1332						1999 144	T			09/27/99	
OAKTON ST	8 VAR *	0000						2000 037	RS				07 Y
OAKTON ST	9 MISC	CITY						75 00109 00	TL	P220	BLRS		80
OAKTON ST	9 MISC	CITY						93 00166 00	BR		CONS	07/02/82	Y
OAKTON ST	9 MISC	CITY						97 00173 00	PV	P989	CONS		02
OAKTON ST	9 MISC	VILL						01 00252 00	BR	0373	CONS		05 Y
OAKTON ST	9 MISC	VILL						77 00014 01	LT		BLRS		94
OAKTON ST	9 MISC	VILL						83 00027 00	WR	P483	BLRS		87
OAKTON ST	9 MISC	VILL						83 00075 00	TL	0161	CONS		87 Y
OAKTON ST	9 MISC	VILL						83 00178 00	TL	0161	CONS		87 Y
OAKTON ST	9 MISC	VILL						97 P4085 00	CH	P998	CONS	05/27/99	
OAKTON ST	9 MISC	VILL						SKIE 43	CS		BLRS		80 Y
OAKTON ST	0 CH	128						128 0808.03		P361	BLRS		68
OAKTON ST	0 CH	128						128 0811		MISS	MISS		67 X
OAKTON ST	0 CH	128						128 0909		MISS	FLRM		56