

SUMMARY OF QUANTITIES

CODE	ITEM DESCRIPTION	UNIT	TOTAL QTY.	FULTON COUNTY	KNOX COUNTY	MARSHALL COUNTY	MCDONOUGH COUNTY	TAZEWELL COUNTY	WOODFORD COUNTY	VARIOUS COUNTIES
				CODE 0021 SAFETY FUNDS 90% FEDERAL 10% STATE URBAN QTY.	CODE 0021 SAFETY FUNDS 90% FEDERAL 10% STATE URBAN QTY.	CODE 0021 SAFETY FUNDS 90% FEDERAL 10% STATE URBAN QTY.	CODE 0021 SAFETY FUNDS 90% FEDERAL 10% STATE URBAN QTY.	CODE 0021 SAFETY FUNDS 90% FEDERAL 10% STATE URBAN QTY.	CODE 0021 SAFETY FUNDS 90% FEDERAL 10% STATE URBAN QTY.	CODE 0021 SAFETY FUNDS 90% FEDERAL 10% STATE URBAN QTY.
42400100	PORTLAND CEMENT CONCRETE SIDEWALK 4 INCH	SQ FT	225.0		125.0			60.0	40.0	
44000600	SIDEWALK REMOVAL	SQ FT	260.0		140.0			70.0	50.0	
67100100	MOBILIZATION	L SUM	1.0							1.0
72000100	SIGN PANEL - TYPE 1	SQ FT	17.6	12.6				5.0		
72800100	TELESCOPING STEEL SIGN SUPPORT	FOOT	34.0					34.0		
81028320	UNDERGROUND CONDUIT, PVC, 1" DIA.	FOOT	520.0	83.0	72.0	39.0	22.0	232.0	72.0	
81028350	UNDERGROUND CONDUIT, PVC, 2" DIA.	FOOT	450.0		24.0			383.0	43.0	
81028370	UNDERGROUND CONDUIT, PVC, 3" DIA.	FOOT	113.0		8.0			105.0		
81400700	HANDHOLE, PORTLAND CEMENT CONCRETE	EACH	5.0					4.0	1.0	
86300400	CONTROLLER CABINET TYPE IV	EACH	16.0	2.0	8.0			6.0		
87301225	ELECTRIC CABLE IN CONDUIT, SIGNAL NO. 14 3C	FOOT	6826.0	230.5	480.5		221.0	5592.5	301.5	
87301245	ELECTRIC CABLE IN CONDUIT, SIGNAL NO. 14 5C	FOOT	9333.0		1568.5	597.0		6845.0	322.5	
87301255	ELECTRIC CABLE IN CONDUIT, SIGNAL NO. 14 7C	FOOT	1085.5	637.0				448.5		
87301900	ELECTRIC CABLE IN CONDUIT, EQUIPMENT GROUNDING CONDUCTOR, NO. 6 1C	FOOT	778.0		43.0			666.5	68.5	
87502450	TRAFFIC SIGNAL POST, GALVANIZED STEEL 11 FT.	EACH	10.0		1.0			8.0	1.0	
87502490	TRAFFIC SIGNAL POST, GALVANIZED STEEL 15 FT.	EACH	2.0					2.0		
87800100	CONCRETE FOUNDATION, TYPE A	FOOT	36.0		3.0			30.0	3.0	
87800200	CONCRETE FOUNDATION, TYPE D	FOOT	10.5		10.5					
87900100	DRILL EXISTING FOUNDATION	EACH	3.0					3.0		
87900200	DRILL EXISTING HANDHOLE	EACH	61.0	8.0	10.0	5.0	7.0	25.0	6.0	
88040070	SIGNAL HEAD, POLYCARBONATE, LED, 1-FACE, 3-SECTION, BRACKET MOUNTED	EACH	2.0					2.0		
88040110	SIGNAL HEAD, POLYCARBONAE, LED, 1-FACE, 4 SECTION, BRACKET MOUNTED	EACH	4.0	4.0						

* = SPECIALTY ITEM

MODEL: D:\dtd\it
 FILE NAME: S:\CEN\HW\DD\DESP\Ankhanon\# AP5168477.DWG ADA Pushbuttons, 2024-1 (08-22-23).dgn

* FULTON, KNOX, MARSHALL, MCDONOUGH, TAZEWELL & WOODFORD COUNTIES NOT TO SCALE

USER NAME = Trevor.Hanson	DESIGNED -	REVISED -
PLOT SCALE = 23.8272' / in.	DRAWN -	REVISED -
PLOT DATE = 8/22/2023	CHECKED -	REVISED -
	DATE -	REVISED -

STATE OF ILLINOIS
DEPARTMENT OF TRANSPORTATION

SUMMARY OF QUANTITIES

SCALE: SHEET OF SHEETS STA. TO STA.

F.A.P. RTE.	SECTION	COUNTY	TOTAL SHEETS	SHEET NO.
VAR. D4 ADA PUSHBUTTONS 2024-1	*		76	5
			CONTRACT NO. 68H77	
ILLINOIS FED. AID PROJECT				

SUMMARY OF QUANTITIES - CONTINUED

CODE	ITEM DESCRIPTION	UNIT	TOTAL QTY.	FULTON COUNTY	KNOX COUNTY	MARSHALL COUNTY	MCDONOUGH COUNTY	TAZEWELL COUNTY	WOODFORD COUNTY	VARIOUS COUNTIES
				CODE 0021 SAFETY FUNDS 90% FEDERAL 10% STATE URBAN QTY.	CODE 0021 SAFETY FUNDS 90% FEDERAL 10% STATE URBAN QTY.	CODE 0021 SAFETY FUNDS 90% FEDERAL 10% STATE URBAN QTY.	CODE 0021 SAFETY FUNDS 90% FEDERAL 10% STATE URBAN QTY.	CODE 0021 SAFETY FUNDS 90% FEDERAL 10% STATE URBAN QTY.	CODE 0021 SAFETY FUNDS 90% FEDERAL 10% STATE URBAN QTY.	
88102825	PEDESTRIAN SIGNAL HEAD, POLYCARBONATE, LED, 1-FACE, BRACKET MOUNTED WITH COUNT DOWN TIMER	EACH	27.0		2.0			23.0	2.0	
88102845	PEDESTRIAN SIGNAL HEAD, POLYCARBONATE, LED, 2-FACE, BRACKET MOUNTED WITH COUNT DOWN TIMER	EACH	3.0					3.0		
88200510	TRAFFIC SIGNAL BACKPLATE, RETROREFLECTIVE	EACH	187.0	35.0	37.0	6.0	31.0	60.0	18.0	
89500100	RELOCATE EXISTING SIGNAL HEAD	EACH	4.0	4.0						
89502210	MODIFY EXISTING CONTROLLER CABINET	EACH	1.0					1.0		
89502220	MODIFY EXISTING CONCRETE FOUNDATION	EACH	1.0					1.0		
X0327739	MISCELLANEOUS ELECTRICAL WORK	L SUM	1.0							1.0
X1400087	SIGNAL HEAD, POLYCARBONATE, LED, 1-FACE, 3-SECTION, MAST ARM MOUNTED (SPECIAL)	EACH	2.0						2.0	
X4402815	ISLAND PAVEMENT REMOVAL AND REPLACEMENT	SQ FT	141.0					101.0	40.0	
X7010216	TRAFFIC CONTROL AND PROTECTION, (SPECIAL)	L SUM	1.0							1.0
X8760200	ACCESSIBLE PEDESTRIAN SIGNALS	EACH	434.0	42.0	94.0	16.0	80.0	176.0	26.0	
X8760201	PEDESTRIAN PUSH-BUTTON POST	EACH	51.0	4.0	7.0	6.0	7.0	22.0	5.0	
X8910050	ILLUMINATED SIGN (SPECIAL)	EACH	13.0	2.0	1.0			9.0	1.0	
X8950212	MODIFY EXISTING CONTROLLER CABINET (SPECIAL)	EACH	1.0	1.0						
Z0025615	FURNISH AND INSTALL METAL SCREEN	EACH	4.0		4.0					
Z0048665	RAILROAD PROTECTIVE LIABILITY INSURANCE	L SUM	1.0				0.5	0.5		
X1400520	THHN WIRE ENCASED IN PVC TUBE, NO. 19/27 AWG	FOOT	8845.5	1082.0	2042.5	328.0	2027.0	3301.0	65.0	
X8860016	SAW CUT FOR ELECTRICAL CABLE INSTALLATION, 5/16"	FOOT	863.0	166.0	234.0		131.0	322.0	10.0	
X8860008	SAW CUT FOR ELECTRICAL CABLE INSTALLATION, 5/8"	FOOT	306.0	19.0	94.0	18.0	79.0	96.0		
X8780302	ANCHOR BOLT SET, 1/2 DIAMETER, WITH WEDGE ANCHORS	EACH	119.0	21.0	29.0	2.0	20.0	45.0	2.0	
X8760002	APS EXTENSION BRACKET	EACH	39.0		6.0	4.0	7.0	18.0	4.0	
X8760203	PEDESTRIAN PUSH-BUTTON POST (NO FOUNDATION)	EACH	119.0	21.0	29.0	2.0	20.0	45.0	2.0	

MODEL: Default
 FILE NAME: S:\CEN\HW\WOODFORD\DESIGN\Ankhanon\# AP5168H77 (D4 ADA Pushbuttons, 2024-1) (08-22-23).dgn

USER NAME = Trevor.Hanson	DESIGNED -	REVISED
DRAWN -	REVISOR	
PLOT SCALE = 23.8272 ' / in.	CHECKED -	REVISED -
PLOT DATE = 8/22/2023	DATE -	REVISED -

STATE OF ILLINOIS
DEPARTMENT OF TRANSPORTATION

SUMMARY OF QUANTITIES - CONTINUED

SCALE: SHEET OF SHEETS STA. TO STA.

* FULTON, KNOX, MARSHALL, MCDONOUGH, TAZEWELL & WOODFORD COUNTIES				NOT TO SCALE	
F.A.P. RTE.	SECTION	COUNTY	TOTAL SHEETS	SHEET NO.	
VAR.	D4 ADA PUSHBUTTONS 2024-1	*	76	6	
			CONTRACT NO. 68H77		
			ILLINOIS FED. AID PROJECT		

42400100 PORTLAND CEMENT CONCRETE SIDEWALK 4 INCH			
COUNTY	CITY	LOCATION	SQ.FT
KNOX	GALESBURG	US 150 (MAIN) & CHERRY	55.0
		US 150 (MAIN) & PRAIRIE	35.0
		US 150 (MAIN) & SEMINARY	35.0
KNOX COUNTY TOTAL			125.0
TAZEWELL	PEKIN	IL 9 (ANN ELIZA) & IL 29 (FIFTH)	60.0
TAZEWELL COUNTY TOTAL			60.0
WOODFORD	METAMORA	IL 116 (MT. VERNON) & IL 89 (NILES)	40.0
WOODFORD COUNTY TOTAL			40.0
TOTAL			225.0

44000600 SIDEWALK REMOVAL			
COUNTY	CITY	LOCATION	SQ.FT
KNOX	GALESBURG	US 150 (MAIN) & CHERRY	60.0
		US 150 (MAIN) & PRAIRIE	40.0
		US 150 (MAIN) & SEMINARY	40.0
KNOX COUNTY TOTAL			140.0
TAZEWELL	PEKIN	IL 9 (ANN ELIZA) & IL 29 (FIFTH)	70.0
TAZEWELL COUNTY TOTAL			70.0
WOODFORD	METAMORA	IL 116 (MT. VERNON) & IL 89 (NILES)	50.0
WOODFORD COUNTY TOTAL			50.0
TOTAL			260.0

72000100 SIGN PANEL - TYPE 1			
COUNTY	CITY	LOCATION	SQ.FT
FULTON	CANTON	IL 9 (LOCUST) & IL 78 (MAIN)	12.6
FULTON COUNTY TOTAL			12.6
TAZEWELL	PEKIN	IL 9 (MARGARET) & IL 29 (THIRD)	5.0
TAZEWELL COUNTY TOTAL			5.0
TOTAL			17.6

72800100 TELESCOPING STEEL SIGN SUPPORT			
COUNTY	CITY	LOCATION	FOOT
TAZEWELL	PEKIN	IL 9 (ANN ELIZA) & IL 29 (FIFTH)	34.0
TAZEWELL COUNTY TOTAL			34.0
TOTAL			34.0

81028320 UNDERGROUND CONDUIT, PVC, 1" DIA.			
COUNTY	CITY	LOCATION	FOOT
FULTON	CANTON	IL 78 (MAIN) & LINCOLN	12.0
		IL 78 (MAIN) & SYCAMORE TERRACE	61.0
		IL 9 (5TH) & CHESTNUT	10.0
FULTON COUNTY TOTAL			83.0
KNOX	GALESBURG	US 150 (HENDERSON) & HOME	5.0
		US 150 (HENDERSON) & DAYTON	18.0
		US 150 (GRAND) & FARNHAM	29.0
		US 150 (HENDERSON) & CARL SANDBURG	20.0
KNOX COUNTY TOTAL			72.0
MARSHALL	LACON	IL 17 (FIFTH) & HIGH	38.0
		IL 17 (FIFTH) & IL 26 (PRAIRIE)	1.0
MARSHALL COUNTY TOTAL			39.0
MCDONOUGH	MACOMB	US 67 (LAFAYETTE) & PIERCE	10.0
		US 67/ US 136 (JACKSON) & PRAIRIE	12.0
MCDONOUGH COUNTY TOTAL			22.0
TAZEWELL	EAST PEORIA	IL 116 & BLACKJACK	16.0
		IL 116 (MAIN) & GOLD/ KROGER ENTRANCE	65.0
		IL 8 (WASHINGTON) & CARVER/ JAY	19.0
		IL 8 (WASHINGTON) & DOLANS	1.0
		IL 8 (WASHINGTON) & FARMDALE/ ILLINI	6.0
		IL 8 (WASHINGTON) & ROSEDALE/ PUTNAM	18.0
	PEKIN	US 150 (MEADOW)/ARNOLD & IL 8 (WASHINGTON)	9.0
		WASHINGTON & TAYLOR/ VETERANS	17.0
		IL 9 (ANN ELIZA) & IL 29 (FIFTH)	3.0
	WASHINGTON	IL 9 (ANN ELIZA) & IL 29 (THIRD)	8.0
		IL 9 (MARGARET) & IL 29 (SECOND)	14.0
		BUS 24 (PEORIA) & WILMOR	16.0
		BUS 24 (WASHINGTON/ PEORIA) & EAGLE	32.0
TAZEWELL COUNTY TOTAL			232.0
WOODFORD	GERMANTOWN HILLS	IL 116 & ARBOR VITAE/ SCHMITT	45.0
		IL 116 & FANDEL/ CATERPILLAR TRAIL	7.0
		US 150 (PEORIA) & IL 117 (EUREKA)	14.0
METAMORA	IL 116 (MT. VERNON) & IL 89 (NILES)	6.0	
	WOODFORD COUNTY TOTAL		
TOTAL			520.0

81028350 UNDERGROUND CONDUIT, PVC, 2" DIA.			
COUNTY	CITY	LOCATION	FOOT
KNOX	GALESBURG	US 150 (HENDERSON) & CARL SANDBURG	24.0
KNOX COUNTY TOTAL			24.0
TAZEWELL	EAST PEORIA	IL 116 & BLACKJACK	48.0
		IL 115 (MAIN) & GOLD/ KROGER ENTRANCE	5.0
		US 150 (MEADOW)/ARNOLD & IL 8 (WASHINGTON)	92.0
	PEKIN	WASHINGTON & TAYLOR/ VETERANS	45.0
		IL 9 (ANN ELIZA) & IL 29 (FIFTH)	108.0
WASHINGTON	IL 9 (MARGARET) & IL 29 (THIRD)	35.0	
TAZEWELL COUNTY TOTAL			383.0
WOODFORD	METAMORA	IL 116 (MT. VERNON) & IL 89 (NILES)	43.0
WOODFORD COUNTY TOTAL			43.0
TOTAL			450.0

81028370 UNDERGROUND CONDUIT, PVC, 3" DIA.			
COUNTY	CITY	LOCATION	FOOT
KNOX	GALESBURG	US 150 (MAIN) & CHERRY	4.0
		US 150 (MAIN) & PRAIRIE	2.0
		US 150 (MAIN) & SEMINARY	2.0
KNOX COUNTY TOTAL			8.0
TAZEWELL	EAST PEORIA	IL 115 (MAIN) & GOLD/ KROGER ENTRANCE	105.0
TAZEWELL COUNTY TOTAL			105.0
TOTAL			113.0

81028350 HANDHOLE, PORTLAND CEMENT CONCRETE			
COUNTY	CITY	LOCATION	EACH
TAZEWELL	EAST PEORIA	IL 116 & BLACKJACK	1.0
		IL 115 (MAIN) & GOLD/ KROGER ENTRANCE	1.0
		US 150 (MEADOW)/ARNOLD & IL 8 (WASHINGTON)	1.0
PEKIN	IL 9 (ANN ELIZA) & IL 29 (FIFTH)	1.0	
TAZEWELL COUNTY TOTAL			4.0
WOODFORD	METAMORA	IL 116 (MT. VERNON) & IL 89 (NILES)	1.0
WOODFORD COUNTY TOTAL			1.0
TOTAL			5.0

86300400 CONTROLLER CABINET TYPE IV			
COUNTY	CITY	LOCATION	EACH
FULTON	CANTON	IL 78 (MAIN) & SYCAMORE TERRACE	1.0
		IL 9 (5TH) & CHESTNUT	1.0
FULTON COUNTY TOTAL			2.0
KNOX	GALESBURG	US 150 (GRAND) & FARNHAM	1.0
		US 150 (HENDERSON) & CARL SANDBURG	1.0
		US 150 (HENDERSON) & FREMONT	1.0
		US 150 (MAIN) & CHERRY	1.0
		US 150 (MAIN) & PRAIRIE	1.0
		US 150 (MAIN) & SEMINARY	1.0
TAZEWELL	EAST PEORIA	US 150 (HENDERSON) & HOME	1.0
		US 150 (HENDERSON) & DAYTON	1.0
		US 150 (HENDERSON) & CHERRY	1.0
WASHINGTON	PEKIN	US 150 (MEADOW)/ARNOLD & IL 8 (WASHINGTON)	1.0
		IL 8 (WASHINGTON) & CARVER/ JAY	1.0
		WASHINGTON & TAYLOR/ VETERANS	1.0
WASHINGTON	IL 8 (WASHINGTON) & FARMDALE/ ILLINI	1.0	
TAZEWELL COUNTY TOTAL			6.0
TOTAL			16.0

87301225 ELECTRIC CABLE IN CONDUIT, SIGNAL NO. 14 3C			
COUNTY	CITY	LOCATION	FOOT
FULTON	CANTON	IL 9 (LOCUST) & IL 78 (MAIN)	230.5
FULTON COUNTY TOTAL			230.5
KNOX	GALESBURG	US 150 (GRAND) & FARNHAM	86.0
		US 150 (HENDERSON) & CARL SANDBURG	253.0
		US 150 (MAIN) & CHERRY	50.5
		US 150 (MAIN) & PRAIRIE	44.5
		US 150 (MAIN) & SEMINARY	46.5
KNOX COUNTY TOTAL			480.5
MCDONOUGH	MACOMB	US 67/ US 136 (CALHOUN) & US 67/ US 136 (CAMPBELL)	221.0
MCDONOUGH COUNTY TOTAL			221.0
TAZEWELL	EAST PEORIA	IL 116 & BLACKJACK	567.0
		IL 116 (MAIN) & GOLD/ KROGER ENTRANCE	563.0
		US 150 (MEADOW)/ARNOLD & IL 8 (WASHINGTON)	700.0
	MORTON	WASHINGTON & TAYLOR/ VETERANS	279.0
		US 150 (JACKSON) & DETROIT	1565.5
		IL 9 (ANN ELIZA) & IL 29 (FIFTH)	1073.5
PEKIN	IL 9 (ANN ELIZA) & IL 29 (THIRD)	256.5	
	IL 9 (MARGARET) & IL 29 (SECOND)	165.0	
	IL 9 (MARGARET) & IL 29 (THIRD)	60.0	
WASHINGTON	US 24 (BOYD) & CUMMINGS	363.0	
TAZEWELL COUNTY TOTAL			5592.5
WOODFORD	METAMORA	IL 116 (MT. VERNON) & IL 89 (NILES)	301.5
WOODFORD COUNTY TOTAL			301.5
TOTAL			6826.0

87301245 ELECTRIC CABLE IN CONDUIT, SIGNAL NO. 14 5C			
COUNTY	CITY	LOCATION	FOOT
KNOX	GALESBURG	US 150 (HENDERSON) & CARL SANDBURG	169.5
		US 150 (MAIN) & CHERRY	422.0
		US 150 (MAIN) & PRAIRIE	427.0
		US 150 (MAIN) & SEMINARY	550.0
KNOX COUNTY TOTAL			1568.5
MARSHALL	LACON	IL 17 (FIFTH) & HIGH	364.0
		IL 17 (FIFTH) & IL 26 (PRAIRIE)	233.0
MARSHALL COUNTY TOTAL			597.0
TAZEWELL	EAST PEORIA	IL 116 & BLACKJACK	407.5
		IL 116 (MAIN) & GOLD/ KROGER ENTRANCE	1014.5
		US 150 (MEADOW)/ARNOLD & IL 8 (WASHINGTON)	1168.5
	MORTON	WASHINGTON & TAYLOR/ VETERANS	294.0
		US 150 (JACKSON) & DETROIT	1076.0
		IL 9 (ANN ELIZA) & IL 29 (FIFTH)	480.5
PEKIN	IL 9 (ANN ELIZA) & IL 29 (THIRD)	226.5	
	IL 9 (MARGARET) & IL 29 (THIRD)	922.0	
	IL 9/ IL 29 (MARGARET) & CAPITOL	415.0	
WASHINGTON	IL 9/ IL 29 (MARGARET) & FOURTH	386.5	
	IL 9/ IL 29 (MARGARET) & IL 29 (FIFTH)	354.0	
WASHINGTON	US 24 (BOYD) & CUMMINGS	100.0	
TAZEWELL COUNTY TOTAL			6845.0
WOODFORD	METAMORA	IL 116 (MT. VERNON) & IL 89 (NILES)	322.5
WOODFORD COUNTY TOTAL			322.5
TOTAL			9333.0

87301255 ELECTRIC CABLE IN CONDUIT, SIGNAL NO. 14 7C			
COUNTY	CITY	LOCATION	FOOT
FULTON	CANTON	IL 9 (LOCUST) & IL 78 (MAIN)	637.0
FULTON COUNTY TOTAL			637.0
TAZEWELL	EAST PEORIA	IL 116 (MAIN) & GOLD/ KROGER ENTRANCE	448.5
TAZEWELL COUNTY TOTAL			448.5
TOTAL			1085.5

87301900 ELECTRIC CABLE IN CONDUIT, EQUIPMENT GROUNDING CONDUCTOR, NO. 6 1C			
COUNTY	CITY	LOCATION	FOOT
KNOX	GALESBURG	US 150 (HENDERSON) & CARL SANDBURG	43.0
KNOX COUNTY TOTAL			43.0
TAZEWELL	EAST PEORIA	IL 116 & BLACKJACK	70.5
		IL 116 (MAIN) & GOLD/ KROGER ENTRANCE	132.5
		US 150 (MEADOW)/ARNOLD & IL 8 (WASHINGTON)	140.0
	PEKIN	WASHINGTON & TAYLOR/ VETERANS	54.5
		IL 9 (ANN ELIZA) & IL 29 (FIFTH)	146.0
WASHINGTON	IL 9 (MARGARET) & IL 29 (THIRD)	54.0	
WASHINGTON	US 24 (BOYD) & CUMMINGS	69.0	
TAZEWELL COUNTY TOTAL			666.5
WOODFORD	METAMORA	IL 116 (MT. VERNON) & IL 89 (NILES)	68.5
WOODFORD COUNTY TOTAL			68.5
TOTAL			778.0

87502450 TRAFFIC SIGNAL POST, GALVANIZED STEEL 11 FT.			
COUNTY	CITY	LOCATION	EACH
KNOX	GALESBURG	US 150 (HENDERSON) & CARL SANDBURG	1.0
KNOX COUNTY TOTAL			1.0
TAZEWELL	EAST PEORIA	IL 116 & BLACKJACK	1.0
		IL 116 (MAIN) & GOLD/ KROGER ENTRANCE	1.0
		US 150 (MEADOW)/ARNOLD & IL 8 (WASHINGTON)	1.0
	PEKIN	WASHINGTON & TAYLOR/ VETERANS	1.0
		IL 9 (ANN ELIZA) & IL 29 (FIFTH)	2.0
WASHINGTON	IL 9 (MARGARET) & IL 29 (THIRD)	1.0	
WASHINGTON	US 24 (BOYD) & CUMMINGS	1.0	
TAZEWELL COUNTY TOTAL			8.0
WOODFORD	METAMORA	IL 116 (MT. VERNON) & IL 89 (NILES)	1.0
WOODFORD COUNTY TOTAL			1.0
TOTAL			10.0

87502490 TRAFFIC SIGNAL POST, GALVANIZED STEEL 15 FT.			
COUNTY	CITY	LOCATION	EACH
TAZEWELL	EAST PEORIA	US 150 (MEADOW)/ARNOLD & IL 8 (WASHINGTON)	2.0
TAZEWELL COUNTY TOTAL			2.0
TOTAL			2.0

87800150 CONCRETE FOUNDATION, TYPE A			
COUNTY	CITY	LOCATION	FOOT
KNOX	GALESBURG	US 150 (HENDERSON) & CARL SANDBURG	3.0
KNOX COUNTY TOTAL			3.0
TAZEWELL	EAST PEORIA	IL 116 & BLACKJACK	3.0
		IL 116 (MAIN) & GOLD/ KROGER ENTRANCE	3.0
		US 150 (MEADOW)/ARNOLD & IL 8 (WASHINGTON)	9.0
	PEKIN	WASHINGTON & TAYLOR/ VETERANS	3.0
		IL 9 (ANN ELIZA) & IL 29 (FIFTH)	6.0
WASHINGTON	IL 9 (MARGARET) & IL 29 (THIRD)	3.0	
WASHINGTON	US 24 (BOYD) & CUMMINGS	3.0	
TAZEWELL COUNTY TOTAL			30.0
WOODFORD	METAMORA	IL 116 (MT. VERNON) & IL 89 (NILES)	3.0
WOODFORD COUNTY TOTAL			3.0
TOTAL			36.0

87800200 CONCRETE FOUNDATION, TYPE D			
COUNTY	CITY	LOCATION	FOOT
KNOX	GALESBURG	US 150 (MAIN) & CHERRY	3.5
		US 150 (MAIN) & PRAIRIE	3.5
		US 150 (MAIN) & SEMINARY	3.5
KNOX COUNTY TOTAL			10.5
TOTAL			10.5

87900100 DRILL EXISTING FOUNDATION			
COUNTY	CITY	LOCATION	EACH
TAZEWELL	PEKIN	IL 9 (ANN ELIZA) & IL 29 (FIFTH)	1.0
		IL 9 (MARGARET) & IL 29 (SECOND)	1.0
		BUS 24 (WASHINGTON/ PEORIA) & EAGLE	1.0
WASHINGTON	US 24 (WASHINGTON/ PEORIA) & EAGLE	1.0	
TAZEWELL COUNTY TOTAL			3.0
TOTAL			3.0

MODEL: D:\d4\11... FILE NAME: S:\CEN\W\W0305\SP\AM\hanson\#_Completed_Contract\045_68176_and_68177\080177_04_ADA_PushButtons_2024-11_11-01-23.dgn

USER NAME = trevor.hanson	DESIGNED -	REVISED - 11-01-23 TJH
PLOT SCALE = 23.8272' / in.	DRAWN -	REVISED -
PLOT DATE = 11/1/2023	CHECKED -	REVISED -
	DATE -	REVISED -

**STATE OF ILLINOIS
DEPARTMENT OF TRANSPORTATION**

SCHEDULE OF QUANTITIES

87900200				
DRILL EXISTING HANDHOLE				
COUNTY	CITY	LOCATION	EACH	
FULTON	CANTON	IL 78 (MAIN) & LINCOLN	2.0	
		IL 78 (MAIN) & SYCAMORE TERRACE	4.0	
		IL 9 (5TH) & CHESTNUT	2.0	
FULTON COUNTY TOTAL			8.0	
KNOX	GALESBURG	US 150 (HENDERSON) & HOME	2.0	
		US 150 (HENDERSON) & DAYTON	2.0	
		US 150 (GRAND) & FARNHAM	3.0	
		US 150 (HENDERSON) & CARL SANDBURG	3.0	
KNOX COUNTY TOTAL			10.0	
MARSHALL	LACON	IL 17 (FIFTH) & HIGH	4.0	
		IL 17 (FIFTH) & IL 26 (PRAIRIE)	1.0	
MARSHALL COUNTY TOTAL			5.0	
MCDONOUGH	MACOMB	US 67 (LAFAYETTE) & PIERCE	4.0	
		US 67/ US 136 (JACKSON) & PRAIRIE	3.0	
MCDONOUGH COUNTY TOTAL			7.0	
TAZEWELL	EAST PEORIA	IL 116 & BLACKJACK	1.0	
		IL 116 (MAIN) & GOLD/ KROGER ENTRANCE	3.0	
		IL 8 (WASHINGTON) & CARVER/ JAY	2.0	
		IL 8 (WASHINGTON) & DOLANS	1.0	
		IL 8 (WASHINGTON) & FARMDALE/ ILLINI	1.0	
	PEKIN	IL 8 (WASHINGTON) & ROSEDALE/ PUTNAM	2.0	
		US 150 (MEADOW)/ARNOLD & IL 8 (WASHINGTON)	3.0	
		WASHINGTON & TAYLOR/ VETERANS	2.0	
		IL 9 (ANN ELIZA) & IL 29 (FIFTH)	1.0	
		IL 9 (ANN ELIZA) & THIRD	1.0	
WASHINGTON	IL 9 (MARGARET) & IL 29 (SECOND)	1.0		
	BUS 24 (PEORIA) & WILMOR	3.0		
	BUS 24 (WASHINGTON/ PEORIA) & EAGLE	1.0		
	IL 8 (WASHINGTON) & SCHOOL	1.0		
TAZEWELL COUNTY TOTAL			25.0	
WOODFORD	METAMORA	IL 116 & ARBOR VITAE/ SCHMITT	1.0	
		IL 116 & FANDEL/ CATERPILLAR TRAIL	3.0	
		US 150 (PEORIA) & IL 117 (EUREKA)	1.0	
WOODFORD COUNTY TOTAL			6.0	
TOTAL				61.0

88040070				
SIGNAL HEAD, POLYCARBONATE, LED, 1-FACE, 3-SECTION, BRACKET MOUNTED				
COUNTY	CITY	LOCATION	EACH	
TAZEWELL	EAST PEORIA	US 150 (MEADOW)/ARNOLD & IL 8 (WASHINGTON)	2.0	
TAZEWELL COUNTY TOTAL			2.0	
TOTAL				2.0

88040110				
SIGNAL HEAD, POLYCARBONATE, LED, 1-FACE, 4-SECTION, BRACKET MOUNTED				
COUNTY	CITY	LOCATION	EACH	
FULTON	CANTON	IL 9 (LOCUST) & IL 78 (MAIN)	4.0	
FULTON COUNTY TOTAL			4.0	
TOTAL				4.0

88102825				
PEDESTRIAN SIGNAL HEAD, POLYCARBONATE, LED, 1-FACE, BRACKET MOUNTED WITH COUNT DOWN TIMER				
COUNTY	CITY	LOCATION	EACH	
KNOX	GALESBURG	US 150 (HENDERSON) & CARL SANDBURG	2.0	
KNOX COUNTY TOTAL			2.0	
TAZEWELL	EAST PEORIA	IL 116 & BLACKJACK	2.0	
		IL 116 (MAIN) & GOLD/ KROGER ENTRANCE	3.0	
		US 150 (MEADOW)/ARNOLD & IL 8 (WASHINGTON)	4.0	
	MORTON	WASHINGTON & TAYLOR/ VETERANS	2.0	
		US 150 (JACKSON) & DETROIT	4.0	
		IL 9 (ANN ELIZA) & IL 29 (FIFTH)	4.0	
PEKIN	IL 9 (MARGARET) & IL 29 (THIRD)	2.0		
	US 24 (BOYD) & CUMMINGS	2.0		
TAZEWELL COUNTY TOTAL			23.0	
WOODFORD	METAMORA	IL 116 (MT. VERNON) & IL 89 (NILES)	2.0	
WOODFORD COUNTY TOTAL			2.0	
TOTAL				27.0

88102845				
PEDESTRIAN SIGNAL HEAD, POLYCARBONATE, LED, 2-FACE, BRACKET MOUNTED WITH COUNT DOWN TIMER				
COUNTY	CITY	LOCATION	EACH	
TAZEWELL	EAST PEORIA	IL 116 (MAIN) & GOLD/ KROGER ENTRANCE	1.0	
TAZEWELL COUNTY TOTAL			3.0	
TOTAL				3.0

88200510					
TRAFFIC SIGNAL BACKPLATE, RETROREFLECTIVE					
COUNTY	CITY	LOCATION	EACH		
FULTON	CANTON	IL 78 (MAIN) & LINCOLN	3.0		
		IL 78 (MAIN) & SYCAMORE TERRACE	5.0		
		IL 9 (5TH) & CHESTNUT	7.0		
		IL 9 (LOCUST) & 1ST	8.0		
		IL 9 (LOCUST) & IL 78 (MAIN)	12.0		
FULTON COUNTY TOTAL			35.0		
KNOX	GALESBURG	US 150 (GRAND) & FARNHAM	2.0		
		US 150 (HENDERSON) & CARL SANDBURG	9.0		
		US 150 (HENDERSON) & FREMONT	4.0		
		US 150 (MAIN) & ACADEMY	6.0		
		US 150 (MAIN) & KELLOGG	4.0		
		US 150 (HENDERSON) & HOME	6.0		
KNOX COUNTY TOTAL			37.0		
MARSHALL	LACON	IL 17 (FIFTH) & HIGH	2.0		
		IL 17 (FIFTH) & IL 26 (PRAIRIE)	4.0		
MARSHALL COUNTY TOTAL			6.0		
MCDONOUGH	GOOD HOPE	US 67 (MONMOUTH) & MAIN/ 1900TH	2.0		
		US 136 (JACKSON) & US 136 (JOHNSON)	8.0		
		US 67 (LAFAYETTE) & PIERCE	6.0		
		US 67/ US 136 (CALHOUN) & US 67 (LAFAYETTE)	5.0		
		US 67/ US 136 (CALHOUN) & US 67/ US 136 (CAMPBELL)	5.0		
	MACOMB	US 67/ US 136 (JACKSON) & DUDLEY	1.0		
		US 67/ US 136 (JACKSON) & PRAIRIE	4.0		
		MCDONOUGH COUNTY TOTAL			31.0
		TAZEWELL	EAST PEORIA	IL 116 (MAIN) & GOLD/ KROGER ENTRANCE	5.0
				IL 8 (WASHINGTON) & CARVER/ JAY	5.0
IL 8 (WASHINGTON) & DOLANS	2.0				
IL 8 (WASHINGTON) & FARMDALE/ ILLINI	5.0				
IL 8 (WASHINGTON) & ROSEDALE/ PUTNAM	1.0				
MORTON	US 150 (MEADOW)/ARNOLD & IL 8 (WASHINGTON)		5.0		
	WASHINGTON & TAYLOR/ VETERANS		4.0		
	MORTON & BOND		2.0		
	US 150 (JACKSON) & VETERANS		4.0		
	IL 29 (EIGHTH) & SHERIDAN		6.0		
PEKIN	IL 9/ IL 29 (MARGARET) & CAPITOL	2.0			
	IL 9/ IL 29 (MARGARET) & FOURTH	2.0			
	IL 9/ IL 29 (MARGARET) & IL 29 (FIFTH)	2.0			
	BUS 24 (PEORIA) & WILMOR	2.0			
	IL 8 (WASHINGTON) & SCHOOL	7.0			
WASHINGTON	IL 8 (WASHINGTON) & SCHOOL	4.0			
	IL 8 (WASHINGTON) & SUMMIT	4.0			
	US 24 (BOYD) & CUMMINGS	2.0			
TAZEWELL COUNTY TOTAL			60.0		
WOODFORD	METAMORA	EUREKA	8.0		
		IL 116 & ARBOR VITAE/ SCHMITT	2.0		
		US 150 (PEORIA) & IL 117 (EUREKA)	4.0		
WOODFORD COUNTY TOTAL			18.0		
TOTAL				187.0	

89502210				
MODIFY EXISTING CONTROLLER CABINET				
COUNTY	CITY	LOCATION	EACH	
TAZEWELL	EAST PEORIA	IL 116 (MAIN) & GOLD/ KROGER ENTRANCE	1.0	
TAZEWELL COUNTY TOTAL			1.0	
TOTAL				1.0

89502220				
MODIFY EXISTING CONCRETE FOUNDATION				
COUNTY	CITY	LOCATION	EACH	
TAZEWELL	PEKIN	IL 9 (ANN ELIZA) & IL 29 (FIFTH)	1.0	
TAZEWELL COUNTY TOTAL			1.0	
TOTAL				1.0

89500100				
RELOCATE EXISTING SIGNAL HEAD				
COUNTY	CITY	LOCATION	EACH	
FULTON	CANTON	IL 9 (LOCUST) & IL 78 (MAIN)	4.0	
FULTON COUNTY TOTAL			4.0	
TOTAL				4.0

X1400520					
THHN WIRE ENCASED IN PVC TUBE, NO. 19/27 AWG					
COUNTY	CITY	LOCATION	FOOT		
FULTON	CANTON	IL 9 (5TH) & CHESTNUT	186.0		
		IL 9 (LOCUST) & 1ST	434.0		
		IL 9 (LOCUST) & IL 78 (MAIN)	462.0		
FULTON COUNTY TOTAL			1082.0		
KNOX	ABINGDON	IL 41 (MONROE) & LATIMER	399.0		
		US 150 (GRAND) & FARNHAM	54.5		
		US 150 (HENDERSON) & CARL SANDBURG	199.0		
		US 150 (HENDERSON) & FREMONT	140.0		
		US 150 (MAIN) & ACADEMY	242.0		
	GALESBURG	US 150 (MAIN) & CHERRY	273.0		
		US 150 (MAIN) & KELLOGG	142.0		
		US 150 (MAIN) & PRAIRIE	259.0		
		US 150 (MAIN) & SEMINARY	277.0		
		US 150 (HENDERSON) & DAYTON	57.0		
KNOX COUNTY TOTAL			2042.5		
MARSHALL	LACON	IL 17 (FIFTH) & IL 26 (PRAIRIE)	328.0		
MARSHALL COUNTY TOTAL			328.0		
MCDONOUGH	MACOMB	US 136 (JACKSON) & US 136 (JOHNSON)	338.0		
		US 67/ US 136 (CALHOUN) & US 67 (LAFAYETTE)	311.0		
		US 67/ US 136 (CALHOUN) & US 67/ US 136 (CAMPBELL)	304.0		
		US 67/ US 136 (JACKSON) & DUDLEY	686.0		
		US 67/ US 136 (JACKSON) & US 67/ US 136 (CAMPBELL)	388.0		
		MCDONOUGH COUNTY TOTAL			2027.0
		TAZEWELL	EAST PEORIA	IL 8 (WASHINGTON) & FARMDALE/ ILLINI	129.0
US 150 (MEADOW)/ARNOLD & IL 8 (WASHINGTON)	333.0				
PEKIN	IL 9 (ANN ELIZA) & IL 29 (FIFTH)		493.0		
	IL 9 (ANN ELIZA) & THIRD		216.0		
WASHINGTON	IL 9 (MARGARET) & IL 29 (THIRD)	185.0			
	IL 9/ IL 29 (MARGARET) & FOURTH	224.0			
	IL 9/ IL 29 (MARGARET) & IL 29 (FIFTH)	182.0			
	IL 8 (WASHINGTON) & SCHOOL	422.0			
TAZEWELL COUNTY TOTAL			3301.0		
WOODFORD	METAMORA	IL 116 (MT. VERNON) & IL 89 (NILES)	65.0		
WOODFORD COUNTY TOTAL			65.0		
TOTAL				8845.5	

X8860016				
SAW CUT FOR ELECTRICAL CABLE INSTALLATION, 5/16"				
COUNTY	CITY	LOCATION	FOOT	
FULTON	CANTON	IL 9 (LOCUST) & 1ST	88.0	
		IL 9 (LOCUST) & IL 78 (MAIN)	78.0	
FULTON COUNTY TOTAL			166.0	
KNOX	GALESBURG	US 150 (GRAND) & FARNHAM	30.0	
		US 150 (HENDERSON) & CARL SANDBURG	26.0	
		US 150 (MAIN) & CHERRY	47.0	
		US 150 (MAIN) & KELLOGG	35.0	
		US 150 (MAIN) & PRAIRIE	43.0	
KNOX COUNTY TOTAL			234.0	
MCDONOUGH	MACOMB	US 136 (JACKSON) & US 136 (JOHNSON)	33.0	
		US 67/ US 136 (CALHOUN) & US 67 (LAFAYETTE)	21.0	
		US 67/ US 136 (CALHOUN) & US 67/ US 136 (CAMPBELL)	39.0	
		US 67/ US 136 (JACKSON) & US 67/ US 136 (CAMPBELL)	38.0	
MCDONOUGH COUNTY TOTAL			131.0	
TAZEWELL	EAST PEORIA	IL 8 (WASHINGTON) & FARMDALE/ ILLINI	35.0	
		US 150 (MEADOW)/ARNOLD & IL 8 (WASHINGTON)	65.0	
	MORTON	WASHINGTON & TAYLOR/ VETERANS	15.0	
		US 150 (JACKSON) & DETROIT	26.0	
	PEKIN	IL 9 (ANN ELIZA) & IL 29 (FIFTH)	36.0	
		IL 9 (ANN ELIZA) & THIRD	32.0	
		IL 9 (MARGARET) & IL 29 (THIRD)	22.0	
		IL 8 (WASHINGTON) & SCHOOL	44.0	
		IL 8 (WASHINGTON) & SUMMIT	30.0	
		US 24 (BOYD) & CUMMINGS	17.0	
TAZEWELL COUNTY TOTAL			322.0	
WOODFORD	METAMORA	IL 116 (MT. VERNON) & IL 89 (NILES)	10.0	
WOODFORD COUNTY TOTAL			10.0	
TOTAL				863.0

X8860008				
SAW CUT FOR ELECTRICAL CABLE INSTALLATION, 5/8"				
COUNTY	CITY	LOCATION	FOOT	
FULTON	CANTON	IL 9 (5TH) & CHESTNUT	19.0	
FULTON COUNTY TOTAL			19.0	
KNOX	GALESBURG	IL 41 (MONROE) & LATIMER	47.0	
		US 150 (HENDERSON) & FREMONT	13.0	
		US 150 (MAIN) & ACADEMY	27.0	
KNOX COUNTY TOTAL			94.0	
MARSHALL	LACON	IL 17 (FIFTH) & IL 26 (PRAIRIE)	18.0	
MARSHALL COUNTY TOTAL			18.0	
MCDONOUGH	MACOMB	US 136 (JACKSON) & US 136 (JOHNSON)	3.0	
		US 67/ US 136 (CALHOUN) & US 67 (LAFAYETTE)	20.0	
		US 67/ US 136 (CALHOUN) & US 67/ US 136 (CAMPBELL)	16.0	
		US 67/ US 136 (JACKSON) & DUDLEY	40.0	
MCDONOUGH COUNTY TOTAL			79.0	
TAZEWELL	PEKIN	IL 8 (WASHINGTON) & ROSEDALE/ PUTNAM	14.0	
		IL 29 (EIGHTH) & SHERIDAN	31.0	
		IL 9 (ANN ELIZA) & IL 29 (FIFTH)	20.0	
		IL 9/ IL 29 (MARGARET) & FOURTH	6.0	
		IL 9/ IL 29 (MARGARET) & IL 29 (FIFTH)	4.0	
WASHINGTON	IL 8 (WASHINGTON) & SCHOOL	19.0		
	IL 8 (WASHINGTON) & SUMMIT	2.0		
TAZEWELL COUNTY TOTAL			96.0	
TOTAL				306.0

X8780302			
ANCHOR BOLT SET, 1/2 DIAMETER, WITH WEDGE ANCHORS			
COUNTY	CITY	LOCATION	EACH
FULTON	CANTON	IL 78 (MAIN) & LINCOLN	2.0
		IL 78 (MAIN) & SYCAMORE TERRACE	1.0
		IL 9 (5TH) & CHESTNUT	3.0
		IL 9 (LOCUST) & 1ST	7.0
		IL 9 (LOCUST) & IL 78 (MAIN)	8.0
FULTON COUNTY TOTAL			21.0
KNOX	ABINGDON	IL 41 (MONROE) & LATIMER	4.0
		US 150 (GRAND) & FARNHAM	1.0
		US 150 (HENDERSON) & CARL SANDBURG	5.0
		US 150 (HENDERSON) & FREMONT	1.0
		US 150 (MAIN) & ACADEMY	3.0
	GALESBURG	US 150 (MAIN) & CHERRY	4.0
		US 150 (MAIN) & KELLOGG	2.0
		US 150 (MAIN) & PRAIRIE	4.0
		US 150 (MAIN) & SEMINARY	4.0
		US 150 (HENDERSON) & DAYTON	1.0
KNOX COUNTY TOTAL			29.0
MARSHALL	LACON	IL 17 (FIFTH) & IL 26 (PRAIRIE)	2.0
MARSHALL COUNTY TOTAL			2.0
MCDONOUGH	MACOMB	US 136 (JACKSON) & US 136 (JOHNSON)	4.0
		US 67/ US 136 (CALHOUN) & US 67 (LAFAYETTE)	5.0
		US 67/ US 136 (CALHOUN) & US 67/ US 136 (CAMPBELL)	4.0
		US 67/ US 136 (JACKSON) & DUDLEY	4.0
		US 67/ US 136 (JACKSON) & US 67/ US 136 (CAMPBELL)	3.0
MCDONOUGH COUNTY TOTAL			20.0
TAZEWELL	EAST PEORIA	IL 8 (WASHINGTON) & FARMDALE/ ILLINI	1.0
		IL 8 (WASHINGTON) & ROSEDALE/ PUTNAM	1.0
		US 150 (MEADOW)/ARNOLD & IL 8 (WASHINGTON)	5.0
	MORTON	WASHINGTON & TAYLOR/ VETERANS	2.0
		US 150 (JACKSON) & DETROIT	3.0
		IL 29 (EIGHTH) & SHERIDAN	3.0
	PEKIN	IL 9 (ANN ELIZA) & IL 29 (FIFTH)	7.0
		IL 9 (ANN ELIZA) & THIRD	3.0
		IL 9 (MARGARET) & IL 29 (THIRD)	3.0
		IL 9/ IL 29 (MARGARET) & FOURTH	2.0
WASHINGTON	IL 9/ IL 29 (MARGARET) & IL 29 (FIFTH)	2.0	
	BUS 24 (WASHINGTON/ PEORIA) & EAGLE	2.0	

X876002 APS EXTENSION BRACKET				
COUNTY	CITY	LOCATION	EACH	
KNOX	GALESBURG	US 150 (HENDERSON) & HOME	4.0	
		US 150 (HENDERSON) & FREMONT	2.0	
KNOX COUNTY TOTAL			6.0	
MARSHALL	LACON	IL 17 (FIFTH) & IL 26 (PRAIRIE)	4.0	
MARSHALL COUNTY TOTAL			4.0	
MCDONOUGH	GOOD HOPE	US 67 (MONMOUTH) & MAIN/ 1900TH	4.0	
	MACOMB	US 136 (JACKSON) & US 136 (JOHNSON)	2.0	
MCDONOUGH COUNTY TOTAL			7.0	
TAZEVELL	EAST PEORIA	IL 116 & BLACKJACK	1.0	
		IL 8 (WASHINGTON) & FARMDALE/ ILLINI	2.0	
	MORTON	MORTON & BOND	2.0	
		US 150 (JACKSON) & DETROIT	7.0	
		US 150 (JACKSON) & VETERANS	1.0	
	PEKIN	IL 9 (ANN ELIZA) & IL 29 (SECOND)	2.0	
		IL 9 (ANN ELIZA) & THIRD	1.0	
		IL 9/ IL 29 (MARGARET) & CAPITOL	2.0	
		TAZEVELL COUNTY TOTAL		18.0
		WOODFORD	EUREKA	US 24 (CENTER) & IL 117 (MAIN)
GERMANTOWN HILLS	IL 116 & ARBOR VITAE/ SCHMITT		1.0	
GOODFIELD	US 150 (PEORIA) & IL 117 (EUREKA)		1.0	
WOODFORD COUNTY TOTAL			4.0	
TOTAL			39.0	

X1400087 SIGNAL HEAD, POLYCARBONATE, LED, 1-FACE, 3-SECTION, MAST ARM MOUNTED (SPECIAL)			
COUNTY	CITY	LOCATION	EACH
WOODFORD	GERMANTOWN HILLS	IL 116 & ARBOR VITAE/ SCHMITT	2.0
WOODFORD COUNTY TOTAL			2.0
TOTAL			2.0

X4402815 ISLAND PAVEMENT REMOVAL AND REPLACEMENT			
COUNTY	CITY	LOCATION	SQ. FT.
TAZEVELL	EAST PEORIA	IL 116 & BLACKJACK	65.0
		WASHINGTON & TAYLOR/ VETERANS	36.0
TAZEVELL COUNTY TOTAL			101.0
WOODFORD	METAMORA	IL 116 (MT. VERNON) & IL 89 (NILES)	40.0
WOODFORD COUNTY TOTAL			40.0
TOTAL			141.0

X8760200 ACCESSIBLE PEDESTRIAN SIGNALS				
COUNTY	CITY	LOCATION	EACH	
FULTON	CANTON	IL 78 (MAIN) & LINCOLN	4.0	
		IL 78 (MAIN) & SYCAMORE TERRACE	6.0	
		IL 9 (5TH) & CHESTNUT	8.0	
		IL 9 (LOCUST) & 1ST	8.0	
		IL 9 (LOCUST) & IL 78 (MAIN)	8.0	
LEWISTOWN		US 24/ IL 97/ IL 100 (MAIN) & US 24/ IL 97 (AVE. E)	8.0	
		FULTON COUNTY TOTAL		42.0
KNOX	GALESBURG	IL 41 (MONROE) & LATIMER	8.0	
		US 150 (GRAND) & FARNHAM	8.0	
		US 150 (HENDERSON) & CARL SANDBURG	6.0	
		US 150 (HENDERSON) & FREMONT	8.0	
		US 150 (MAIN) & ACADEMY	8.0	
		US 150 (MAIN) & CHAMBERS	8.0	
		US 150 (MAIN) & CHERRY	8.0	
		US 150 (MAIN) & KELLOGG	8.0	
		US 150 (MAIN) & PRAIRIE	8.0	
		US 150 (MAIN) & SEMINARY	8.0	
KNOX COUNTY TOTAL			94.0	
MARSHALL	LACON	IL 17 (FIFTH) & HIGH	8.0	
		IL 17 (FIFTH) & IL 26 (PRAIRIE)	8.0	
MARSHALL COUNTY TOTAL			16.0	
MCDONOUGH	MACOMB	GOOD HOPE	US 67 (MONMOUTH) & MAIN/ 1900TH	8.0
		US 136 (JACKSON) & US 136 (JOHNSON)	10.0	
		US 67 (LAFAYETTE) & PIERCE	8.0	
		US 67/ US 136 (CALHOUN) & US 67 (LAFAYETTE)	10.0	
		US 67/ US 136 (CALHOUN) & US 67/ US 136 (CAMPBELL)	10.0	
		US 67/ US 136 (JACKSON) & BOWER	8.0	
		US 67/ US 136 (JACKSON) & DUDLEY	8.0	
		US 67/ US 136 (JACKSON) & PRAIRIE	8.0	
		US 67/ US 136 (JACKSON) & US 67/ US 136 (CAMPBELL)	10.0	
		MCDONOUGH COUNTY TOTAL		

X8760201 PEDESTRIAN PUSH-BUTTON POST			
COUNTY	CITY	LOCATION	EACH
FULTON	CANTON	IL 78 (MAIN) & SYCAMORE TERRACE	3.0
		IL 9 (5TH) & CHESTNUT	1.0
FULTON COUNTY TOTAL			4.0
KNOX	GALESBURG	US 150 (GRAND) & FARNHAM	3.0
		US 150 (HENDERSON) & HOME	2.0
		US 150 (HENDERSON) & DAYTON	2.0
KNOX COUNTY TOTAL			7.0
MARSHALL	LACON	IL 17 (FIFTH) & HIGH	5.0
		IL 17 (FIFTH) & IL 26 (PRAIRIE)	1.0
MARSHALL COUNTY TOTAL			6.0
MCDONOUGH	MACOMB	US 67 (LAFAYETTE) & PIERCE	4.0
		US 67/ US 136 (JACKSON) & PRAIRIE	3.0
MCDONOUGH COUNTY TOTAL			7.0
TAZEVELL	EAST PEORIA	IL 116 & BLACKJACK	2.0
		IL 116 (MAIN) & GOLD/ KROGER ENTRANCE	3.0
		IL 8 (WASHINGTON) & CARVER/ JAY	2.0
		IL 8 (WASHINGTON) & DOLANS	1.0
		IL 8 (WASHINGTON) & FARMDALE/ ILLINI	1.0
		IL 8 (WASHINGTON) & ROSEDALE/ PUTNAM	2.0
		US 150 (MEADOW)/ARNOLD & IL 8 (WASHINGTON)	2.0
		WASHINGTON & TAYLOR/ VETERANS	2.0
		IL 9 (ANN ELIZA) & IL 29 (FIFTH)	1.0
		IL 9 (ANN ELIZA) & THIRD	2.0
PEKIN		IL 9 (MARGARET) & IL 29 (SECOND)	1.0
		IL 9 (ANN ELIZA) & IL 29 (FIFTH)	1.0
WASHINGTON		IL 9 (ANN ELIZA) & IL 29 (FIFTH)	1.0
		IL 9 (ANN ELIZA) & IL 29 (SECOND)	1.0
TAZEVELL COUNTY TOTAL			22.0
WOODFORD	GERMANTOWN HILLS	IL 116 & ARBOR VITAE/ SCHMITT	1.0
		IL 116 & FANDEL/ CATERPILLAR TRAIL	3.0
GOODFIELD		US 150 (PEORIA) & IL 117 (EUREKA)	1.0
		WOODFORD COUNTY TOTAL	
TOTAL			51.0

X8760203 PEDESTRIAN PUSH-BUTTON POST (NO FOUNDATION)				
COUNTY	CITY	LOCATION	EACH	
FULTON	CANTON	IL 78 (MAIN) & LINCOLN	2.0	
		IL 78 (MAIN) & SYCAMORE TERRACE	1.0	
		IL 9 (5TH) & CHESTNUT	3.0	
		IL 9 (LOCUST) & 1ST	7.0	
		IL 9 (LOCUST) & IL 78 (MAIN)	8.0	
FULTON COUNTY TOTAL			21.0	
KNOX	GALESBURG	ABINGDON	IL 41 (MONROE) & LATIMER	4.0
		US 150 (GRAND) & FARNHAM	1.0	
		US 150 (HENDERSON) & CARL SANDBURG	5.0	
		US 150 (HENDERSON) & FREMONT	1.0	
		US 150 (MAIN) & ACADEMY	3.0	
		US 150 (MAIN) & CHERRY	4.0	
		US 150 (MAIN) & KELLOGG	2.0	
		US 150 (MAIN) & PRAIRIE	4.0	
		US 150 (MAIN) & SEMINARY	4.0	
		US 150 (HENDERSON) & DAYTON	1.0	
KNOX COUNTY TOTAL			29.0	
MARSHALL	LACON	IL 17 (FIFTH) & IL 26 (PRAIRIE)	2.0	
MARSHALL COUNTY TOTAL			2.0	
MCDONOUGH	MACOMB	US 136 (JACKSON) & US 136 (JOHNSON)	4.0	
		US 67/ US 136 (CALHOUN) & US 67 (LAFAYETTE)	5.0	
		US 67/ US 136 (CALHOUN) & US 67/ US 136 (CAMPBELL)	4.0	
		US 67/ US 136 (JACKSON) & DUDLEY	4.0	
		US 67/ US 136 (JACKSON) & US 67/ US 136 (CAMPBELL)	3.0	
MCDONOUGH COUNTY TOTAL			20.0	
TAZEVELL	EAST PEORIA	IL 8 (WASHINGTON) & FARMDALE/ ILLINI	1.0	
		IL 8 (WASHINGTON) & ROSEDALE/ PUTNAM	1.0	
		US 150 (MEADOW)/ARNOLD & IL 8 (WASHINGTON)	5.0	
	MORTON		WASHINGTON & TAYLOR/ VETERANS	2.0
			US 150 (JACKSON) & DETROIT	3.0
	PEKIN		IL 29 (EIGHTH) & SHERIDAN	3.0
			IL 9 (ANN ELIZA) & IL 29 (FIFTH)	7.0
			IL 9 (ANN ELIZA) & THIRD	3.0
			IL 9 (MARGARET) & IL 29 (THIRD)	3.0
			IL 9/ IL 29 (MARGARET) & FOURTH	2.0
WASHINGTON		IL 9/ IL 29 (MARGARET) & IL 29 (FIFTH)	2.0	
		BUS 24 (WASHINGTON/ PEORIA) & EAGLE	2.0	
		IL 8 (WASHINGTON) & SCHOOL	6.0	
		IL 8 (WASHINGTON) & SUMMIT	3.0	
		US 24 (BOYD) & CUMMINGS	2.0	
TAZEVELL COUNTY TOTAL			45.0	
WOODFORD	METAMORA	IL 116 (MT. VERNON) & IL 89 (NILES)	2.0	
WOODFORD COUNTY TOTAL			2.0	
TOTAL			119.0	

X8910050 ILLUMINATED SIGN (SPECIAL)				
COUNTY	CITY	LOCATION	EACH	
FULTON	CANTON	IL 9 (LOCUST) & IL 78 (MAIN)	2.0	
FULTON COUNTY TOTAL			2.0	
KNOX	GALESBURG	US 150 (HENDERSON) & CARL SANDBURG	1.0	
KNOX COUNTY TOTAL			1.0	
TAZEVELL	EAST PEORIA	IL 116 & BLACKJACK	1.0	
		IL 116 (MAIN) & GOLD/ KROGER ENTRANCE	1.0	
		US 150 (MEADOW)/ARNOLD & IL 8 (WASHINGTON)	1.0	
	MORTON		US 150 (JACKSON) & DETROIT	2.0
			IL 9 (ANN ELIZA) & IL 29 (FIFTH)	2.0
PEKIN		IL 9 (MARGARET) & IL 29 (THIRD)	1.0	
		IL 9 (MARGARET) & IL 29 (THIRD)	1.0	
		US 24 (BOYD) & CUMMINGS	1.0	
TAZEVELL COUNTY TOTAL			9.0	
WOODFORD	METAMORA	IL 116 (MT. VERNON) & IL 89 (NILES)	1.0	
WOODFORD COUNTY TOTAL			1.0	
TOTAL			13.0	

Z0025615 FURNISH AND INSTALL METAL SCREEN			
COUNTY	CITY	LOCATION	EACH
KNOX	ABINGDON	IL 41 (MONROE) & LATIMER	4.0
KNOX COUNTY TOTAL			4.0
TOTAL			4.0

Z0048665 RAILROAD PROTECTIVE LIABILITY INSURANCE			
COUNTY	CITY	LOCATION	L SUM
MCDONOUGH	MACOMB	US 67/ US 136 (CALHOUN) & US 67 (LAFAYETTE)	0.5
MCDONOUGH COUNTY TOTAL			0.5
TAZEVELL	ABINGDON	IL 9 (MARGARET) & IL 29 (THIRD)	0.5
TAZEVELL COUNTY TOTAL			0.5
TOTAL			1.0

X8950212 MODIFY EXISTING CONTROLLER CABINET (SPECIAL)			
COUNTY	CITY	LOCATION	EACH
FULTON	CANTON	IL 9 (LOCUST) & IL 78 (MAIN)	1.0
FULTON COUNTY TOTAL			1.0
TOTAL			1.0

X0327739 MISCELLANEOUS ELECTRICAL WORK			
COUNTY	CITY	LOCATION	L SUM
VARIOUS	VARIOUS	VARIOUS	1.0
TOTAL			1.0

MODEL: D:\design\...
 FILE NAME: S:\CEN\WIN\WOOD\DESP AN\Hanson#\ Completed Contracts\APS_68H76 and 68H77\68H77.D4 ADA Pushbutton 2024-11-11-02-23.dgn

USER NAME = trevor.hanson	DESIGNED -	REVISED 11-02-23 TJH
PLOT SCALE = 23.8272' / in.	DRAWN -	REVISED -
PLOT DATE = 11/2/2023	CHECKED -	REVISED -
	DATE -	REVISED -

**STATE OF ILLINOIS
DEPARTMENT OF TRANSPORTATION**

SCHEDULE OF QUANTITIES - CONTINUED

SCALE:	SHEET	OF	SHEETS	STA.	TO	STA.
--------	-------	----	--------	------	----	------

F.A.P. RTE.	SECTION	COUNTY	TOTAL SHEETS	SHEET NO.
VAR.	D4 ADA PUSHBUTTONS 2024-1	*	76	9
			CONTRACT NO. 68H77	
		ILLINOIS FED. AID PROJECT		

- NOTES:
1. THE CONTRACTOR SHALL FURNISH AND INSTALL R10-15 SIGN (30"X30", RIGHT TURN ARROW, FLOURESCENT YELLOW-GREEN BACKGROUND) ON THE MAST ARM STRAIN POLE. THE CONTRACTOR SHALL RELOCATE EXISTING SIGNS AS REQUIRED TO ACCOMODATE THE INSTALLATION OF THE PROPOSED SIGN. THIS WORK WILL NOT BE PAID FOR SEPARATELY, BUT SHALL BE INCLUDED IN THE BID PRICE OF THE SIGN PANEL TYPE 1.
 2. THE CONTRACTOR SHALL RELOCATE THE EXISTING 3-SECTION SIGNAL HEADS ON THE SB MAST ARM STRAIN POLE AND MAST ARM TO THE SB MAST ARM, SPACED 8 FT. APART AND CENTERED OVER THE THROUGH LANE. THE CONTRACTOR SHALL RELOCATE THE EXISTING 3-SECTION SIGNAL HEADS ON THE WB MAST ARM STRAIN POLE AND MAST ARM TO THE WB MAST ARM, SPACED 8 FT. APART AND CENTERED OVER THE THROUGH LANE. THE CONTRACTOR SHALL FURNISH AND INSTALL ALL REQUIRED HARDWARE, BRACKETING, ETC. AND SHALL FILL THE HOLES USING STAINLESS STEEL PLUGS AND/OR ALUMINUM PLATES WITH STAINLESS STEEL BANDING. THE CONTRACTOR SHALL RE-USE THE EXISTING SIGNAL CABLE FOR THE LEFT SIGNAL HEAD AND INSTALL AN 8 FT. 5/C JUMPER CABLE BETWEEN THE TWO SIGNAL HEADS. THIS WORK WILL NOT BE PAID FOR SEPARATELY, BUT SHALL BE INCLUDED IN THE COST OF THE RELOCATED SIGNAL HEADS.
 3. THE CONTRACTOR SHALL FURNISH AND INSTALL ALL ITEMS (LOAD SWITCHES, JUMPERS, ETC.), PROGRAM THE EXISTING CONTROLLER AND MMU, PROVIDE RED-LINED PRINTS, AND RE-ARRANGE THE EXISTING CABINET COMPONENTS AS NEEDED TO ACCOMODATE THE PROPOSED FLASHING YELLOW ARROW OPERATION FOR THE SB AND WB RIGHT TURN. THE COST OF THIS WORK SHALL BE INCLUDED IN THE BID PRICE FOR THE MODIFY EXISITNG CONTROLLER CABINET (SPECIAL.)

BILL OF MATERIALS		
IL 9 (LOCUST) & IL 78 (MAIN)		
ITEM DESCRIPTION	UNIT	QTY.
ACCESSIBLE PEDESTRIAN SIGNALS	EACH	8.0
ANCHOR BOLT SET, 1/2 DIAMETER, WITH WEDGE ANCHORS	EACH	8.0
THHN WIRE ENCASED IN PVC TUBE, NO. 19/27 AWG	FOOT	462.0
SAW CUT FOR ELECTRICAL CABLE INSTALLATION, 5/16"	FOOT	78.0
PEDESTRIAN PUSH-BUTTON POST (NO FOUNDATION)	EACH	8.0
TRAFFIC SIGNAL BACKPLATE, RETROREFLECTIVE	EACH	12.0
SIGN PANEL - TYPE 1	SQ FT	12.6
SIGNAL HEAD, POLYCARBONATE, LED, 1-FACE, 4-SECTION, BRACKET MOUNTED	EACH	4.0
RELOCATE EXISTING SIGNAL HEAD	EACH	4.0
ILLUMINATED SIGN (SPECIAL)	EACH	2.0
ELECTRIC CABLE IN CONDUIT, SIGNAL NO. 14 3C	FOOT	230.5
ELECTRIC CABLE IN CONDUIT, SIGNAL NO. 14 7C	FOOT	637.0
MODIFY EXISTING CONTROLLER CABINET (SPECIAL)	EACH	1.0

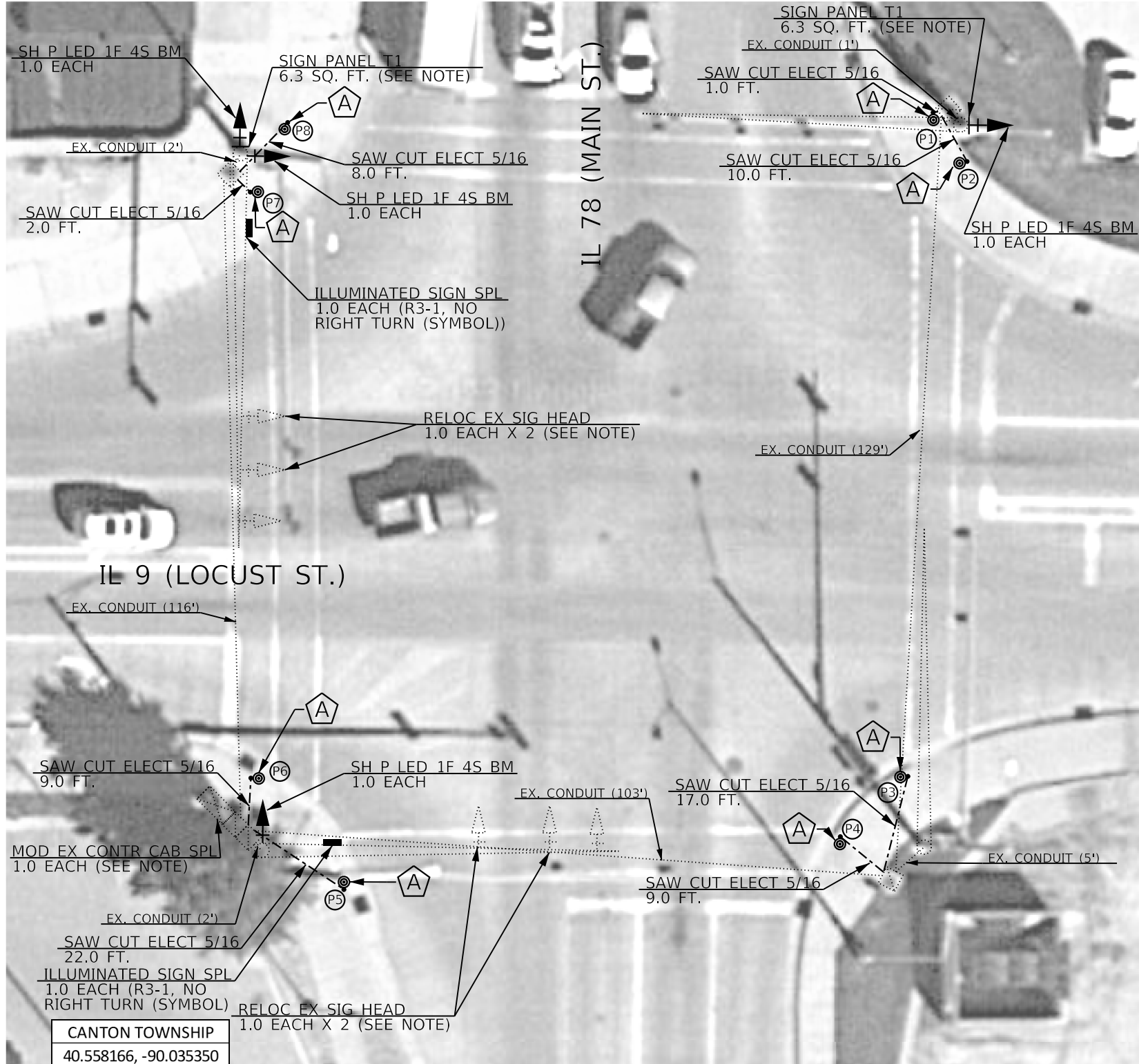

APS SCHEDULE							
IL 9 (LOCUST) & IL 78 (MAIN)							
LABEL	LOCATION	INSTALLATION TYPE	MOUNTING BRACKET	CROSSING	WALK INDICATION	WIRING NOTES	NOTES
P1	NE QUAD	PROP. PED PB POST (NO FDN)	SINGLE	MAIN	STONE	INSTALL NEW WIRE FROM APS TO EX. MAST ARM AND SPLICE WITH EX. WIRE IN MAST ARM BASE	PROP. SAW CUT FROM PROP. PUSHBUTTON POST TO EX. HANDHOLE
P2	NE QUAD	PROP. PED PB POST (NO FDN)	SINGLE	LOCUST	STONE	INSTALL NEW WIRE FROM APS TO EX. MAST ARM AND SPLICE WITH EX. WIRE IN MAST ARM BASE	PROP. SAW CUT FROM PROP. PUSHBUTTON POST TO EX. HANDHOLE
P3	SE QUAD	PROP. PED PB POST (NO FDN)	SINGLE	LOCUST	STONE	INSTALL NEW WIRE FROM APS TO EX. MAST ARM AND SPLICE WITH EX. WIRE IN MAST ARM BASE	PROP. SAW CUT FROM PROP. PUSHBUTTON POST TO EX. HANDHOLE
P4	SE QUAD	PROP. PED PB POST (NO FDN)	SINGLE	MAIN	STONE	INSTALL NEW WIRE FROM APS TO EX. MAST ARM AND SPLICE WITH EX. WIRE IN MAST ARM BASE	PROP. SAW CUT FROM PROP. PUSHBUTTON POST TO EX. HANDHOLE
P5	SW QUAD	PROP. PED PB POST (NO FDN)	SINGLE	MAIN	STONE	INSTALL NEW WIRE FROM APS TO CONTROLLER	PROP. SAW CUT FROM PROP. PUSHBUTTON POST TO EX. DOUBLE HANDHOLE
P6	SW QUAD	PROP. PED PB POST (NO FDN)	SINGLE	LOCUST	STONE	INSTALL NEW WIRE FROM APS TO CONTROLLER	PROP. SAW CUT FROM PROP. PUSHBUTTON POST TO EX. DOUBLE HANDHOLE
P7	NW QUAD	PROP. PED PB POST (NO FDN)	SINGLE	LOCUST	STONE	INSTALL NEW WIRE FROM APS TO EX. MAST ARM AND SPLICE WITH EX. WIRE IN MAST ARM BASE	PROP. SAW CUT FROM PROP. PUSHBUTTON POST TO EX. HANDHOLE
P8	NW QUAD	PROP. PED PB POST (NO FDN)	SINGLE	MAIN	STONE	INSTALL NEW WIRE FROM APS TO EX. MAST ARM AND SPLICE WITH EX. WIRE IN MAST ARM BASE	PROP. SAW CUT FROM PROP. PUSHBUTTON POST TO EX. HANDHOLE

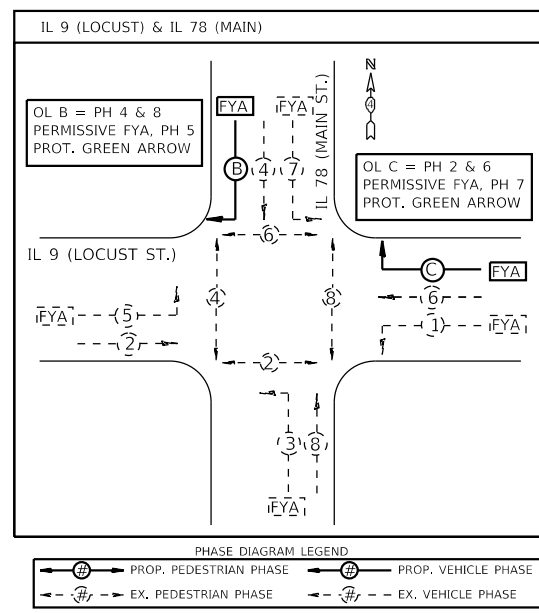

- OVERLAP B SHALL OPERATE WITH FLASHING YELLOW ARROW DURING PHASES 4 AND 8 GREEN INDICATION AND RED ARROW DURING PHASE 4 WALK.
- OVERLAP C SHALL OPERATE WITH FLASHING YELLOW ARROW DURING PHASES 2 AND 6 GREEN INDICATION AND RED ARROW DURING PHASE 6 WALK.
- APS LEGEND**
- A PROP. APS INSTALLED ON PROP. PEDESTRIAN PUSHBUTTON POST (NO FOUNDATION) ON EX. SIDEWALK, WITH ANCHOR BOLT SET, 1/2 DIAMETER, WITH WEDGE ANCHORS
 - B PROP. APS INSTALLED ON PROP. PEDESTRIAN PUSHBUTTON POST (NO FOUNDATION) ON EX. ISLAND SURFACE, WITH ANCHOR BOLT SET, 1/2 DIAMETER, WITH WEDGE ANCHORS
 - C PROP. APS INSTALLED ON PROP. PEDESTRIAN PUSHBUTTON POST (NO FOUNDATION) ON EX. SIDEWALK CURB, WITH ANCHOR BOLT SET 1/2 DIAMETER, WITH WEDGE ANCHORS
 - D PROP. APS INSTALLED ON PROP. PEDESTRIAN PUSHBUTTON POST (CONCRETE FOUNDATION)
 - E PROP. APS INSTALLED ON EX. MAST ARM STRAIN POLE
 - F PROP. APS INSTALLED ON EX. TRAFFIC SIGNAL POST OR LIGHT POLE
 - G PROP. APS INSTALLED ON EX. PEDESTRIAN PUSHBUTTON POST
 - H PROP. APS INSTALLED ON PROP. TRAFFIC SIGNAL POST

MODEL: D:\d4\11\11102233.dgn FILE: \d4\11102233.dgn CONTRACTOR: 68177 AND 68177\68177.D4 ADA PUSHBUTTONS 2024-11 11:02:23.dgn

USER NAME = trevor.hanson	DESIGNED -	REVISED - 11-01-23 TJH
PLOT SCALE = 23.8272' / in.	DRAWN -	REVISED -
PLOT DATE = 11/2/2023	CHECKED -	REVISED -
	DATE -	REVISED -

**STATE OF ILLINOIS
DEPARTMENT OF TRANSPORTATION**

**PROPOSED ACCESSIBLE PEDESTRIAN SIGNALS
IL 78 (MAIN ST.) & IL 9 (LOCUST ST.) - CANTON**

SCALE: SHEET OF SHEETS STA. TO STA.

F.A.P. RTE.	SECTION	COUNTY	TOTAL SHEETS	SHEET NO.
VAR.	D4 ADA PUSHBUTTONS 2024-1	FULTON	76	13
CONTRACT NO. 68H77				
ILLINOIS FED. AID PROJECT				