

F.A.L. RTE	SECTION	COUNTY	TOTAL SHEETS	SHEET NO.
80/94	*	COOK	870	57
STA.		TO STA.		
FED ROAD DIST. NO.		ILLINOIS FED. AID PROJECT		

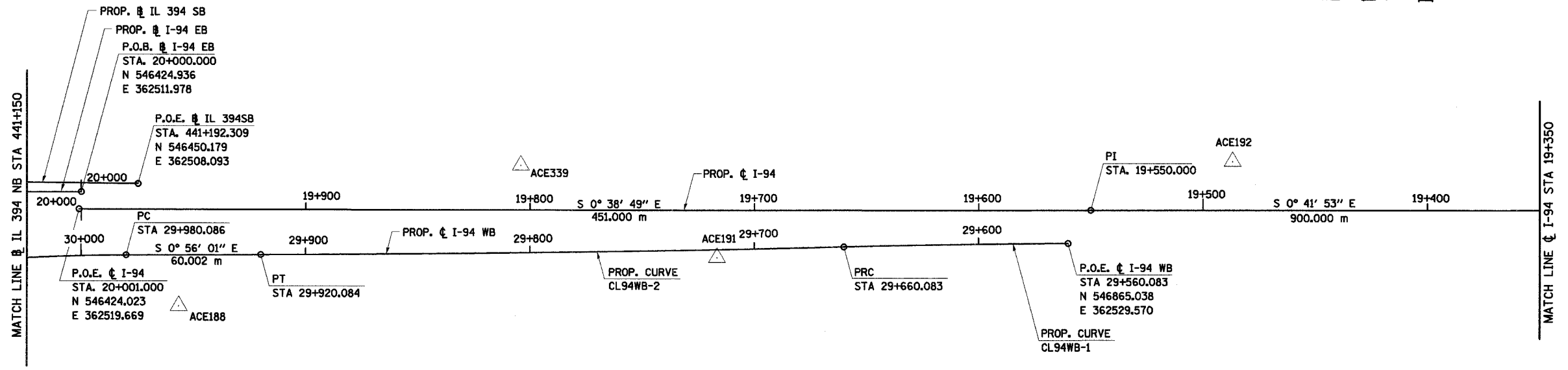

PROP. CURVE CL94WB-2  
 PI STA. = 29+790.088  
 $\Delta = 1^\circ 08' 45''$  (RT)  
 R = 12,999.999 m  
 T = 130.005 m  
 L = 260.001 m  
 E = 0.650 m  
 e = 2.0  
 P.R.C. STA. = 29+660.083  
 P.T. STA. = 29+920.084

PROP. CURVE CL94WB-1  
 PI STA. = 29+610.085  
 $\Delta = 1^\circ 08' 45''$  (LT)  
 R = 5,000.000 m  
 T = 50.002 m  
 L = 100.000 m  
 E = 0.250 m  
 e = 2.0  
 P.C. STA. = 29+560.083  
 P.R.C. STA. = 29+660.083

PI COORDINATES

STATION	NORTH	EAST
19+550.000	546874.994	362514.576
340+573.083	546865.360	362548.547

CURVE PI COORDINATES

NAME	NORTH	EAST
CL94WB-2	546635.155	362536.916
CL94WB-1	546815.043	362530.385

TB-6

ILLINOIS DEPARTMENT OF TRANSPORTATION  
 I-94 EAST BOUND / IL 394 SOUTH BOUND

**HORIZONTAL ALIGNMENT**

HORIZ SCALE: 1:1000  
 VERT SCALE: NONE  
 DATE: JULY 18, 2005  
 DRAWN BY: BAJ  
 CHECKED BY: JES

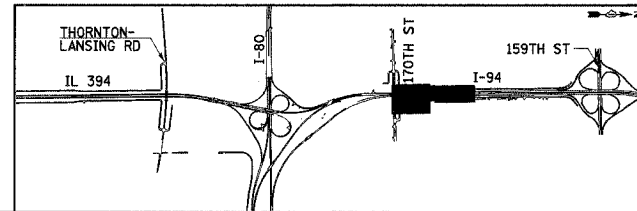

REVISIONS	
NAME	DATE

NOTE:  
 COORDINATE DATA IS STATE PLANE