

F.A.I. RTE	SECTION	COUNTY	TOTAL SHEETS	SHEET NO.
80/94	•	COOK	870	120
STA.		TO STA.		
FED ROAD DIST. NO.	ILLINOIS	FED. AID PROJECT		

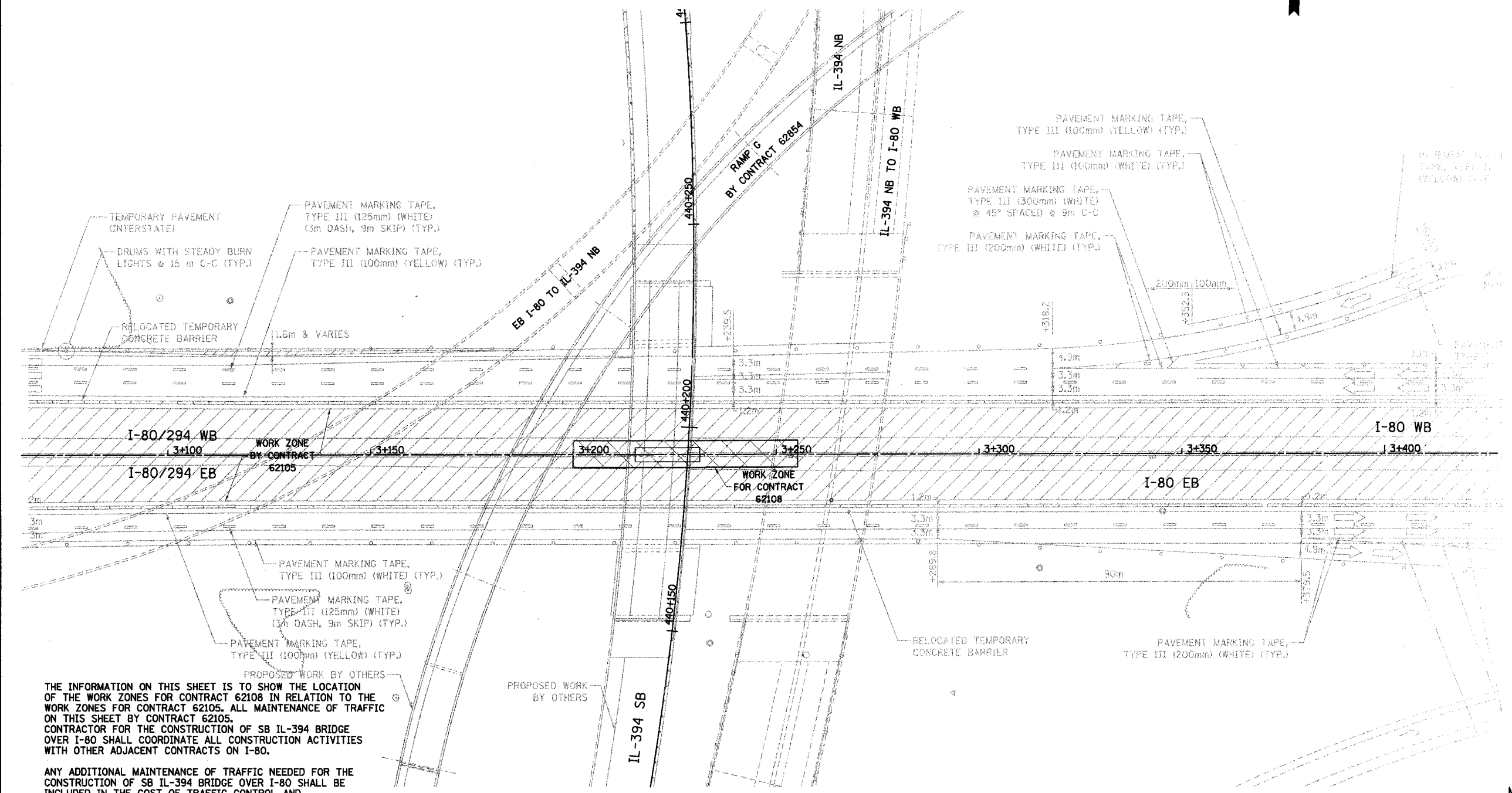

THE INFORMATION ON THIS SHEET IS TO SHOW THE LOCATION OF THE WORK ZONES FOR CONTRACT 62108 IN RELATION TO THE WORK ZONES FOR CONTRACT 62105. ALL MAINTENANCE OF TRAFFIC ON THIS SHEET BY CONTRACT 62105. CONTRACTOR FOR THE CONSTRUCTION OF SB IL-394 BRIDGE OVER I-80 SHALL COORDINATE ALL CONSTRUCTION ACTIVITIES WITH OTHER ADJACENT CONTRACTS ON I-80.

ANY ADDITIONAL MAINTENANCE OF TRAFFIC NEEDED FOR THE CONSTRUCTION OF SB IL-394 BRIDGE OVER I-80 SHALL BE INCLUDED IN THE COST OF TRAFFIC CONTROL AND PROTECTION (EXPRESSWAYS).

ALL MAINTENANCE OF TRAFFIC SHOWN ON THIS SHEET IS FOR REFERENCE ONLY.

LEGEND

	WORK ZONE		DRUMS WITH STEADY BURN LIGHTS
	TEMPORARY PAVEMENT		VERTICAL PANELS
	TRAFFIC DIRECTION		TYPE III BARRICADE WITH 2 FLASHING LIGHTS
	LANE CLOSURE		

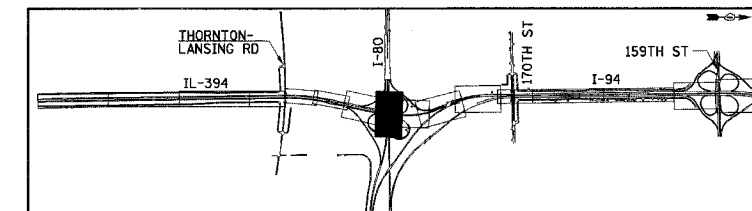

REVISIONS	
NAME	DATE

MT-46

ILLINOIS DEPARTMENT OF TRANSPORTATION
I-94 EAST BOUND / IL 394 SOUTH BOUND

**MAINTENANCE OF TRAFFIC
STAGE 2
I-80/94 UNDER SB IL-394**

HORIZ SCALE: 1:500
VERT SCALE: NONE
DATE: JULY 18, 2005

DRAWN BY: STS
CHECKED BY: JES

HNTB