

F.A.I. RTE 80/94	SECTION •	COUNTY COOK	TOTAL SHEETS 870	SHEET NO. 130
STA. 19+050		TO STA. 19+350		
FED ROAD DIST. NO.		ILLINOIS FED. AID PROJECT		

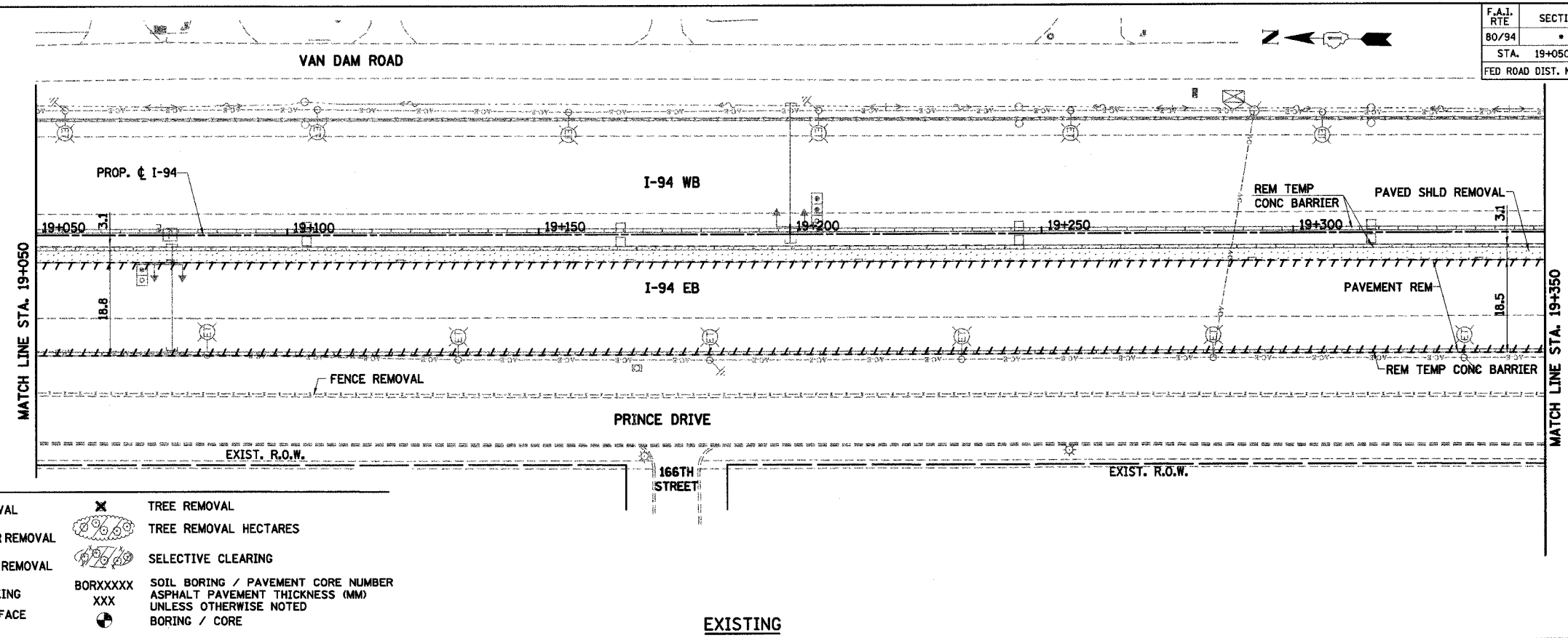

LEGEND

	PAVEMENT REMOVAL		TREE REMOVAL
	PAVED SHOULDER REMOVAL		TREE REMOVAL HECTARES
	APPROACH SLAB REMOVAL		SELECTIVE CLEARING
	PAVEMENT BREAKING	BORXXXXX	SOIL BORING / PAVEMENT CORE NUMBER
	BITUMINOUS SURFACE REMOVAL, 45MM	XXX	ASPHALT PAVEMENT THICKNESS (MM) UNLESS OTHERWISE NOTED
			BORING / CORE

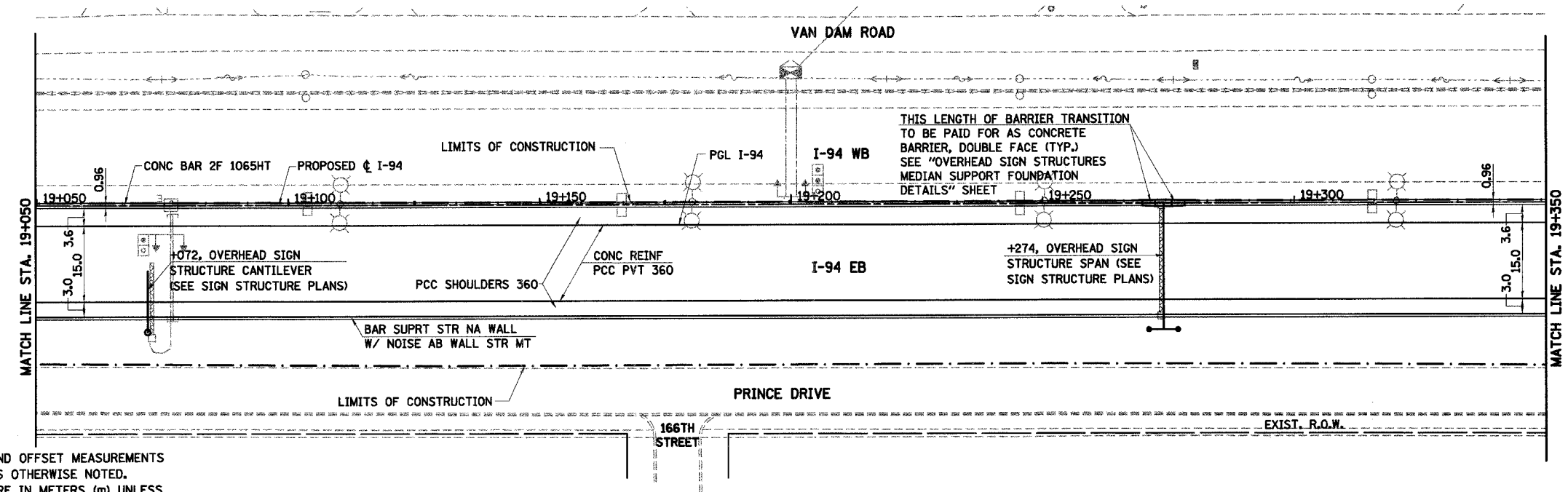

NOTES:

1. ALL STATIONING AND OFFSET MEASUREMENTS OFF C I-94 UNLESS OTHERWISE NOTED.
2. ALL DIMENSIONS ARE IN METERS (m) UNLESS OTHERWISE NOTED.
3. ALL TREE DIAMETERS ARE IN MILLIMETERS (mm) UNLESS OTHERWISE NOTED.
4. WHERE EXISTING SIGNS INTERFERE WITH CONSTRUCTION OPERATIONS, SEE ARTICLE 107.25 OF THE STANDARD SPECIFICATIONS.
5. SEE CONTRACT 62664 FOR LIGHTING REMOVAL.
6. ALL CONCRETE GUTTER OR COMBINATION CONCRETE CURB AND GUTTER ENCOUNTERED UNDER THE EXISTING BITUMINOUS SURFACE SHALL BE REMOVED AND PAID FOR UNDER ITS CORRESPONDING PAY ITEM

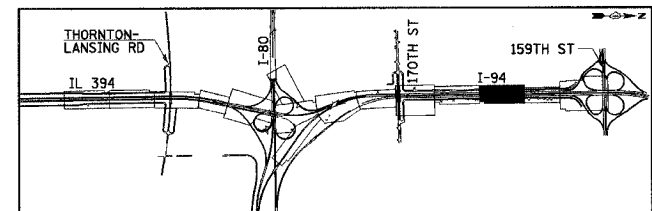

REVISIONS	
NAME	DATE

ILLINOIS DEPARTMENT OF TRANSPORTATION
I-94 EAST BOUND / IL 394 SOUTH BOUND

EXISTING AND PROPOSED PLAN
I-94
STA. 19+050 TO STA. 19+350

HORIZ SCALE: 1:500
VERT SCALE:
DATE: JULY 18, 2005

DRAWN BY: BAJ
CHECKED BY: JES

HNTB

PROPOSED