

F.A.T. RTE.	SECTION	COUNTY	TOTAL SHEETS	SHEET NO.
80/394	*	COOK	870	159
STA. 130+367.00		TO STA. 130+884.42		
FED. ROAD DIST. NO. 1		ILLINOIS FED. AID PROJECT		

FINAL SURVEY PLOTTED	BY	DATE
NOTE BOOK		
AREAS CHECKED		
NO.		

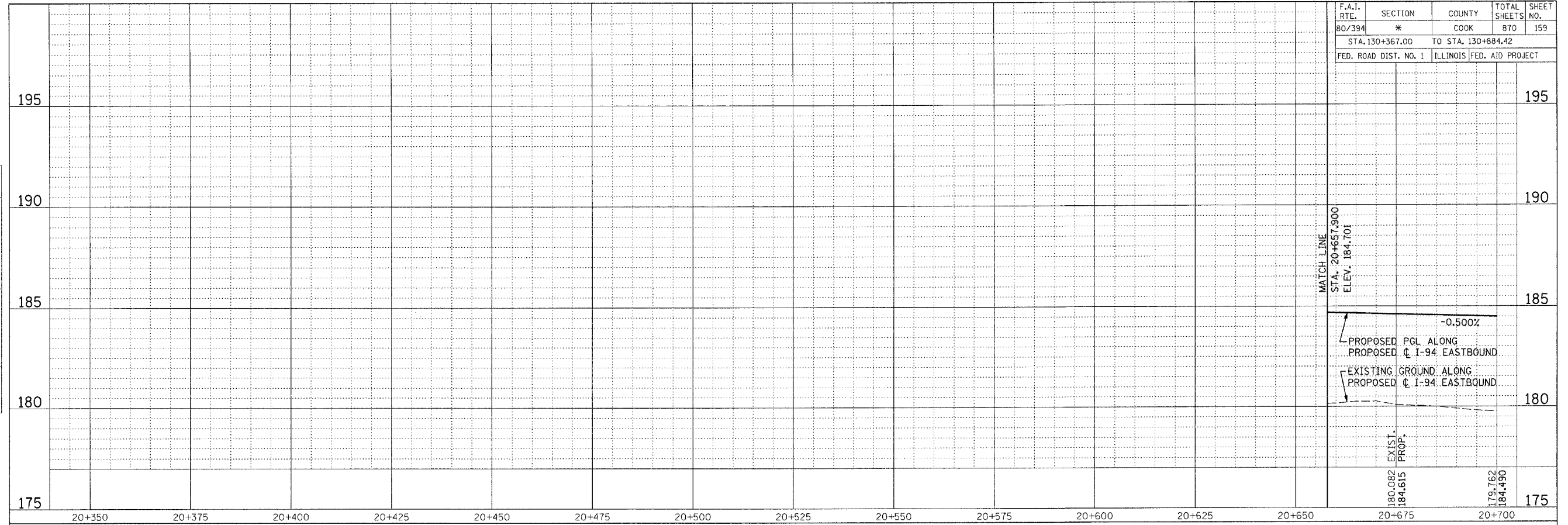

ORIGINAL SURVEY PLOTTED	BY	DATE
NOTE BOOK		
AREAS CHECKED		
NO.		

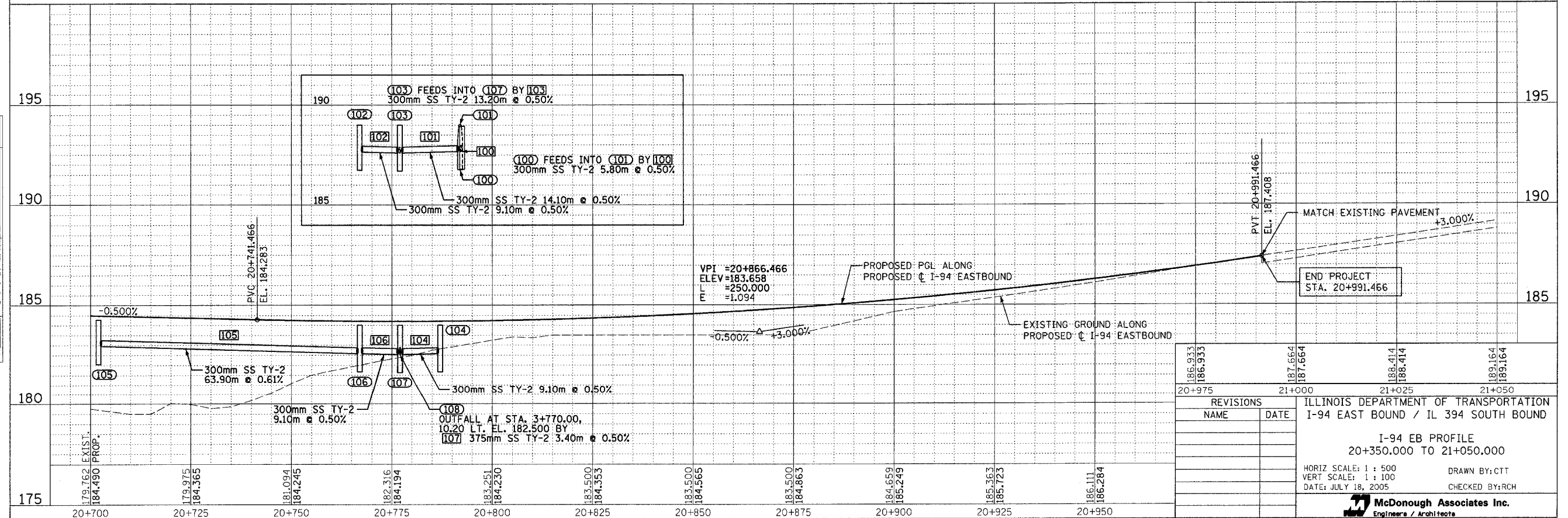

186.933	20+975	187.664	21+000	188.414	21+025	189.164	21+050
186.933		187.664		188.414		189.164	
REVISIONS		ILLINOIS DEPARTMENT OF TRANSPORTATION					
NAME	DATE	I-94 EAST BOUND / IL 394 SOUTH BOUND					
		I-94 EB PROFILE					
		20+350.000 TO 21+050.000					
		HORIZ SCALE: 1 : 500			DRAWN BY: CTT		
		VERT SCALE: 1 : 100			CHECKED BY: RCH		
		DATE: JULY 18, 2005					
		 McDonough Associates Inc. Engineers / Architects					