

F.A.I. 80/94 (KINGERY EXPRESSWAY) BORING LOCATION PLAN ILLINOIS DEPARTMENT OF TRANSPORTATION, COOK COUNTY		F.A.I. RTE	SECTION	COUNTY	TOTAL SHEETS NO.
80/94				COOK	870
STA. 19+050		TO STA. 19+350			
FED ROAD DIST. NO.		ILLINOIS FED. AID PROJECT			

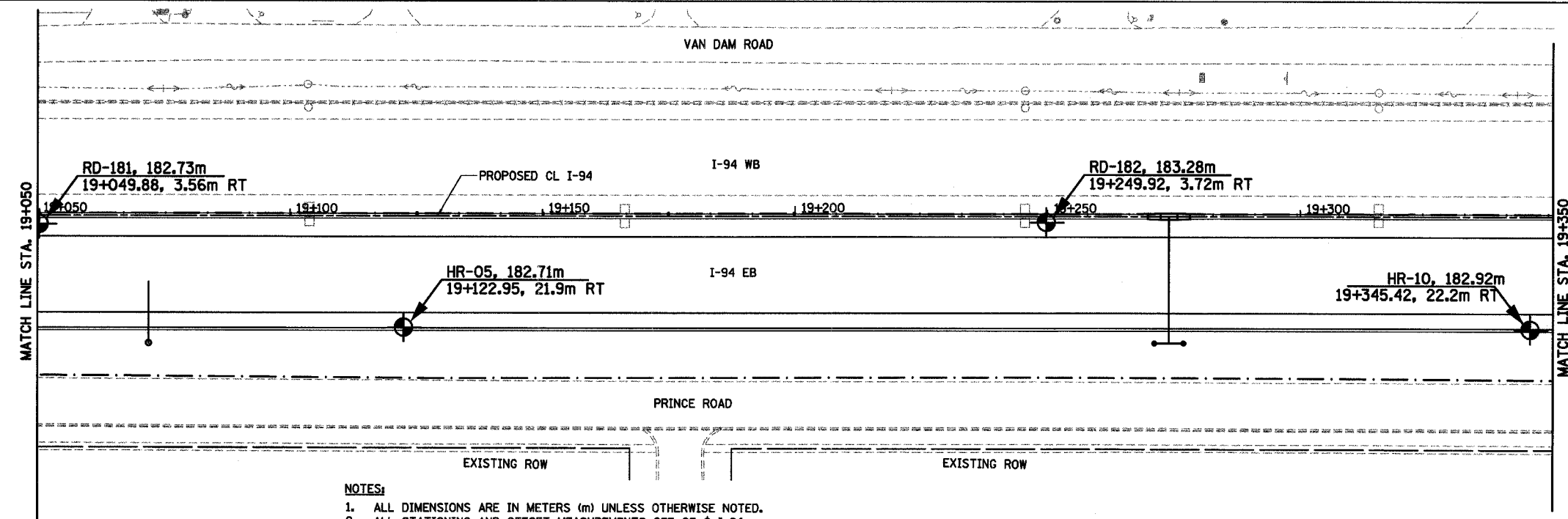

- NOTES:**
1. ALL DIMENSIONS ARE IN METERS (m) UNLESS OTHERWISE NOTED.
 2. ALL STATIONING AND OFFSET MEASUREMENTS OFF OF CL I-94 UNLESS OTHERWISE STATED.

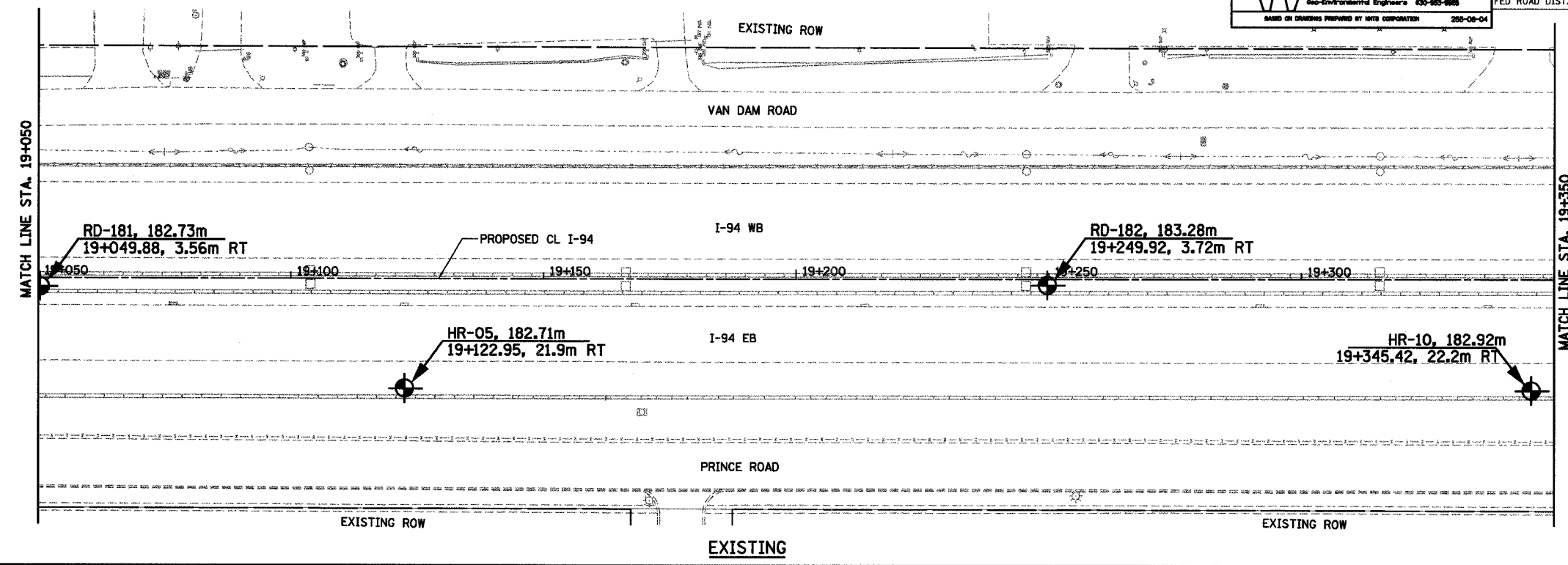
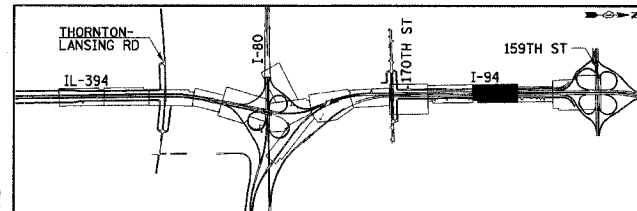

REVISIONS	
NAME	DATE

SB-04
ILLINOIS DEPARTMENT OF TRANSPORTATION
I-94 EAST BOUND / IL 394 SOUTH BOUND
SOIL BORING PLAN
I-94
STA. 19+050 TO STA. 19+350
HORIZ SCALE: 1:500
VERT SCALE:
DATE: JULY 18, 2005
DRAWN BY:
CHECKED BY: