

F.A.I. RTE	SECTION	COUNTY	TOTAL SHEETS	SHEET NO.
80/94	*	COOK	870	228
STA. 440+200 TO STA. 440+550				
FED ROAD DIST. NO.		ILLINOIS FED. AID PROJECT		

- REMOVING CATCH BASINS**
- 440+508.8, 46.7 RT
  - 440+503.1, 17.3 RT
- REMOVING MANHOLES**
- 440+275.0, 14.4 RT
  - 440+295.2, 11.5 LT
  - 440+343.7, 4.0 RT
  - 440+381.1, 8.9 RT
  - 440+447.7, 43.8 RT
  - 440+423.3, 14.7 LT
  - 440+345.6, 43.0 LT
  - 440+348.3, 101.2 LT
  - 440+293.3, 135.9 LT
  - 440+229.2, 114.3 LT
  - 440+513.8, 2.1 RT

- REMOVING INLETS**
- 440+232.3, 17.5 LT
  - 440+230.8, 6.0 LT
  - 440+295.8, 10.2 LT
  - 440+333.4, 4.4 RT
  - 440+377.2, 18.7 RT
  - 440+378.2, 11.0 RT
  - 440+422.2, 16.4 RT
  - 440+467.0, 20.8 RT

- STORM SEWER REMOVAL - 600mm**
- STA. 440+348.3 TO 440+387.1 - 36.0m (62.9 cu m)
  - STA. 440+387.1 TO 440+400.0 - 11.4m (19.9 cu m)
  - STA. 440+389.5 TO 440+423.3 - 41.0m (71.6 cu m)
  - STA. 440+423.3 TO 440+503.1 - 86.1m (150.3 cu m)
  - STA. 440+503.1 TO 440+513.8 - 19.0m (33.2 cu m)
  - STA. 440+513.8 TO 440+525.0 - 11.3m (19.8 cu m)
  - STA. 440+447.7 TO 440+509.2 - 64.5m (112.6 cu m)

- STORM SEWER REMOVAL - 450mm**
- STA. 440+217.8 TO 440+229.2 - 59.0m (74.2 cu m)
  - STA. 440+229.2 TO 440+293.3 - 58.2m (73.2 cu m)
  - STA. 440+293.3 TO 440+348.3 - 58.3m (73.3 cu m)

- STORM SEWER REMOVAL - 300mm**
- STA. 440+232.27 TO 440+230.84 - 11.6m (10cu m)
  - STA. 440+230.84 TO 440+237.49 - 9.7m (8cu m)
  - STA. 440+237.49 TO 440+274.96 - 40.1m (33cu m)
  - STA. 440+274.96 TO 440+276.57 - 4.1m (4cu m)
  - STA. 440+295.78 TO 440+295.25 - 1.4m (2cu m)
  - STA. 440+295.25 TO 440+343.74 - 50.7m (41cu m)
  - STA. 440+333.44 TO 440+343.74 - 10.4m (9cu m)
  - STA. 440+343.74 TO 440+381.09 - 38.0m (31cu m)
  - STA. 440+377.18 TO 440+378.24 - 7.7m (7cu m)
  - STA. 440+345.55 TO 440+348.33 - 58.2m (47cu m)
  - STA. 440+467.02 TO 440+447.74 - 30.4m (25cu m)
  - STA. 440+510.25 TO 440+508.81 - 22.3m (18cu m)

- STORM SEWER REMOVAL - 375mm**
- STA. 440+381.09 TO 440+422.15 - 42.4m (44cu m)
  - STA. 440+422.15 TO 440+477.74 - 38.1m (40cu m)
  - STA. 440+509.18 TO 440+525.00 - 21.4 m (30cu m)

- END SECTIONS TO BE REMOVED**
- 440+276.6, 10.7 RT
  - 440+389.5, 38.1 LT

- NOTES:**
- ALL STATIONING AND OFFSET MEASUREMENTS OFF IL 394 SB UNLESS OTHERWISE NOTED.
  - ALL DIMENSIONS ARE IN METERS (m) UNLESS OTHERWISE NOTED.
  - ALL PIPE SIZES IN MILLIMETERS (mm) UNLESS OTHERWISE NOTED.
  - QUANTITY OF TRENCH BACKFILL FOR STORM SEWER REMOVAL IS PROVIDED IN SCHEDULE AT TOP OF PLAN SHEET AFTER LENGTH OF PIPE TO BE REMOVED. TRENCH BACKFILL QUANTITY BASED ON LENGTH OF PIPE REMOVED. IF EXISTING STORM SEWER IS REMOVED AND REPLACED, TRENCH BACKFILL WILL BE PROVIDED FOR PROPOSED STORM SEWER ONLY.
  - CONTRACTOR TO COORDINATE DRAINAGE REMOVAL WITH CONTRACT 62105.
  - STORM SEWER SYSTEM TO BE MAINTAINED UNTIL CLOSURE OF RAMP F.

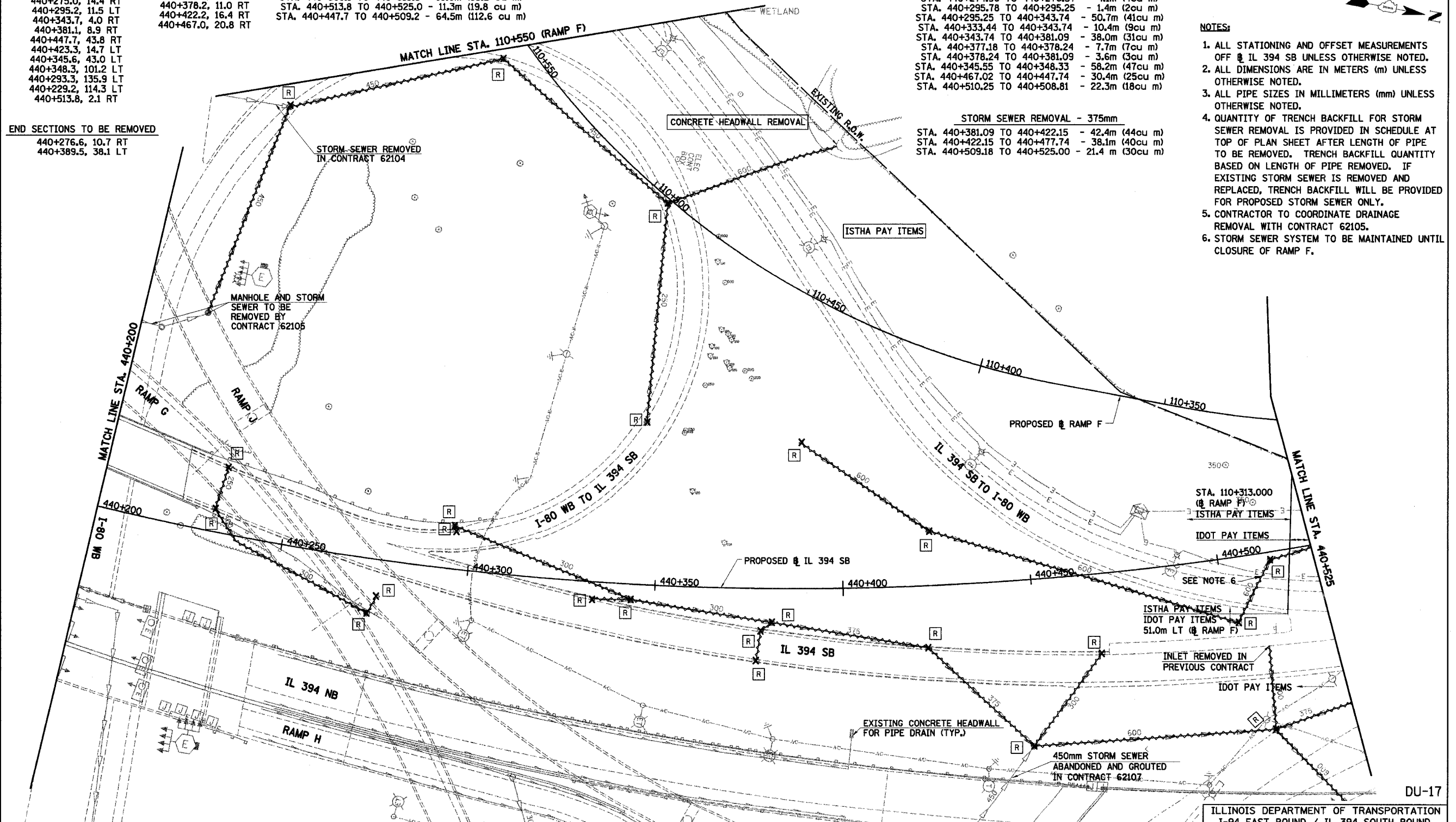

**LEGEND - EXISTING**

- |    |  |     |  |
|----|--|-----|--|
| ○  | EXISTING INLET                         | REC | EXISTING DRAINAGE STRUCTURE RECONSTRUCTED  |
| ○  | EXISTING CATCH BASIN                   | A   | EXISTING FRAMES AND GRATES ADJUSTMENT      |
| ○  | EXISTING MANHOLE                       | C   | EXISTING DRAINAGE STRUCTURES TO BE CLEANED |
| ⊠  | EXISTING MEDIAN DRAINAGE STRUCTURE     | →   | EXISTING STORM SEWER TO BE REMOVED         |
| ⊠  | EXISTING DRAINAGE STRUCTURE REMOVAL    | →   | EXISTING STORM SEWER                       |
| AD | EXISTING DRAINAGE STRUCTURE ADJUSTMENT | →   | EXISTING SLOTTED DRAIN                     |
| →  | EXISTING DITCH                         | →   | EXISTING PIPE UNDERDRAIN                   |

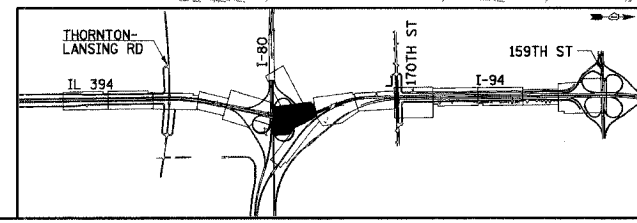

REVISIONS	
NAME	DATE

ILLINOIS DEPARTMENT OF TRANSPORTATION  
I-94 EAST BOUND / IL 394 SOUTH BOUND

**DRAINAGE AND UTILITIES**  
**IL 394 SB**  
**STA. 440+200 TO STA. 440+525**

HORIZ SCALE: 1:500  
VERT SCALE: 1:500  
DATE: JULY 18, 2005

DRAWN BY: JPH  
CHECKED BY: MAM

**HNTB**