

F.A.I. RTE	SECTION	COUNTY	TOTAL SHEETS NO.	SHEET NO.
80/94	*	COOK	870	376
STA. 39+500		TO STA. 39+850		
FED ROAD DIST. NO.		ILLINOIS FED. AID PROJECT		

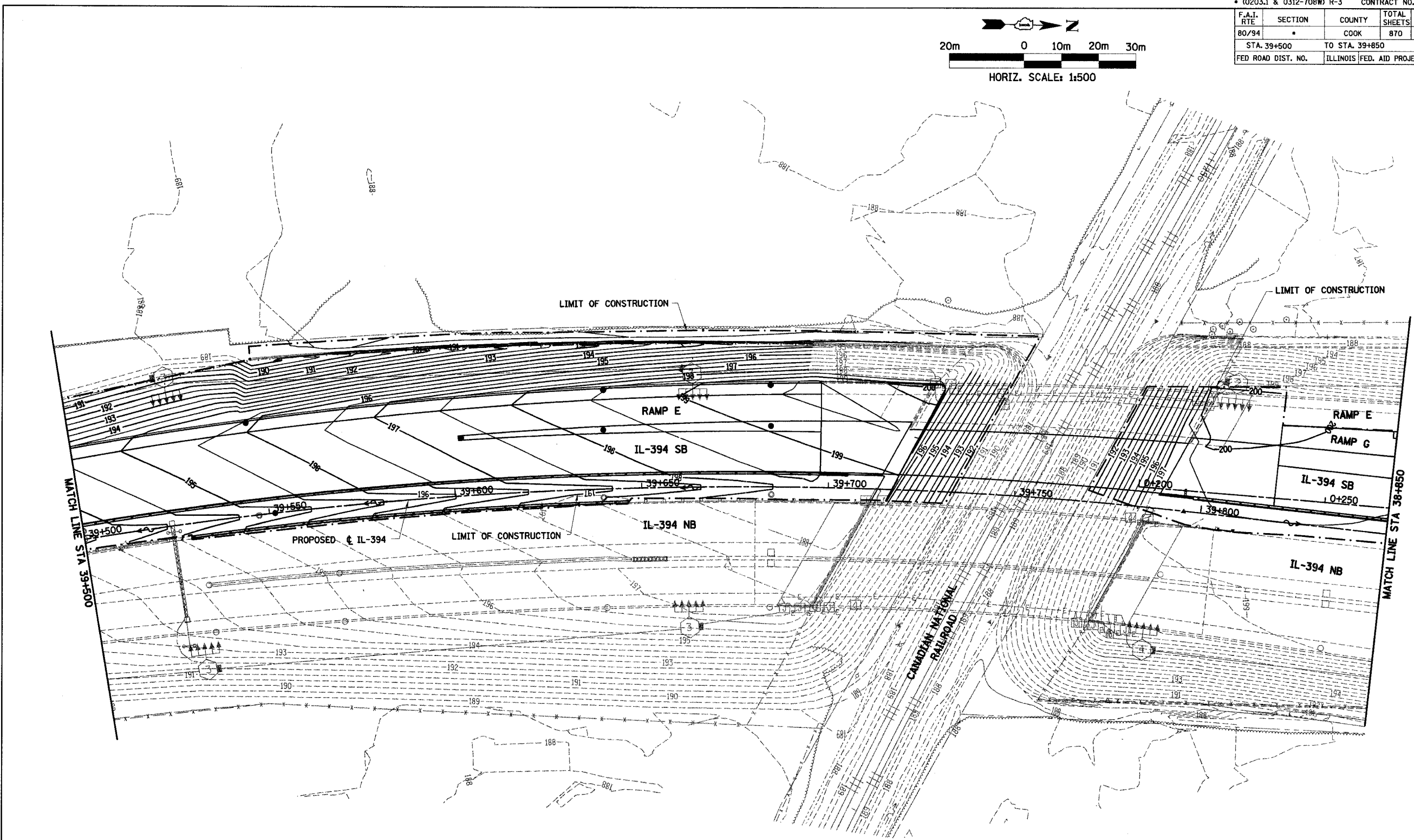

- LEGEND**
- 190--- EXISTING CONTOUR
 - - - - - EXISTING DITCH LINE
 - 190— PROPOSED CONTOUR
 - ~ ~ ~ PROPOSED DITCH FLOW
 - - - - - PROPOSED DITCH LINE
 - ||| PROPOSED SWALE
 - ▲▲▲▲▲ PROPOSED SUMMIT
 - PROPOSED MANHOLE
 - PROPOSED INLET
 - PROPOSED CATCH BASIN
 - ▼ PROPOSED END SECTION

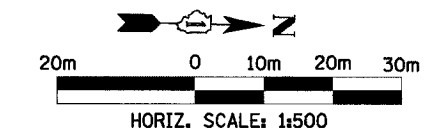
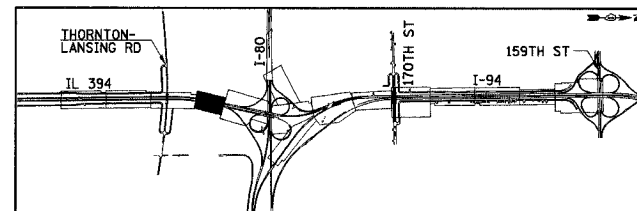

REVISIONS	
NAME	DATE

IG - 6

ILLINOIS DEPARTMENT OF TRANSPORTATION
I-94 EAST BOUND / IL 394 SOUTH BOUND

GRADING PLAN
IL-394
STA. 39+500 TO STA. 39+850

HORIZ SCALE: 1:500
VERT SCALE: 1:500
DATE: JULY 18, 2005

DRAWN BY: BAJ
CHECKED BY: JES