

F.A.I. RTE.	SECTION	COUNTY	TOTAL SHEETS	SHEET NO.
80/94	*	COOK	631	34
STA.		TO STA.		
FED. ROAD DIST. NO.		ILLINOIS FED. AID PROJECT		
* (2425 & 2626) R-2		CONTRACT NO. 62111		

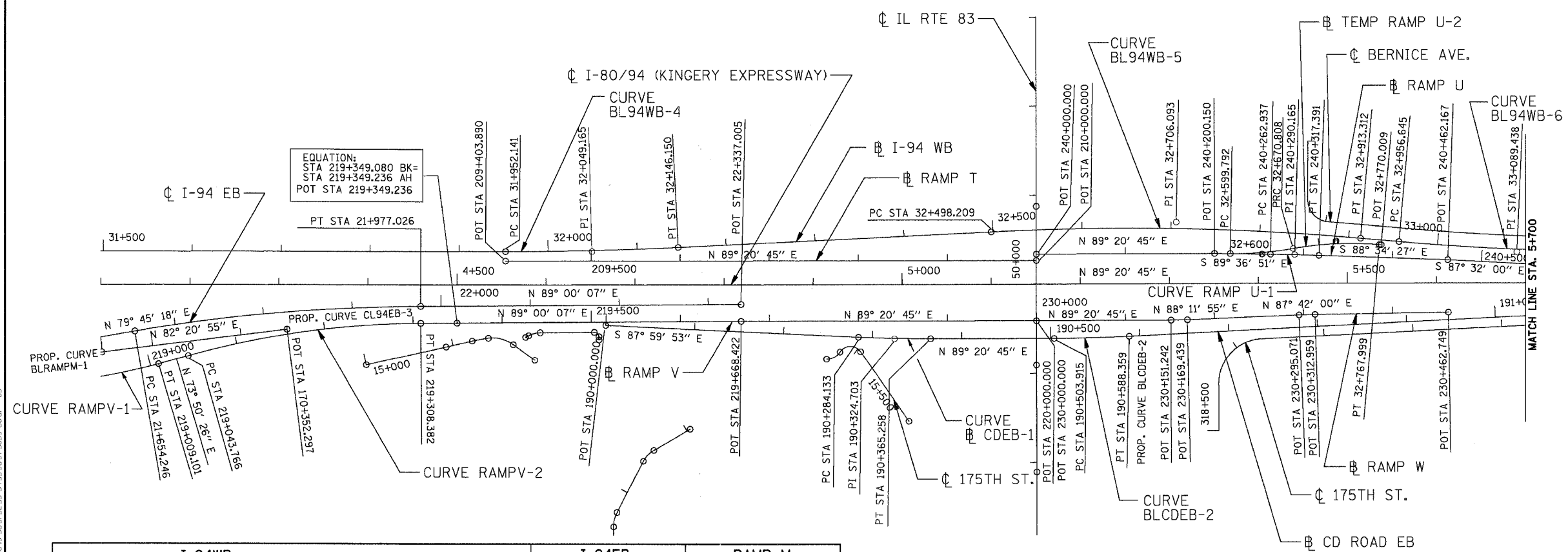

EQUATION:
 STA 219+349.080 BK=
 STA 219+349.236 AH=
 POT STA 219+349.236

BALZEXKJ
 1489900024.DGN, 1489900024.DGN, 1489900024.DGN
 8/18/2005 10:06:57
 1. ADD DOCUMENT 193776061.CWL.DGN, 193776061.CWL.DGN
 1.2, 3.4, 5.6, 7.9, 10, 11, 12, 13, 14, 15, 16, 17, 18, 19, 20, 21, 22, 23, 24, 25, 26, 27, 28, 29, 30, 31, 32, 33, 34, 35, 36, 37, 38, 39, 40, 41, 42, 43, 44, 45, 46, 47, 48, 49, 50, 51, 52, 53, 54, 55, 56, 57, 58, 59, 60, 61, 62, 63

I-94WB		I-94EB		RAMP M	
CURVE BL94WB-4	CURVE BL94WB-5	CURVE BL94WB-6	CURVE CL94EB-3	CURVE BLRAMP-1	
PI STA = 32+049.165 N = 545527.369 E = 364087.694 Δ = 2° 46' 44" (LT) R = 4,000.000 m T = 97.024 m L = 194.009 m E = 1.177 m	PI STA = 32+706.093 N = 545566.714 E = 364743.480 Δ = 7° 55' 40" (RT) R = 3,000.000 m T = 207.884 m L = 415.103 m E = 7.194 m	PI STA = 33+089.438 N = 545536.622 E = 365126.308 Δ = 5° 04' 08" (LT) R = 3,000.000 m T = 132.792 m L = 265.412 m E = 2.938 m	PI STA = 21+815.988 N = 545460.6774 E = 363734.212 Δ = 9° 14' 49.08" (RT) R = 2,000.000 m T = 161.741 m L = 322.780 m E = 6.529 m	PI STA = 170+071.763 N = 545398.612 E = 363467.306 Δ = 141° 22' 18.712" (LT) R = 569.190 m T = 71.763 m L = 142.774 m E = 4.506 m	
RAMP U		RAMP V		CD ROAD EB	
CURVE BLRAMPU-1	CURVE BLRAMPV-1	CURVE BLRAMPV-2	CURVE BLCDEB-1	CURVE BLCDEB-2	
PI STA = 240+290.165 N = 545531.145 E = 364876.938 Δ = 1° 02' 24" (RT) R = 3,000.000 m T = 27.228 m L = 54.454 m E = 0.124 m	PI STA = 218+857.928 N = 545351.814 E = 363451.193 Δ = 27° 10' 18.879" (LT) R = 650.000 m T = 157.083 m L = 308.255 m E = 18.711 m	PI STA = 219+176.852 N = 545442.219 E = 363763.193 Δ = 15° 09' 1.080" (RT) R = 1000.000 m T = 133.086 m L = 264.616 m E = 8.817 m	PI STA = 190+546.145 N = 545433.214 E = 364428.514 Δ = 2° 45' 53" (LT) R = 1,750.000 m T = 42.230 m L = 84.444 m E = 0.509 m	PI STA = 190+324.703 N = 545435.743 E = 364649.956 Δ = 2° 39' 22" (LT) R = 1,750.000 m T = 40.570 m L = 81.125 m E = 0.470 m	
				CURVE BLMU24-1	CURVE BLMU24-2
				PI STA = 32+635.41 N = 545531.392 E = 364840.159 Δ = 11° 08' 52" (LT) R = 365.000 m T = 35.621 m L = 71.016 m E = 1.734 m	PI STA = 32+719.690 N = 545547.172 E = 364923.178 Δ = 15° 15' 23" (RT) R = 365.000 m T = 48.885 m L = 97.191 m E = 3.259 m

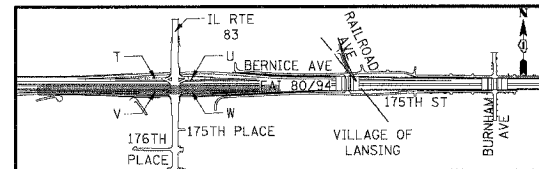

REVISIONS	
NAME	DATE

ILLINOIS DEPARTMENT OF TRANSPORTATION
 F.A.I. ROUTE 80/94 (KINGERY EXPRESSWAY)
 EB & WB INSIDE LANES (MAINLINE) CONSTRUCTION
 COOK COUNTY

**HORIZONTAL ALIGNMENT,
 TIES & BENCHMARKS**

SCALE: 1:2500
 DATE: 8/22/05

DRAWN BY: JFS
 CHECKED BY: MCD

TENG
 TENG & ASSOCIATES, INC.
 ENGINEERS/ARCHITECTS/PLANNERS
 CHICAGO, ILLINOIS