

F.A.I. RTE.	SECTION	COUNTY	TOTAL SHEETS	SHEET NO.
			631	100
STA.	TO STA.			
FED. ROAD DIST. NO.	ILLINOIS	FED. AID PROJECT		
• (2425 & 2626) R-2		CONTRACT NO. 62111		

ALL DIMENSIONS IN MILLIMETERS (INCHES)  
UNLESS OTHERWISE SHOWN.

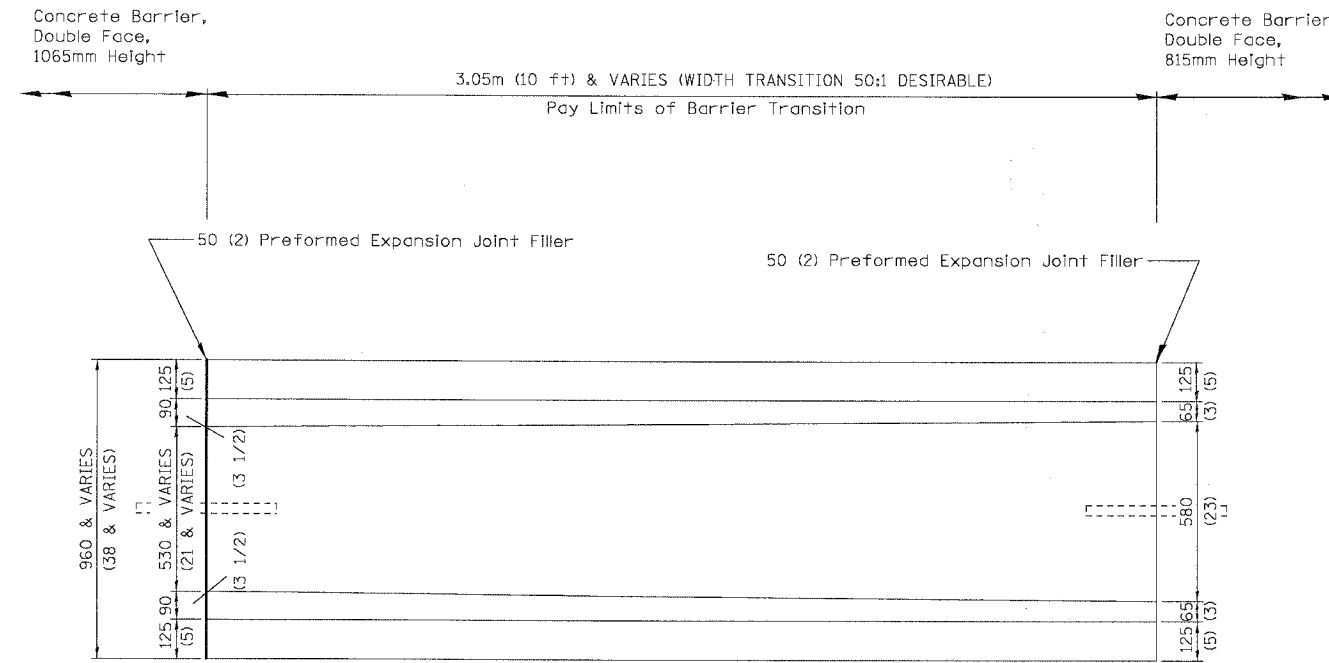

PLAN

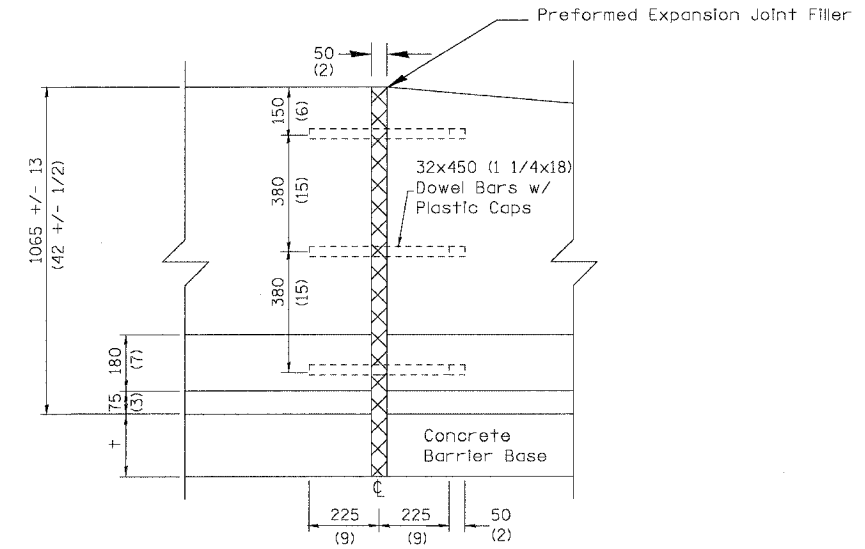

EXPANSION JOINT (TALL WALL)

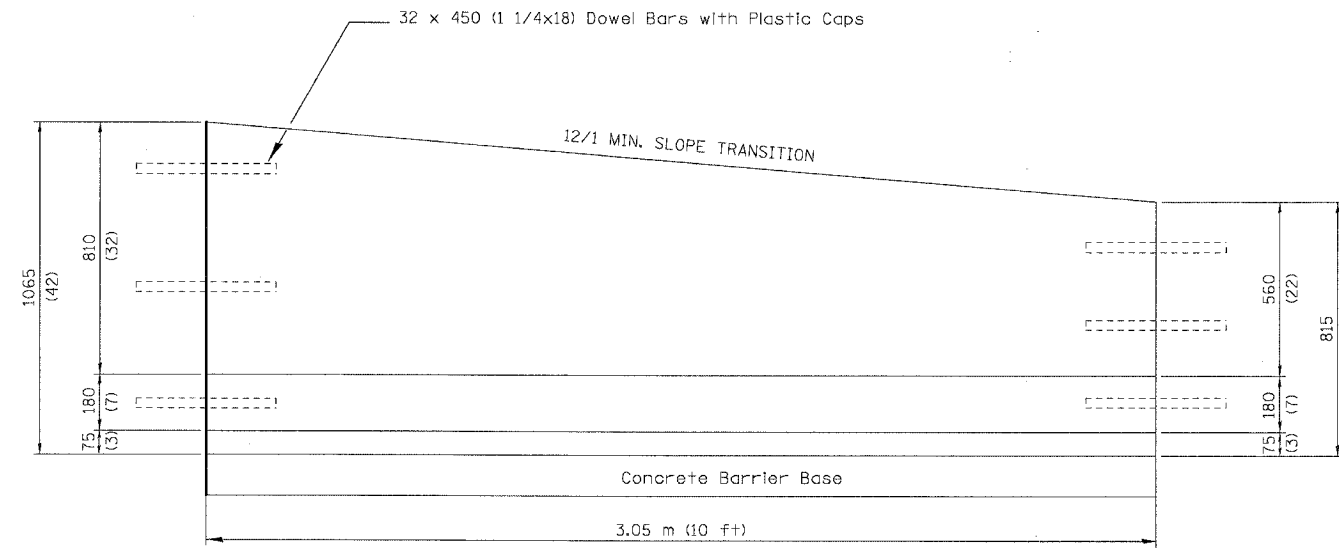

ELEVATION

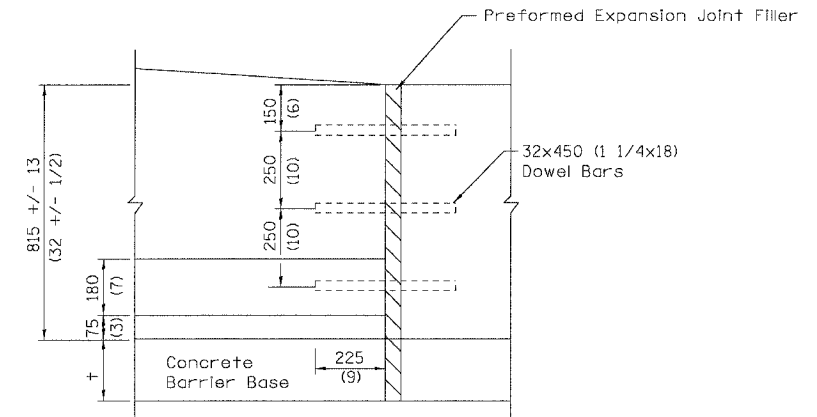

CONSTRUCTION JOINT (SHORT WALL)

NOTES:

- 1) FOR ADDITIONAL CONCRETE BARRIER DETAILS, INCLUDING TIE BAR PLACEMENT, SEE CONCRETE BARRIER DETAILS, OF THE HEIGHT SPECIFIED.
- 2) A 25 RADIUS CAN BE SUBSTITUTED FOR THE 13 CHAMFER AT THE TOP OF THE BARRIER WALL.
- 3) FOR BITUMINOUS SHOULDERS -- DEPTH "+" EQUALS 450 MINIMUM.
- 4) FOR PCC SHOULDERS -- DEPTH "+" SHALL BE 255 MINIMUM OR THE SHOULDER DEPTH IF GREATER.
- 5) SEE "CONCRETE BARRIER DETAILS" FOR ADDITIONAL NOTES AND DETAILS.
- 6) ALL REINFORCING BARS, BAR SPLICERS, TIE BARS AND DOWEL BARS SHALL BE SEATED IN THE FINAL POSITION PRIOR TO THE CONCRETE OPERATIONS. BARS CANNOT BE MUCKED INTO PLACE.

- 7) THE FURNISHING AND PLACING OF TIE BARS AND DOWEL BARS SHALL BE INCLUDED IN THE COST OF THE CONCRETE BARRIER TRANSITION.
- 8) FOR CONDUIT LOCATIONS, SIZE, AND DETAILS, SEE THE ELECTRICAL AND/OR SURVEILLANCE PLANS. THE FURNISHING AND PLACING OF CONDUITS OF THE SIZE SPECIFIED SHALL BE PAID FOR SEPARATELY. EXPANSION/DEFLECTION COUPLES SHALL BE INCLUDED IN THE COST OF THE CONDUITS, OF THE SIZE SPECIFIED.
- 9) LENGTH OF BARRIER TRANSITION SHALL BE EQUAL TO LONGEST TRANSITION REQUIRED.

REVISIONS	
NAME	DATE
MRN/MDV	06/04
MRN	4/20/05
MRN	8/04/05

ILLINOIS DEPARTMENT OF TRANSPORTATION  
F.A.I. ROUTE 80/94 (KINGERY EXPRESSWAY)

CONCRETE BARRIER TRANSITION  
DETAILS

SCALE NONE  
DATE 6/04

DRAWN BY ACE/CAD  
CHECKED BY



C:\CONCRETE\TRANSITION.DGN  
 8-16-2005, 10:09:32  
 T:\DOCUMENT\131750\CVL\09\PROJ\09A.DGN  
 12.3.4.5.6.7.8.9.10.11.12.13.14.15.16.17.18.19.20.21.22.23.24.25.26.27.28.29.30.31.32.33.34.35.36.37.38.39.40.41.42.43.44.45.46.47.48.49.50.51.52.53.54.55.56.57.58.59.60.61.62.63  
 BAJZEKJ