

F.A.I. RTE.	SECTION	COUNTY	TOTAL SHEETS	SHEET NO.
80/94		COOK	631	162
STA.		TO STA.		
FED. ROAD DIST. NO.		ILLINOIS	FED. AID PROJECT	
• (2425 & 2626) R-2		CONTRACT NO. 62111		

LEGEND

- ① EPOXY PAVEMENT MARKING - LETTERS AND SYMBOLS
- ② EPOXY PAVEMENT MARKING - 100mm (WHITE)
- ③ EPOXY PAVEMENT MARKING - 100mm (YELLOW)
- ④ EPOXY PAVEMENT MARKING - 150mm (WHITE)
- ⑤ EPOXY PAVEMENT MARKING - 200mm (WHITE)
- ⑥ EPOXY PAVEMENT MARKING - 300mm (WHITE)
- ⑦ EPOXY PAVEMENT MARKING - 300mm (YELLOW)
- ⑧ EPOXY PAVEMENT MARKING - 600mm (WHITE)
- ⑨ PAVEMENT MARKING TAPE, TYPE III - LETTERS AND SYMBOLS
- ⑩ PAVEMENT MARKING TAPE, TYPE III - 100mm (WHITE)
- ⑪ PAVEMENT MARKING TAPE, TYPE III - 100mm (YELLOW)
- ⑫ PAVEMENT MARKING TAPE, TYPE III - 125mm (WHITE)
- ⑬ PAVEMENT MARKING TAPE, TYPE III - 150mm (WHITE)
- ⑭ PAVEMENT MARKING TAPE, TYPE III - 200mm (WHITE)
- ⑮ PAVEMENT MARKING TAPE, TYPE III - 300mm (WHITE)
- ⑯ PAVEMENT MARKING TAPE, TYPE III - 300mm (YELLOW)
- ⑰ PAVEMENT MARKING TAPE, TYPE III - 600mm (WHITE)

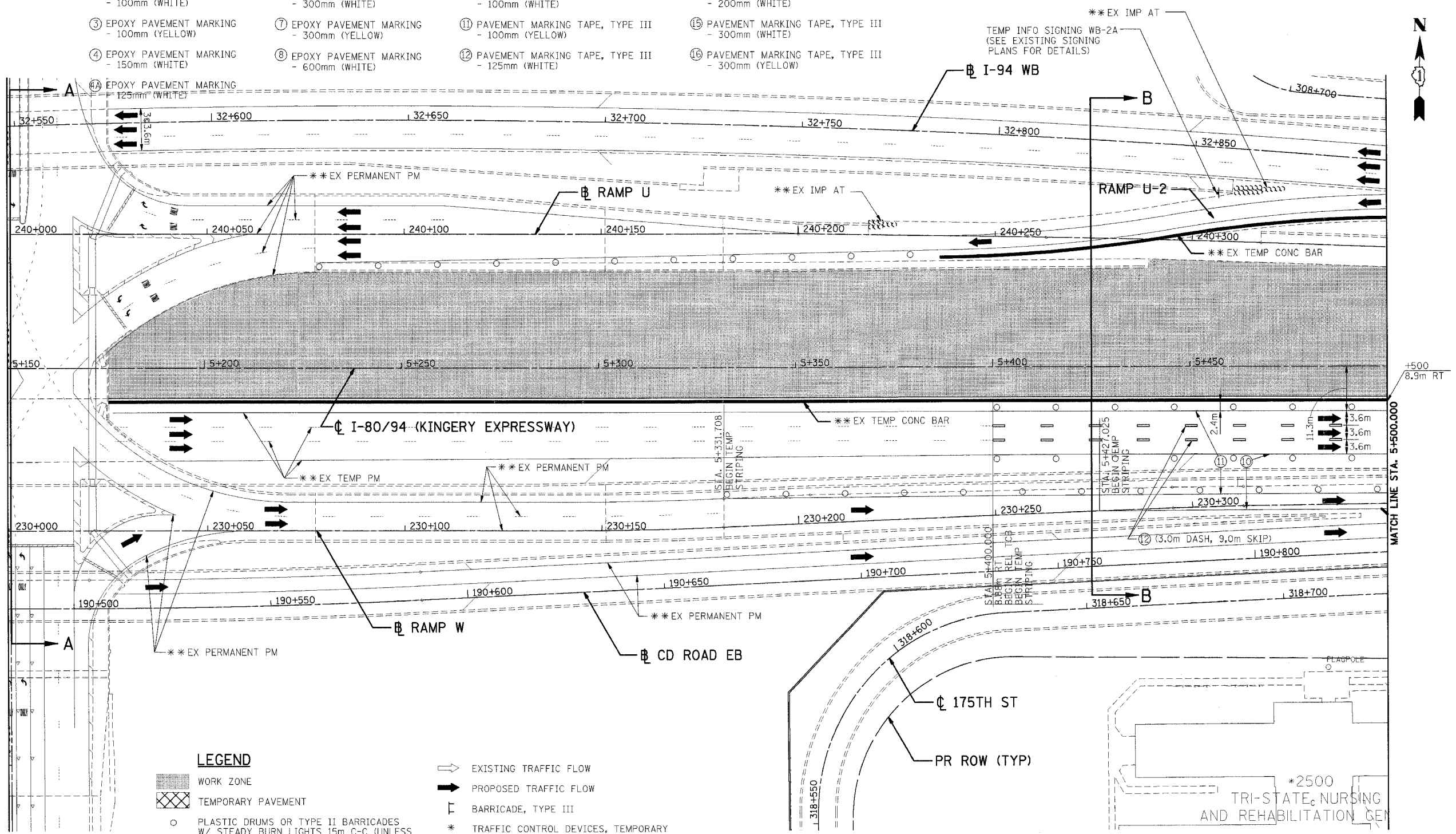

LEGEND

- WORK ZONE
- TEMPORARY PAVEMENT
- PLASTIC DRUMS OR TYPE II BARRICADES W/ STEADY BURN LIGHTS 15m C-C (UNLESS OTHERWISE SHOWN)
- TEMPORARY CONCRETE BARRIER
- TYPE II BARRICADES WITH FLASHING LIGHT
- SIGN
- EXISTING TRAFFIC FLOW
- PROPOSED TRAFFIC FLOW
- BARRICADE, TYPE III
- TRAFFIC CONTROL DEVICES, TEMPORARY CONCRETE BARRIER, TEMPORARY MSE WALLS, TEMPORARY SHEET PILING AND TEMPORARY STRIPING FROM A PREVIOUS STAGE
- FROM PREVIOUS CONTRACT
- SHEET PILING

NOTE: DIMENSIONS TO TEMP CONC BARRIER ARE TO THE BOTTOM FACE OF THE BARRIER CLOSEST TO TRAFFIC.

\HRT0022A.DGN, \APR17002A.DGN, \HRT002A.DGN, \TRIT002A.DGN, \A899002A.DGN, \N171702A.DGN, \N171702A.DGN
 9-15-2005, 16:22:26
 T:\DOCUMENTS\193050\01\01\CIVIL\00\N171702A.DGN
 1, 2, 3, 4, 5, 6, 7, 8, 9, 10, 11, 12, 13, 14, 15, 16, 17, 18, 19, 20, 21, 22, 23, 24, 25, 26, 27, 28, 29, 30, 31, 32, 33, 34, 35, 36, 37, 38, 39, 40, 41, 42, 43, 44, 45, 46, 47, 48, 49, 50, 51, 52, 53, 54, 55, 56, 57, 58, 59, 60, 61, 62, 63
 HANSENDD

REVISIONS	
NAME	DATE

ILLINOIS DEPARTMENT OF TRANSPORTATION
 F.A.I. ROUTE 80/94 (KINGERY EXPRESSWAY)
 EB & WB INSIDE LANES (MAINLINE) CONSTRUCTION
 COOK COUNTY

**MAINTENANCE OF TRAFFIC
 FAI 80/94 - PHASE III, STAGE II
 STA. 5+150 TO STA. 5+500**

SCALE: 1:500
 DATE: 9/13/05

DRAWN BY: DP
 CHECKED BY: JP

TENG
 TENG & ASSOCIATES, INC.
 ENGINEERS/ARCHITECTS/PLANNERS
 CHICAGO, ILLINOIS