

F.A.I.	SECTION	COUNTY	TOTAL SHEETS	SHEET NO.
94/90	*	COOK	419	BB
STA.	TO STA.			
FED. ROAD DIST. NO.	ILLINOIS	FED. AID PROJECT		
62580 * (I818, ETC, 2324.6-1P)R-9				

FOR INFORMATION ONLY

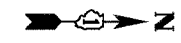

MATCH LINE B-B

MATCH LINE A-A

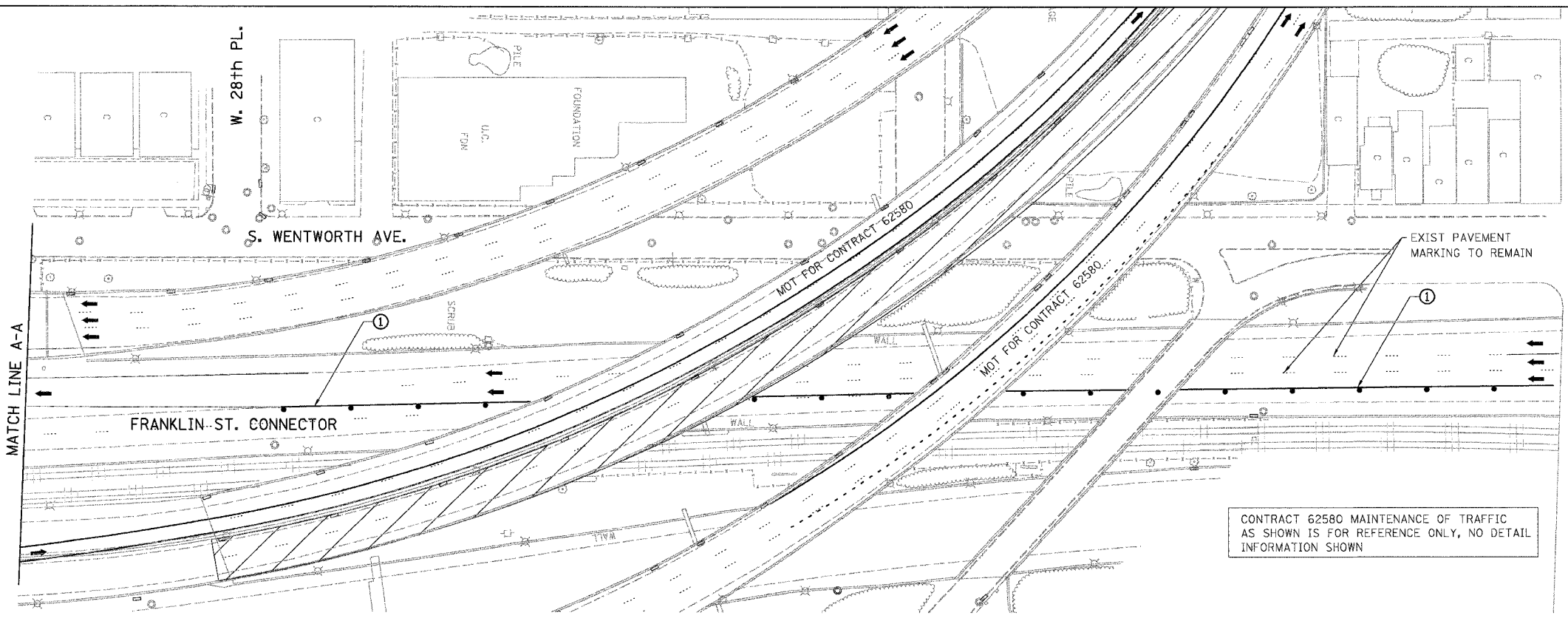

**LEGEND**

- WORK ZONE
- TEMPORARY PAVEMENT
- ALL TRAFFIC LANE & DIRECTION OF TRAFFIC
- DRUM OR BARRICADE TYPE II WITH STEADY BURN LIGHT
- IMPACT ATTENUATORS, TEMPORARY (NON-REDIRECTIVE), TEST LEVEL 3
- BARRICADE TYPE III
- TEMPORARY CONCRETE BARRIER
- LINE 4" (YELLOW EDGE LINE)
- LINE 4" (WHITE EDGE LINE)
- LINE 4" (SKIP DASH, 6' SKIP - 2' DASH, WHITE)
- LINE 5" (SKIP DASH, 30' SKIP - 10' DASH, WHITE)
- LINE 8" (WHITE GORE LINE)
- LINE 8" (SKIP DASH, 12' SKIP - 3' DASH, WHITE)
- LINE 12" (DIAGONAL, 30' C-C)
- LINE 12" (DIAGONAL, 500' C-C)
- LETTERS AND SYMBOLS
- EXISTING SIGNS
- TEMPORARY SIGNS

**STATIONING**

- +###.## STATION PROVIDED FROM THE I-90/94 EXPRESS LANES
- (+###.##) STATION PROVIDED FROM THE I-90/94 LOCAL LANES
- [+###.##] STATION PROVIDED FROM THE SLIP RAMP

**NOTE:**

ALL PAVEMENT MARKINGS ON THIS SHEET WILL BE PAVEMENT MARKING TAPE, TYPE III, UNLESS OTHERWISE NOTED.

MOT-21

MATCH LINE B-B

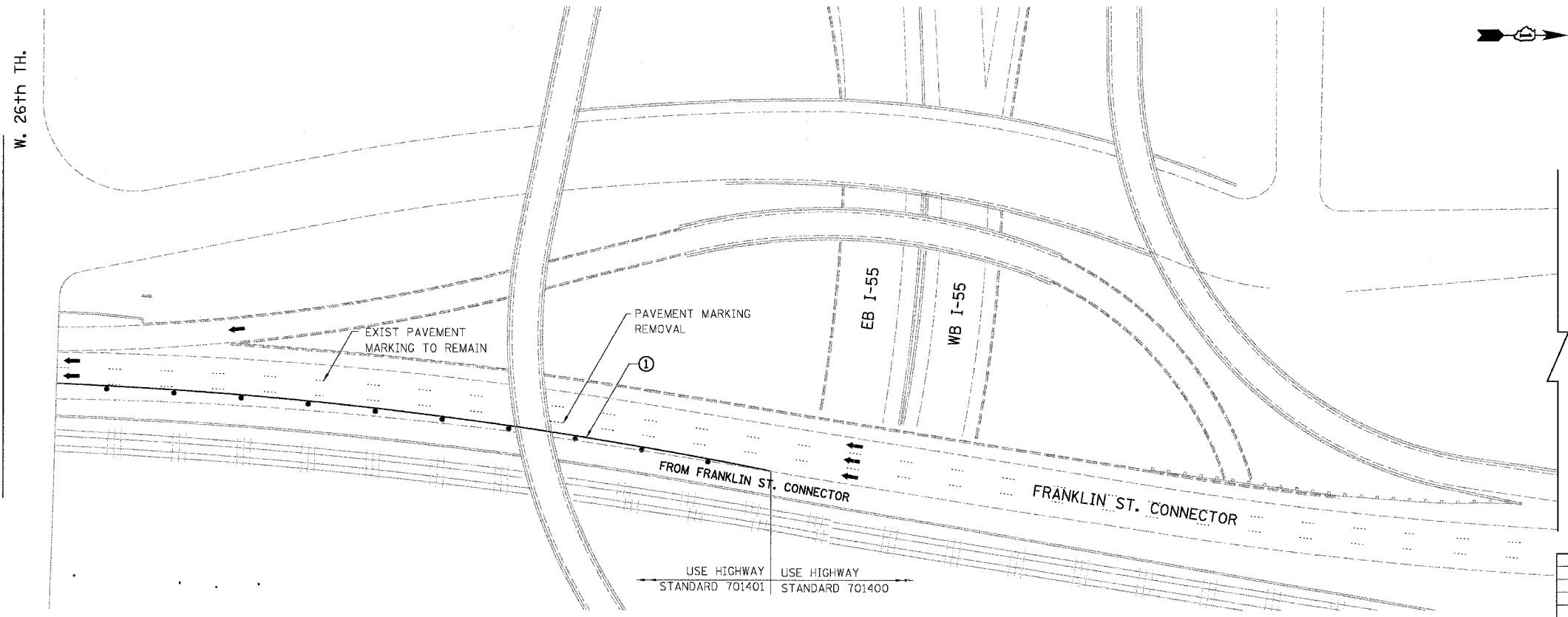

REVISIONS	
NAME	DATE

ILLINOIS DEPARTMENT OF TRANSPORTATION  
 F.A.I. 94/90 (DAN RYAN EXPRESSWAY)  
 31ST STREET TO 71ST STREET  
 SB EXPRESS LANE RECONSTRUCTION  
 MAINTENANCE OF TRAFFIC PLAN STAGE 1  
 SOUTHBOUND STA. TO STA.  
 SCALE: 1"=50'  
 DATE: 7/22/2005  
 DRAWN BY: RA  
 CHECKED BY: RS

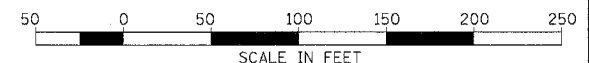

BOWMAN, BARRETT & ASSOCIATES INC.  
 CONSULTING ENGINEERS  
 Chicago, Illinois  
 312.228.0100  
 www.bbandainc.com

7/19/2005 2:02:27 PM