

F.A.I.	SECTION	COUNTY	TOTAL SHEETS	SHEET NO.
94/90	2003-028F	COOK	419	124
STA.	TO STA.			
FED. ROAD DIST. NO.	ILLINOIS	FED. AID PROJECT		
62580				

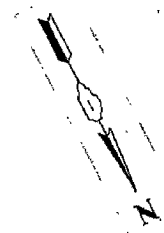
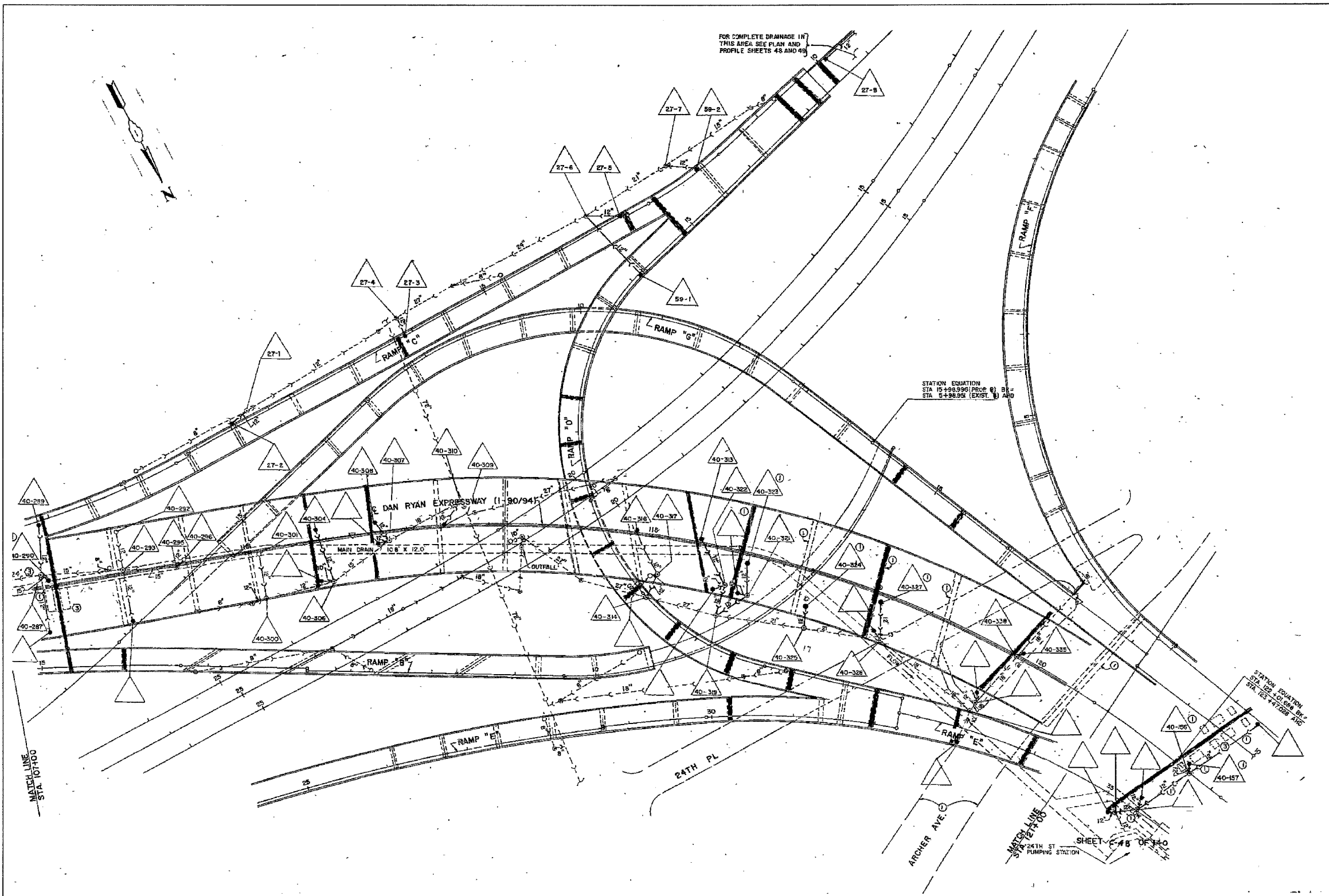

FOR COMPLETE DRAINAGE IN THIS AREA SEE PLAN AND PROFILE SHEETS 48 AND 49

STATION EQUATION  
STA 15+98.996 (PROP. 0) BR -  
STA 5+38.95 (EXIST. 1) AND

STATION EQUATION  
STA 12+10.000 (BR -)  
STA 12+47.000 (ARC)

MATCH LINE  
STA. 10+100

MATCH LINE  
STA. 15+000  
PUMPING STATION

NOTE:  
Information from 1988-89 As-Builts to show probable location of existing catch basins collecting bridge drainage. Field verify location with Engineer. Clean all catch basins receiving drainage from NB viaduct.

FOR INFORMATION ONLY

BOWMAN, BARRETT & ASSOCIATES INC.  
CONSULTING ENGINEERS  
Chicago, Illinois  
312.228.0100  
www.bbainc.com

REVISIONS	
NAME	DATE

ILLINOIS DEPARTMENT OF TRANSPORTATION  
F.A.I. 94/90 (DAN RYAN EXPRESSWAY)  
NB DAN RYAN ELEVATED BRIDGE  
REPAIR FROM 15TH TO 28TH STREETS  
EXISTING DRAINAGE SYSTEM  
DETAILS  
SCALE: NTS  
DATE: 7/22/2005  
DRAWN BY: BDC  
CHECKED BY: BLU

5:05:55 PM  
7/20/2005