

62580

SECTION	COUNTY	TOTAL SHEETS	SHEET NO.
		419	414
STA. TO STA.		FED. AID PROJECT	
FED. ROAD DIST. NO. 7		ILLINOIS	

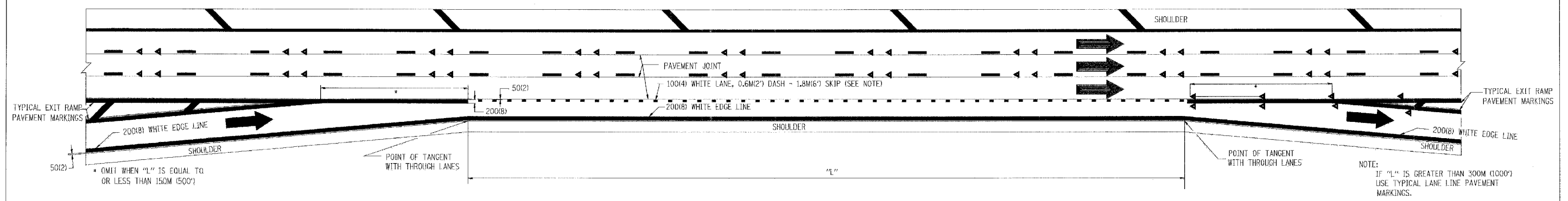

TYPICAL ENTRANCE/EXIT RAMP COMBINATION PAVEMENT MARKINGS

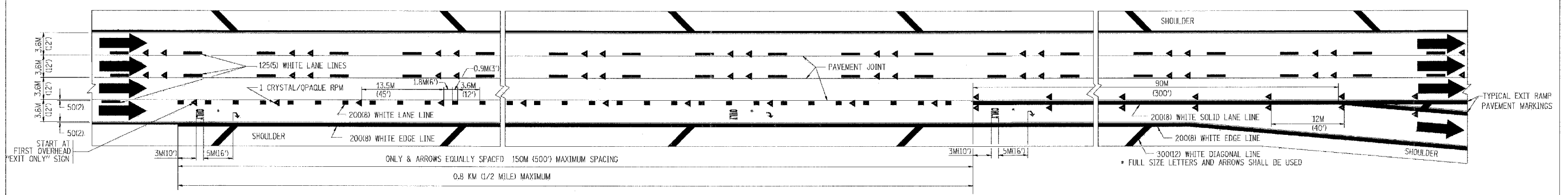

TYPICAL EXIT ONLY LANE PAVEMENT MARKINGS

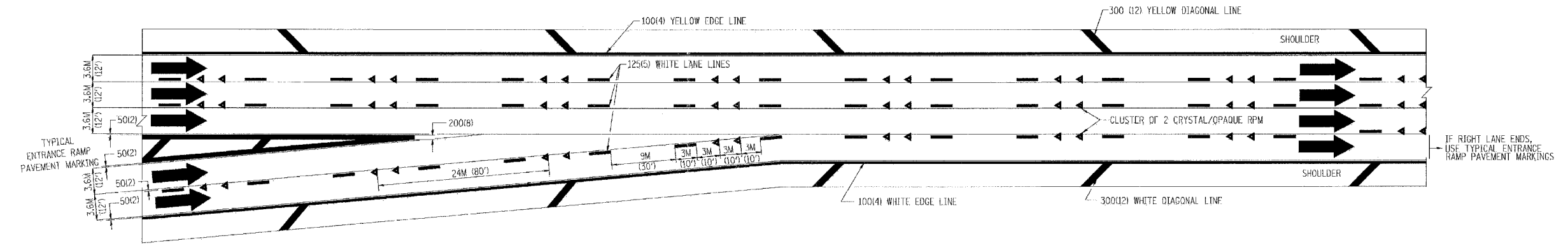

TYPICAL TWO LANE ENTRANCE RAMP PAVEMENT MARKINGS

ILLINOIS DEPARTMENT OF TRANSPORTATION

MULTI-LANE FREEWAY PAVEMENT MARKING DETAILS

REVISIONS	
NAME	DATE
DWS	1/90
DWS	5/91

SCALE: NONE
 DATE: 10/18/2002
 DRAWN BY C.A.D.D.
 CHECKED BY TC12 SHEET 2 OF 2
 REVISION DATE: 01/01/96

DATE-TIME
 DOW-SPEC
 VHTC12