

F.A.U. RTE.	SECTION	COUNTY	TOTAL SHEETS	SHEET NO.
1332	2004-022TS	COOK	20	18
STA.	TO STA.			
FED. ROAD DIST. NO.	ILLINOIS		FED. AID PROJECT	
CONTRACT NO. 62741				

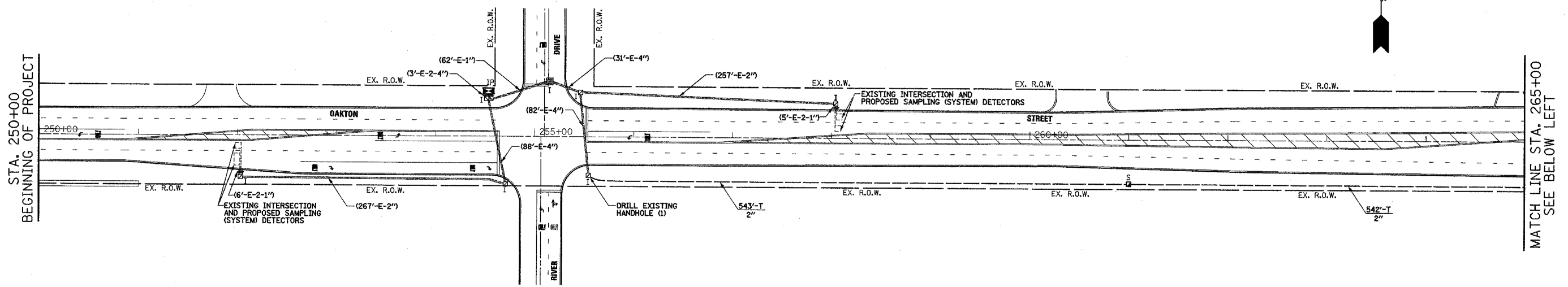

INTERCONNECT PLAN LEGEND

	PROPOSED	EXISTING
CONTROLLER		
HANDHOLE		
DOUBLE HANDHOLE		
HEAVY DUTY HANDHOLE		
G.S. CONDUIT IN TRENCH (T) OR PUSHED (P)		
DETECTOR LOOP		
UNIT DUCT SYSTEM	UD S	
INTERSECTION	IP	I
TELEPHONE CONNECTION		
MASTER CONTROLLER	MC	

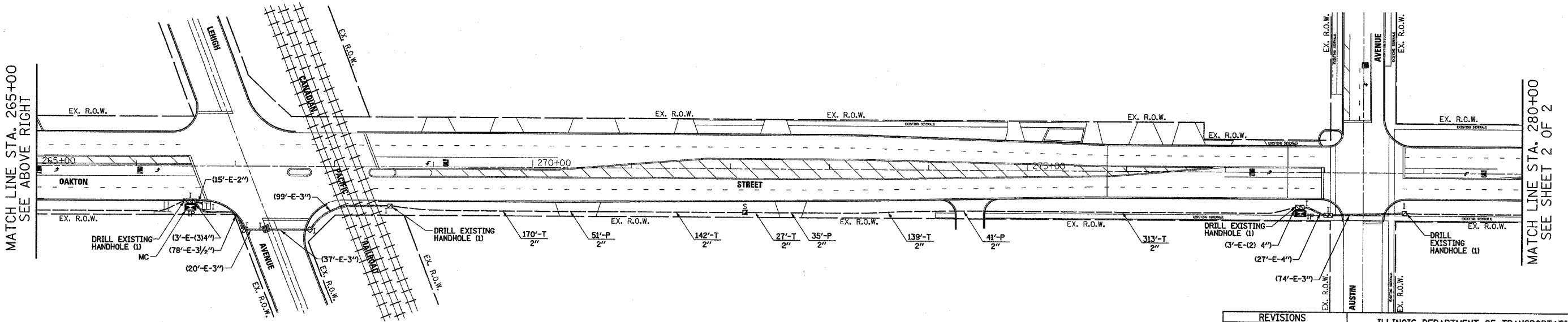

REVISIONS	
NAME	DATE

**SETON ENGINEERING**  
 SERVICE CORPORATION  
 CIVIL ENGINEERS  
 19 S. BOTHWELL STREET  
 PALATINE, ILLINOIS 60067  
 VOICE: 847-776-7200 FAX: 847-776-7239

ILLINOIS DEPARTMENT OF TRANSPORTATION  
**INTERCONNECT PLAN**  
 OAKTON AVENUE  
 FROM RIVER DRIVE TO AUSTIN AVENUE  
 MORTON GROVE, IL  
 SHEET 1 OF 2  
 SCALE: 1" = 50'  
 DATE 09-20-2004  
 DRAWN BY BR  
 DESIGNED BY YO  
 CHECKED BY TJM