

F.A.E. RTE.	SECTION	COUNTY	TOTAL SHEETS	SHEET NO.
573	1168-4	DEKALB	416	2
STA. _____		TO STA. _____		
FED. ROAD DIST. NO. _____		ILLINOIS FED. AID PROJECT		

## INDEX OF SHEETS

1	COVER SHEET
2	INDEX OF SHEETS AND STANDARDS
3 - 8	SUMMARY OF QUANTITIES
9 - 12	GENERAL NOTES
13 - 27	TYPICAL SECTIONS
28 - 33	HORIZONTAL AND VERTICAL CONTROL
34 - 51	SCHEDULE OF QUANTITIES
52 - 55	EARTHWORK SCHEDULE
56 - 57	SEEDING SCHEDULE
58	BITUMINOUS SCHEDULE
59 - 60	ENTRANCE SCHEDULE
61 - 69	DRAINAGE SCHEDULE
70 - 97	PLAN AND PROFILE
98 - 139	DRAINAGE DETAILS AND EROSION CONTROL
139A	JACKING DETAIL
140 - 155	PAVEMENT ELEVATION
156 - 169	PAVEMENT MARKING, RIGHT OF WAY AND EASEMENTS
170 - 176	SIDEWALK VAULT LOCATIONS AND DETAILS
177 - 230	STAGING DETAILS
231 - 250	REMOVAL DETAILS
251	PCC SIDEWALK 5" (SPECIAL) DETAIL
252 - 253	BORING LOGS
254	STAIR DETAIL
255	SIDEWALK DETAILS / ISLAND PAVEMENT REMOVAL AND REPLACEMENT DETAIL
256	TREE GRATE DETAIL
257	SANITARY MANHOLE FRAME AND COVER SANITARY MANHOLE
258	OUTSIDE DROP MANHOLE CONNECTION WATER AND SEWER TRENCH CROSS SECTION FOR PVC PIPE CURB AND GUTTER OUTLET, SPECIAL (18.4)
259	DETAIL OF BITUMINOUS SHOULDER AT GUARD RAIL (23.4) BITUMINOUS SHOULDER (23.4A) SIDEWALK AND DRIVEWAY PAVEMENT PAY AREAS (35.4)
260	DELINEATOR AND POST ORIENTATION (37.4) WITNESS MARKER FOR PERMANENT SURVEY MARKERS TYPE II (38.4) REFERENCE MARKERS (63.4) DETAIL OF CONCRETE STEPS (71.4)
261	INLET SPECIAL NO. 3 (79.4) INLET SPECIAL NO. 4 (79.4A) INLET SPECIAL NO. 5 (79.4B) STORM SEWER REMOVAL DETAIL
262	NOSE TYPE FOR INLET TOP SLAB (79.4D) INLET SPECIAL NO. 3, 4, 5, 6 REINFORCEMENT DETAIL (79.4E) DRAIN FOR AGGREGATE BASES IN URBAN AREAS (88.4) TREE REPLACEMENT SCHEDULE (90.4)
263	TYPICAL MARKING FOR PAINTED ISLANDS (93.4) DRAIN FOR AGGREGATE BASE COURSE (96.4)
264	INLET SPECIAL (10.2) STANDARD INLET FOR CURB AND GUTTER TYPE B - 6.24 (21.2)
265	EROSION CONTROL DETAILS FOR SILT FENCE (29.2) FIELD TILE JUNCTION VAULTS 600 (24) AND 900 (36) DIA. (30.2)
266	SUPERELEVATION TRANSITION ON TWO - LANE HIGHWAY (45.2) BITUMINOUS APPROACHES AND MAILBOX RETURNS FOR TWO LIFT (3P) RESURFACING PROJECTS (47.2)
267	DISABLED RAMP DETAIL (60.2) PIPE HANDRAILS FOR STEPS (63.2)
267A	MECHANICAL JOINTS FOR CONCRETE PIPE AND BOX CULVERTS (90.2)
268	THREE CENTER CURVE DATA / TWO CENTER CURVE DATA (92.2) SPECIAL FRAME AND GRATE
269	STORM WATER POLLUTION PREVENTION PLAN EROSION CONTROL PLAN (2.1)
270	MAILBOX TURNOUT IN CURB AND GUTTER SECTION (3.1)
271	PC CONCRETE ISLANDS AND MEDIANS ACCESSIBLE TO THE DISABLED (4.1)
272	BITUMINOUS APPROACHES AND MAILBOX RETURNS (20.1)
273	ENTRANCE APPROACHES - URBAN AREA (25.1)
274	SEWER AND WATER MAIN CROSSINGS (32.1)
275	DELETED
276	CORRUGATED STEEL PIPE MULTIPLE END SECTIONS (34.1)
277	TRAFFIC CONTROL FOR ROAD CLOSURE (40.1)
278 - 278A	TYPICAL PAVEMENT MARKINGS (41.1)
279	DETAILS OF PLANTING AND BRACING TREES (92.1)
280 - 377	US 30 CROSS SECTIONS
378 - 409	SIDE ROAD CROSS SECTIONS
410 - 416	STORM SEWER CROSS SECTIONS

## STATE STANDARDS

000001-04	STANDARD SYMBOLS, ABBREVIATIONS, AND PATTERNS
001001	AREAS OF REINFORCEMENT REBARS
280001-02	TEMPORARY EROSION CONTROL SYSTEMS
420001-06	PAVEMENT JOINTS
424001-04	CURB RAMPS FOR SIDEWALKS
482001	BITUMINOUS SHOULDER ADJACENT TO FLEXIBLE PAVEMENT
482011-01	BITUMINOUS SHOULDER STRIPS / SHOULDERS WITH RESURFACING OR WIDENING AND RESURFACING PROJECTS
542301	PRECAST REINFORCED CONCRETE FLARED END SECTION
542401	METAL END SECTIONS FOR PIPE CULVERTS
601001	SUB-SURFACE DRAINS
602101-01	DRAINAGE STRUCTURES, TYPES 1,2,&3
602306	INLET, TYPE B
602401	MANHOLE TYPE A
602601	PRECAST REINFORCED CONCRETE FLAT SLAB TOP
602701	CAST IRON STEPS
604001-02	FRAME AND LIDS TYPE 1
604026-01	FRAME AND GRATE, TYPE 6
604041-01	FRAME AND GRATE, TYPE 9
606001-02	CONCRETE CURB TYPE B AND COMBINATION CONCRETE CURB AND GUTTER
606201	TYPE B GUTTER (INLET, OUTLET, AND ENTRANCE)
606301-02	P.C. CONCRETE ISLANDS AND MEDIANS
630001-05	STEEL PLATE BEAM GUARDRAIL
630201-03	PCC / BITUMINOUS STABILIZATION AT STEEL PLATE BEAM GUARDRAIL
630301-03	SHOULDER WIDENING FOR TYPE 1 GUARDRAIL TERMINALS
635001	DELINEATORS
635006-02	REFLECTOR AND TERMINAL MARKER PLACEMENT
635011-01	REFLECTOR MARKER AND MOUNTING DETAILS
666001	RIGHT OF WAY MARKERS
667101	PERMANENT SURVEY MARKERS
701006-02	OFF - ROAD OPERATIONS, 2L, 2W, 4.5M (15') TO 600MM (24") FROM PAVEMENT EDGE
701011-01	OFF - ROAD MOVING OPERATIONS, 2L, 2W, DAY ONLY
701301-02	LANE CLOSURE, 2L, 2W, SHORT TIME OPERATIONS
701311-02	LANE CLOSURE, 2L, 2W, MOVING OPERATIONS - DAY ONLY
701326-02	LANE CLOSURE, 2L, 2W, PAVEMENT WIDENING FOR SPEEDS ≥ 45 MPH
701331-02	LANE CLOSURE, 2L 2W, WITH RUN - AROUND, FOR SPEEDS ≥ 45 MPH
701501-03	URBAN LANE CLOSURE, 2L, 2W, UNDIVIDED
701502-01	URBAN LANE CLOSURE, 2L, 2W, WITH BIDIRECTIONAL LEFT TURN LANE
701801-03	LANE CLOSURE, MULTILANE, 1W OR 2W CROSSWALK OR SIDEWALK CLOSURE
702001-05	TRAFFIC CONTROL DEVICES
720011	METAL POST FOR SIGNS, MARKERS, AND DELINEATORS
781001-02	TYPICAL APPLICATIONS RAISED REFLECTIVE PAVEMENT MARKERS

PLOT DATE = Fri, Oct 21, 10:27:45, 2005  
 FILE NAME = c:\prow\prow\201708\1708\1708.dgn  
 PLOT SCALE = 50.0000 / 1 IN.  
 USER NAME = palzinaj

REVISED  
10-31-05

F.A.P. RTE.	SECTION	COUNTY	TOTAL SHEETS	SHEET NO.
513	J168-4	DEKALB	416	3
STA.	TO STA.			
FED. ROAD DIST. NO.	ILLINOIS FED. AID PROJECT			

CODE NUMBER	PAY ITEMS	UNIT	80% FED / 20% STATE TOTAL QUANTITY 1 000-2A
20100110	TREE REMOVAL (6 TO 15 UNITS DIAMETER)	UNIT	101
20100210	TREE REMOVAL (OVER 15 UNITS DIAMETER)	UNIT	581
20100500	TREE REMOVAL (ACRES)	ACRES	0.5
20200100	EARTH EXCAVATION	CU YD	42,730
20800150	TRENCH BACKFILL	CU YD	5,812
21001000	GEOTECHNICAL FABRIC FOR GROUND STABILIZATION	SQ YD	210
* 21101615	TOPSOIL FURNISH AND PLACE, 4"	SQ YD	18,610
21301052	EXPLORATION TRENCH 52" DEPTH	FOOT	350
* 25000400	NITROGEN FERTILIZER NUTRIENT	POUND	553
* 25000500	PHOSPHORUS FERTILIZER NUTRIENT	POUND	553
* 25000600	POTASSIUM FERTILIZER NUTRIENT	POUND	553
△ 25000750	MOWING	ACRE	2.5
* 25000910	SEEDING, CLASS 1 (MODIFIED)	ACRE	2.50
* 25001830	SEEDING CLASS 6 (MODIFIED)	ACRE	1.25
25100115	MULCH, METHOD 2	ACRE	3.75
* 25200100	SODDING	SQ YD	18,610
25200200	SUPPLEMENTAL WATERING	UNIT	837.4
28000250	TEMPORARY EROSION CONTROL SEEDING	POUND	2,970
28000300	TEMPORARY DITCH CHECKS	EACH	18
28000400	PERIMETER EROSION BARRIER	FOOT	3,984
28000500	INLET AND PIPE PROTECTION	EACH	9
28100107	STONE RIPRAP, CLASS A4	SQ YD	88
28200200	FILTER FABRIC	SQ YD	88
31100100	SUB-BASE GRANULAR MATERIAL, TYPE A	TON	50,481
31100910	SUB-BASE GRANULAR MATERIAL, TYPE A 12"	SQ YD	27
31100965	SUB-BASE GRANULAR MATERIAL, TYPE A 24"	SQ YD	5
35100100	AGGREGATE BASE COURSE, TYPE A	TON	11,083
35101400	AGGREGATE BASE COURSE, TYPE B	TON	2,034
40200800	AGGREGATE SURFACE COURSE, TYPE B	TON	2,256
40500300	BITUMINOUS MIXTURE COMPLETE	TON	336
40600200	BITUMINOUS MATERIALS (PRIME COAT)	TON	48.2
40600300	AGGREGATE (PRIME COAT)	TON	80.8
40600895	CONSTRUCTING TEST STRIP	EACH	2
40600980	BITUMINOUS SURFACE REMOVAL - BUTT JOINT	SQ YD	269
40600990	TEMPORARY RAMP	SQ YD	536
40800040	INCIDENTAL BITUMINOUS SURFACING	TON	1,041
42300300	PORTLAND CEMENT CONCRETE DRIVEWAY PAVEMENT, 7 INCH	SQ YD	4,491
42400200	PORTLAND CEMENT CONCRETE SIDEWALK 5 INCH	SQ FT	40,784
42400430	PORTLAND CEMENT CONCRETE SIDEWALK 5 INCH, SPECIAL	SQ FT	4,691
42400800	DETECTABLE WARNINGS	SQ FT	610

△ NON-PARTICIPATING

○ REVISED  
10-31-05

SUMMARY OF QUANTITIES

F.A.P. RTE.	SECTION	COUNTY	TOTAL SHEETS	SHEET NO.
513	1168-4	DEKALB	416	4
STA.	TO STA.			
FED. ROAD DIST. NO.	ILLINOIS	FED. AID PROJECT		

CODE NUMBER	PAY ITEMS	UNIT	80% FED / 20% STATE TOTAL QUANTITY I 000-2A
4400007	BITUMINOUS SURFACE REMOVAL 2"	SQ YD	5,245
4400030	BITUMINOUS SURFACE REMOVAL (VARIABLE DEPTH)	SQ YD	6,540
44000100	PAVEMENT REMOVAL	SQ YD	23,242
44000200	DRIVEWAY PAVEMENT REMOVAL	SQ YD	610
44000300	CURB REMOVAL	FOOT	2,786
44000500	COMBINATION CURB AND GUTTER REMOVAL	FOOT	3,391
44000600	SIDEWALK REMOVAL	SQ FT	44,315
44002020	CONCRETE MEDIAN SURFACE REMOVAL	SQ FT	182
44004300	PAVEMENT BREAKING	SQ YD	389
44200998	CLASS B PATCHES, TYPE III, 12 INCH	SQ YD	43
44213200	SAW CUTS	FOOT	137
44300200	STRIP REFLECTIVE CRACK CONTROL TREATMENT	FOOT	14,207
48100100	AGGREGATE SHOULDERS, TYPE A	TON	748
48202400	BITUMINOUS SHOULDERS SUPERPAVE 6"	SQ YD	2,749
50100200	REMOVAL OF EXISTING STRUCTURES	L SUM	1
50104400	CONCRETE HEADWALL REMOVAL	EACH	2
50105210	REMOVE EXISTING CULVERTS	FOOT	110
50300225	CONCRETE STRUCTURES	CU YD	6
50800105	REINFORCEMENT BARS	POUND	485
50800205	REINFORCEMENT BARS, EPOXY COATED	POUND	70
51000105	PIPE HANDRAIL	FOOT	62
54213657	PRECAST REINFORCED CONCRETE FLARED END SECTIONS 12"	EACH	1
54213675	PRECAST REINFORCED CONCRETE FLARED END SECTION 30"	EACH	1
54213681	PRECAST REINFORCED CONCRETE FLARED END SECTION 36"	EACH	2
54213687	PRECAST REINFORCED CONCRETE FLARED END SECTION 42"	EACH	1
54215550	METAL END SECTIONS 15"	EACH	6
54215565	METAL END SECTIONS 30"	EACH	1
54244405	FLUSH INLET BOX FOR MEDIAN, STANDARD 542546	EACH	3
542D0220	PIPE CULVERTS, CLASS D, TYPE 1 15"	FOOT	382
542D0235	PIPE CULVERTS, CLASS D, TYPE 1 30"	FOOT	20
550A0050	STORM SEWERS, CLASS A, TYPE 1 12"	FOOT	96
550A0120	STORM SEWERS, CLASS A, TYPE 1 24"	FOOT	348
550A0160	STORM SEWERS, CLASS A, TYPE 1 36"	FOOT	70
550A0340	STORM SEWERS, CLASS A, TYPE 2 12"	FOOT	1,148
550A0410	STORM SEWERS, CLASS A, TYPE 2 24"	FOOT	1,002
550A0430	STORM SEWERS, CLASS A, TYPE 2 30"	FOOT	733

PLOT DATE = Wed Sep 14 13:05:52 2005  
 FILE NAME = C:\projects\62507780\62507780-rr.dgn  
 PLOT SCALE = 1/8" = 1'-0"  
 USER NAME = jordanhd

REVISION  
 10-31-05

F.A.P. RITE	SECTION	COUNTY	TOTAL SHEETS	SHEET NO.
573	J168-4	DEKALB	416	5
STA.		TO STA.		
FED. ROAD DIST. NO.		ILLINOIS FED. AID PROJECT		

CODE NUMBER	PAY ITEMS	UNIT	80% FED / 20% STATE TOTAL QUANTITY 1 000-2A
550A2320	STORM SEWERS, RUBBER GASKET, CLASS A, TYPE 1 12"	FOOT	77
550A2520	STORM SEWERS, RUBBER GASKET, CLASS A, TYPE 2 12"	FOOT	833
550A2560	STORM SEWERS, RUBBER GASKET, CLASS A, TYPE 2 24"	FOOT	896
550A2580	STORM SEWERS, RUBBER GASKET, CLASS A, TYPE 2 30"	FOOT	203
56300100	ADJUSTING SANITARY SEWERS, 8-INCH DIAMETER OR LESS	FOOT	600
59100100	GEOCOMPOSITE WALL DRAIN	SQ YD	15
60107600	PIPE UNDERDRAINS 4"	FOOT	1,194
60218400	MANHOLES, TYPE A, 4'-DIAMETER, TYPE 1 FRAME, CLOSED LID	EACH	8
60221100	MANHOLES, TYPE A, 5'-DIAMETER, TYPE 1 FRAME, CLOSED LID	EACH	19
60222930	MANHOLES, TYPE A, 5'-DIAMETER, WITH SPECIAL FRAME AND GRATE	EACH	2
60228110	MANHOLES, SANITARY, 4'-DIAMETER, TYPE 1 FRAME, CLOSED LID	EACH	3
60228400	MANHOLES, SPECIAL	EACH	1
60240385	INLETS, TYPE B, WITH SPECIAL FRAME AND GRATE	EACH	15
60242400	INLETS, SPECIAL	EACH	27
60242700	INLETS, SPECIAL, NO. 3	EACH	20
60242800	INLETS, SPECIAL, NO. 4	EACH	1
60242801	INLETS, SPECIAL, NO. 5	EACH	59
60255500	MANHOLES TO BE ADJUSTED	EACH	16
60257900	MANHOLES TO BE RECONSTRUCTED	EACH	23
60406100	FRAMES AND LIDS, TYPE 1, CLOSED LID	EACH	15
60500040	REMOVING MANHOLES	EACH	34
60500050	REMOVING CATCH BASINS	EACH	5
60500060	REMOVING INLETS	EACH	27
60600095	CLASS SI CONCRETE (OUTLET)	CU YD	8.3
60600605	CONCRETE CURB, TYPE B	FOOT	2,605
60600705	CONCRETE CURB, TYPE B (ABUTTING EXISTING PAVEMENT)	FOOT	60
60603800	COMBINATION CONCRETE CURB AND GUTTER, TYPE B-6.12	FOOT	410
60605000	COMBINATION CONCRETE CURB AND GUTTER, TYPE B-6.24	FOOT	20,301
60608600	COMBINATION CONCRETE CURB AND GUTTER, TYPE M-6.06	FOOT	85
60610400	COMBINATION CONCRETE CURB AND GUTTER, TYPE M-6.24	FOOT	16
60618300	CONCRETE MEDIAN SURFACE, 4 INCH	SQ FT	176
61133100	FIELD TILE JUNCTION VAULTS, 2' DIA.	EACH	2
61140000	STORM SEWERS, SPECIAL 8"	FOOT	100
61140100	STORM SEWERS, SPECIAL 10"	FOOT	100
61140200	STORM SEWERS, SPECIAL 12"	FOOT	100
* 61141100	<del>STORM SEWERS, SPECIAL 30"</del>	<del>FOOT</del>	<del>20</del>
* 63000000	STEEL PLATE BEAM GUARDRAIL TYPE A	FOOT	188
* 63100085	TRAFFIC BARRIER TERMINAL, TYPE 6	EACH	2

REVISI  
10-31-05

F.A.R. RTE.	SECTION	COUNTY	TOTAL SHEETS	SHEET NO.
573	116R-4	DEKALB	416	6
STA. _____		TO STA. _____		
FED. ROAD DIST. NO. _____		ILLINOIS FED. AID PROJECT		

CODE NUMBER	PAY ITEMS	UNIT	80% FED / 20% STATE TOTAL QUANTITY 1 000-2A
63200310	GUARDRAIL REMOVAL	FOOT	104
63301210	REMOVE AND RE-ERECT STEEL PLATE BEAM GUARD RAIL, TYPE A	FOOT	75
63500105	DELINEATORS	EACH	2
66410400	CHAIN LINK FENCE TO BE REMOVED AND RE-ERECTED	FOOT	166
66600105	FURNISHING AND ERECTING RIGHT-OF-WAY MARKERS	EACH	8
66700305	PERMANENT SURVEY MARKERS, TYPE II	EACH	7
66900105	UNDERGROUND STORAGE TANK REMOVAL	EACH	6
66900200	NON-SPECIAL WASTE DISPOSAL	CU YD	895
* 66900450	SPECIAL WASTE PLANS AND REPORT	L SUM	1
66900530	SOIL DISPOSAL ANALYSIS	EACH	2
66901000	BACKFILL PLUGS	CU.YD.	27
67000400	ENGINEER'S FIELD OFFICE, TYPE A	CAL MO	24
67100100	MOBILIZATION	L SUM	1
70100200	TRAFFIC CONTROL AND PROTECTION, STANDARD 701331	EACH	4
70100500	TRAFFIC CONTROL AND PROTECTION, STANDARD 701326	L SUM	1
70102620	TRAFFIC CONTROL AND PROTECTION, STANDARD 701501	L SUM	1
70102622	TRAFFIC CONTROL AND PROTECTION, STANDARD 701502	L SUM	1
70102640	TRAFFIC CONTROL AND PROTECTION, STANDARD 701801	L SUM	1
70103815	TRAFFIC CONTROL SURVEILLANCE	CAL DAY	300
70300520	PAVEMENT MARKING TAPE, TYPE III, 4"	FOOT	16,178
70300610	TEMPORARY PAINT PAVEMENT MARKING, LETTERS AND SYMBOLS	SQ FT	1,248
70300625	TEMPORARY PAINT PAVEMENT MARKING LINE 4"	FOOT	16,564
70300635	TEMPORARY PAINT PAVEMENT MARKING LINE 6"	FOOT	824
70300640	TEMPORARY PAINT PAVEMENT MARKING LINE 8"	FOOT	2,086
70300645	TEMPORARY PAINT PAVEMENT MARKING LINE 12"	FOOT	877
70300660	TEMPORARY PAINT PAVEMENT MARKING LINE 24"	FOOT	298
70301000	WORK ZONE PAVEMENT MARKING REMOVAL	SQ FT	8,988
* 78000100	THERMOPLASTIC PAVEMENT MARKING - LETTERS AND SYMBOLS	SQ FT	1,966
* 78000200	THERMOPLASTIC PAVEMENT MARKING - LINE 4"	FOOT	24,723
* 78000400	THERMOPLASTIC PAVEMENT MARKING - LINE 6"	FOOT	1,305
* 78000500	THERMOPLASTIC PAVEMENT MARKING - LINE 8"	FOOT	2,988
* 78000600	THERMOPLASTIC PAVEMENT MARKING - LINE 12"	FOOT	1,180
* 78000650	THERMOPLASTIC PAVEMENT MARKING - LINE 24"	FOOT	419
* 78100100	RAISED REFLECTIVE PAVEMENT MARKER	EACH	205
78200410	GUARDRAIL MARKERS, TYPE A	EACH	6
78201000	TERMINAL MARKER - DIRECT APPLIED	EACH	2
78300100	PAVEMENT MARKING REMOVAL	SQ FT	2,243

PLOT DATE = Fri Sep 02 09:26:37 2005  
 FILE NAME = C:\projects\201709\17091709.dgn  
 USER NAME = jordanhd

REVISED  
10-31-05

SUMMARY OF QUANTITIES

F.A.R. SECTION	COUNTY	TOTAL SHEETS	SHEET NO.
573 J16R-4	DEKALB	416	61
STA. _____ TO STA. _____			
FED. ROAD DIST. NO. ILLINOIS FED. AID PROJECT			

DECRISPTION	STATION		DIA. PIPE INCHES	STORM SEWER TYPE	LENGTH FEET	PIPE INVERT ELEVATION		SLOPE OF SECTION FT/FT	WEIR, LID, or GRATE ELEVATION		60240385	60242400	60242700	60242801	60218400	60221100	60222930	60228400	54213657	54213687
	FROM	TO				UPSTREAM	DOWNSTREAM		UPSTREAM	DOWNSTREAM	INLETS TYPE B WITH SPECIAL FRAME & GRATE EACH	INLETS SPECIAL EACH	INLETS SPECIAL # 3 EACH	INLETS SPECIAL # 5 EACH	4'-DIA, TIF CL EACH	5'-DIA, TIF CL EACH	5'-DIA, W/SPECIAL FRAME & GRATE EACH	MANHOLES, SPECIAL EACH	CONC. FLARED END SECTION 12" EACH	CONC. FLARED END SECTION 42" EACH
	MANHOLES TYPE A																			
I 1 to MH 1	798+98	798+91	12	2	42	738.50	738.45	0.12%	741.98	744.65										
I 15 MH 1	799+50	799+36	12	2	64	737.00	736.60	0.62%	743.98	744.65										
MH 1 to MH 2	799+36	802+38	24	2	298	736.50	735.50	0.34%	744.65	745.83										
MH 2 to I 2	802+38	803+85	24	2	143	735.40	735.00	0.28%	745.83	743.85										
I 2 to I 3	803+85	805+77	30	2	187	734.90	734.60	0.16%	743.85	741.50										
Flared end to I 2	803+75	803+84	12	2	15	738.00	737.55	3.00%	738.00	743.85										
I 3 to I 4	805+77	806+95	30	2	114	734.50	734.30	0.18%	741.50	740.53										
I 4 to I 5	806+95	807+40	30	2	39	734.20	734.10	0.26%	740.53	740.02										
EXISTING MH to I 5	807+32	807+40	12	2	8	737.00	734.75	28.13%	739.90	740.02										
I 5 to I 6	807+40	808+55	30	2	111	734.00	733.80	0.18%	740.02	738.99										
I 6 to I 7	808+55	809+70	30	2	110	733.70	733.50	0.18%	738.99	738.48										
I 7 to I 8	809+70	810+32	30	2	59	733.40	733.30	0.17%	738.48	737.47										
I 8 to I 9	810+32	811+25	30	2	91	733.20	733.00	0.22%	737.47	738.76										
I 9 to MH 3	811+25	812+25	30	2	97	732.90	732.70	0.21%	738.76	739.54										
MH 3 to I 10	812+25	814+30	30	2	202	732.60	732.30	0.15%	739.54	738.25										
I 10 to MH 5	814+30	814+37	30	2	53	732.20	732.10	0.19%	738.25	739.02										
I 16 to I 17	805+53	807+36	12	2	177	738.50	736.50	1.13%	742.07	740.00										
I 17 to I 18	807+36	808+50	12	2	108	736.40	735.25	1.06%	740.00	738.75										
I 18 to I 19	808+50	809+50	24	1	95	735.15	734.70	0.47%	738.75	738.26										
I 19 to I 20	809+50	810+51	24	2	98	733.60	733.35	0.26%	738.26	738.38										
I 20 to I 21	810+51	810+95	24	2	42	733.25	733.15	0.24%	738.38	738.17										
I 21 to I 22	810+95	813+00	24	2	203	733.05	732.65	0.20%	738.17	739.00										
I 22 to MH 4	813+03	813+27	24	2	19	732.55	732.45	0.53%	739.00	740.01										
MH 4 to MH 5	813+27	814+37	24	2	98	732.35	732.10	0.26%	740.01	739.02										
MH 5 to I 23	814+29	814+53	30	2	23	732.00	731.90	0.43%	739.02	737.15										
I 23 to MH 6	814+53	814+75	30	2	19	731.80	731.75	0.26%	737.15	738.00										
I 25 to I 24	816+00	814+95	12	2	102	733.60	733.10	0.49%	738.00	738.00										
I 24 to MH 6	814+95	814+75	12	2	19	733.00	732.00	5.26%	738.00	738.00										
I 27 to I 28	818+80	819+20	12	2	38	741.00	740.60	1.05%	744.50	744.50										
I 28 to MH 7	819+19	819+40	24	2	65	740.00	739.80	0.31%	744.50	747.57										
I 14 to I 13	820+05	819+67	12	2	37	743.85	743.65	0.54%	747.35	747.40										
I 13 to MH 7	819+67	819+40	12	2	29	743.55	743.40	0.52%	747.40	747.57										
MH 7 to I 12	819+39	817+50	24	3	181	736.00	735.00	0.55%	747.57	740.18										
I 26 to I 12	817+75	817+50	12	2	51	736.00	735.50	0.98%	740.49	740.18										
I 12 to MH 8	817+53	815+90	24	2	159	734.80	734.40	0.25%	740.18	739.32										
MH 8 to I 11	815+90	815+00	36	2	85	733.00	732.20	0.94%	739.32	737.78										
I 11 to MH 6	815+00	814+75	36	2	64	732.10	731.50	0.94%	737.78	738.00										
MH 6 to MH 9	814+75	66+12	42	2	346	731.00	729.50	0.43%	738.00	736.32										
I 23A to MH 9	66+12	66+12	12	2	14	729.70	729.50	1.43%	736.20	736.32										
I 24A to MH 9	66+12	66+12	12	2	10	729.65	729.50	1.50%	736.20	736.32										
MH 9 to MH 9A	66+12	65+03	42	2	120	729.40	728.90	0.42%	736.32	736.72										
MH 9A to QUILLET (DELETED MH 9B)	65+03	63+52	42	2	112	728.80	728.08	0.64%	736.72	728.08										
MH 8 to MH 8A	815+89	815+89	24	2	55	MATCH EXISTING 20" TILE (BOTTOM PIPE)			739.32	739.13										

PLOT DATE = Fri, Oct 21, 19:29:45, 2005  
 FILE NAME = c:\projects\11201700\11201700.dgn  
 PLOT SCALE = 50.0000' / IN.  
 USER NAME = polina.j

**REVISED**  
10-31-05

TOTALS	1.0	3.0	9.0	15.0	3.0	6.0	2.0	1.0	1.0	1.0
--------	-----	-----	-----	------	-----	-----	-----	-----	-----	-----

F.A.R. SECTION	COUNTY	TOTAL SHEETS	SHEET NO.
511 J16R-4	DEKALB	46	66
STA.	TO STA.		
FED. ROAD DIST. NO.	ILLINOIS	FED. AID PROJECT	

DESCRIPTION	STATION		60218400	60221100	550A0050	550A0340	X0322033	550A2320	550A2520	550A0120	550A0410	X0322125	550A2560	*2001337	61141100	54215565	20800150
			MANHOLES TYPE A		12" CLASS A					24" CLASS A				30" JACKED IN PLACE	STORM SEWERS, SPECIAL 30"	END SECTIONS 30"	TRENCH BACKFILL
	4'-DIA, TIF CL	5'-DIA, TIF CL	TYPE 1		WATERMAIN QUALITY		GASKET		TYPE 1		WATERMAIN QUALITY		GASKET	(feet)	(feet)	(each)	(cu yd)
	EACH	EACH	(feet)	(feet)	(feet)	(feet)	(feet)	(feet)	(feet)	(feet)	(feet)	(feet)	(feet)	(feet)	(feet)	(each)	(cu yd)
I 46 to I 47	832+16	832+50					44.0										9.01
I 47 to I 48	832+62	833+21										55.0					17.00
I 48 to I 49	833+21	833+60											41.0				26.34
I 50 to I 49	833+53	833+60					12.0										2.46
I 49 to I 52	833+58	833+95								32.0							7.05
I 51 to I 52	833+95	833+95			15.0												3.07
EXISTING SS to I 52	833+95					20.0											5.98
I 52 to MH 17	833+98	834+32										39.0					28.23
MH 17 to I 53	834+31	835+50		1								117.0					30.96
I 53 to I 54	835+53	836+92										134.0					9.66
I 58 to I 56	183+10	183+10						32.0									1.19
I 56 to I 57	183+10	182+67			38.0												1.41
I 57 to I 55	182+67	180+45								221.0							65.04
I 60 to I 59	837+85	180+45					26.0										0.96
I 59 to I 55	837+64	182+45							35.0								3.50
I 55 to I 54	837+26	836+92										38.0					4.43
I 54 to I 68	836+92	836+92											46.0				9.45
I 65 to I 66	832+14	833+13					98.0										28.28
I 66 to I 67	833+13	834+66					150.0										106.78
I 67 to I 68	834+66	836+92				220.0											70.41
I 68 to MH 18	836+92	837+12								25.0							19.12
I 63 to I 62	840+20	840+02					14.0										0.67
I 62 to MH 62A	840+02	840+02							20.0								2.84
MH 62A to MH 61A	840+02	838+58	1							140.0							18.38
I 61 to MH 61A	838+59	838+58							22.0								3.81
MH 61A to I 72A	838+58	838+58	1							18.0							3.43
I 72 to I 72A	839+51	838+58				91.0											17.68
I 72A to I 71	838+58	838+25								41.0							9.64
I 71 to I 69	838+15	837+24								92.0							18.90
I 70 to I 69	837+60	837+24			43.0												3.40
I 69 to MH 18	837+24	837+12											11.0				7.51
MH 18 to Outlet	179+58	178+05		1										132.0			0.00
COLLAR to OUTLET	178+25	178+05													20.0	1.0	19.53
REPLACE EXISTING	840+18	840+18											60.0				
			2.0	2.0	96.0	331.0	344.0	32.0	77.0	158.0	411.0	383.0	158.0	132.0	20.0	1.0	556.1

PLOT DATE = Fri Oct 21 10:25:49 2005  
 FILE NAME = c:\p\o\m\sta\p201728\cvt\728ev.dgn  
 PLOT SCALE = 50.0000' / IN.  
 USER NAME = polzmej

REVISED  
 10-31-05

OAK DRAINAGE SCHEDULE

F.A.P. RTE.	SECTION	COUNTY	TOTAL SHEETS	SHEET NO.
573	J168-4	DEKALB	416	128
STA. _____		TO STA. _____		
FED. ROAD DIST. NO. _____		ILLINOIS FED. AID PROJECT		

PLAN	DATE
SURVEYED	
PLOTTED	
CHECKED	
BY	
NO. _____	
DATE FILED	

PROFILE	DATE
SURVEYED	
PLOTTED	
CHECKED	
BY	
NO. _____	
DATE FILED	

PLOT DATE = Fri Oct 21 10:22:00 2005  
 FILE NAME = c:\pwork\msta\320178\0178\0178.dgn  
 PLOT SCALE = 20.0000 / 1 IN.  
 USER NAME = polzmej

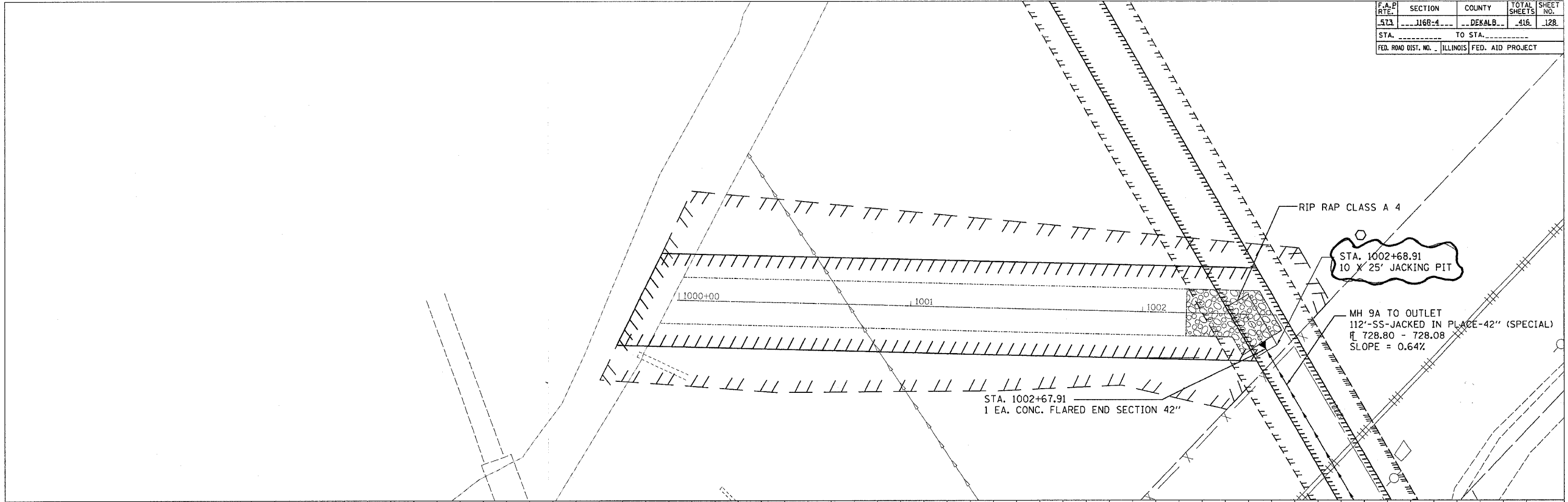

REVISIONS  
 10-31-05



F.A.P. RTE.	SECTION	COUNTY	TOTAL SHEETS	SHEET NO.
573	J168-4	DEKALB	416	129
STA. _____		TO STA. _____		
FED. ROAD DIST. NO. _____ ILLINOIS FED. AID PROJECT				

PLAN	DATE
SURVEYED _____ ALIGNED _____ CHECKED _____ NO. _____ DATE _____ FILE NAME _____ USER NAME _____	

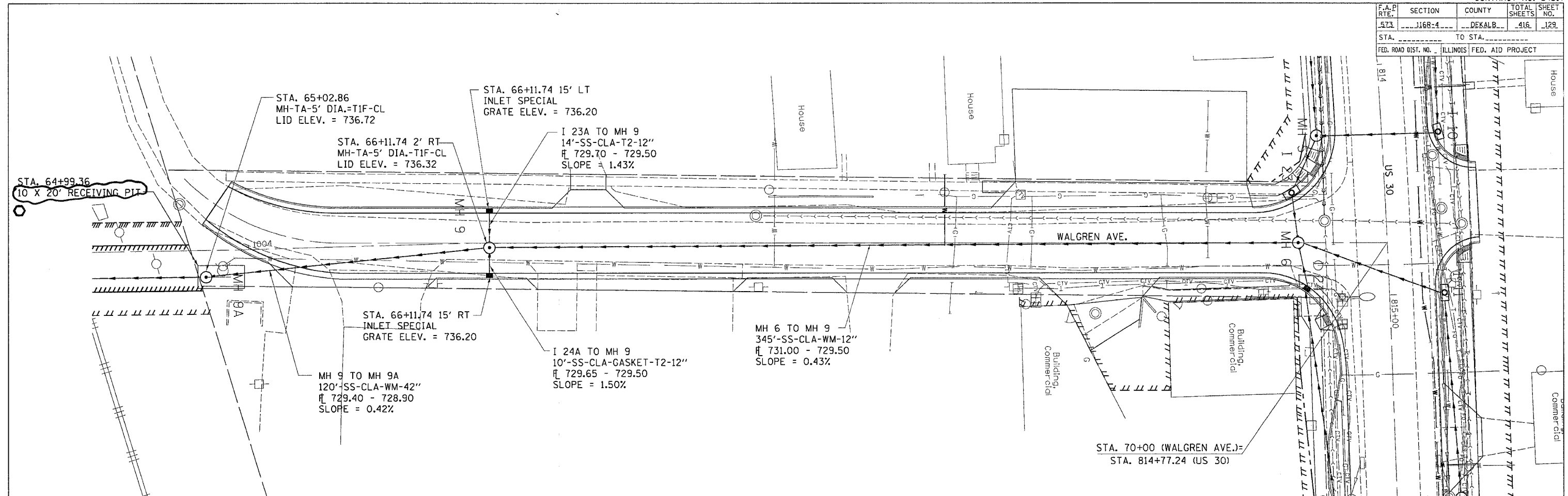

PROFILE	DATE
SURVEYED _____ GRADES CHECKED _____ STRUCTURE NOTATION CHRD _____ NO. _____ DATE _____ FILE NAME _____ USER NAME _____	

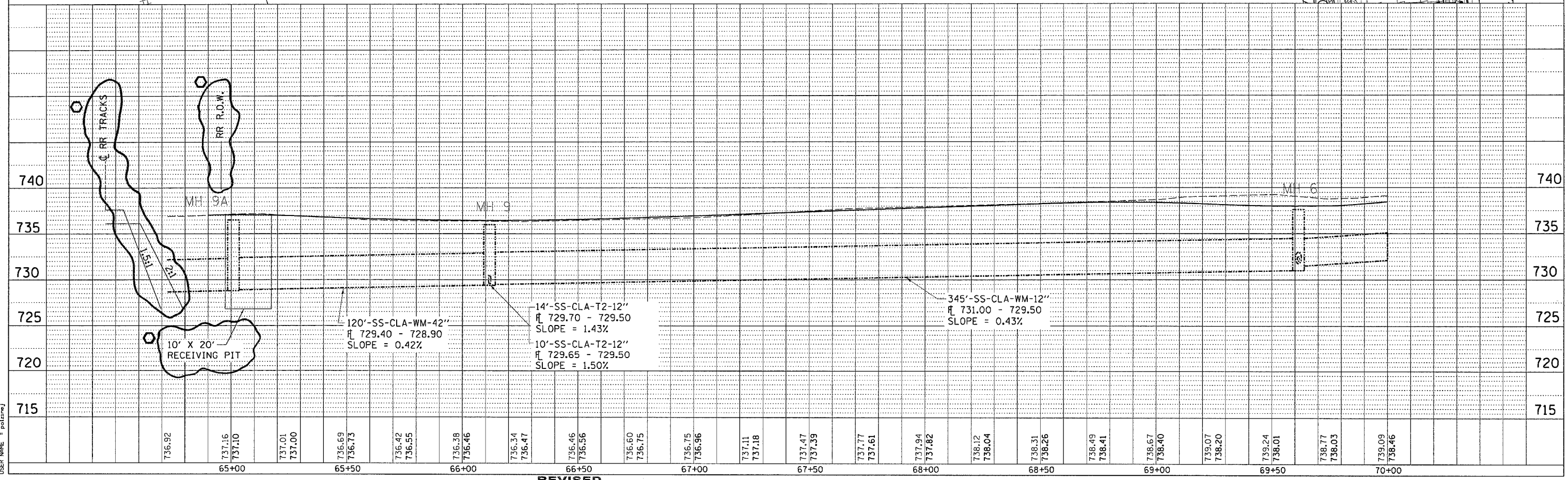

PLOT DATE = Fri Oct 21 16:22:52 2005  
 FILE NAME = c:\p\proj\sta\201700\81700-4.dgn  
 USER NAME = polarsj

REVISION  
 10-31-05

F.A.P. RTE.	SECTION	COUNTY	TOTAL SHEETS	SHEET NO.
573	J168-4	DEKALB	416	131
STA. _____ TO STA. _____		ILLINOIS FED. AID PROJECT		

PLAN	SURVEYED	DATE
	BY	
	NOTED	
	REVISIONS	
	NO. DATE	

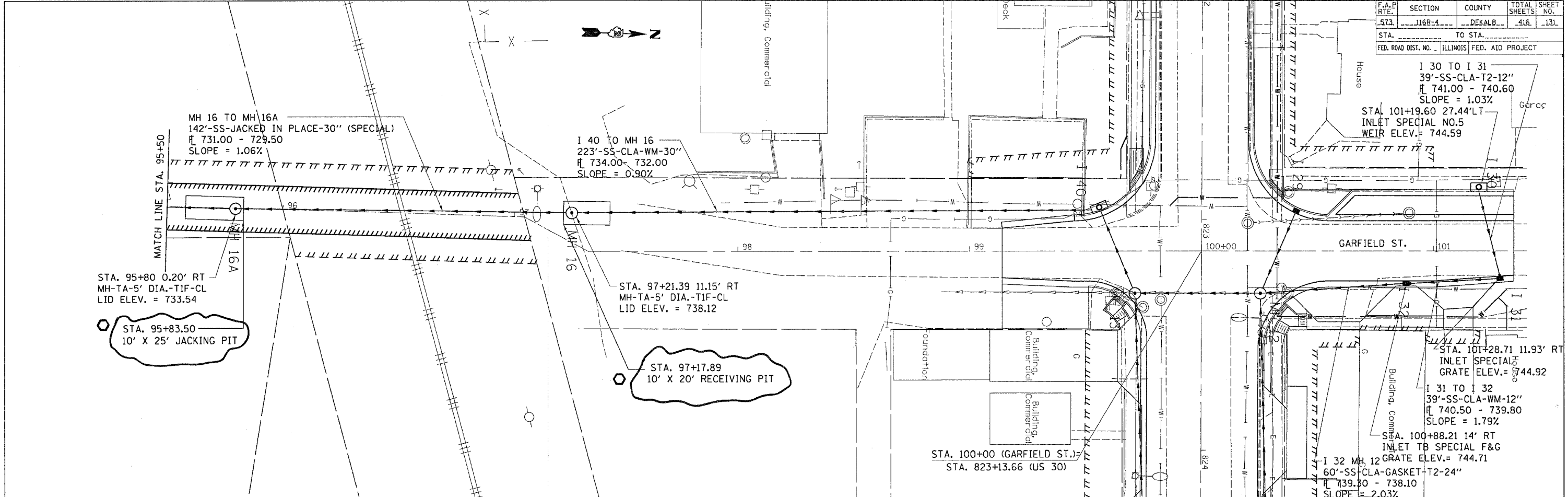

PROFILE	SURVEYED	DATE
	BY	
	NOTED	
	REVISIONS	
	NO. DATE	

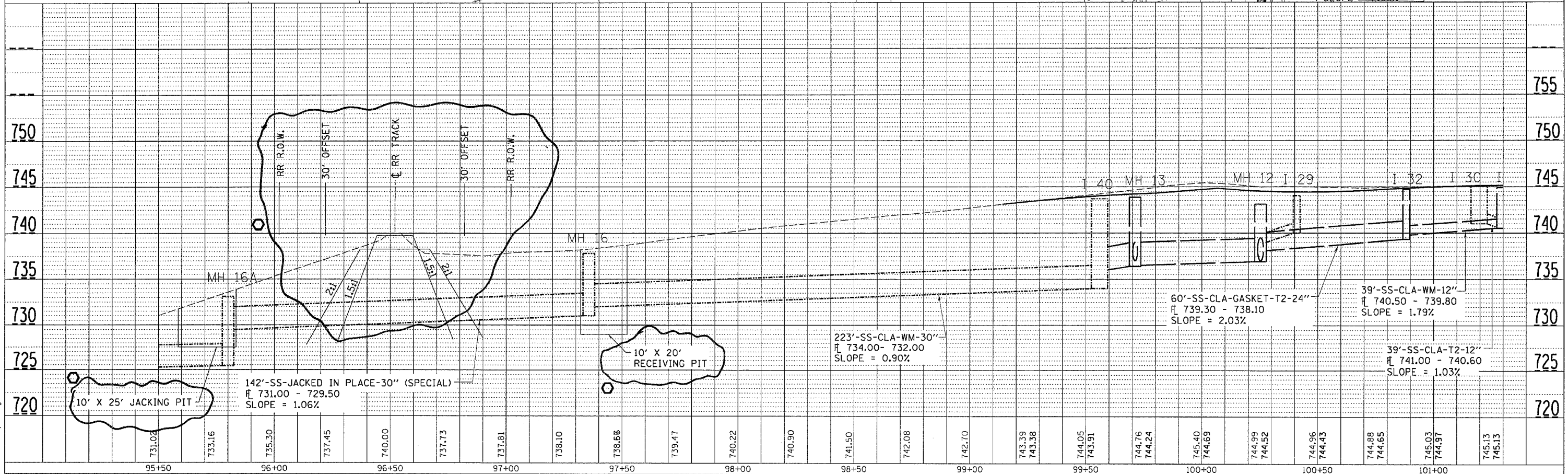

PLOT DATE = Fri Oct 21 10:23:47 2005  
 FILE NAME = c:\pwworkspace\20051021\100717881.dwg  
 PLOT SCALE = 20.00000' / 1" / IN.  
 USER NAME = polstrom

REVISED 10-31-05

F.A.P. RTE.	SECTION	COUNTY	TOTAL SHEETS	SHEET NO.
573	1168-4	DEKALB	416	133
STA. _____ TO STA. _____		FED. ROAD DIST. NO. _____ ILLINOIS FED. AID PROJECT		

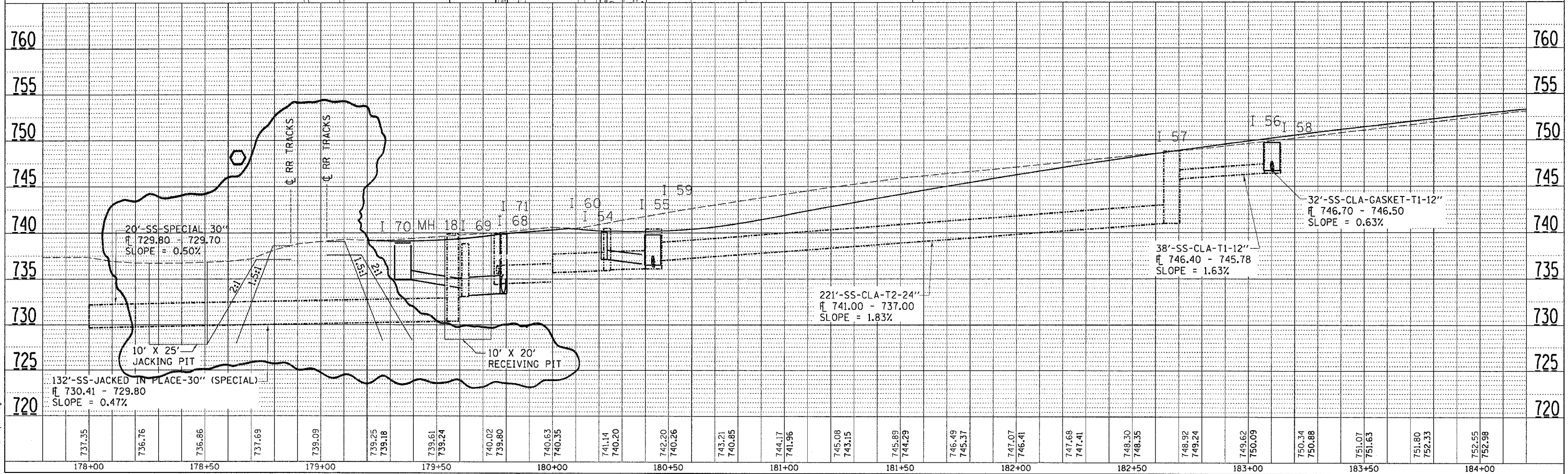
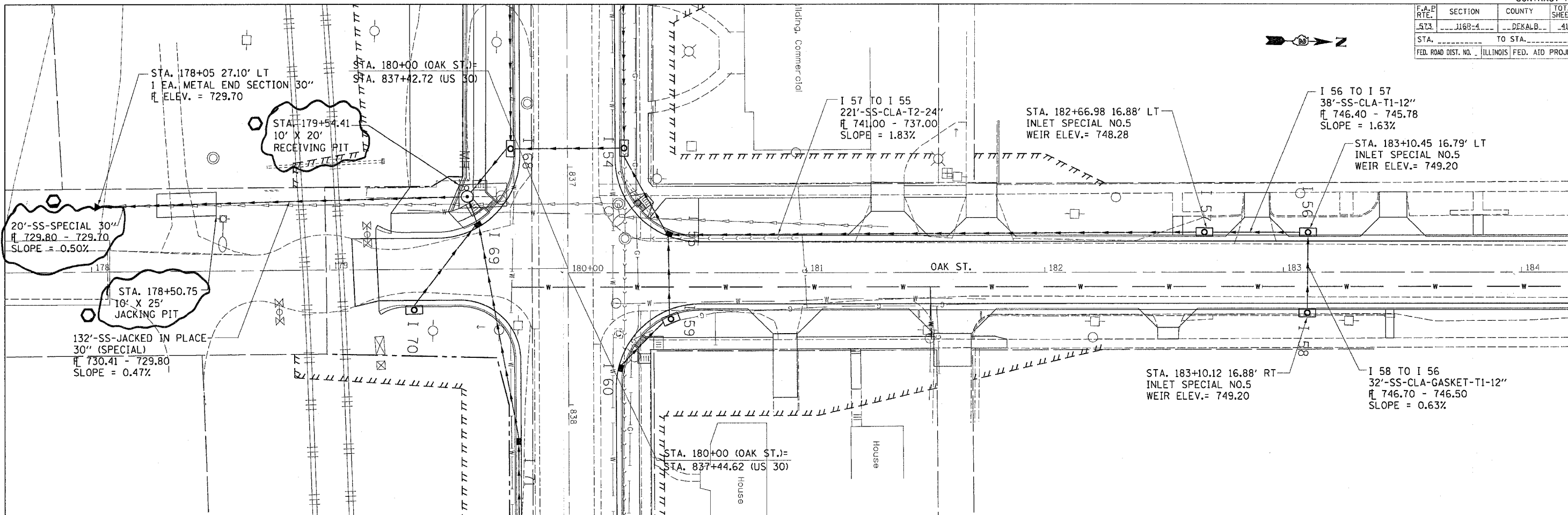

PLAN	DATE	BY
SURVEYED		
PLOTTED		
REVISIONS		
NO. _____		
DATE _____		
BY _____		

PROFILE	DATE	BY
SURVEYED		
PLOTTED		
REVISIONS		
NO. _____		
DATE _____		
BY _____		

PLOT DATE = Fri, Oct 21, 10:24:24, 2005  
 FILE NAME = c:\pwworkspace\p20170807\108070807.dwg  
 PLOT SCALE = 1/8" = 1'-0"  
 USER NAME = polznowj

REVISED 10-25-05

F.A.P. RTE.	SECTION	COUNTY	TOTAL SHEETS	SHEET NO.
523	J168-A	DEKALB	416	137
STA. 6+00		TO STA. 11+00		
FED. ROAD DIST. NO.		ILLINOIS FED. AID PROJECT		

PLAN	REVIEWED	DATE
NO.	BY	
	CHECKED	
	DATE	
	FILE NAME	
	ADD FILE NAME	

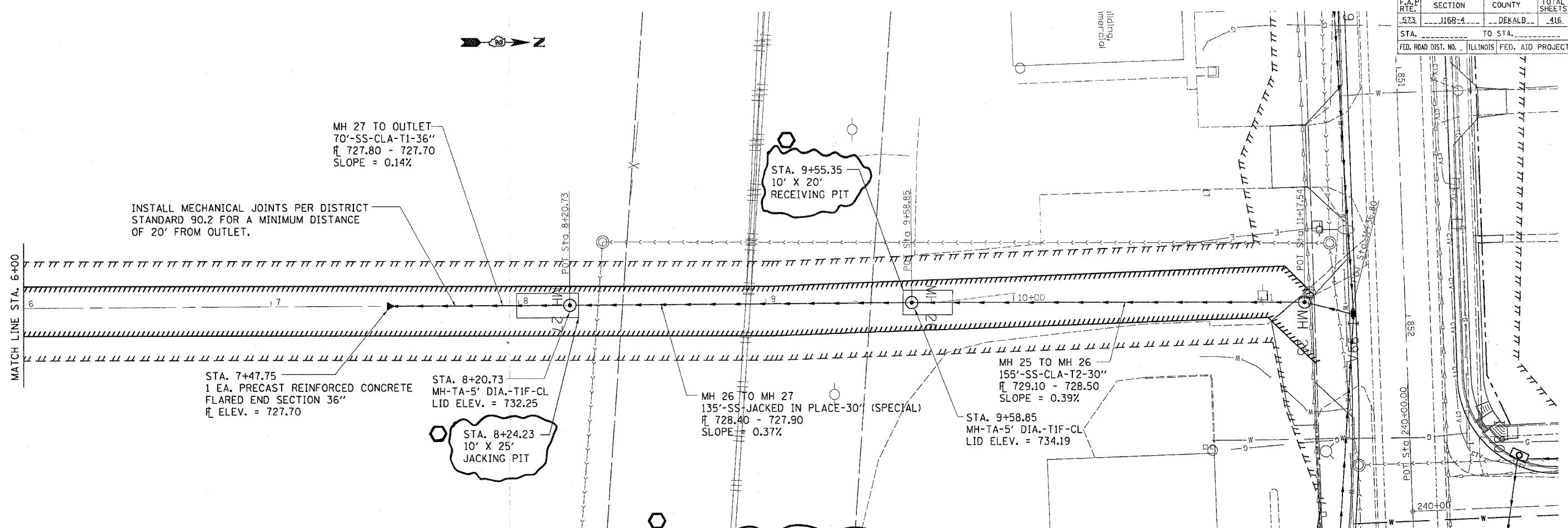

PROFILE	REVIEWED	DATE
NO.	BY	
	CHECKED	
	DATE	
	FILE NAME	
	ADD FILE NAME	

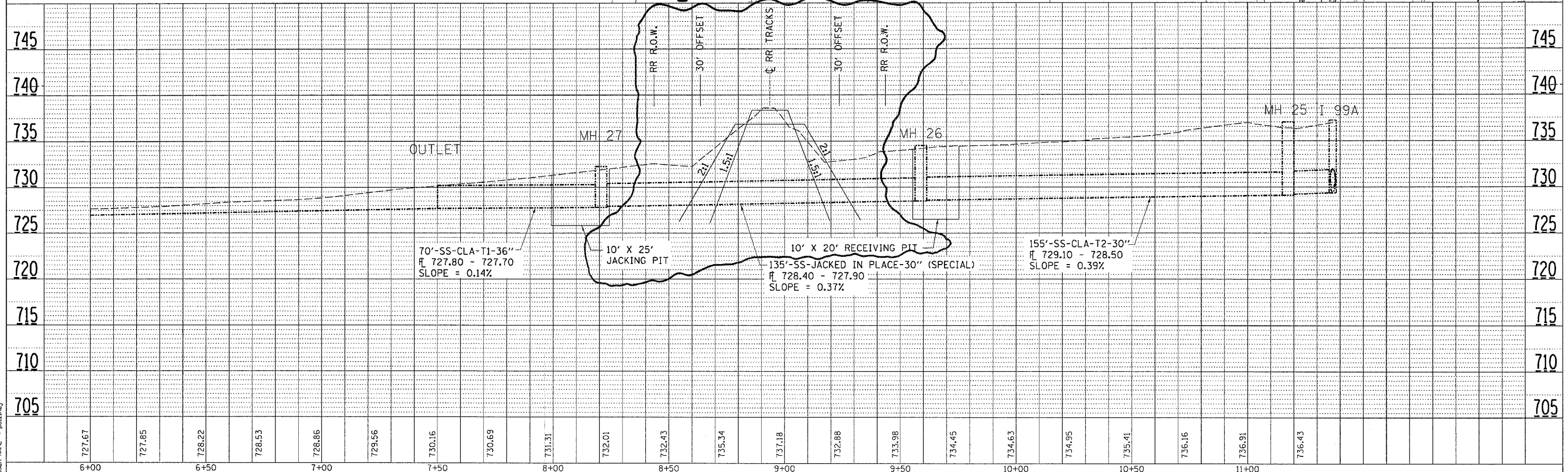

PLT DATE = Fri, Oct 21 11:53:55 2005  
 FILE NAME = 2824008.dwg  
 PLOT SCALE = 28.24008" / IN.  
 USER NAME = polsanej

REVISED 10-31-05

DONALD DRAINAGE DETAILS OUTLET

F.A.P. RY.	SECTION	COUNTY	TOTAL SHEETS	SHEET NO.
573	J16R-4	DEKALB	416	139
STA. _____ TO STA. _____				
FED. ROAD DIST. NO. ILLINOIS FED. AID PROJECT				

PLAN	DATE	BY
SURVEYED		
PLOTTED		
NOTED		
NOTE BOOK NO.		
DATE FILED		

PROFILE	DATE	BY
SURVEYED		
PLOTTED		
NOTED		
NOTE BOOK NO.		
DATE FILED		

PLOT DATE = Fri, Oct 21 10:25:14 2005  
 FILE NAME = c:\prowork\10201700\10201700.dgn  
 PLOT SCALE = 26.00000 / IN.  
 USER NAME = polzimmj

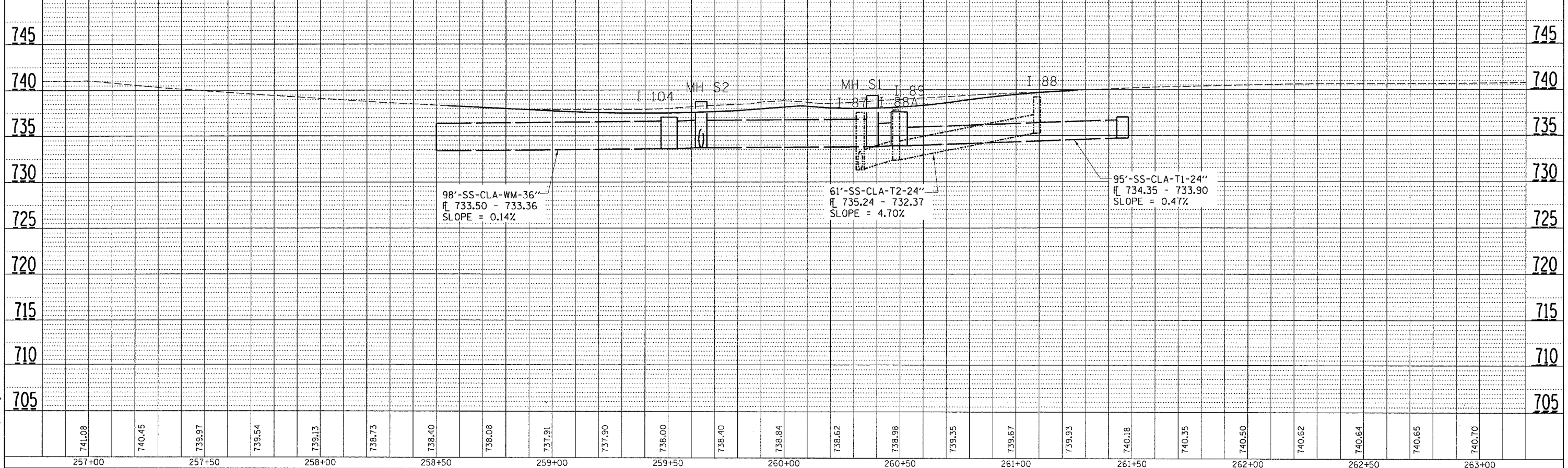
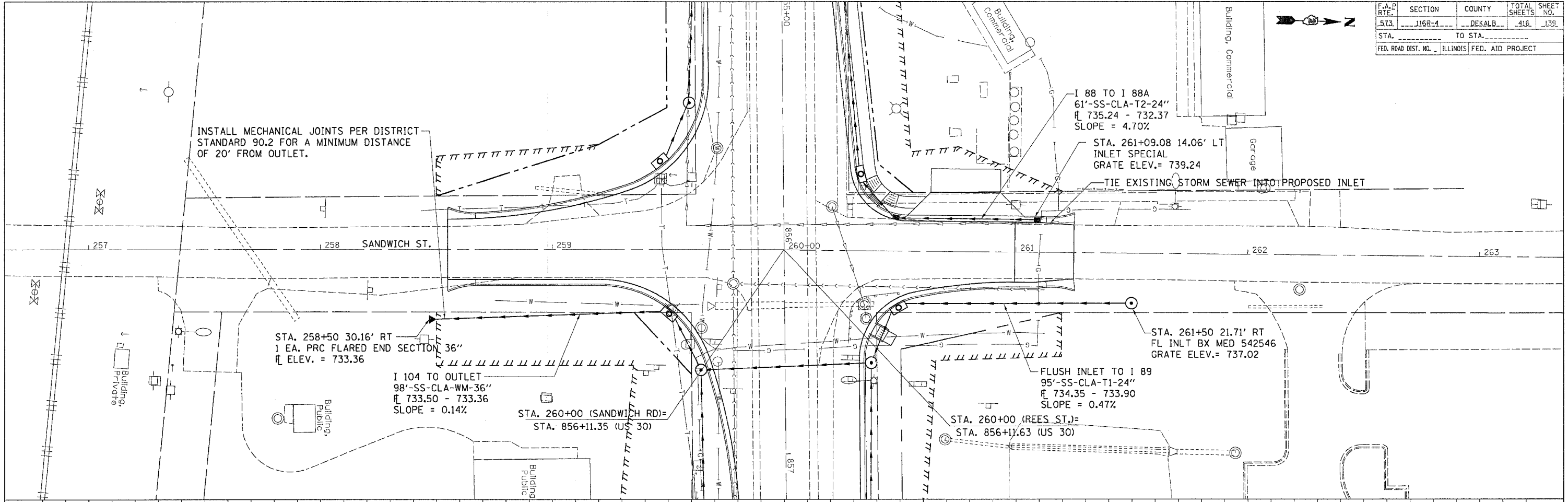

REVISED 10-31-05 NEW SHEET

DRAINAGE DETAILS SANDWICH ST. & REES ST.

F.A. RTE.	SECTION	COUNTY	TOTAL SHEETS	SHEET NO.
573	116R-4	DEKALB	416	139A
STA.		TO STA.		
FED. ROAD DIST. NO.		ILLINOIS FED. AID PROJECT		

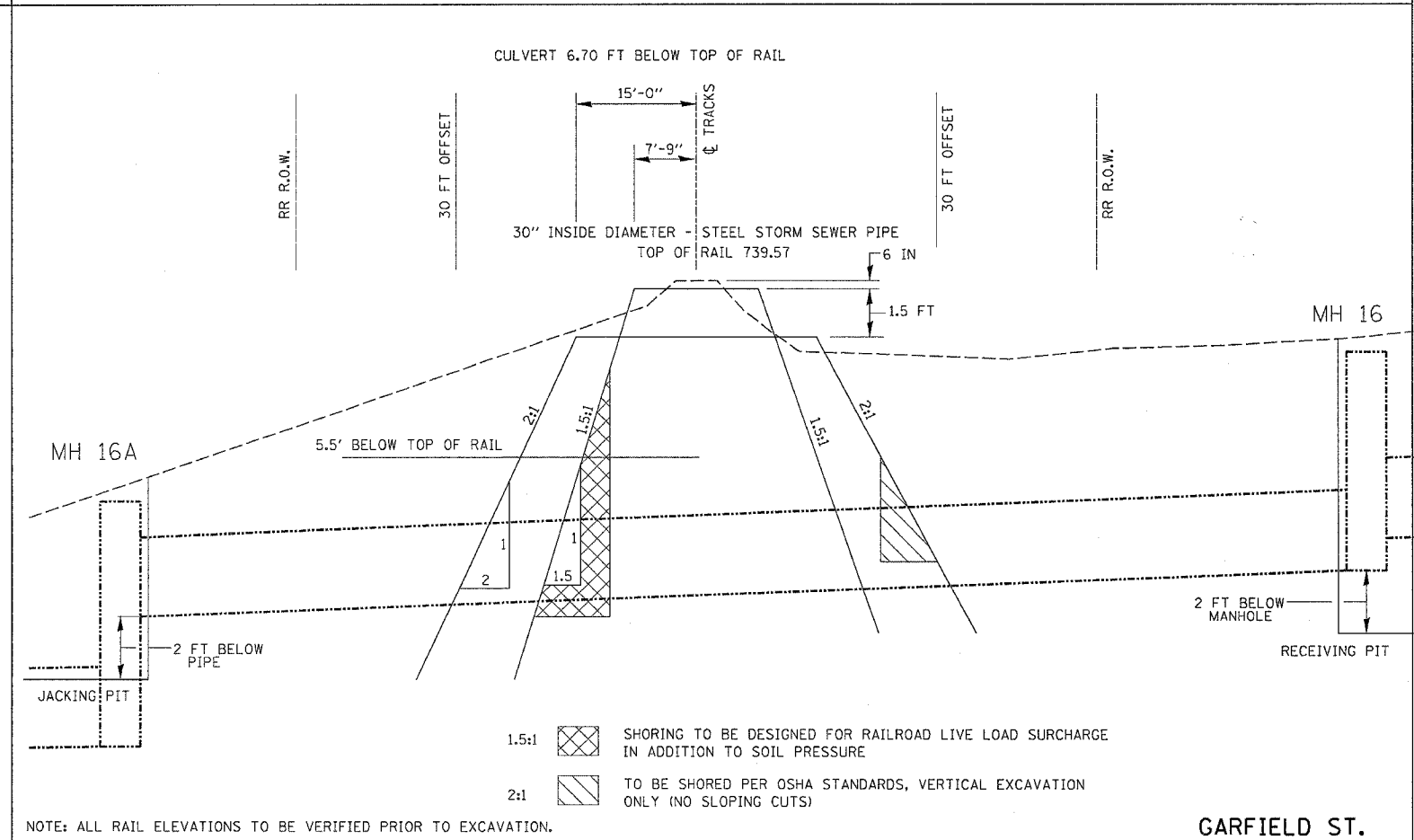
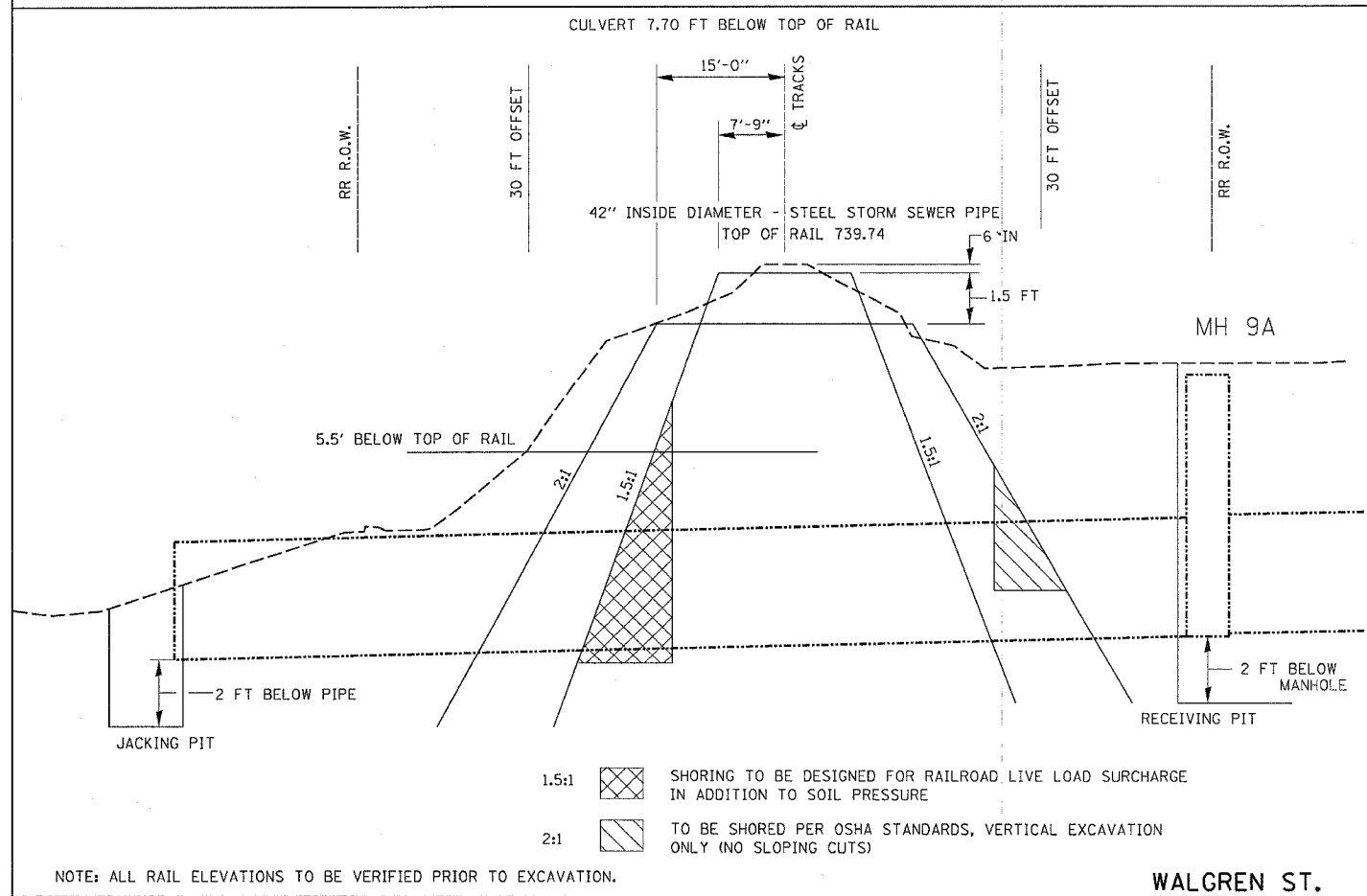
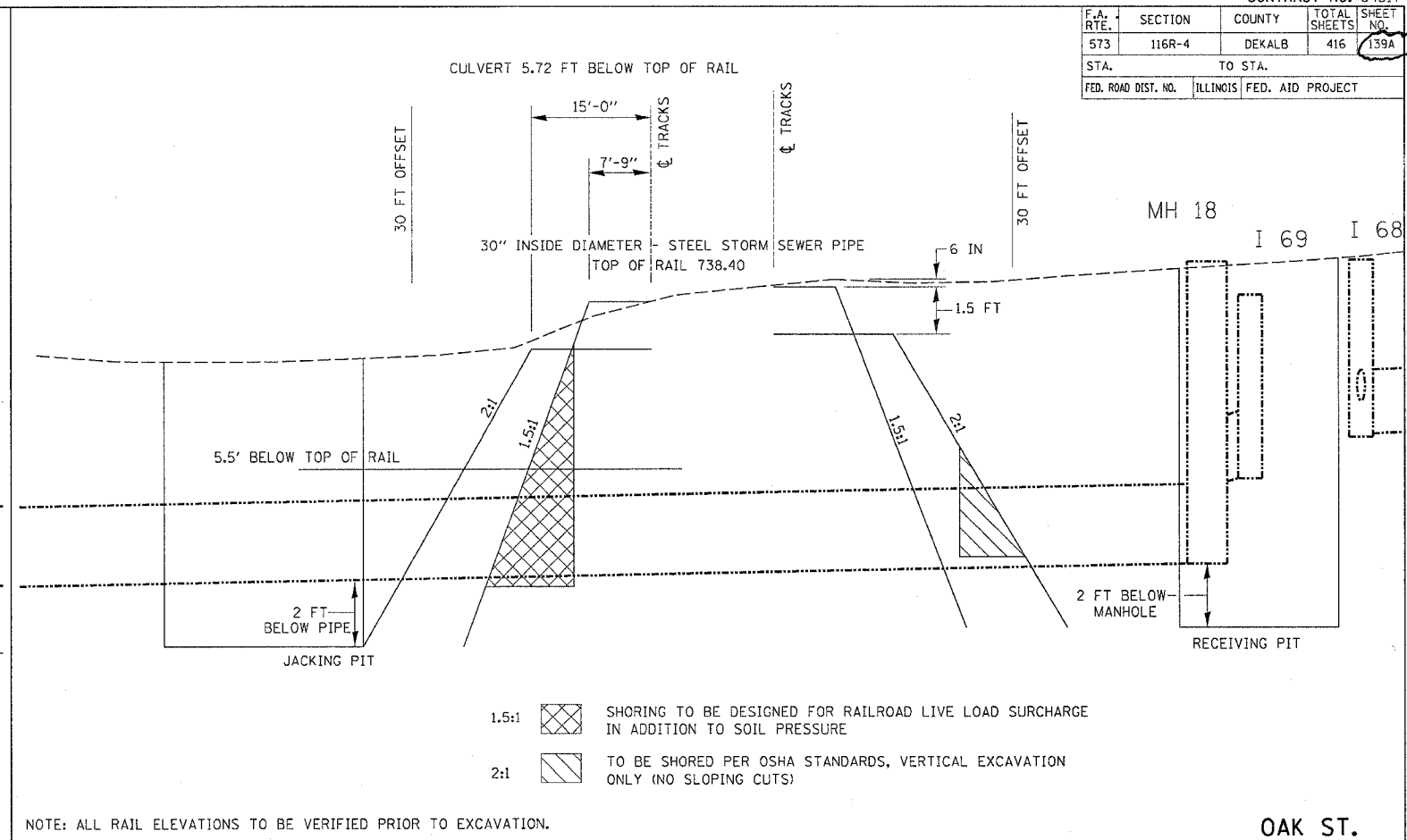
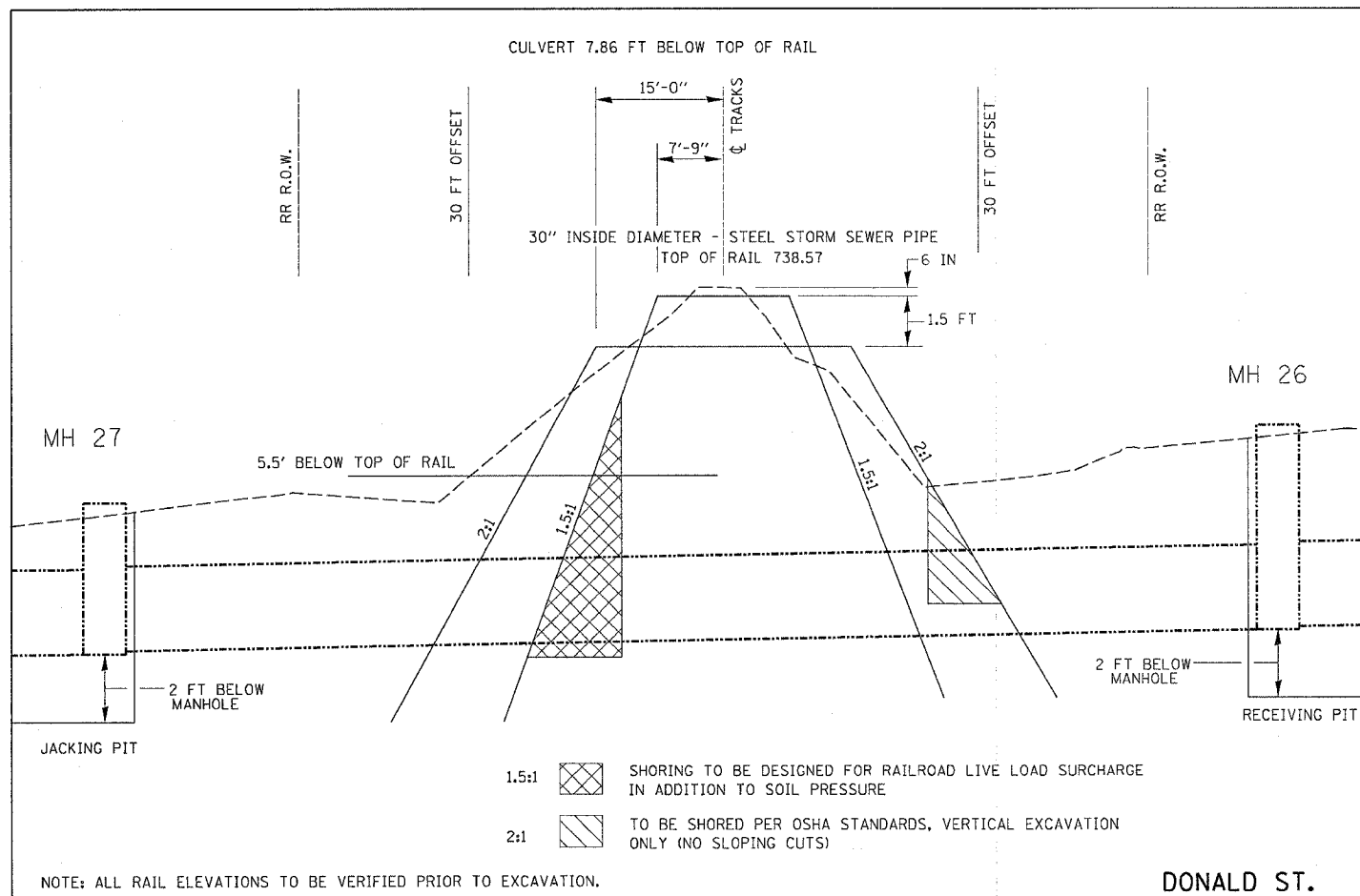

PLOT DATE = Fri Oct 21 10:41:21 2005  
 FILE NAME = c:\p\projects\201786\j87786.dgn  
 PLOT SCALE = 50.0000 / IN  
 REFERENCE = NONE