

F.A. RTE.	SECTION	COUNTY	TOTAL SHEETS	SHEET NO.
573	116R-4	DEKALB	416	71
STA. 791+00		TO STA. 797+00		
FED. ROAD DIST. NO.		ILLINOIS FED. AID PROJECT		



EXIST. CURVE 1290
 PI STA. = 793+82.44
 $\Delta = 30^\circ 45' 11''$ (LT)
 $D = 5^\circ 04' 14''$
 $R = 1,130.00'$
 $T = 310.76'$
 $L = 606.52'$
 $E = 41.95'$
 $e =$
 T.R. =
 S.E. RUN =
 P.C. STA. = 790+71.69
 P.T. STA. = 796+78.21

Gregory S. Degeeter
 & Greg Kaleel

Building, Commerc

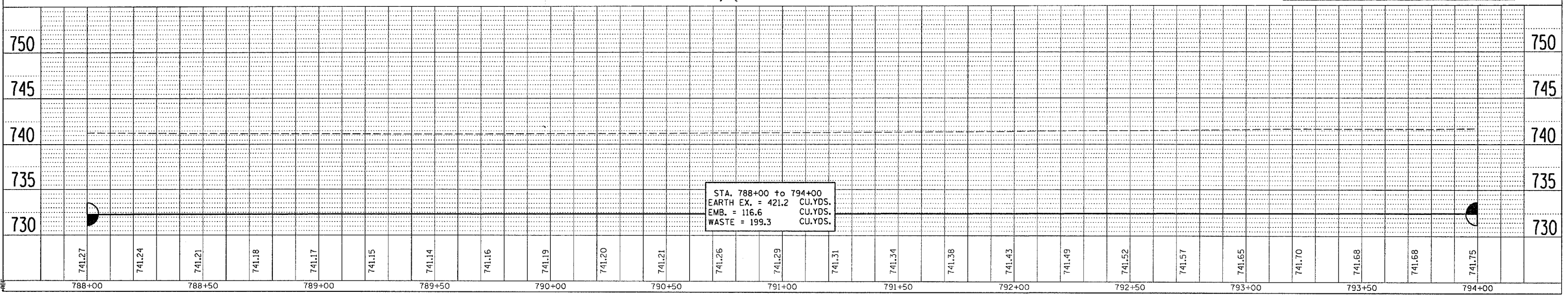
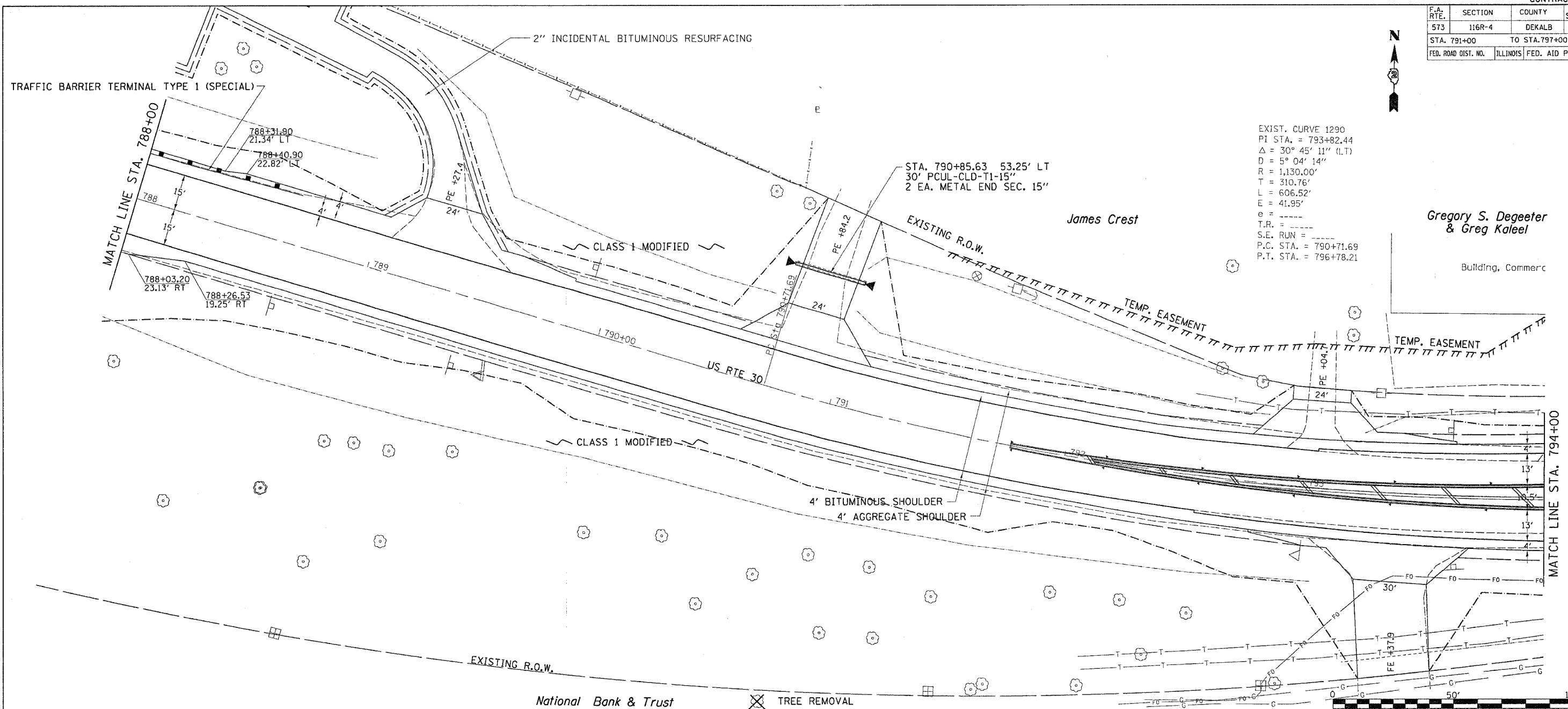

PLAN	DATE
BY	
CHECKED	
DATE	

PROFILE	DATE
BY	
CHECKED	
DATE	

DATE TIME
 DRAWN
 REF
 REF