

F.A.P. RTE.	SECTION	COUNTY	TOTAL SHEETS	SHEET NO.
573	116R-4	DEKALB	416	89
STA.		TO STA.		
FED. ROAD DIST. NO.		ILLINOIS FED. AID PROJECT		

EXIST. CURVE 70270  
 PI STA. = 78+21.20  
 $\Delta = 1^\circ 28' 50''$  (LT)  
 $D = 1^\circ 08' 45''$   
 $R = 5,000.00'$   
 $T = 64.61'$   
 $L = 129.21'$   
 $E = 0.42'$   
 $e =$   
 T.R. =  
 S.E. RUN =  
 P.C. STA. = 77+56.60  
 P.T. STA. = 78+85.80

Betty L. Harris  
 & Celestine Jandt

David E. &  
 Victoria L. Fessler

David E. & Victoria L. Fessler

Florence J. &  
 Harold O. Darling

R.A. Lundquist

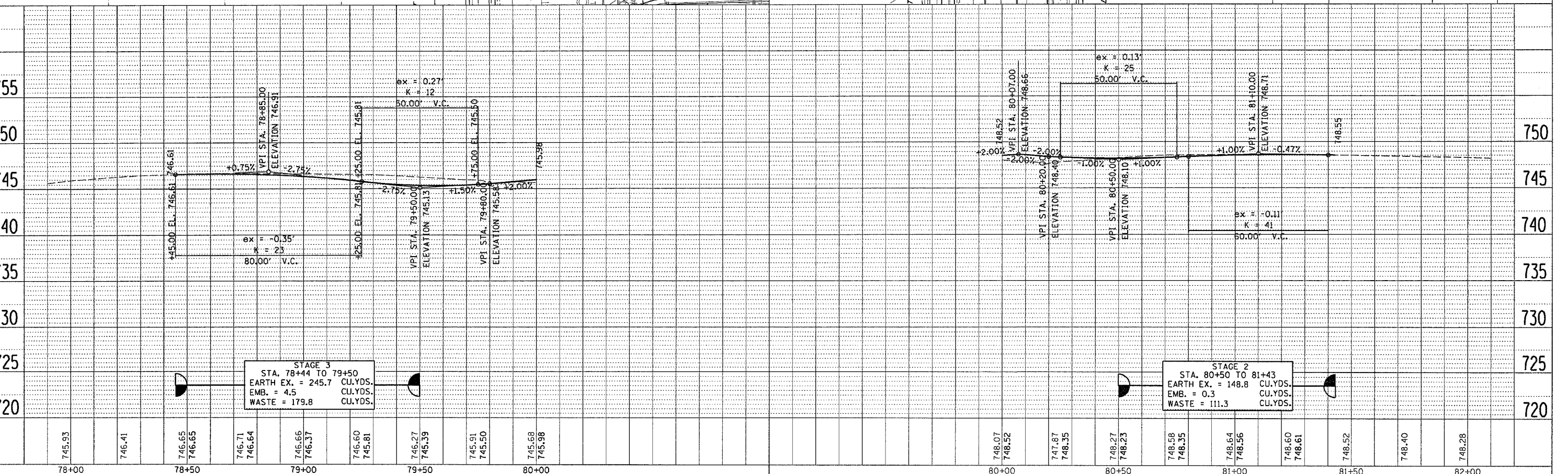
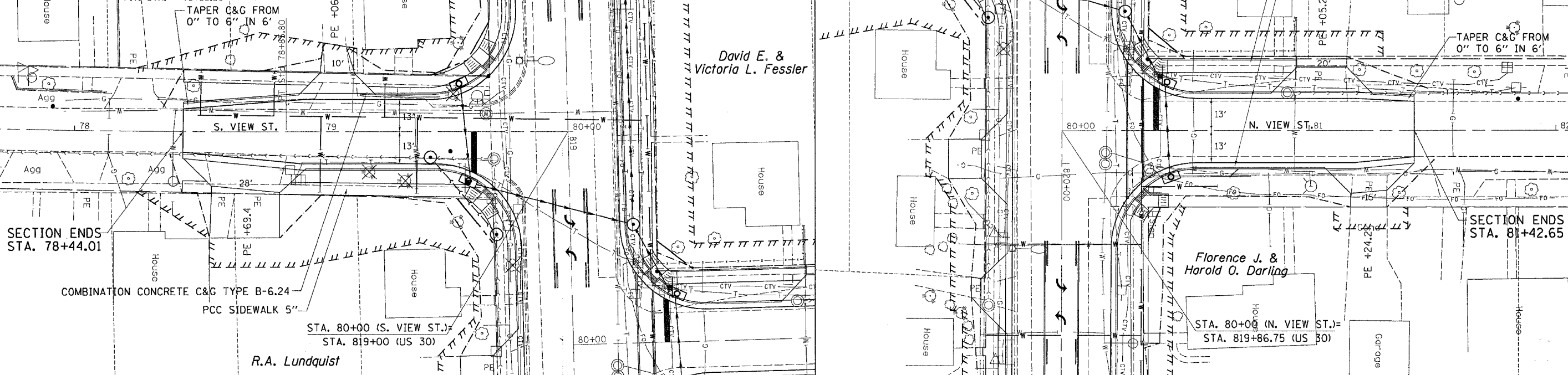

STAGE 3  
 STA. 78+44 TO 79+50  
 EARTH EX. = 245.7 CU.YDS.  
 EMB. = 4.5 CU.YDS.  
 WASTE = 179.8 CU.YDS.

STAGE 2  
 STA. 80+50 TO 81+43  
 EARTH EX. = 148.8 CU.YDS.  
 EMB. = 0.3 CU.YDS.  
 WASTE = 111.3 CU.YDS.

DATE-TIME  
 REF  
 REF  
 REF

PLAN  
 BY  
 DATE  
 CHECKED  
 DATE

PROFILE  
 BY  
 DATE  
 CHECKED  
 DATE