

F.A. R. RTE.	SECTION	COUNTY	TOTAL SHEETS	SHEET NO.
573	116R-4	DEKALB	416	193
STA.		TO STA.		
FED. ROAD DIST. NO.		ILLINOIS	FED. AID PROJECT	

STAGE 2



TEMPORARY CURB		
STA.	OFFSET	ELEV.
837+75	32'LT	739.88
838+00	32'LT	740.29
838+25	32'LT	740.26
838+50	32'LT	740.31
838+75	32'LT	740.33
839+00	32'LT	740.45
839+25	32'LT	740.38
839+50	32'LT	740.51
839+75	32'LT	740.58
840+00	32'LT	740.54
840+25	32'LT	740.36
840+50	30'LT	740.26
840+75	30'LT	740.20
841+00	30'LT	740.09
841+25	30'LT	739.93
841+50	30'LT	739.82

CONSTRUCT TEMPORARY RUNAROUND TO BE USED IN STAGE III AND STAGE V

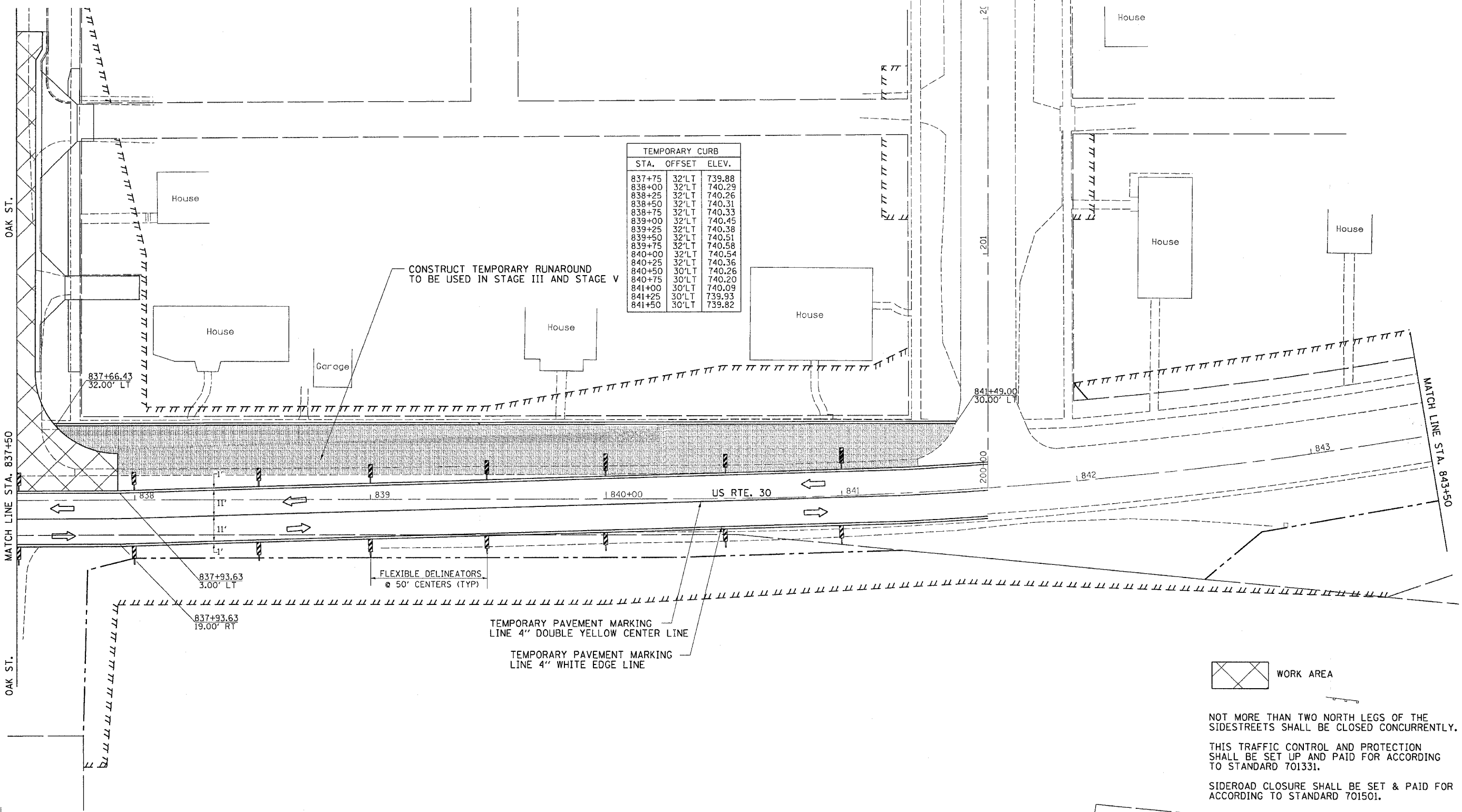

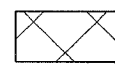
 WORK AREA

NOT MORE THAN TWO NORTH LEGS OF THE SIDESTREETS SHALL BE CLOSED CONCURRENTLY.
 THIS TRAFFIC CONTROL AND PROTECTION SHALL BE SET UP AND PAID FOR ACCORDING TO STANDARD 701331.
 SIDEROAD CLOSURE SHALL BE SET & PAID FOR ACCORDING TO STANDARD 701501.

FILE NAME = #FILES
 LEVELS = #LEVELS
 PLOT SCALE = #PLOTS/SCALE
 DATE = #/##/##
 OPERATOR = JORDAN
 REF REF REF REF