

STAGE 4

CONTRACT NO. 64517				
F.A. RTE.	SECTION	COUNTY	TOTAL SHEETS	SHEET NO.
573	116R-4	DEKALB	416	207
STA.		TO STA.		
FED. ROAD DIST. NO.		ILLINOIS FED. AID PROJECT		

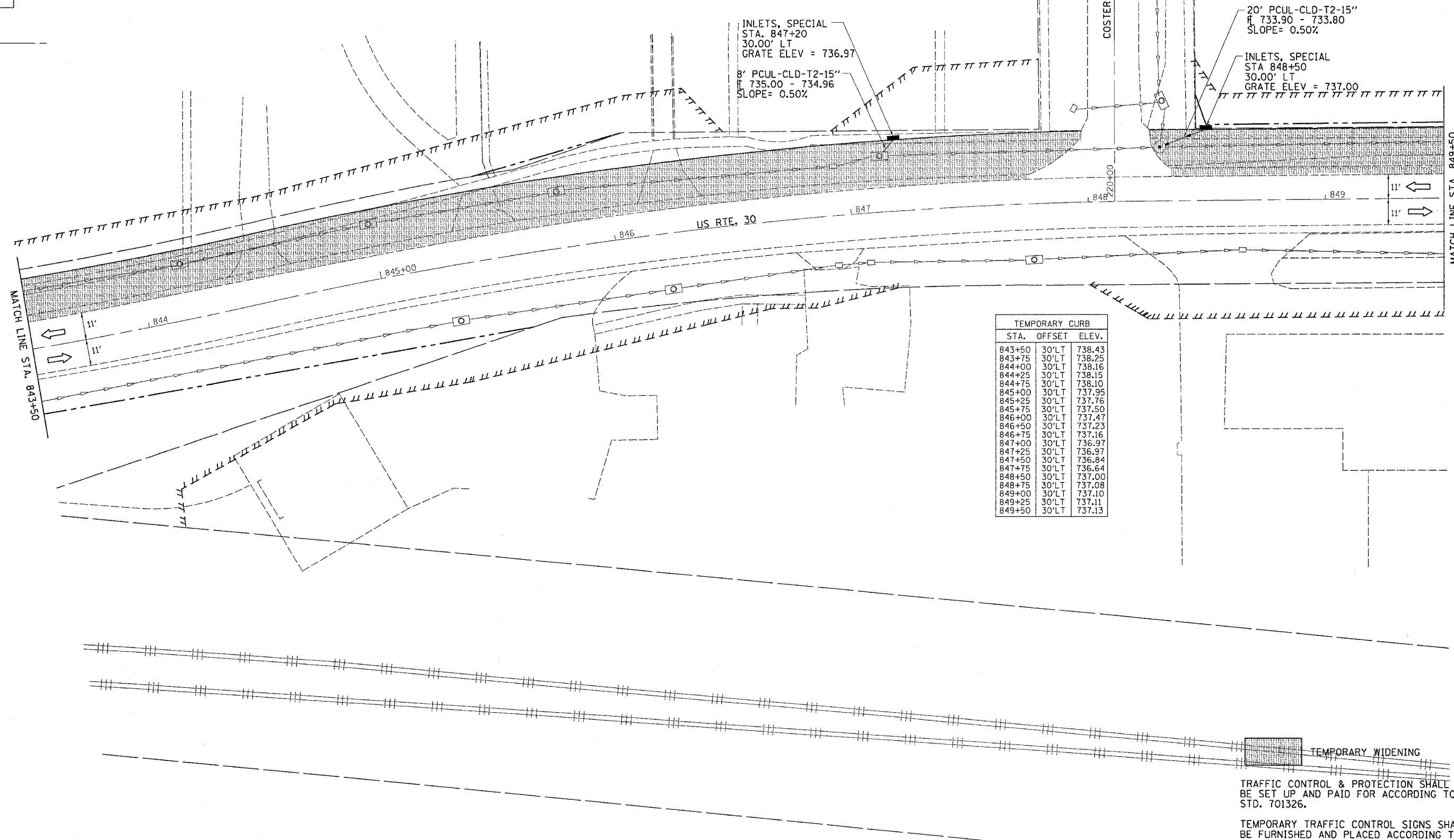

INLETS, SPECIAL
 STA. 847+20
 30.00' LT
 GRATE ELEV = 736.97
 8' PCUL-CLD-T2-15"
 H 735.00 - 734.96
 SLOPE= 0.50%

20' PCUL-CLD-T2-15"
 H 733.90 - 733.80
 SLOPE= 0.50%

INLETS, SPECIAL
 STA 848+50
 30.00' LT
 GRATE ELEV = 737.00

TEMPORARY CURB		
STA.	OFFSET	ELEV.
843+50	30'LT	738.43
843+75	30'LT	738.25
844+00	30'LT	738.16
844+25	30'LT	738.15
844+75	30'LT	738.10
845+00	30'LT	737.95
845+25	30'LT	737.76
845+75	30'LT	737.50
846+00	30'LT	737.47
846+50	30'LT	737.23
846+75	30'LT	737.16
847+00	30'LT	736.97
847+25	30'LT	736.97
847+50	30'LT	736.84
847+75	30'LT	736.64
848+50	30'LT	737.00
848+75	30'LT	737.08
849+00	30'LT	737.10
849+25	30'LT	737.11
849+50	30'LT	737.13

TEMPORARY WIDENING

TRAFFIC CONTROL & PROTECTION SHALL BE SET UP AND PAID FOR ACCORDING TO STD. 701326.

TEMPORARY TRAFFIC CONTROL SIGNS SHALL BE FURNISHED AND PLACED ACCORDING TO STD. 701326

FILE NAME = #FILES
 LEVELS = #LEVELS
 SCALE = #SCALE
 PLOT DATE = #DATE
 OPERATOR = #NAME