

FAP NO.	SECTION	COUNTY	TOTAL SHEETS	SHEET NO.
599	42MFT-BR	ROCK ISLAND	90	20
STA. 404+30		TO STA. 411+46		

EXISTING CONDITIONS: CONTRACT 64641

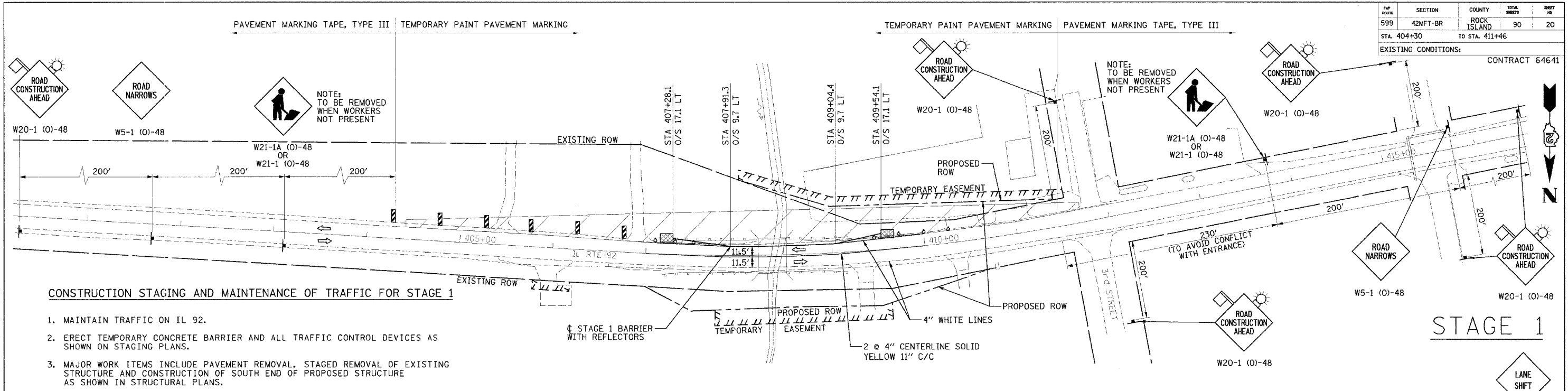

STAGE 1

CONSTRUCTION STAGING AND MAINTENANCE OF TRAFFIC FOR STAGE 1

1. MAINTAIN TRAFFIC ON IL 92.
2. ERECT TEMPORARY CONCRETE BARRIER AND ALL TRAFFIC CONTROL DEVICES AS SHOWN ON STAGING PLANS.
3. MAJOR WORK ITEMS INCLUDE PAVEMENT REMOVAL, STAGED REMOVAL OF EXISTING STRUCTURE AND CONSTRUCTION OF SOUTH END OF PROPOSED STRUCTURE AS SHOWN IN STRUCTURAL PLANS.

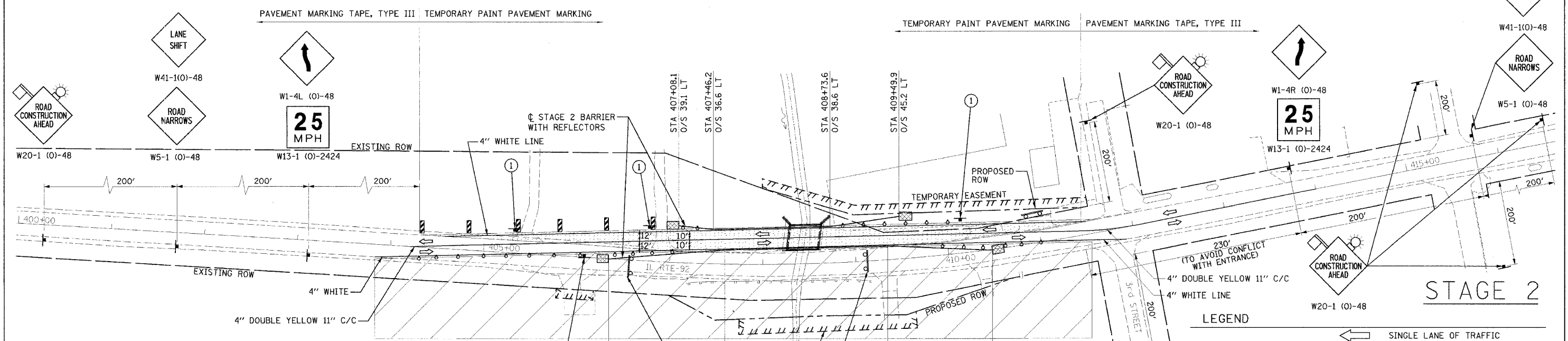

STAGE 2

CONSTRUCTION STAGING AND MAINTENANCE OF TRAFFIC FOR STAGE 2

1. MAINTAIN TRAFFIC ON IL 92.
2. REMOVE LEFT SHOULDER AND CONSTRUCT TEMPORARY PAVEMENT IN ACCORDANCE WITH STANDARD 701326-01.
3. ERECT TEMPORARY CONCRETE BARRIER AND ALL TRAFFIC CONTROL DEVICES AS SHOWN ON STAGING PLANS.
4. SHIFT TRAFFIC ONTO TEMPORARY PAVEMENT
5. MAJOR WORK ITEMS INCLUDE PAVEMENT REMOVAL, REMOVAL OF REMAINING EXISTING STRUCTURE, CONSTRUCT BALANCE OF CULVERT AND CONSTRUCT WB FULL DEPTH PAVEMENT (EXCEPT FINAL WEARING SURFACE) FROM STA 407+70 TO STA 411+00 AND EB FULL DEPTH PAVEMENT (EXCEPT FINAL WEARING SURFACE) FROM STA 407+70 TO STA 409+20, RIGHT SIDE SHOULDERS AND ENTRANCES.

TEMPORARY PAVEMENT SCHEDULE

STATION	LT EDGE OF TEMPORARY PAVEMENT		RT EDGE OF TEMPORARY PAVEMENT		CROSS SLOPE
	ELEVATION	OFFSET	ELEVATION	OFFSET	
404+31.70	BEGIN LEFT EDGE OF TEMPORARY PAVEMENT		N/A	N/A	N/A
405+00.00	573.34	18.53 LT	MATCH EX EDGE OF PAVEMENT		1.50%
406+00.00	572.58	26.79 LT	MATCH EX EDGE OF PAVEMENT		
407+00.00	572.12	34.91 LT	MATCH EX EDGE OF PAVEMENT		
408+00.00	572.60	39.40 LT	572.96	15.40 LT	
408+10.28	572.65	39.59 LT	573.01	15.59 LT	
408+23.03	572.71	39.74 LT	573.07	15.74 LT	
408+41.00	572.57	39.80 LT	572.93	15.80 LT	
408+58.05	572.66	39.75 LT	573.02	15.75 LT	
408+73.29	572.74	39.56 LT	573.10	15.56 LT	
409+00.00	572.87	38.96 LT	573.23	14.96 LT	
410+00.00	573.04	33.58 LT	MATCH EX EDGE OF PAVEMENT		1.50%
411+00.00	573.09	23.20 LT	MATCH EX EDGE OF PAVEMENT		
411+40.00	573.07	16.68 LT	MATCH EX EDGE OF PAVEMENT		
411+63.40	END LEFT EDGE OF TEMPORARY PAVEMENT		N/A	N/A	N/A

LEGEND

- ← SINGLE LANE OF TRAFFIC
 - ▬ TYPE 3 BARRICADE W/STEADY BURN LIGHTS - QUANTITY AS REQUIRED FOR PROPER CLOSURE
 - ⊙ DRUM W/STEADY BURNING LIGHT AT 25' SPACING
 - ▬ VERTICAL PANEL W/STEADY BURNING LIGHT AT 50' SPACING
 - ▬ TEMPORARY PAVEMENT
 - ▬ WORK AREA
 - ▬ TEMPORARY IMPACT ATTENUATORS IN COMPLIANCE WITH NCHRP 350 FOR THE POSTED SPEED LIMIT
- AT ALL ENTRANCES
NOTE: ABOVE SIGNS SHALL BE BLACK ON ORANGE REFLECTIVE BACKGROUND

REVISIONS	
NAME	DATE

ILLINOIS DEPARTMENT OF TRANSPORTATION
FAP 599 (IL 92)
SECTION 42MFT-BR
ROCK ISLAND COUNTY
MAINTENANCE OF TRAFFIC
DRAWN BY: HLC

