

STATE OF ILLINOIS
DEPARTMENT OF TRANSPORTATION

ROUTE NO.	SECTION	COUNTY	SHEET	SHEET	SHEET NO.
	8	Henry	26	10	8 SHEETS
F.A.U. 5862		ILLINOIS		FED. AID PROJECT-	
FED. ROAD DIST. NO. 7		ILLINOIS		FED. AID PROJECT-	

* Section 2BR-1 Contract #64B10

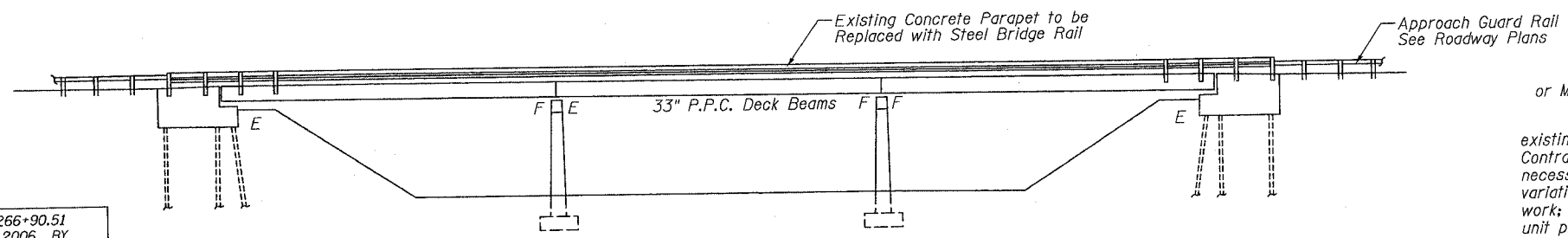

ELEVATION

STATION 266+90.51
RE-BUILT 2006 BY
STATE OF ILLINOIS
F.A.U. RT. 5862 SEC. 2BR-1
LOADING HS20-44
STR. NO. 037-0127

LETTERING FOR NAME PLATE
SEE STD. 515001

GENERAL NOTES

Reinforcement bars shall conform to the requirements of AASHTO M-31, or M-322, Grade 60.

Plan dimensions and details relative to existing structure have been taken from existing plans and are subject to nominal construction variations. It shall be the Contractor's responsibility to verify such dimensions and details in the field and make necessary approved adjustments prior to construction or ordering of materials. Such variations shall not be cause for additional compensation for a change in the scope of work; however, the Contractor will be paid for the quantity actually furnished at the unit price bid for the work.

Existing structure construction plans and subsequent repair plans are available from the IDOT District office by written request. The contractor shall be responsible for obtaining and reviewing the plans prior to construction.

The minimum thickness of the Concrete overlay shall be 5" and varies as required to adjust for the new profile grade and beam camber.

All construction joints shall be bonded.

No instream work will be allowed on this project.

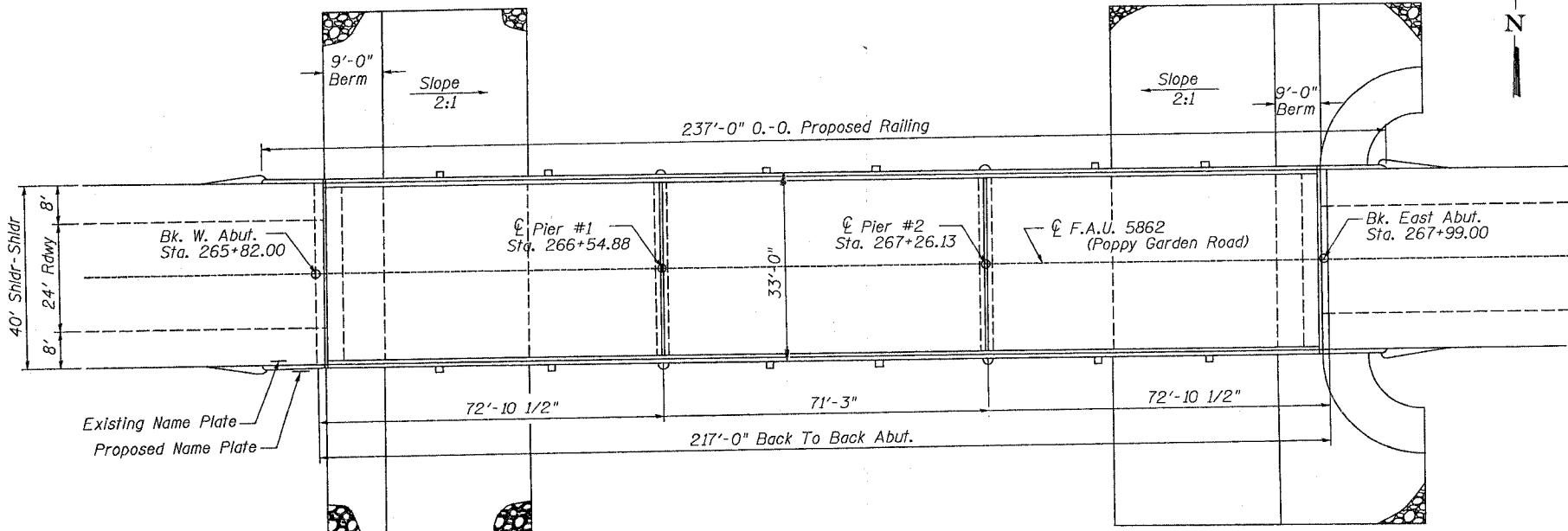

PLAN

The contractor is advised that the existing PPC Deck Beams are in a deteriorated condition with reduced load carrying capacity. It is the contractor's responsibility to account for the condition of the beams when developing construction procedures for removal and replacement of the superstructure.

If the contractor's procedure for existing beam removal or placement of new beams involves placement of cranes or other heavy equipment on new beams, a detailed procedure shall be submitted to the Engineer for approval. The procedure shall include calculations, prepared and sealed by an Illinois Licensed Structural engineer, verifying that the equipment and procedure used will not overstress the new beams. To distribute load to multiple beams and protect the concrete, in all cases a double layer mat of heavy timbers shall be used at all times under crane tracks or wheels and any other outriggers in the down position. If necessary, shims shall be used under the crane mat to ensure uniform contact with the underlying beams. If cranes or other heavy equipment will be placed on new beams prior to placement of the concrete wearing surface, it shall be done after the dowel rods are grouted and cured for 24 hours minimum and prior to grouting the shear keys. A temporary means of lateral restraint will be required for fascia beams at expansion ends of beams to prevent movement of the beams.

The cut strands at each beam end shall be given two coats of zinc dust spray or paint meeting the requirements of ASTM A 780. The zinc dust spray or paint shall be applied before corrosion appears and allowed to dry according to the manufacturer's specifications prior to another coat of zinc. A concrete sealer meeting the requirements of Section 587 of the Standard Specifications shall be applied to the exterior face and 9" in on the underside of the fascia beams. The sealer shall be applied after visible crack growth has subsided. This work shall be performed by the producer and included with the cost of the item.

LOADING HS20-44 (New Construction)
No Allowance for Future Wearing Surface

DESIGN SPECIFICATIONS (New Construction)
2002 AASHTO

DESIGN STRESSES (New Construction)

FIELD UNITS	PRECAST PRESTRESSED UNITS
f'c = 3,500 p.s.i.	f'c = 5,000 p.s.i.
fy = 60,000 p.s.i. (Reinforcement)	f'ci = 4,000 p.s.i.
	f's = 270,000 p.s.i. (1/2" Low Lax Strands)
	f'si = 201,960 p.s.i. (1/2" Low Lax Strands)

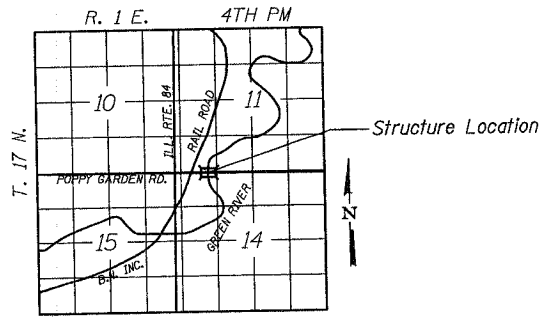

LOCATION SKETCH

WENDLER ENGINEERING SERVICES, INC.
Illinois Professional Design
Firm No. 184-000848
Bridge plan sheets
1 thru 8 Only

SCOTT A. BROWN
DIXON, ILLINOIS
ILLINOIS LICENSED STRUCTURAL ENGINEER NO. 081-005981
EXPIRES 11-30-2006

SCOTT A. BROWN
DATE 8/31/05

TOTAL BILL OF MATERIAL

ITEM	UNIT	TOTAL
Removal of Existing Superstructures	Each	1
Bridge Deck Grooving	Sq Yd	721
Concrete Wearing Surface	Sq Yd	744
Precast Prestressed Concrete Deck Beams (33" Depth)	Sq. Ft.	7046
Reinforcement Bars, Epoxy Coated	Pound	10170
Formed Concrete Repair (Depth Equal to or Less Than 5 Inches)	Sq. Ft.	30
Name Plates	Each	1
Concrete Superstructures	Cu. Yd.	9.7
Concrete Removal	Cu. Yd.	9.2
Bridge Joint System Expansion 1"	Foot	99
Steel Bridge Rail, Type SM	Foot	474
Protective Coat	Sq Yd	914

GENERAL PLAN AND ELEVATION
F.A.U. 5862 (POPPY GARDEN RD)
OVER GREEN RIVER
SECTION 2BR-1
HENRY COUNTY
STR. NO. 037-0127

DESIGNED	SB
CHECKED	RB
DRAWN	BH, BS
CHECKED	SB