

STATE OF ILLINOIS
DEPARTMENT OF TRANSPORTATION

SECTION	COUNTY	TOTAL SHEETS	SHEET NO.	SHEET NO.
IL 113	109BR, N KANKAKEE COUNTY	58	21	14 SHEETS
FED. ROAD DIST. NO. 7 ILLINOIS		FED. AID PROJECT-		
CONTRACT # 66410				

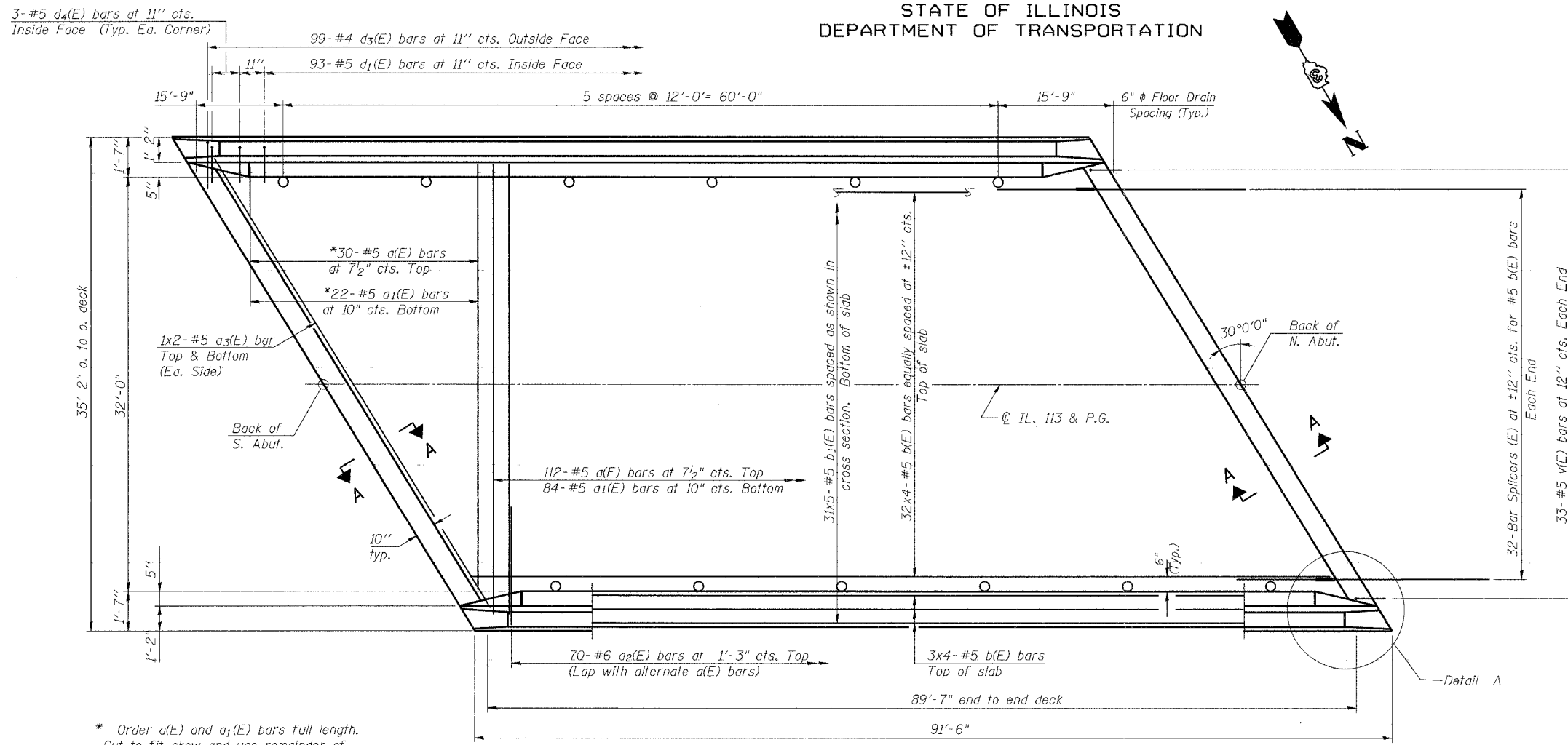

* Order a(E) and a₁(E) bars full length. Cut to fit skew and use remainder of bars in opposite end.

PLAN

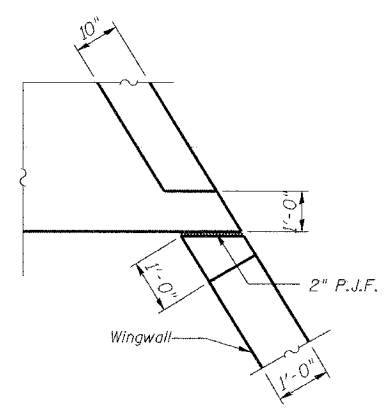

DETAIL A
(Parapet and approach not shown)
(Similar at all four corners)

MIN. BAR LAP
#5 = 1'-8"

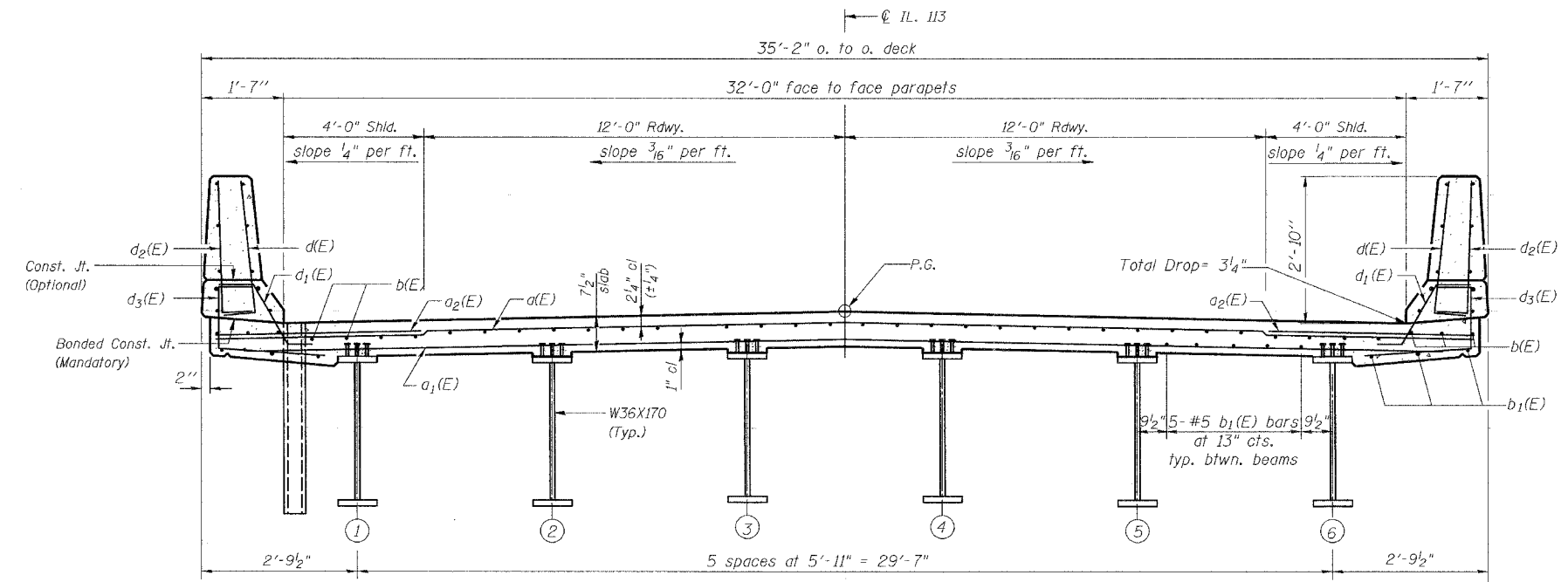

CROSS SECTION
(Looking East)

- Notes:
- See Sheet 5 of 14 for superstructure details and Bill of Material.
 - Reinforcement bars designated (E) shall be epoxy coated.
 - Bars indicated thus 20 x 3-#5 etc. indicates 20 lines of bars with 3 lengths per line.
 - See Sheet 5 of 14 for parapet reinforcement.
 - See Sheet 6 of 14 for Section A-A.

DESIGNED	M.R./R.A.
CHECKED	H.T.
DRAWN	J.S.
CHECKED	H.T./M.R.

SUPERSTRUCTURE
IL 113 OVER WILEY CREEK (PUBLIC WATERS)
FAS ROUTE 1317 (IL 113), SECTION 109BR, N
KANKAKEE COUNTY
STATION 260+00.00
STRUCTURE NO. 046-0137

SCALE: NONE DATE: AUGUST, 2005
Soodan & Associates, Inc.
100 North LaSalle Street, Suite 1800
Chicago, Illinois 60602