

F.A.P. RTE.	SECTION	COUNTY	TOTAL SHEETS	SHEET NO.
687	*	McDonough / Fulton	58	18
STA.		TO STA.		
FED. ROAD DIST. NO.	ILLINOIS	FED. AID PROJECT		

*04 CULV. EXT. REPAIR 2006

JOHN S. SCHAUBLE

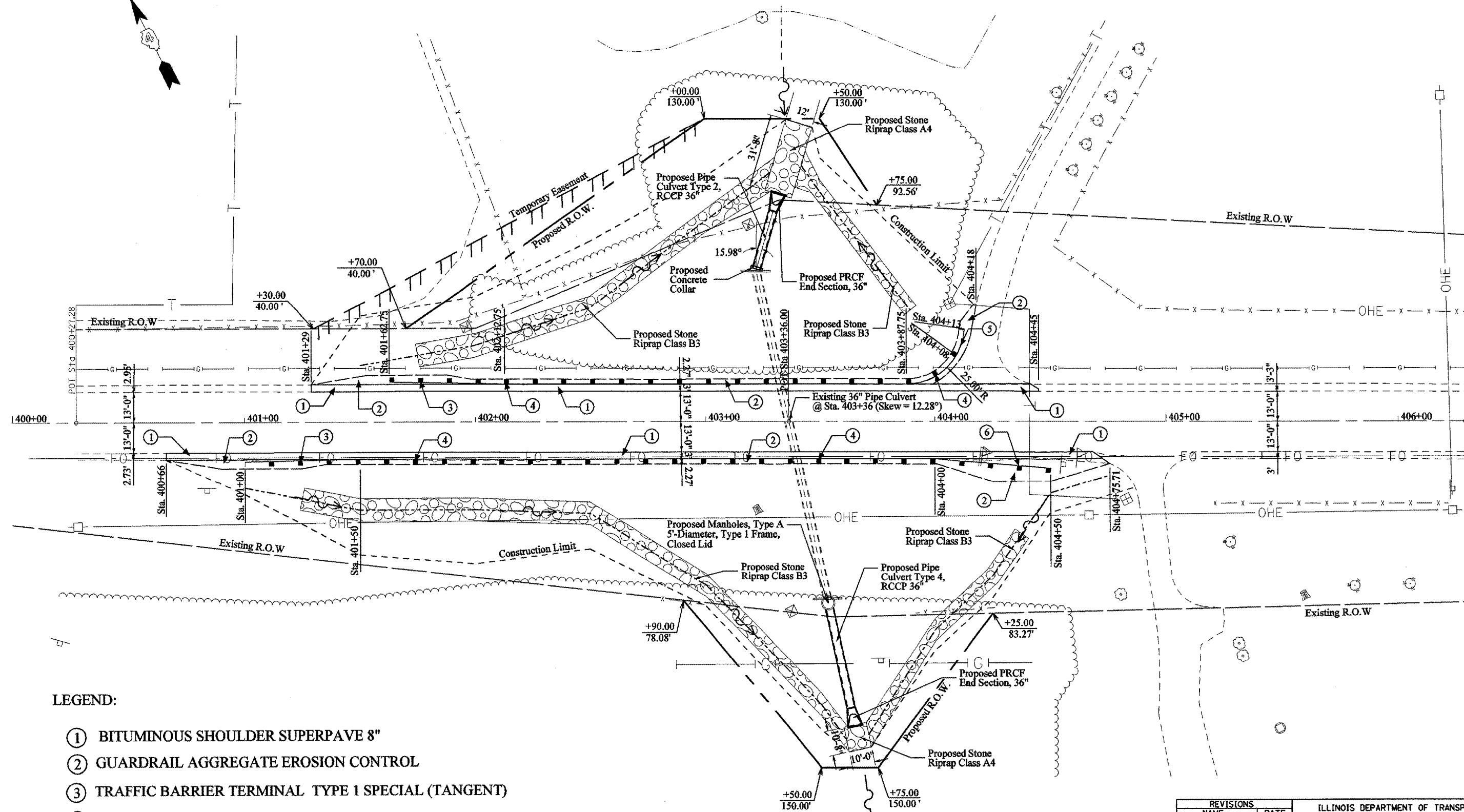

LEGEND:

- ① BITUMINOUS SHOULDER SUPERPAVE 8"
- ② GUARDRAIL AGGREGATE EROSION CONTROL
- ③ TRAFFIC BARRIER TERMINAL TYPE 1 SPECIAL (TANGENT)
- ④ STEEL PLATE BEAM GUARDRAIL TYPE A
- ⑤ TRAFFIC BARRIER TERMINAL, TYPE 2
- ⑥ TRAFFIC BARRIER TERMINAL TYPE 1 SPECIAL (FLARED)

RICHARD WHITEMAN JR.

REVISIONS	
NAME	DATE

ILLINOIS DEPARTMENT OF TRANSPORTATION

PROPOSED PLANS LOCATION #3

SCALE: VERT. _____
HORIZ. _____

DATE _____ DRAWN BY _____
CHECKED BY _____