

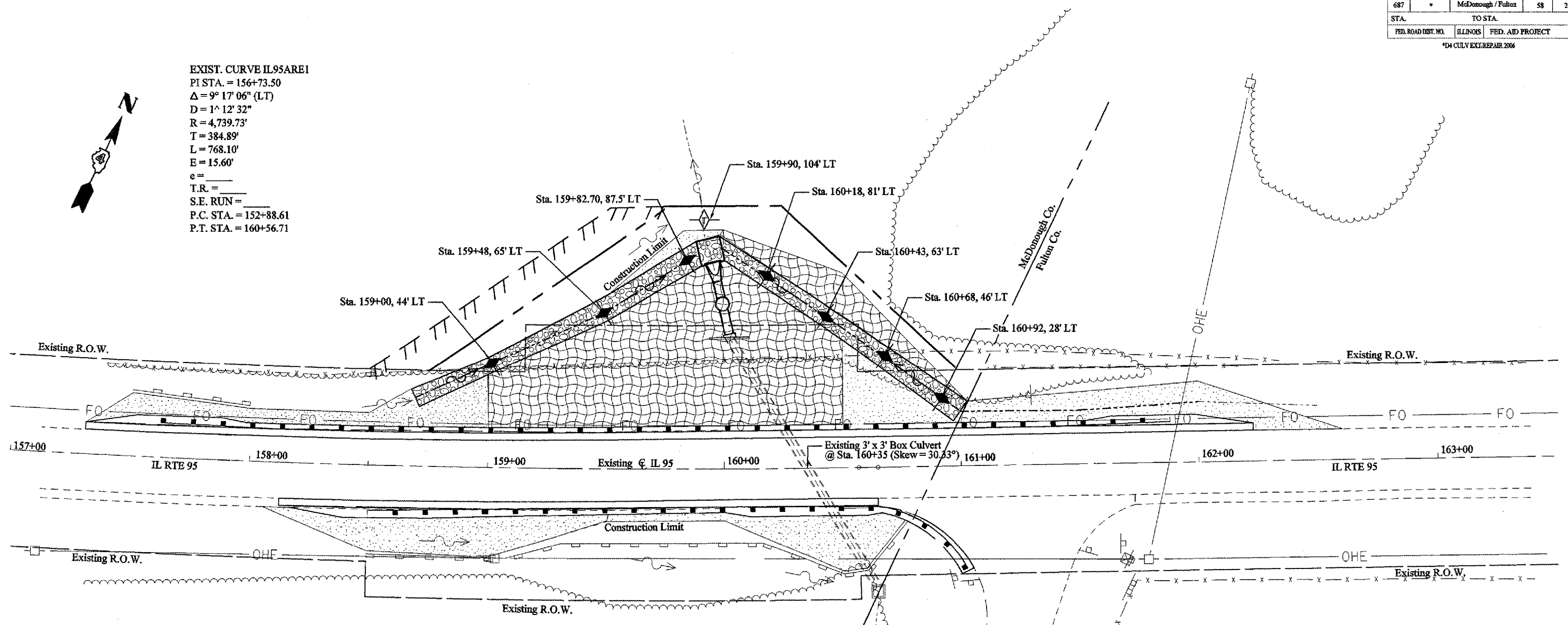

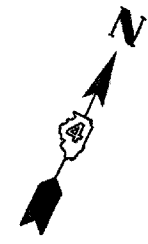

F.A.P. RTE.	SECTION	COUNTY	TOTAL SHEETS	SHEET NO.
687	*	McDonough / Fulton	58	20
STA.		TO STA.		
FED. ROAD DIST. NO.	ILLINOIS	FED. AID PROJECT		

*D4 CULV EXC/REPAIR 2006

EXIST. CURVE IL95ARE1
 PI STA. = 156+73.50
 $\Delta = 9^\circ 17' 06''$ (LT)
 $D = 1^\circ 12' 32''$
 $R = 4,739.73'$
 $T = 384.89'$
 $L = 768.10'$
 $E = 15.60'$
 $e =$
 $T.R. =$
 $S.E. RUN =$
 $P.C. STA. = 152+88.61$
 $P.T. STA. = 160+56.71$

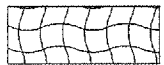

LEGEND

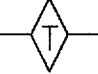
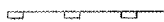
-  SEEDING CLASS 3 (MODIFIED)
-  HEAVY DUTY EXCELSIOR BLANKET
-  AGGREGATE DITCH CHECKS
-  TEMPORARY DITCH CHECKS
-  PERIMETER EROSION BARRIER

Note:
 A Endangered Plant is located between Rt. Sta. 158+50 to Sta. 160+50 close to the tree line. The Contractor shall contact Greg Larson (309) 671-3479 prior to any construction at this location and before the installation of any fence to locate and protect the Endangered Species.

REVISIONS	
NAME	DATE

ILLINOIS DEPARTMENT OF TRANSPORTATION
**EROSION CONTROL PLANS
 LOCATION #1**
 SCALE: VERT. _____
 HORIZ. _____
 DATE _____ DRAWN BY _____
 CHECKED BY _____