

**SECTION 81B-1
LOCATION 3
ENDS
STATION 160+00.00**

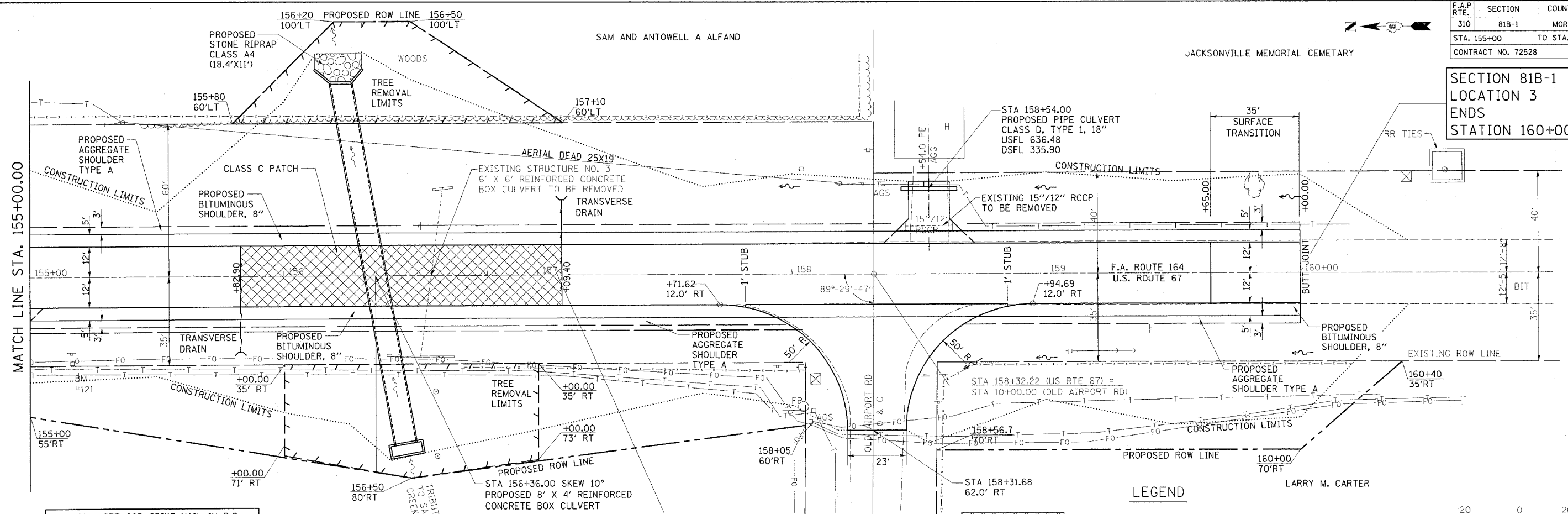

DATE	
BY	
CHECKED	
DATE	
BY	
CHECKED	
DATE	
BY	
CHECKED	

BM #121 - SET 60D SPIKE NAIL IN P.P
1.57 MILES NORTH OF WATER TOWER ROAD
STA 155+16.30, 34.42' RT. EL. 635.98

LEGEND

CLASS C PATCH

LIMITS OF TREE REMOVAL ACRES

SCALE IN FEET

0 20 40

DATE	
BY	
CHECKED	
DATE	
BY	
CHECKED	
DATE	
BY	
CHECKED	

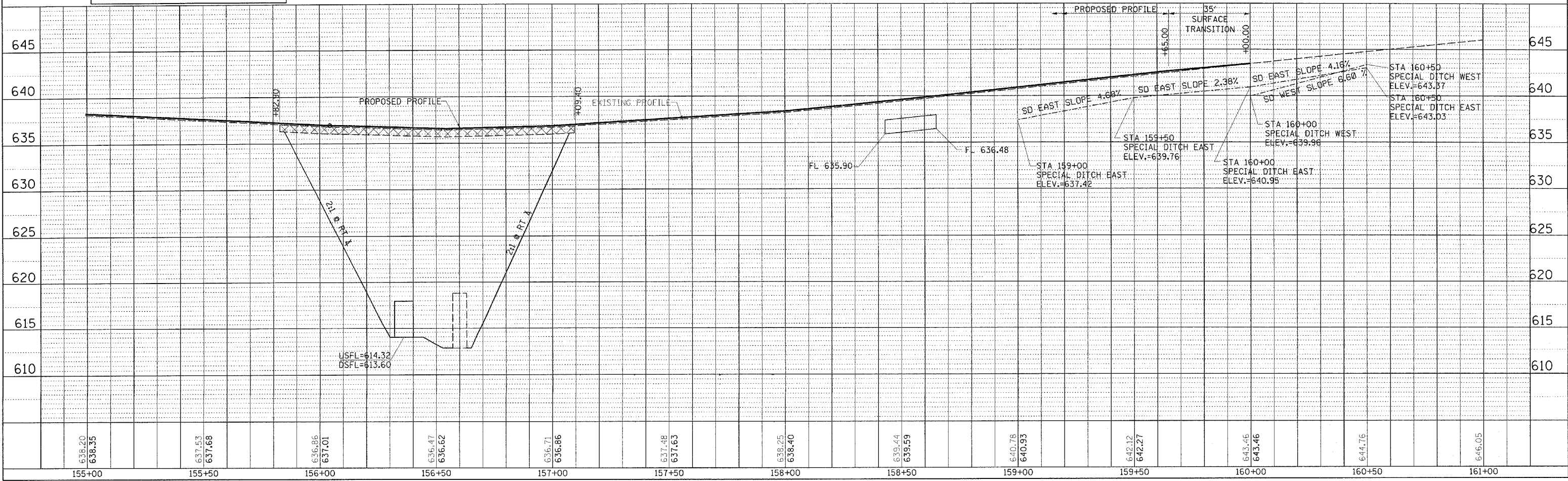

PLAN AND PROFILE, US 67/IL 267 LOCATION 3, STA 155+00 TO STA 161+00

•DGN-SPEC•
•DATE-TIME• \$TIME\$ •USER•