

F.A.P. RTE.	SECTION	COUNTY	TOTAL SHEETS	SHEET NO.
310	818-1	MORGAN	114	90
STA. 1157+50.00		TO STA. 1158+00.00		
CONTRACT NO. 72528				

WEST SIDE

EAST SIDE

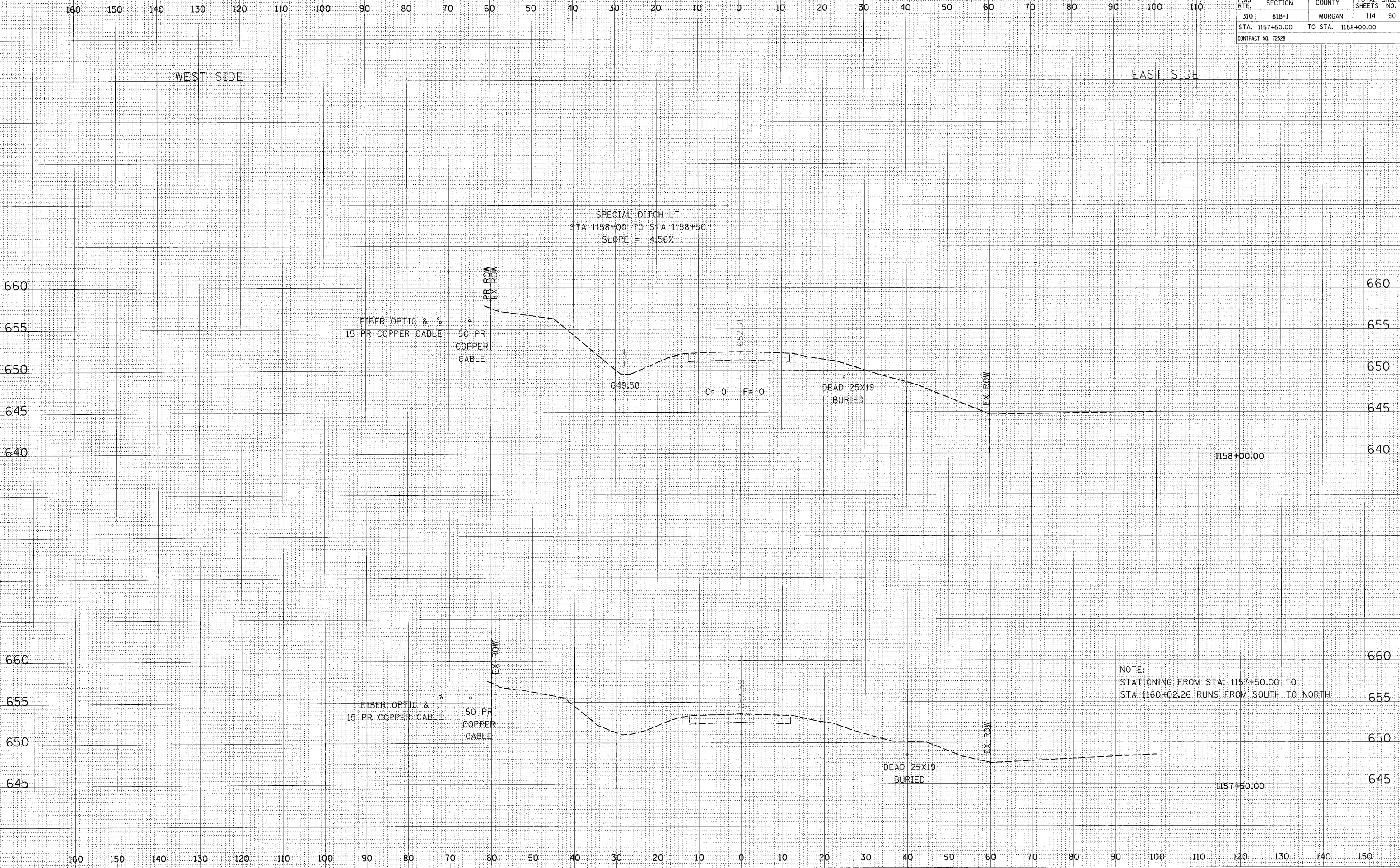

NOTE:
STATIONING FROM STA. 1157+50.00 TO
STA 1160+02.26 RUNS FROM SOUTH TO NORTH

CROSS SECTION, BRUSHY CREEK, US 67 LOCATION 2, STA 1157+50.00 TO STA 1158+00.00