

STATE OF ILLINOIS  
DEPARTMENT OF TRANSPORTATION  
DIVISION OF HIGHWAYS

F.A.P. RTE.	SECTION	COUNTY	TOTAL SHEETS	SHEET NO.
562	117(B-4)	SCOTT	41	1

STATE CONTRACT NO. 72818

TRAFFIC DATA

ADT: IL 100	
2001 = 1650	PV = 94.0%
2006 = 1750	SU = 3.0%
2016 = 1900	MU = 3.0%
2026 = 2100	

INDEX OF SHEETS

- 1 COVER SHEET
  - 2 GENERAL NOTES, COMMITMENTS & MIX DESIGN
  - 3 SUMMARY OF QUANTITIES
  - 4-5 SCHEDULE OF QUANTITIES
  - 6 TYPICAL SECTION & BUTT JOINT DETAIL
  - 7-9 ROADWAY PLAN & PROFILE SHEETS
  - 10 STAGING DETAILS
  - 11 TEMPORARY BRIDGE TRAFFIC SIGNAL LOOP PLACEMENT DETAIL SHEET
  - 12 WIDTH RESTRICTION SIGNAGE
  - 13-17 STORM WATER POLLUTION PREVENTION PLAN
  - 18-19 DISTRICT SIX ENTRANCE DETAILS FOR 3R PROJECTS
  - 20 DITCH RIPRAP DETAIL
  - 21-26 STRUCTURE PLANS - SN 086-7500
  - 26a-26b SOIL BORINGS
  - 27 CULVERT PROFILE
  - 28-39 CROSS SECTIONS
- HIGHWAY STANDARDS

PROPOSED  
HIGHWAY PLANS

FAP ROUTE 562 (IL 100)  
SECTION 117(B-4)  
PROJECT: ACF-0562(013)  
SCOTT COUNTY  
C-96-501-06

IDOT HIGHWAY STANDARDS

000001-04	701306-01
001001	701311-02
001006	701321-08
280001-02	701326-02
442201-01	702001-05
482011-01	704001-02
666001	780001-01
701006-02	781001-02
701011-01	886001
701201-02	886006

PROPOSED CULVERT

SECTION 117(B-4) INCLUDES:  
BRIDGE REPLACEMENT: REPLACE SN 086-0022 WITH  
10'x6'x90" R.C. BOX CULVERT W/ CAST-IN-PLACE HDWLS  
PROPOSED SN 086-7500  
RESURFACING FROM STA. 296+25 TO STA. 304+00

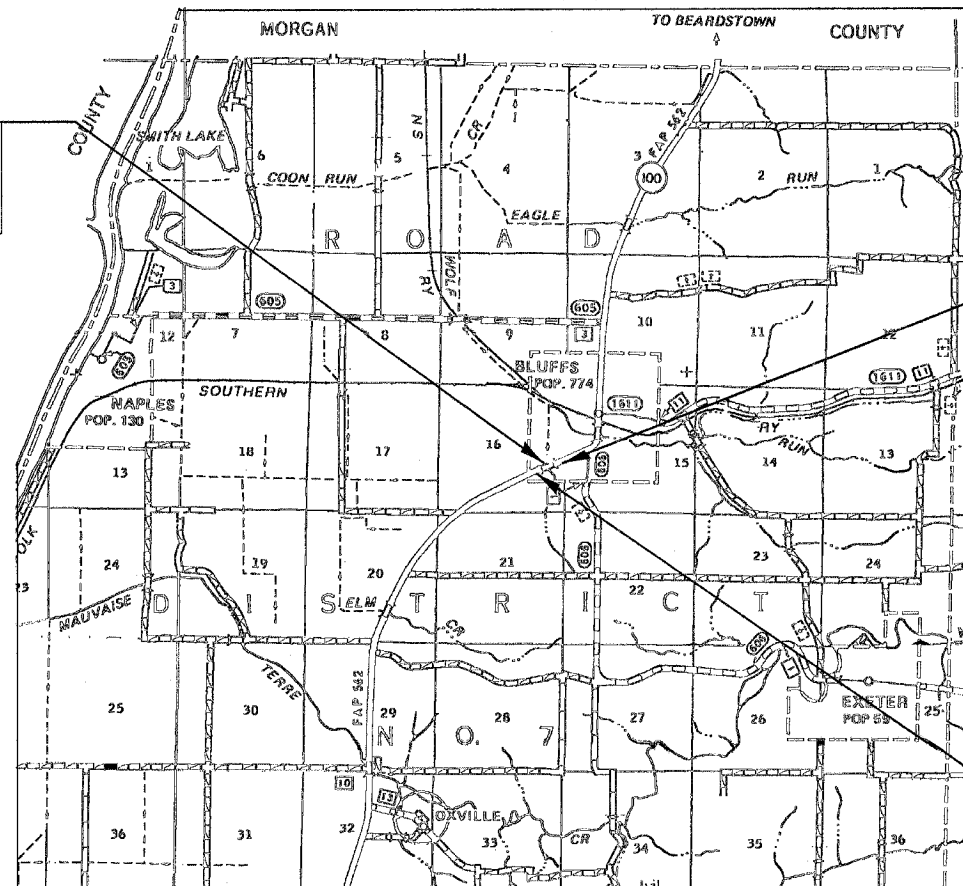

PROJECT BEGINS  
STA. 296 + 25

PROJECT ENDS  
STA. 304 + 00

NET LENGTH OF PROJECT  
0.1468 MILE = 775.00 FT

PLANS PREPARED BY

**HORNER & SHIFRIN, INC.**  
ENGINEERS ■ ARCHITECTS ■ PLANNERS

141 MARKET PLACE SUITE 208 ■ FAIRVIEW HEIGHTS, ILLINOIS 62208  
5200 OAKLAND AVENUE ■ ST. LOUIS, MISSOURI 63110  
www.hornershifrin.com



*Steven R. Donahue* 4/27/05  
STEVEN R. DONAHUE, P.E.  
License Expires 11/30/2005 Date

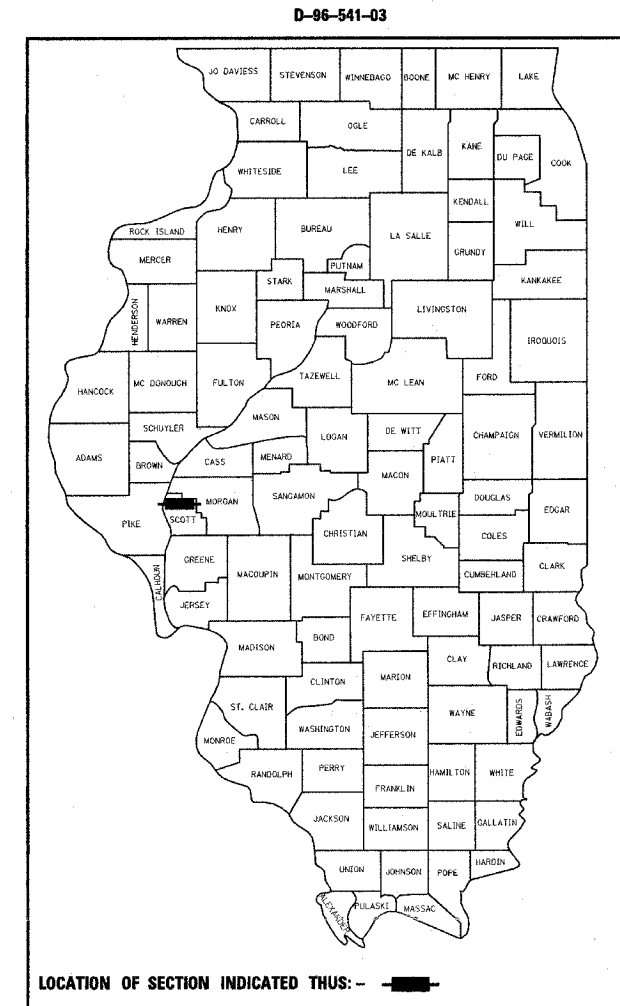

LOCATION OF SECTION INDICATED THUS: — ■ —

STATE OF ILLINOIS  
DEPARTMENT OF TRANSPORTATION  
DIVISION OF HIGHWAYS

SUBMITTED June 7, 2005  
*Chris M. Reed* DISTRICT ENGINEER  
October 14, 2005  
*Mike Hine* ENGINEER OF DESIGN AND ENVIRONMENT  
October 14, 2005  
*Eric E. Howard* DEPUTY DIRECTOR, DIVISION OF HIGHWAYS

PRINTED BY THE AUTHORITY  
OF THE STATE OF ILLINOIS

FULL SIZE PLANS HAVE BEEN PREPARED USING STANDARD  
ENGINEERING SCALES. REDUCED SIZED PLANS WILL NOT  
CONFORM TO STANDARD SCALES. IN MAKING MEASUREMENTS  
ON REDUCED PLANS, THE ABOVE SCALES MAY BE USED.

J.U.L.I.E.  
JOINT UTILITY LOCATION INFORMATION FOR EXCAVATION  
1-800-892-0123

CONTRACT NO. 72818

Plot Date: 4/27/2005  
Plot Time: 12:28:43 PM  
Plotted By: apointnet  
Pen Table: idot.tbl  
Filename: s:\040011\100\Cad\T\_Construction\Plans\01\_Cover\_1100.dgn  
Project Engineer: John Negangard Phone: (217) 782-6390  
Squad Leader: Vince Madonia Phone: (217) 785-9046