

FAP ROUTE	SECTION	COUNTY	TOTAL SHEETS	SHEET NO.
609	76-1BR-2	ST. CLAIR	13	6
STA.		TO STA.		
CONTRACT NO. 76862				

B.M. 100
R.R. SPIKE IN POWER POLE @ W. SIDE OF (IL 157)
EL. 419.43

B.M. 101
CUT " " ON N.E. CORNER OF CONC. FOUND. ON
WATER VALVE IN FRONT OF CENTREVILLE ELEM. SCHOOL W. OF (IL 157)
EL. 414.74

B.M. 102
CUT " " ON BRIDGE CURB
(BEHIND C.R.) @ S.W. CORNER OF S.N. 082-0124
EL. 413.28

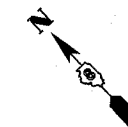

PLAN	SURVEYED	DATE
NOTE BOOK	ALIGNED	
NO.	CHECKED	
	BY	
	FILE NAME	
	CHECKED	

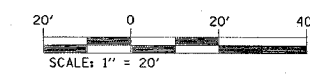
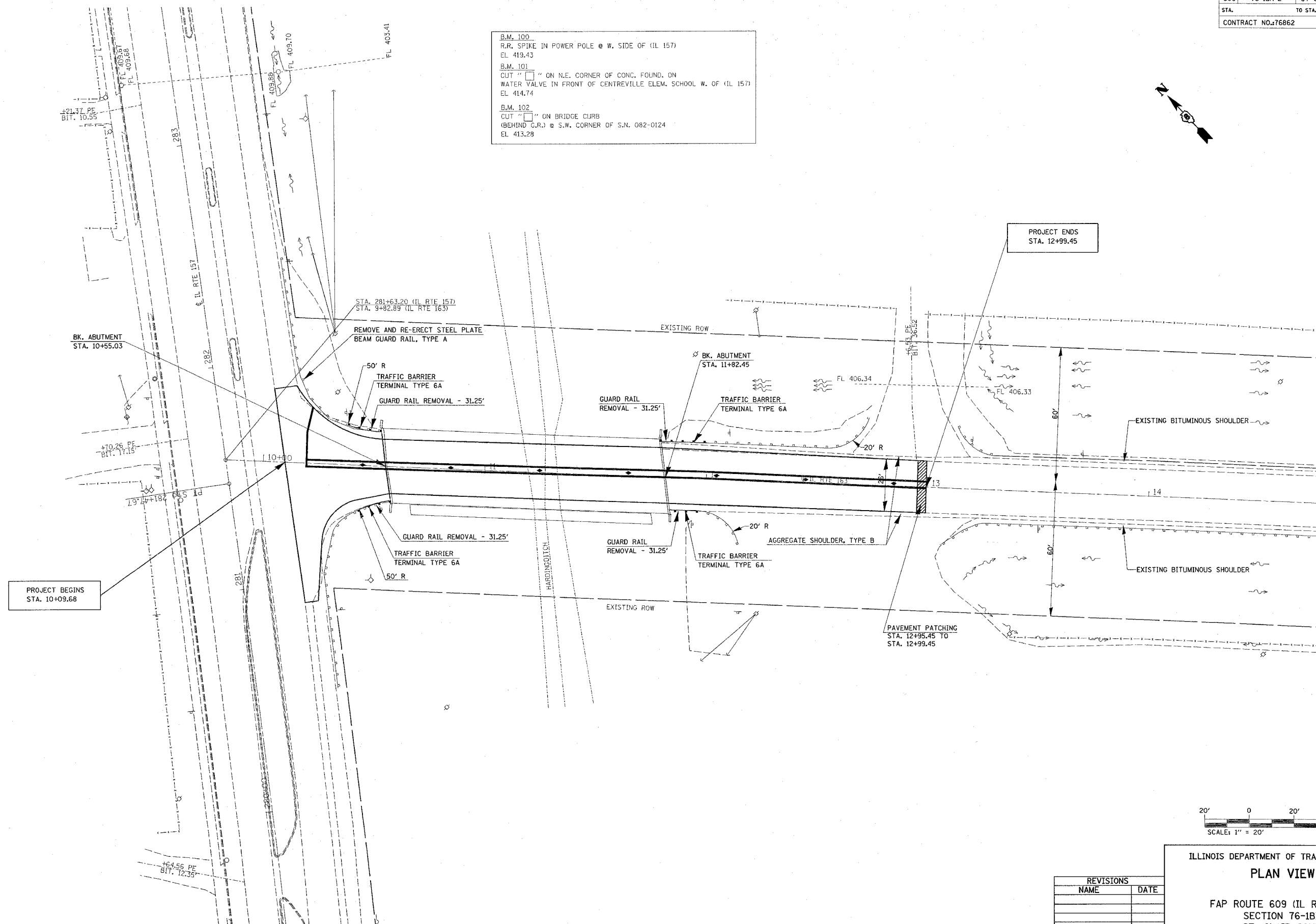

REVISIONS	
NAME	DATE

ILLINOIS DEPARTMENT OF TRANSPORTATION
PLAN VIEW
FAP ROUTE 609 (IL ROUTE 163)
SECTION 76-1BR-2
ST. CLAIR COUNTY

DRAWN BY:
PLOT DATE: *DATE-TIME*

DATE
DATE-TIME
CON-SPEC
REF