

FAP ROUTE	SECTION	COUNTY	TOTAL SHEETS	SHEET NO.
609	76-1BR-2	ST. CLAIR	30	8
STA.	TO STA.		EXISTING CONDITIONS:	

76862

- NOTES:**
- SIGNS REQUIRED SHALL BE SUPPLIED BY I.D.O.T. AND BY THE CONTRACTOR, AS NOTED BELOW. THE CONTRACTOR SHALL FURNISH THE POSTS AND ERECT SIGNS AT THE LOCATIONS SHOWN ON THIS SHEET, AS DIRECTED BY THE R.E./R.T. THE POSTS SHALL REMAIN THE PROPERTY OF THE CONTRACTOR.
 - THE CONTRACTOR SHALL GIVE ILLINOIS DEPARTMENT OF TRANSPORTATION, BUREAU OF OPERATIONS TWO WEEKS NOTICE FOR THE SIGNS WHICH SHALL BE SUPPLIED BY I.D.O.T. THE CONTRACTOR SHALL PICK UP THE SIGNS AT THE TM BUILDING AT 9601 ST. CLAIR AVE. IN FAIRVIEW HEIGHTS.
 - THE CONTRACTOR SHALL REMOVE AND RETURN THE SIGNS THAT WERE SUPPLIED BY I.D.O.T. TO THE TM BUILDING IN FAIRVIEW HEIGHTS AFTER THE CONTRACT HAS BEEN COMPLETED.
 - THIS WORK SHALL BE PAID FOR AT THE CONTRACT UNIT PRICE, LUMP SUM, FOR DETOUR SIGNING AND NO OTHER COMPENSATION WILL BE ALLOWED, EXCEPT FOR PAYMENT OF SIGNS THAT WILL BE SUPPLIED BY THE CONTRACTOR.
 - THE SIGNS THAT ARE TO BE SUPPLIED BY THE CONTRACTOR SHALL BE PAID FOR AT THE CONTRACT UNIT PRICE, LUMP SUM, FOR TRAFFIC CONTROL AND PROTECTION, STANDARD BLR 21
 - SIGN SPACING WILL BE 400' OR TO FIT FIELD CONDITIONS.
 - THE HEIGHT TO THE BOTTOM OF THE LOWEST SIGN SHALL NOT BE LESS THAN 6'.

DATE	BY

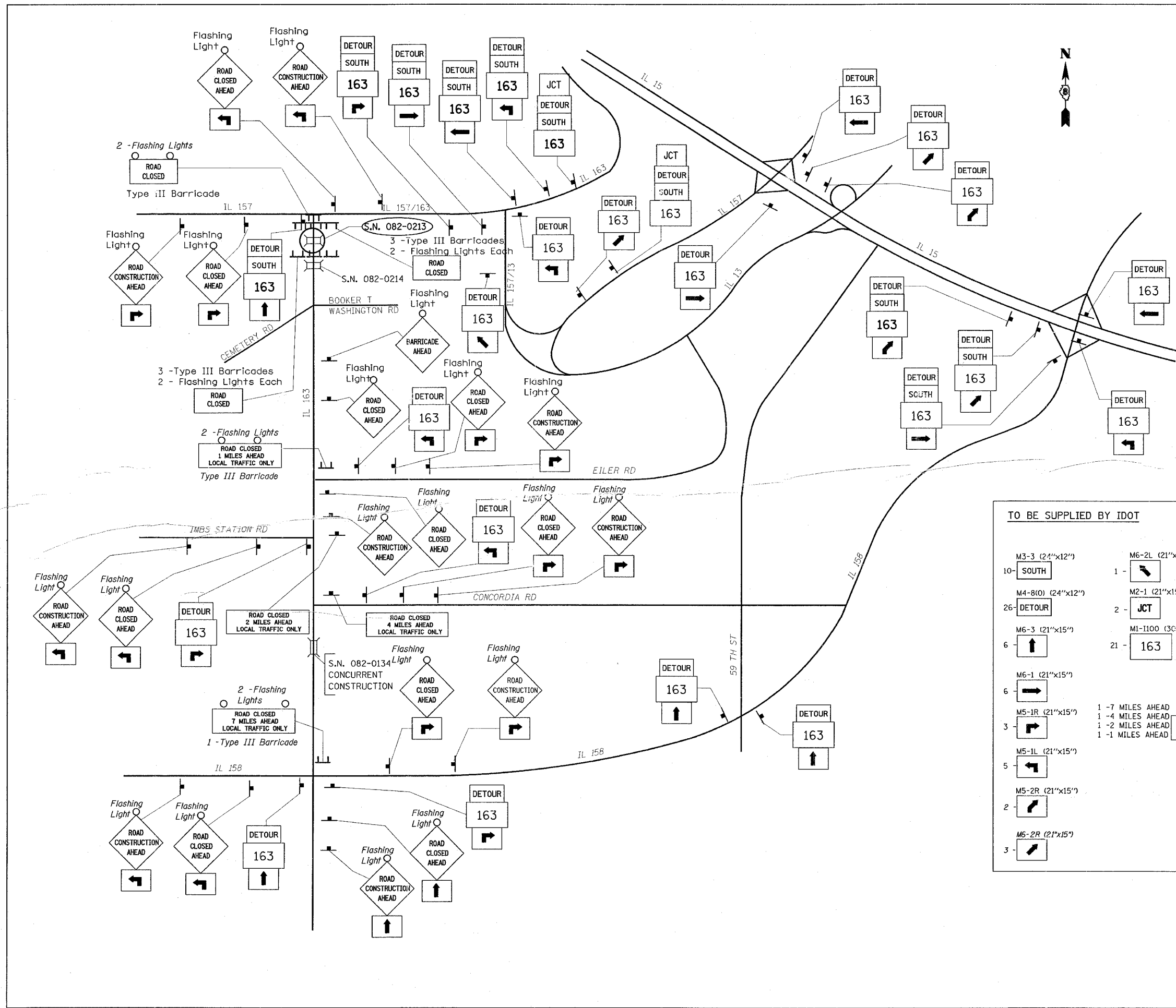

TO BE SUPPLIED BY IDOT		TO BE SUPPLIED BY CONTRACTOR	
M3-3 (21"x12")	M6-2L (21"x15")	R11-2 (48"x30")	M5-1R(O) (24"x24")
10 - SOUTH	1 - [Sign]	2 - ROAD CLOSED	6 - [Sign]
M4-8(O) (24"x12")	M2-1 (21"x15")	W20-1(O) (48"x48")	M5-1L(O) (24"x24")
26 - DETOUR	2 - JCT	6 - ROAD CONSTRUCTION AHEAD	4 - [Sign]
M6-3 (21"x15")	M1-1100 (30"x24")	ww20-3(O) (48"x48")	9 - TYPE III BARRICADES
6 - [Sign]	21 - 163	38 - FLASHING LIGHTS	
M6-1 (21"x15")		W21-1100(O) (48"x48")	1 - BARRICADE AHEAD
6 - [Sign]			
M5-1R (21"x15")	1 - 7 MILES AHEAD		
3 - [Sign]	1 - 4 MILES AHEAD		
M5-1L (21"x15")	1 - 2 MILES AHEAD		
5 - [Sign]	1 - 1 MILES AHEAD		
M5-2R (21"x15")	R11-3B (60"x30")		
2 - [Sign]	ROAD CLOSED		
M6-2R (21"x15")	MILES AHEAD		
3 - [Sign]	LOCAL TRAFFIC ONLY		

NOT TO SCALE

REVISIONS	
NAME	DATE

ILLINOIS DEPARTMENT OF TRANSPORTATION
DETOUR SIGNING
S.N. 082-0213
 FAP ROUTE 609 (IL ROUTE 163)
 SECTION 76-1BR-2
 ST. CLAIR COUNTY
 DRAWN BY:
 PLOT DATE: 9/13/2005