

F.A.U. RTE.	SECTION	COUNTY	TOTAL SHEETS	SHEET NO.
9128	28-RS-1	MADISON	14	8
STA.		TO STA.		
FED. ROAD DIST. NO.	ILLINOIS	FED. AID PROJECT		

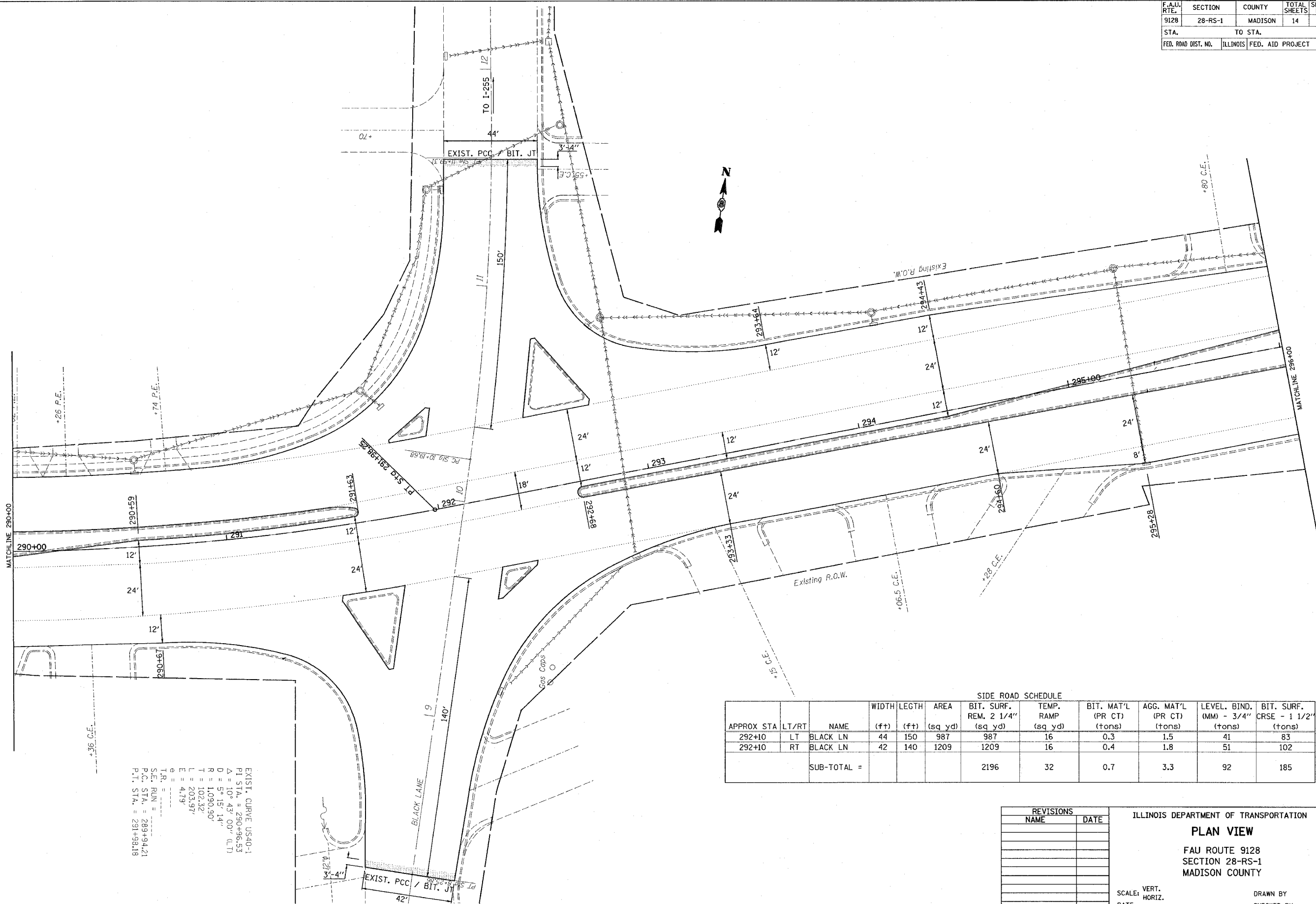

APPROX STA	LT/RT	NAME	WIDTH (ft)	LEGT (ft)	AREA (sq yd)	BIT. SURF. REM. 2 1/4" (sq yd)	TEMP. RAMP (sq yd)	BIT. MAT'L (PR CT) (tons)	AGG. MAT'L (PR CT) (tons)	LEVEL. BIND. (MM) - 3/4" (tons)	BIT. SURF. CRSE - 1 1/2" (tons)
292+10	LT	BLACK LN	44	150	987	987	16	0.3	1.5	41	83
292+10	RT	BLACK LN	42	140	1209	1209	16	0.4	1.8	51	102
SUB-TOTAL =						2196	32	0.7	3.3	92	185

EXIST. CURVE USA40-1
 P.I. STA. = 290+96.53
 $\Delta = 10^\circ 43' 00''$ (LT)
 $D = 5^\circ 15' 14''$
 $R = 1,090.90'$
 $T = 102.32'$
 $L = 203.97'$
 $E = 4.79'$
 T.R. =
 S.E. RUN =
 P.C. STA. = 289+94.21
 P.T. STA. = 291+98.18

REVISIONS	
NAME	DATE

ILLINOIS DEPARTMENT OF TRANSPORTATION
PLAN VIEW
 FAU ROUTE 9128
 SECTION 28-RS-1
 MADISON COUNTY
 SCALE: VERT. _____
 HORIZ. _____
 DATE _____
 DRAWN BY _____
 CHECKED BY _____

PLOT DATE = 7/7/2005
 PLOT SCALE = 20,000 / IN.
 REFERENCE = #REF#