

| F.A.U. RTE. | SECTION | COUNTY | TOTAL SHEETS | SHEET NO. |
|-------------|---------|---------|--------------|-----------|
| 9128 | 28-RS-1 | MADISON | 14 | 1 |

STATE OF ILLINOIS
DEPARTMENT OF TRANSPORTATION
DIVISION OF HIGHWAYS

**PROPOSED
HIGHWAY PLANS**

FAU ROUTE 9128 (US 40 /COLLINSVILLE ROAD)
SECTION 28-RS-1
PROJECT: HS-9128(004)
MADISON COUNTY
INTERSECTION RESURFACING
C-98-128-05

INDEX OF SHEETS

| PAGE | TITLE |
|-------|---|
| 1 | COVER SHEET |
| 2 | STANDARDS, GENERAL NOTES, COMMITMENTS & SCHEDULES |
| 3 | SUMMARY OF QUANTITIES |
| 4 - 6 | TYPICAL SECTIONS |
| 7 - 9 | PLAN SHEETS |
| 10-12 | PAVEMENT MARKING PLAN |
| | PAVEMENT MARKING DETAILS |
| 13-14 | ELECTRICAL PLAN |

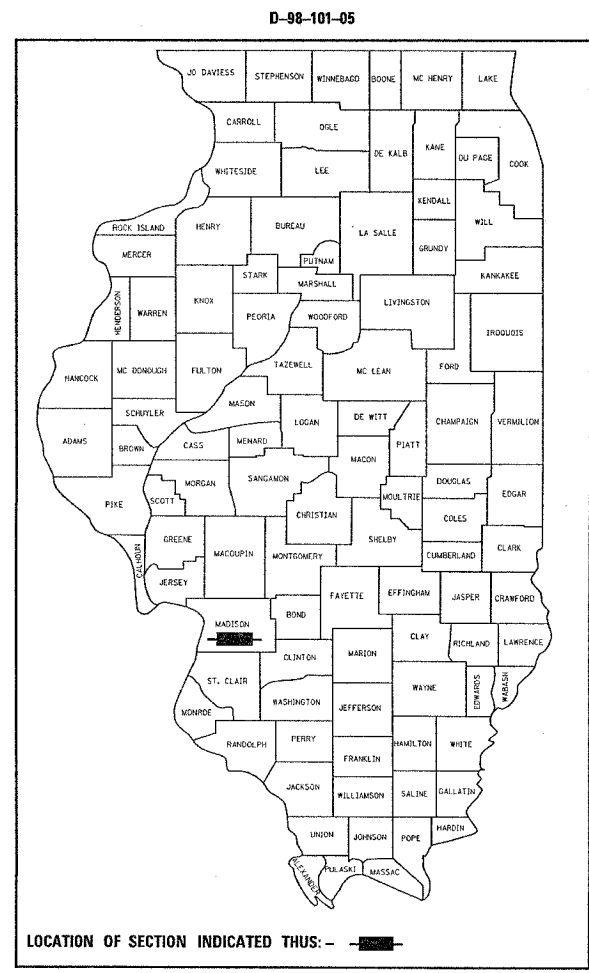

MICROFILMED _____
REEL NUMBER _____
AWARDED _____
RESIDENT ENGINEER _____
AS BUILT CHANGES WERE MADE
ON THE FOLLOWING SHEETS _____

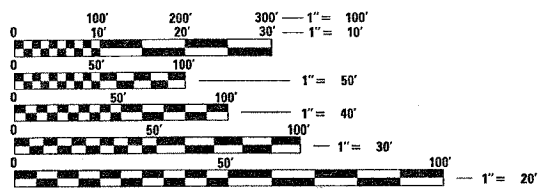

FULL SIZE PLANS HAVE BEEN PREPARED USING STANDARD ENGINEERING SCALES. REDUCED SIZED PLANS WILL NOT CONFORM TO STANDARD SCALES. IN MAKING MEASUREMENTS ON REDUCED PLANS, THE ABOVE SCALES MAY BE USED.

J.U.L.I.E.
JOINT UTILITY LOCATION INFORMATION FOR EXCAVATION
1-800-892-0123

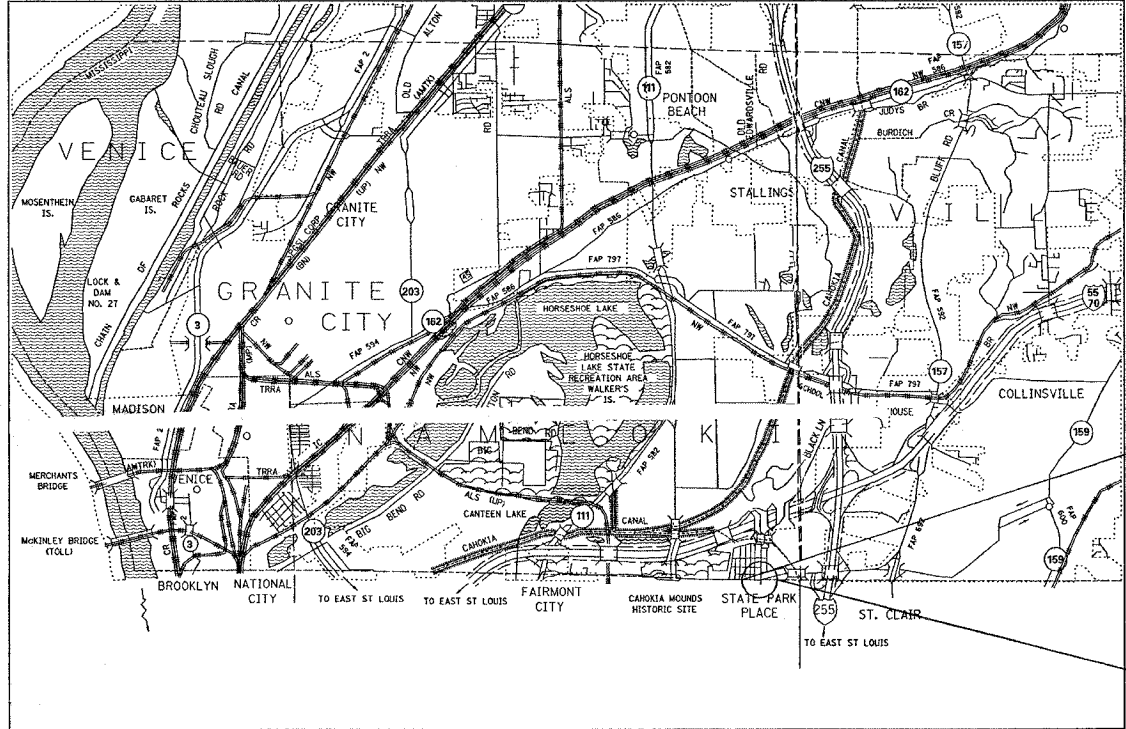

BEGIN STA 286+85
LAT. 38.65840
LONG. -90.04737

END STA 299+35
LAT. 38.65867
LONG. -90.04659

ADT INFO.

| US 40 EAST OF BLACK LN | US 40 WEST OF BLACK LN | BLACK LANE NORTH OF US 40 | BLACK LANE SOUTH OF US 40 |
|------------------------|------------------------|---------------------------|---------------------------|
| 2005 = 8400 | 2005 = 7300 | 2005 = 3400 | 2005 = 4700 |
| 2025 = 9300 | 2025 = 8100 | 2025 = 3800 | 2025 = 5200 |
| SU = 4.5% | SU = 5.1% | SU = 4.5% | SU = 4.4% |
| MU = 1.6% | MU = 1.5% | MU = 1.0% | MU = 1.0% |

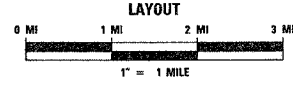

GROSS LENGTH 1,580 FT
NET LENGTH 1,580 FT

PROJECT ENG NEER: WENDA SOUTHERLAND (618)-346-3159
SQUAD LEAD: BRIAN COURTWRIGHT (618)-346-3192

STATE OF ILLINOIS
DEPARTMENT OF TRANSPORTATION
DIVISION OF HIGHWAYS

SUBMITTED: *Mike* 20 05
Victor
DEPUTY DIRECTOR OF HIGHWAYS
REGION FIVE ENGINEER

August 19, 20 05
Mike
ENGINEER OF DESIGN AND ENVIRONMENT

August 19, 20 05
Victor
DIRECTOR, DIVISION OF HIGHWAYS

**PRINTED BY THE AUTHORITY
OF THE STATE OF ILLINOIS**

| F.A. RTE. | SECTION | COUNTY | TOTAL SHEETS | SHEET NO. |
|---------------------|---------|----------|------------------|-----------|
| 9128 | 28-RS-1 | MADISON | 14 | 3 |
| STA. | | TO STA. | | |
| FED. ROAD DIST. NO. | | ILLINOIS | FED. AID PROJECT | |

SUMMARY OF QUANTITIES

90% FED / 10% STATE

| SUMMARY OF QUANTITIES | | | CONSTRUCTION TYPE CODE | | |
|-----------------------|---|-------------------|------------------------|---------------|--|
| CODE NO | ITEM | UNIT | TOTAL QUANTITIES | URBAN I000-1A | |
| 40600200 | BITUMINOUS MATERIALS (PRIME COAT) | TON | 3.4 | 3.4 | |
| 40600300 | AGGREGATE (PRIME COAT) | TON | 16.4 | 16.4 | |
| 40600990 | TEMPORARY RAMP | SQ YD | 115 | 115 | |
| 44200202 | PAVEMENT PATCHING, TYPE II, 17 INCH | SQ YD | 46 | 46 | |
| 44200204 | PAVEMENT PATCHING, TYPE III, 17 INCH | SQ YD | 50 | 50 | |
| 67100100 | MOBILIZATION | L SUM | 1 | 1 | |
| 70102630 | TRAFFIC CONTROL AND PROTECTION, STANDARD 701601 | L SUM | 1 | 1 | |
| 70102635 | TRAFFIC CONTROL AND PROTECTION, STANDARD 701701 | L SUM | 1 | 1 | |
| 70103815 | TRAFFIC CONTROL SURVEILLANCE | GAL DA | 7 | 7 | |
| 70300100 | SHORT-TERM PAVEMENT MARKING | FOOT | 647 | 647 | |
| 70300210 | TEMPORARY PAVEMENT MARKING - LETTERS AND SYMBOLS | SQ FT | 240 | 240 | |
| 70300220 | TEMPORARY PAVEMENT MARKING - LINE 4" | FOOT | 6091 | 6091 | |
| 70300250 | TEMPORARY PAVEMENT MARKING - LINE 8" | FOOT | 440 | 440 | |
| 70300260 | TEMPORARY PAVEMENT MARKING - LINE 12" | FOOT | 97 | 97 | |
| 70300280 | TEMPORARY PAVEMENT MARKING - LINE 24" | FOOT | 192 | 192 | |
| 70301000 | WORK ZONE PAVEMENT MARKING REMOVAL | SQ FT | 1592 | 1592 | |
| * 78001100 | PAINT THERMOPLASTIC PAVEMENT MARKING - LETTERS AND SYMBOLS | SQ FT | 240 | 240 | |
| * 78001110 | PAINT THERMOPLASTIC PAVEMENT MARKING - LINE 4" | FOOT | 6091 | 6091 | |
| * 78001140 | PAINT THERMOPLASTIC PAVEMENT MARKING - LINE 8" | FOOT | 440 | 440 | |
| * 78001150 | PAINT THERMOPLASTIC PAVEMENT MARKING - LINE 12" | FOOT | 97 | 97 | |
| * 78001160 | PAINT THERMOPLASTIC PAVEMENT MARKING - LINE 24" | FOOT | 192 | 192 | |
| * 78100100 | RAISED REFLECTIVE PAVEMENT MARKER | EACH | 123 | 123 | |
| 78300200 | RAISED REFLECTIVE PAVEMENT MARKER REMOVAL | EACH | 58 | 58 | |
| * 88600100 | DETECTOR LOOP, TYPE I | FOOT | 2345 | 2345 | |
| X4066526 | POLYMERIZED BITUMINOUS CONCRETE SURFACE COURSE, SUPERPAVE, MIX "D", N70 | TON | 915 | 915 | |
| X4066770 | LEVELING BINDER (MACHINE METHOD), SUPERPAVE N70 | TON | 458 | 458 | |
| X4409410 | BITUMINOUS SURFACE REMOVAL 2 1/4" | SQ YD | 10893 | 10893 | |

| SUMMARY OF QUANTITIES | | | CONSTRUCTION TYPE CODE | | |
|-----------------------|------|------|------------------------|--|--|
| CODE NO | ITEM | UNIT | TOTAL QUANTITIES | | |
| | | | | | |

Rev.

* SPECIALTY ITEMS

PLOT DATE = 6/28/2005
 FILE NAME = c:\pavements\ed01085\plan\p101085a.dwg
 PLOT SCALE = 5/8" = 1' IN.
 REFERENCE = REF#

| | | | | |
|---------------------|----------|------------------|--------------|-----------|
| FAU RTE. | SECTION | COUNTY | TOTAL SHEETS | SHEET NO. |
| 9128 | 28-RS-1 | MADISON | 14 | 4 |
| STA. | | TO STA. | | |
| FED. ROAD DIST. NO. | ILLINOIS | FED. AID PROJECT | | |

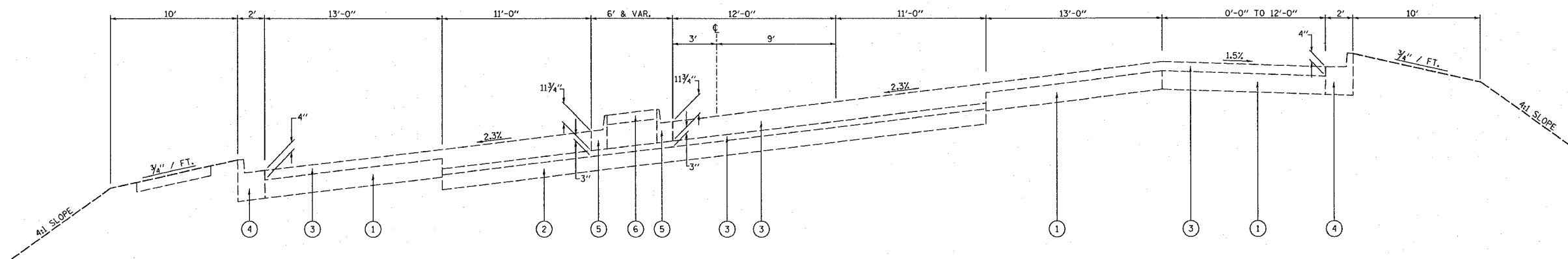

EXISTING SUPERELEVATION TYPICAL SECTION
289+94.21 TO 291+98.18

LEFT TURN LANE
289+48 TO 291+63 E.B.
292+60 TO 296+24 W.B.

RIGHT TURN LANE
288+48 TO 290+67 E.B.
293+64 TO 297+42 W.B.

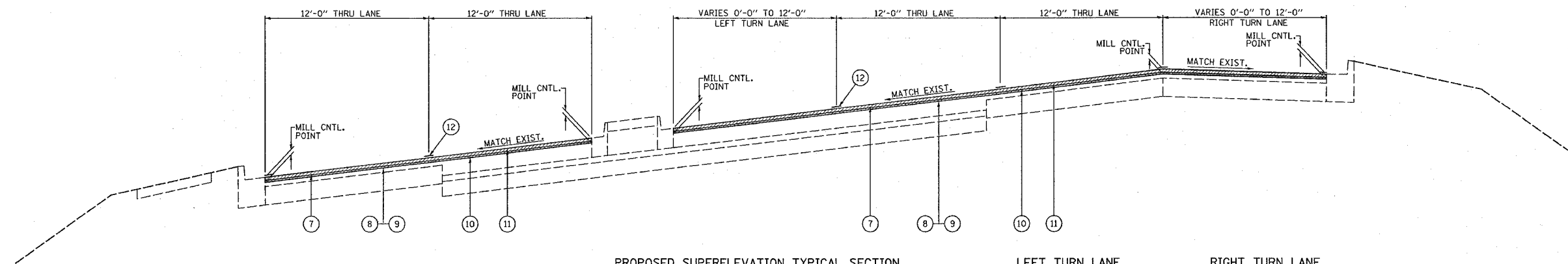

PROPOSED SUPERELEVATION TYPICAL SECTION
289+94.21 TO 291+98.18

LEFT TURN LANE
289+48 TO 291+63 E.B.
292+60 TO 296+24 W.B.

RIGHT TURN LANE
288+48 TO 290+67 E.B.
293+64 TO 297+42 W.B.

LEGEND

- ① EXISTING P.C.C. PAVEMENT - 8"
- ② EXISTING P.C.C. PAVEMENT - 9"
- ③ EXISTING BITUMINOUS OVERLAY - VARIES 3" TO 11 3/4"
- ④ EXISTING CONCRETE COMBINATION C&G T-B 6.24
- ⑤ EXISTING CONCRETE COMBINATION C&G T-M 6.06
- ⑥ EXISTING P.C.C. MEDIAN SURFACE - 4"
- ⑦ PROPOSED BITUMINOUS SURFACE REMOVAL - 2 1/4"
- ⑧ PROPOSED BITUMINOUS MATERIAL (PRIME COAT)
- ⑨ PROPOSED AGGREGATE (PRIME COAT)
- ⑩ PROPOSED LEVELING BINDER (MIN.) - 3/4"
- ⑪ PROPOSED SURFACE COURSE - 1 1/2"
- ⑫ PROPOSED THERMOPLASTIC PAVEMENT MARKING

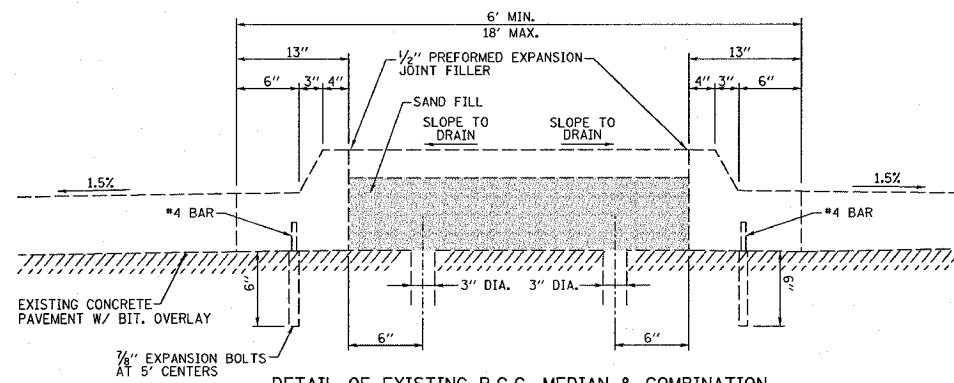

DETAIL OF EXISTING P.C.C. MEDIAN & COMBINATION
CONCRETE CURB AND GUTTER, TYPE M-6.06
(MODIFIED)

| REVISIONS | | ILLINOIS DEPARTMENT OF TRANSPORTATION |
|--------------|------|---------------------------------------|
| NAME | DATE | |
| | | TYPICAL SECTIONS |
| | | |
| | | |
| | | |
| | | |
| | | |
| SCALE: VERT. | DATE | DRAWN BY |
| HORIZ. | | |

PLOT DATE = 6/28/2005
FILE NAME = c:\pwork\mcs\110102\110102.dgn
PLOT SCALE = 50,000.00 / IN.
REFERENCE = #REF#

| FAU RTE. | SECTION | COUNTY | TOTAL SHEETS | SHEET NO. |
|---------------------|----------|------------------|--------------|-----------|
| 9128 | 28-RS-1 | MADISON | 14 | 5 |
| STA. | | TO STA. | | |
| FED. ROAD DIST. NO. | ILLINOIS | FED. AID PROJECT | | |

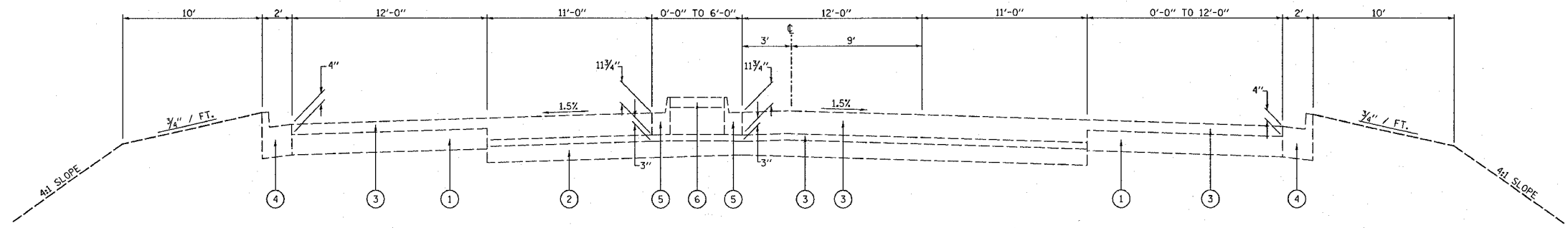

EXISTING TANGENT TYPICAL SECTION
 297+42 TO 299+35 W.B. 297+65 TO 299+35 E.B.

RIGHT TURN LANE
 288+48 TO 290+67 E.B.
 293+64 TO 297+42 W.B.

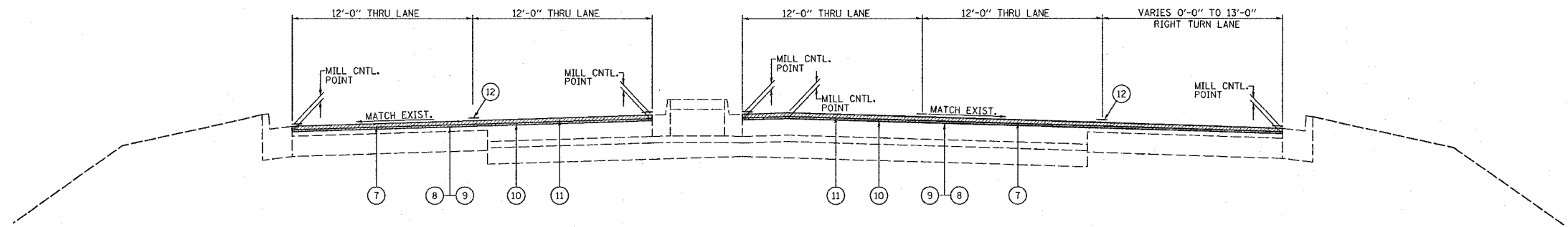

PROPOSED TANGENT TYPICAL SECTION
 297+42 TO 299+35 W.B. 297+65 TO 299+35 E.B.

RIGHT TURN LANE
 288+48 TO 290+67 E.B.
 293+64 TO 297+42 W.B.

LEGEND

- ① EXISTING P.C.C. PAVEMENT - 8"
- ② EXISTING P.C.C. PAVEMENT - 9"
- ③ EXISTING BITUMINOUS OVERLAY - VARIES 3" TO 11 3/4"
- ④ EXISTING CONCRETE COMBINATION C&G T-B 6.24
- ⑤ EXISTING CONCRETE COMBINATION C&G T-M 6.06
- ⑥ EXISTING P.C.C. MEDIAN SURFACE - 4"
- ⑦ PROPOSED BITUMINOUS SURFACE REMOVAL - 2 1/4"
- ⑧ PROPOSED BITUMINOUS MATERIAL (PRIME COAT)
- ⑨ PROPOSED AGGREGATE (PRIME COAT)
- ⑩ PROPOSED LEVELING BINDER (MIN.) - 3/4"
- ⑪ PROPOSED SURFACE COURSE - 1 1/2"
- ⑫ PROPOSED THERMOPLASTIC PAVEMENT MARKING

| REVISIONS | |
|-----------|------|
| NAME | DATE |
| | |
| | |
| | |
| | |
| | |
| | |
| | |
| | |
| | |
| | |

ILLINOIS DEPARTMENT OF TRANSPORTATION
TYPICAL SECTIONS
 FAU ROUTE 9128
 SECTION 28-RS-1
 MADISON COUNTY

SCALE: VERT.
 HORIZ.
 DATE

DRAWN BY
 CHECKED BY

PLOT DATE = 6/30/2005
 PLOT SCALE = 50.0000' = 1" IN.
 REFERENCE = #REF#

| FAU RTE. | SECTION | COUNTY | TOTAL SHEETS | SHEET NO. |
|---------------------|---------|---------------------------|--------------|-----------|
| 9128 | 28-RS-1 | MADISON | 14 | 6 |
| STA. | | TO STA. | | |
| FED. ROAD DIST. NO. | | ILLINOIS FED. AID PROJECT | | |

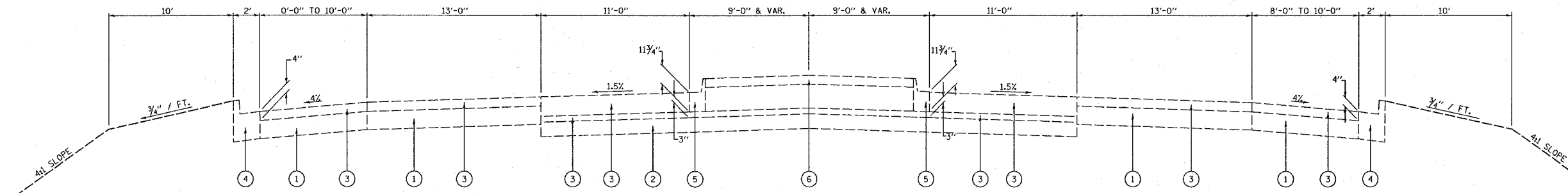

EXISTING TANGENT TYPICAL SECTION W/ BUS LOADING LANE
 286+85 TO 288+36 W.B. 286+85 TO 288+48 E.B.
 294+69 TO 296+23 E.B.

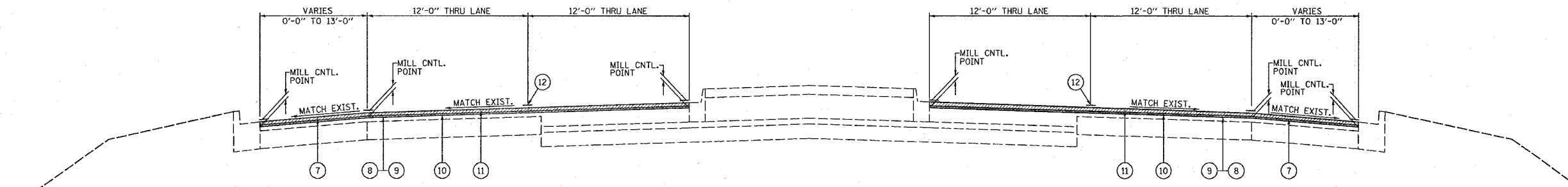

PROPOSED TANGENT TYPICAL SECTION W/ BUS LOADING LANE
 286+85 TO 288+36 W.B. 286+85 TO 288+48 E.B.
 294+69 TO 296+23 E.B.

LEGEND

- ① EXISTING P.C.C. PAVEMENT - 8"
- ② EXISTING P.C.C. PAVEMENT - 9"
- ③ EXISTING BITUMINOUS OVERLAY - VARIES 3" TO 11 3/4"
- ④ EXISTING CONCRETE COMBINATION C&G T-B 6.24
- ⑤ EXISTING CONCRETE COMBINATION C&G T-M 6.06
- ⑥ EXISTING P.C.C. MEDIAN SURFACE - 4"
- ⑦ PROPOSED BITUMINOUS SURFACE REMOVAL - 2 1/4"
- ⑧ PROPOSED BITUMINOUS MATERIAL (PRIME COAT)
- ⑨ PROPOSED AGGREGATE (PRIME COAT)
- ⑩ PROPOSED LEVELING BINDER (MIN.) - 3/4"
- ⑪ PROPOSED SURFACE COURSE - 1 1/2"
- ⑫ PROPOSED THERMOPLASTIC PAVEMENT MARKING

PLOT DATE = 6/28/2005
 FILE NAME = c:\pcc\pcc\mch\mch\1005\plan\p1\c10105.dgn
 PLOT SCALE = 5/8" = 1' / IN.
 REFERENCE = *REF*

| REVISIONS | |
|-----------|------|
| NAME | DATE |
| | |
| | |
| | |
| | |
| | |
| | |
| | |
| | |
| | |
| | |

ILLINOIS DEPARTMENT OF TRANSPORTATION
TYPICAL SECTIONS
 FAU ROUTE 9128
 SECTION 28-RS-1
 MADISON COUNTY

SCALE: VERT. DRAWN BY
 HORIZ. CHECKED BY
 DATE

| F.A.U. RTE. | SECTION | COUNTY | TOTAL SHEETS | SHEET NO. |
|---------------------|----------|------------------|--------------|-----------|
| 9128 | 28-RS-1 | MADISON | 14 | 7 |
| STA. | | TO STA. | | |
| FED. ROAD DIST. NO. | ILLINOIS | FED. AID PROJECT | | |

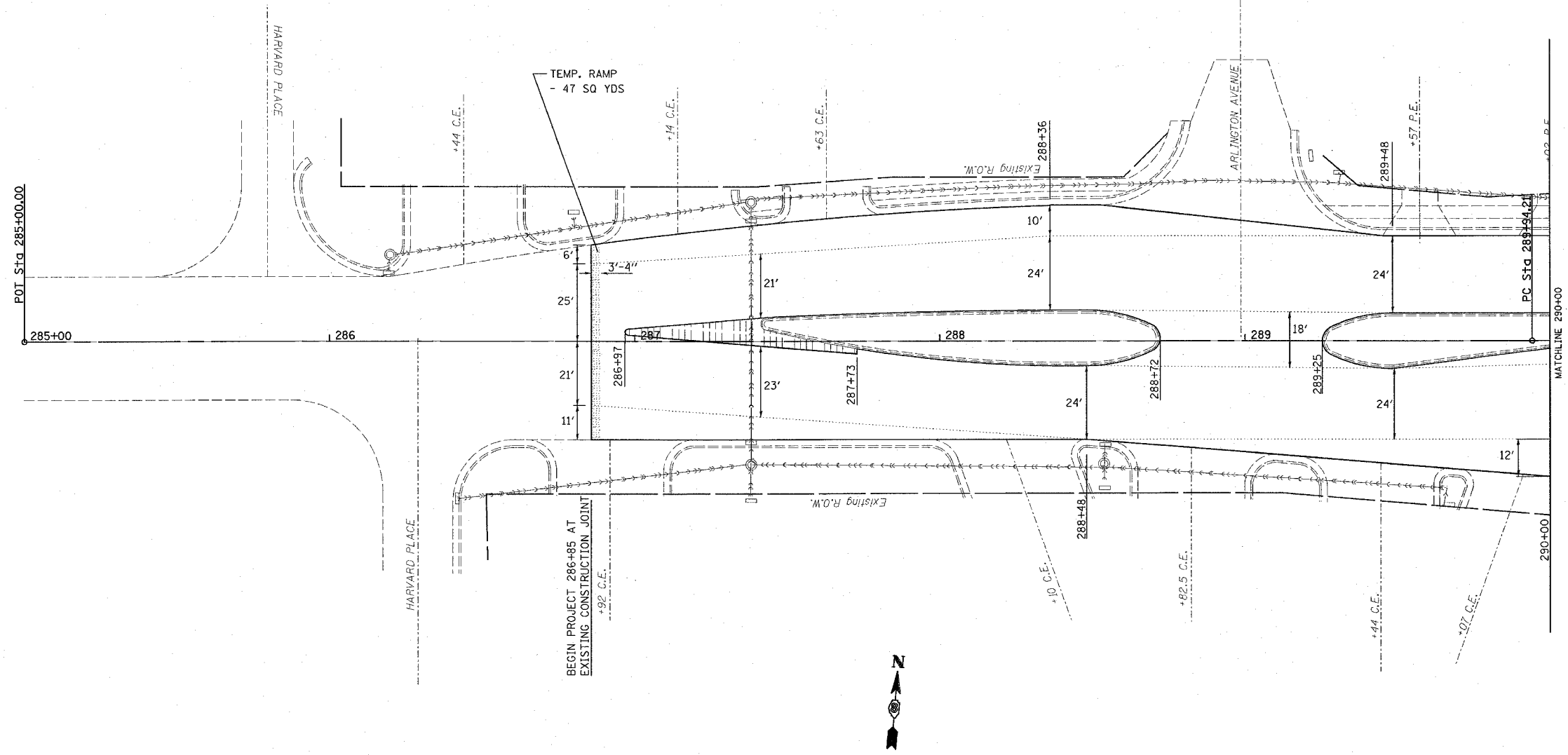

PLOT DATE = 6/30/2005
 FILE NAME = c:\pro\pccs\ed0185\plan\p10105.dgn
 PLOT SCALE = 20.0000 / IN.
 REFERENCE = #RCP#

| REVISIONS | |
|-----------|------|
| NAME | DATE |
| | |
| | |
| | |
| | |
| | |
| | |
| | |
| | |
| | |
| | |

ILLINOIS DEPARTMENT OF TRANSPORTATION

PLAN VIEW

FAU ROUTE 9128
 SECTION 28-RS-1
 MADISON COUNTY

SCALE: VERT. / HORIZ.
 DATE

DRAWN BY
 CHECKED BY

| F.A.U. RTE. | SECTION | COUNTY | TOTAL SHEETS | SHEET NO. |
|---------------------|----------|------------------|--------------|-----------|
| 9128 | 28-RS-1 | MADISON | 14 | 8 |
| STA. | | TO STA. | | |
| FED. ROAD DIST. NO. | ILLINOIS | FED. AID PROJECT | | |

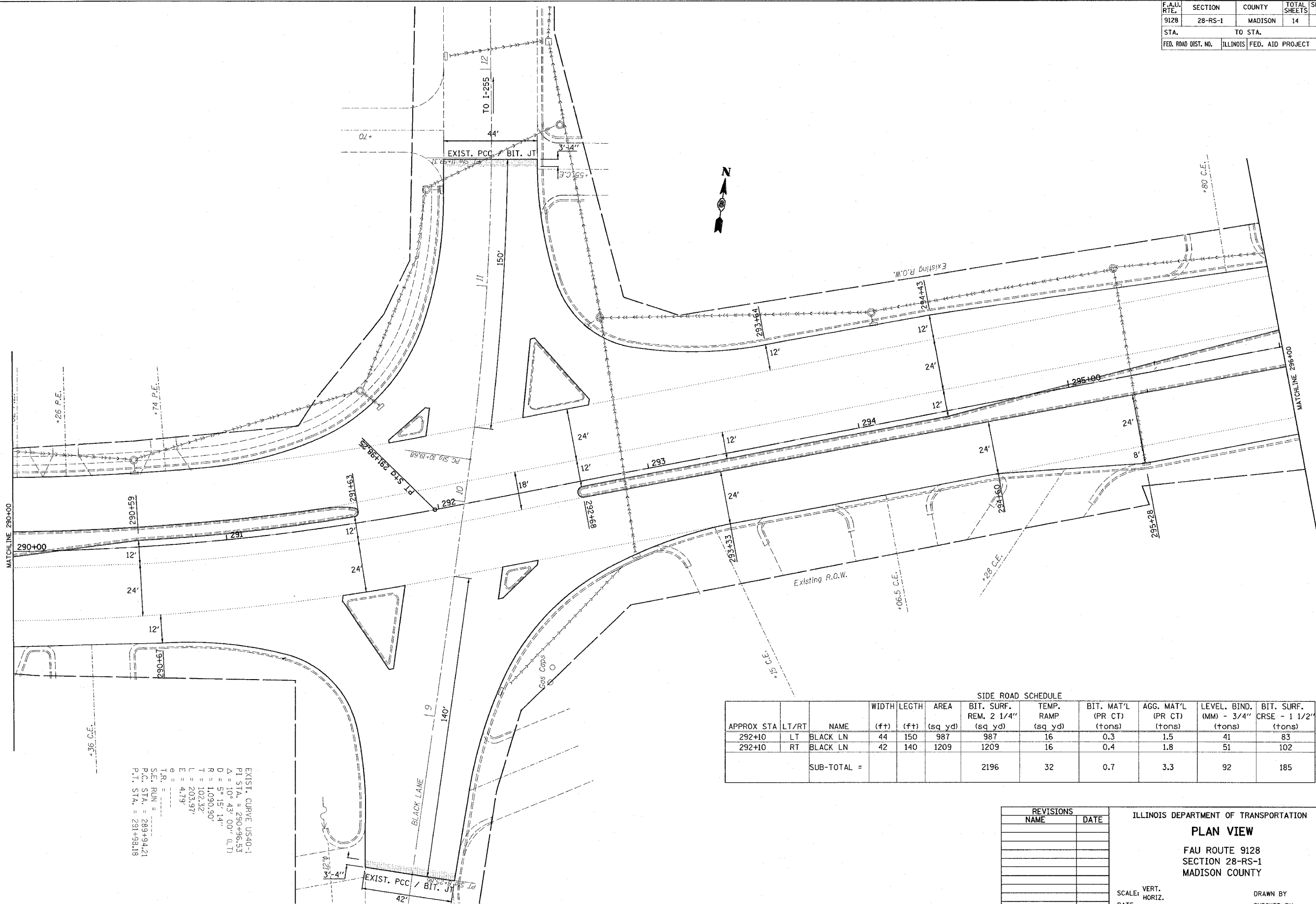

| APPROX STA | LT/RT | NAME | WIDTH (ft) | LEGT (ft) | AREA (sq yd) | BIT. SURF. REM. 2 1/4" (sq yd) | TEMP. RAMP (sq yd) | BIT. MAT'L (PR CT) (tons) | AGG. MAT'L (PR CT) (tons) | LEVEL. BIND. (MM) - 3/4" (tons) | BIT. SURF. CRSE - 1 1/2" (tons) |
|-------------|-------|----------|------------|-----------|--------------|--------------------------------|--------------------|---------------------------|---------------------------|---------------------------------|---------------------------------|
| 292+10 | LT | BLACK LN | 44 | 150 | 987 | 987 | 16 | 0.3 | 1.5 | 41 | 83 |
| 292+10 | RT | BLACK LN | 42 | 140 | 1209 | 1209 | 16 | 0.4 | 1.8 | 51 | 102 |
| SUB-TOTAL = | | | | | | 2196 | 32 | 0.7 | 3.3 | 92 | 185 |

EXIST. CURVE USA40-1
 P.I. STA. = 290+96.53
 Δ = 10° 43' 00" (LT)
 D = 5° 15' 14"
 R = 1,090.90'
 T = 102.32'
 L = 203.97'
 E = 4.79'
 P.C. STA. = 289+94.21
 P.T. STA. = 291+98.18

PLOT DATE = 7/7/2005
 PLOT SCALE = 20,000 / IN.
 REFERENCE = #REF#

| REVISIONS | |
|-----------|------|
| NAME | DATE |
| | |
| | |
| | |
| | |
| | |
| | |
| | |
| | |
| | |
| | |

ILLINOIS DEPARTMENT OF TRANSPORTATION
PLAN VIEW
 FAU ROUTE 9128
 SECTION 28-RS-1
 MADISON COUNTY
 SCALE: VERT. _____
 HORIZ. _____
 DATE _____
 DRAWN BY _____
 CHECKED BY _____

| F.A.U. RTE. | SECTION | COUNTY | TOTAL SHEETS | SHEET NO. |
|---------------------|----------|------------------|--------------|-----------|
| 9128 | 28-RS-1 | MADISON | 14 | 10 |
| STA. | | TO STA. | | |
| FED. ROAD DIST. NO. | ILLINOIS | FED. AID PROJECT | | |

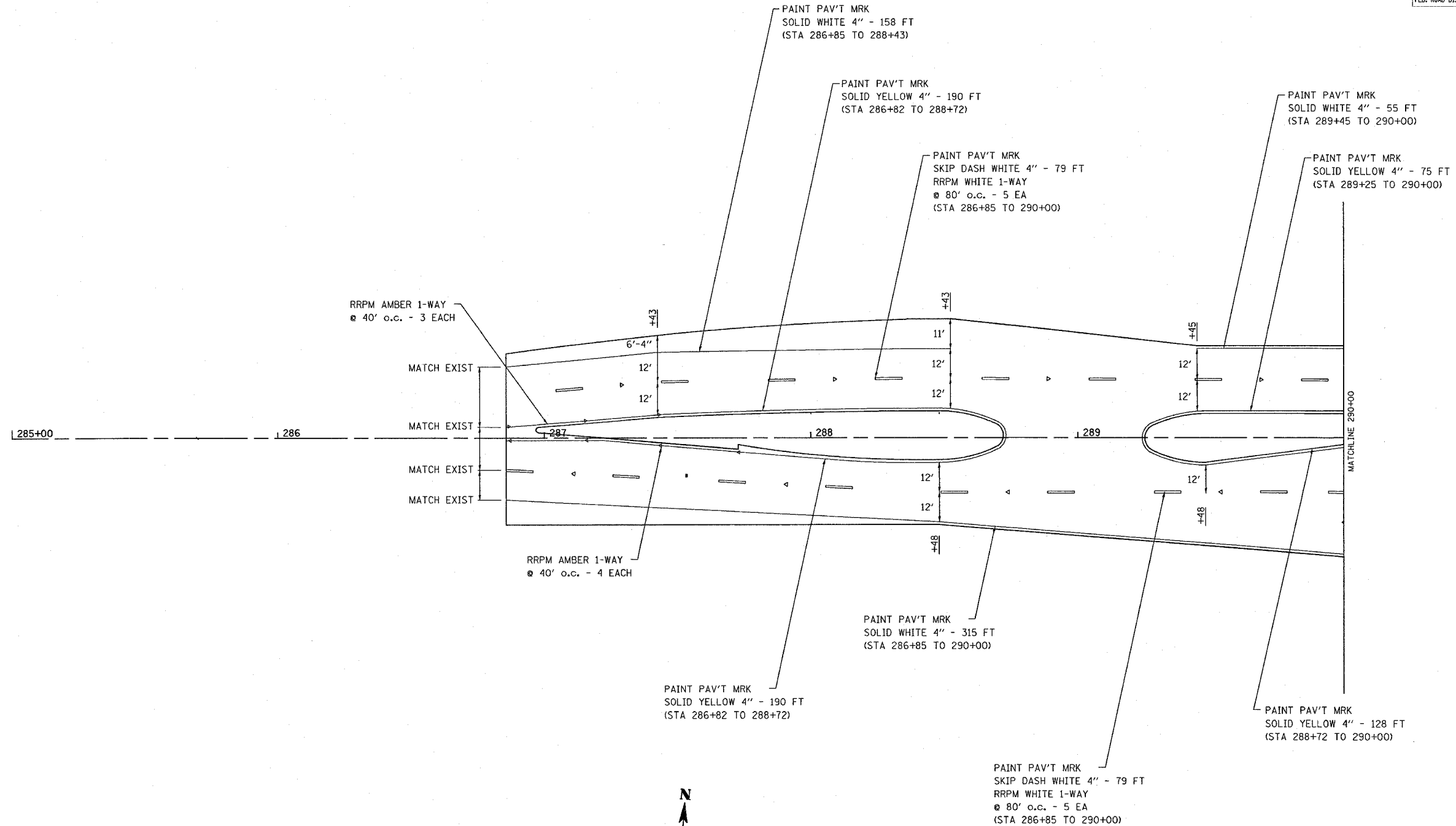

PLOT DATE = 7/29/2005
 PLOT SCALE = 24.00000000
 PLOT REFERENCE = #REF#

| REVISIONS | |
|-----------|------|
| NAME | DATE |
| | |
| | |
| | |
| | |
| | |
| | |
| | |
| | |
| | |
| | |

ILLINOIS DEPARTMENT OF TRANSPORTATION
PAVEMENT MARKING PLANS
 FAU ROUTE 9128
 SECTION 28-RS-1
 MADISON COUNTY

SCALE: VERT. _____
 HORIZ. _____
 DATE _____

DRAWN BY _____
 CHECKED BY _____

| F.A.U. RTE. | SECTION | COUNTY | TOTAL SHEETS | SHEET NO. |
|---------------------|---------|---------------------------|--------------|-----------|
| 9128 | 28-RS-1 | MADISON | 14 | 11 |
| STA. | | TO STA. | | |
| FED. ROAD DIST. NO. | | ILLINOIS FED. AID PROJECT | | |

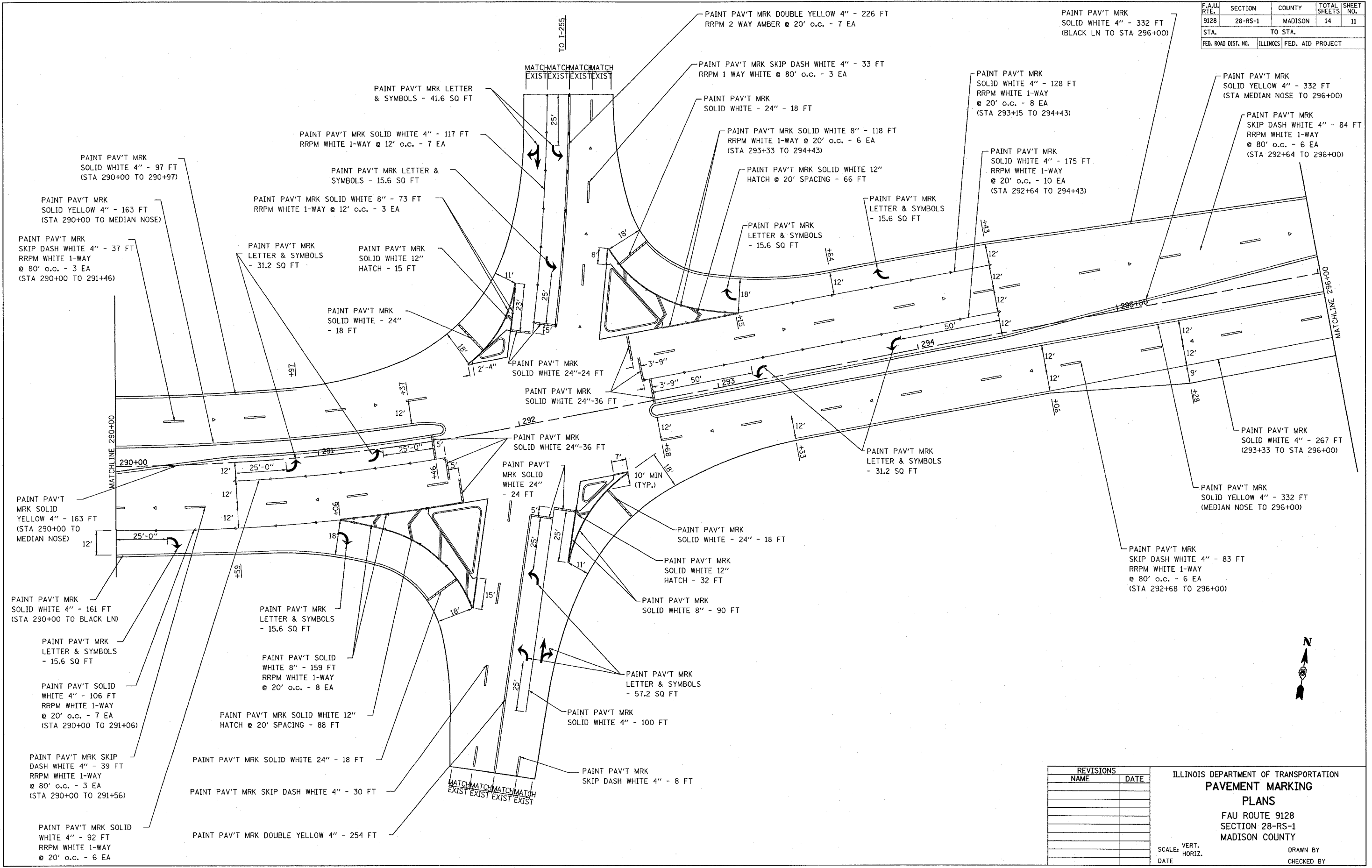

PLOT DATE = 7/29/2008
 FILE NAME = c:\p1\m108\plan\p108b5.dgn
 PLOT SCALE = 20,000/1" IN.
 REFERENCE = REF#

| REVISIONS | |
|-----------|------|
| NAME | DATE |
| | |
| | |
| | |
| | |
| | |
| | |
| | |
| | |
| | |
| | |

ILLINOIS DEPARTMENT OF TRANSPORTATION
PAVEMENT MARKING PLANS
 FAU ROUTE 9128
 SECTION 28-RS-1
 MADISON COUNTY

SCALE: VERT. _____
 HORIZ. _____

DRAWN BY _____
 CHECKED BY _____



| F.A.U. RTE. | SECTION | COUNTY | TOTAL SHEETS | SHEET NO. |
|---------------------|---------|---------------------------|--------------|-----------|
| 9128 | 28-RS-1 | MADISON | 14 | 12 |
| STA. | | TO STA. | | |
| FED. ROAD DIST. NO. | | ILLINOIS FED. AID PROJECT | | |

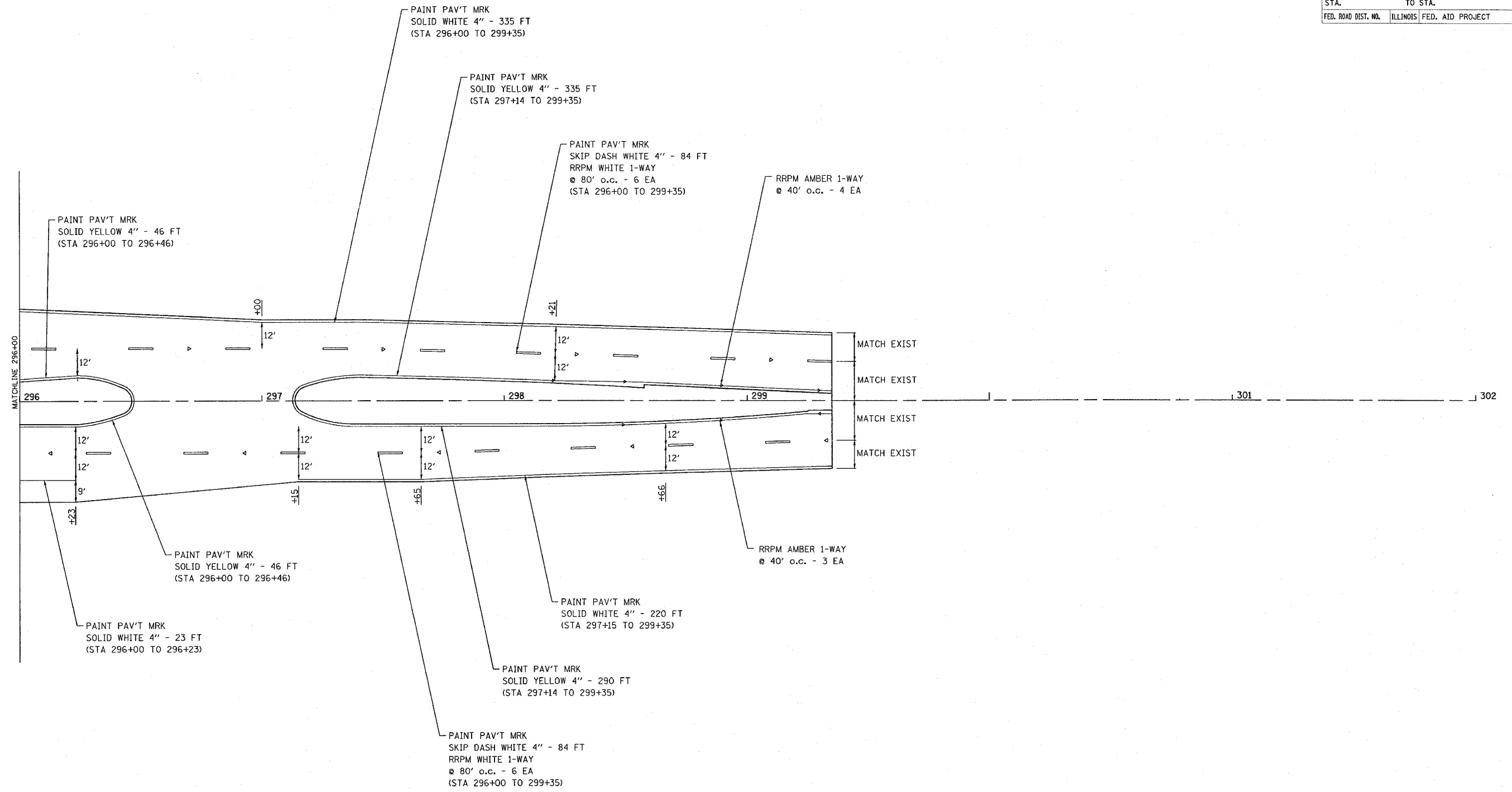

PLOT DATE = 7/24/2005
 FILE NAME = c:\projects\76960\plan\p1n12.dgn
 PLOT SCALE = 28.0000 / 1"
 REFERENCE = #REF#

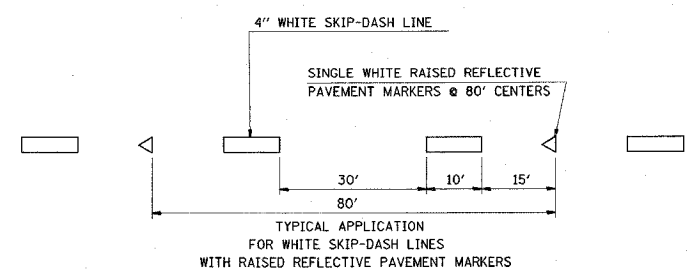
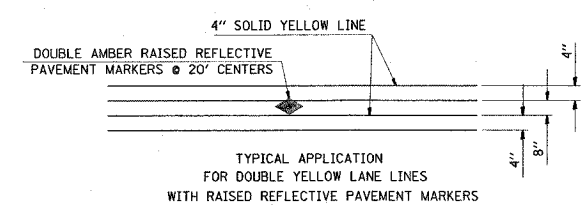

| REVISIONS | |
|-----------|------|
| NAME | DATE |
| | |
| | |
| | |
| | |
| | |
| | |
| | |
| | |
| | |
| | |

ILLINOIS DEPARTMENT OF TRANSPORTATION
PAVEMENT MARKING PLANS
 FAU ROUTE 9128
 SECTION 28-RS-1
 MADISON COUNTY

SCALE: VERT. _____
 HORIZ. _____
 DATE _____

DRAWN BY _____
 CHECKED BY _____

| F.A.U. RTE. | SECTION | COUNTY | TOTAL SHEETS | SHEET NO. |
|---------------------|----------|------------------|--------------|-----------|
| 9128 | 28-RS-1 | MADISON | 14 | 13 |
| STA. TO STA. | | | | |
| FED. ROAD DIST. NO. | ILLINOIS | FED. AID PROJECT | | |

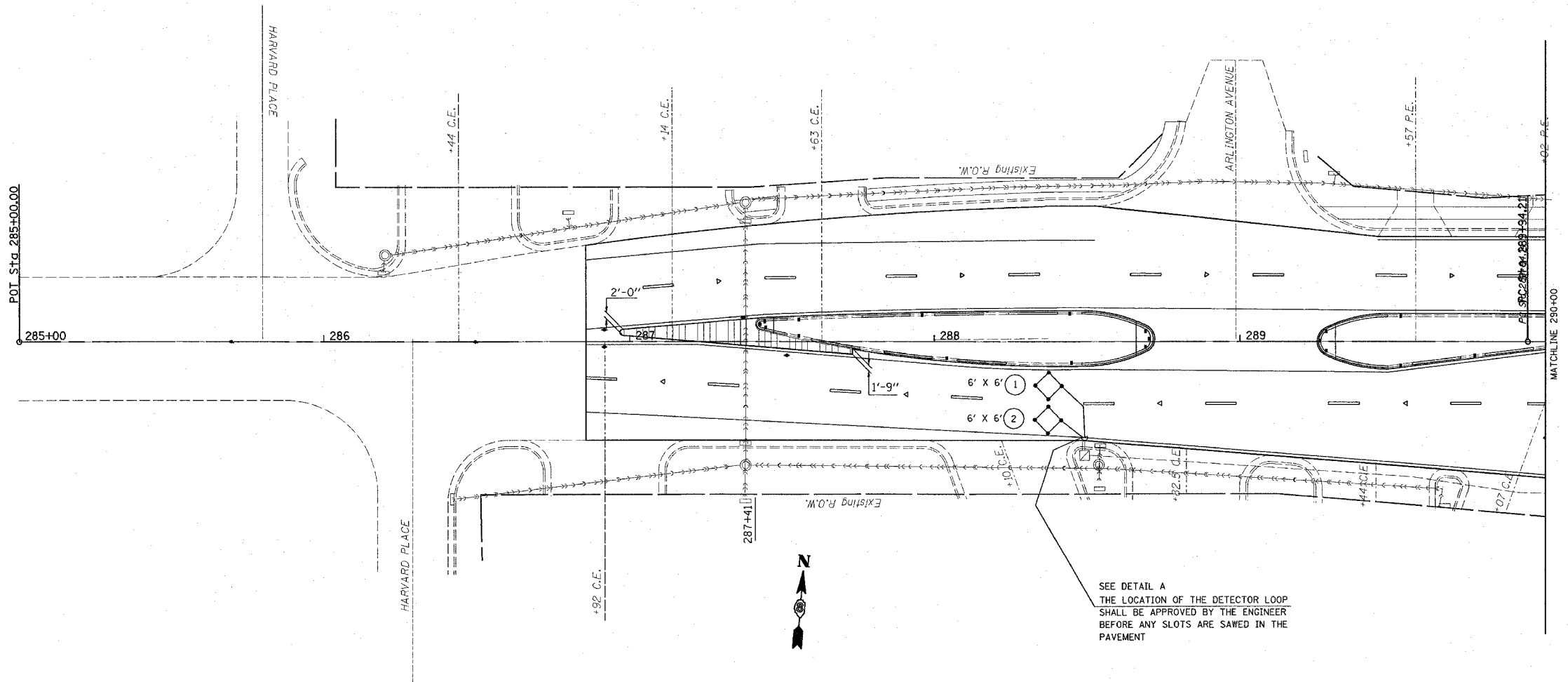

SEE DETAIL A
 THE LOCATION OF THE DETECTOR LOOP
 SHALL BE APPROVED BY THE ENGINEER
 BEFORE ANY SLOTS ARE SAWED IN THE
 PAVEMENT

PLOT DATE = 6/30/2005
 FILE NAME = \\s11010185\plan\11010185.dgn
 PLOT SCALE = 20,000% / IN.
 REFERENCE = #REF#

| REVISIONS | |
|-----------|------|
| NAME | DATE |
| | |
| | |
| | |
| | |
| | |
| | |
| | |
| | |
| | |
| | |

ILLINOIS DEPARTMENT OF TRANSPORTATION
DETECTOR LOOP REPLACEMENT
PLAN SHT.1 OF 2
 FAU ROUTE 9128
 SECTION 28-RS-1
 MADISON COUNTY

SCALE: VERT. _____
 HORIZ. _____

DATE _____ DRAWN BY _____
 CHECKED BY _____

| F.A.U. RTE. | SECTION | COUNTY | TOTAL SHEETS | SHEET NO. |
|---------------------|----------|------------------|--------------|-----------|
| 9128 | 28-RS-1 | MADISON | 14 | 14 |
| STA. | | TO STA. | | |
| FED. ROAD DIST. NO. | ILLINOIS | FED. AID PROJECT | | |

DETECTOR LOOP REQUIREMENTS AND CALCULATIONS FOR COLLINSVILLE ROAD AND BLACK LANE

| LOOP | PHASE (Ø) | LOOP SIZE(FT) | REQUIRED # OF TURNS | CALCULATED INDUCTANCE MICROHENRIES (µH) | CALCULATED RESISTANCE OHMS (Ω) |
|------------------|-----------|---------------|---------------------|---|--------------------------------|
| 1. EB CCO A | 6 | 6' X 6' | 6 | 360.0 | 2.8 |
| 2. EB CCO B | 6 | 6' X 6' | 6 | 357.7 | 2.7 |
| 3. EB LT CD | 1 | 6' X 50'0 | 3-6-3 | 812.8 | 2.2 |
| 4. EB THRU CD A | 6 | 6' X 50'0 | 3-6-3 | 819.1 | 2.3 |
| 5. EB THRU CD | 6 | 6' X 50'0 | 3-6-3 | 815.7 | 2.3 |
| 6. EB RT CD | 6 | 6' X 25'0 | 3-6-3 | 443.9 | 1.6 |
| 7. NB CCO | 4 | NA | NA | NA | NA |
| 8. NB LT CD | 4 | 6' X 50'0 | 3-6-3 | 833.0 | 2.7 |
| 9. NB THRU CD | 4 | 6' X 50'0 | 3-6-3 | 831.2 | 2.6 |
| 10. NB RT CD A | 4 | NA | NA | NA | NA |
| 11. NB RT CD B | 4 | 6' X 25'0 | 3-6-3 | 458.1 | 1.9 |
| 12. WB CCO | 2 | 6' X 6' | 6 | 364.4 | 2.9 |
| 13. WB CCO | 2 | 6' X 6' | 6 | 361.7 | 2.8 |
| 14. WB LT CD | 5 | 6' X 50'0 | 3-6-3 | 820.0 | 2.4 |
| 15. WB THRU CD A | 2 | 6' X 50'0 | 3-6-3 | 816.8 | 2.3 |
| 16. WB THRU CD B | 2 | 6' X 50'0 | 3-6-3 | 813.2 | 2.2 |
| 17. WB RT CD | 2 | 6' X 25'0 | 3-6-3 | 439.1 | 1.5 |
| 18. SB CCO A | 3 | NA | NA | NA | NA |
| 19. SB CCO B | 3 | NA | NA | NA | NA |
| 20. SB LT CD | 3 | 6' X 50'0 | 3-6-3 | 803.1 | 2.0 |
| 21. SB THRU CD | 3 | 6' X 50'0 | 3-6-3 | 801.0 | 1.9 |
| 22. SB RT CD A | 3 | NA | NA | NA | NA |
| 23. SB RT CD B | 3 | 6' X 25'0 | 3-6-3 | 425.5 | 1.2 |

THE ABOVE VALUES ARE CALCULATED OF COMBINED LOOP AND LEAD-IN INDUCTANCE AND RESISTANCE. ACTUAL MEASURED VALUES SHOULD BE WITHIN +/- 20% OF THESE VALUES.

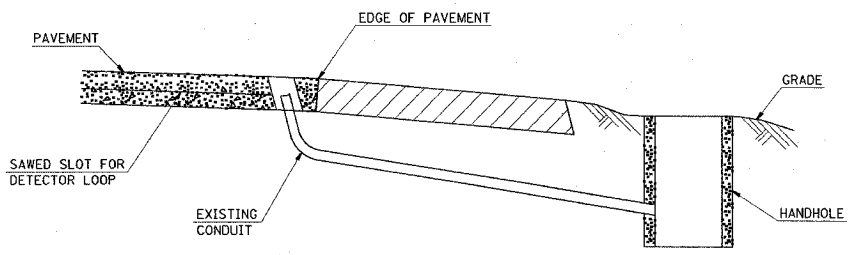
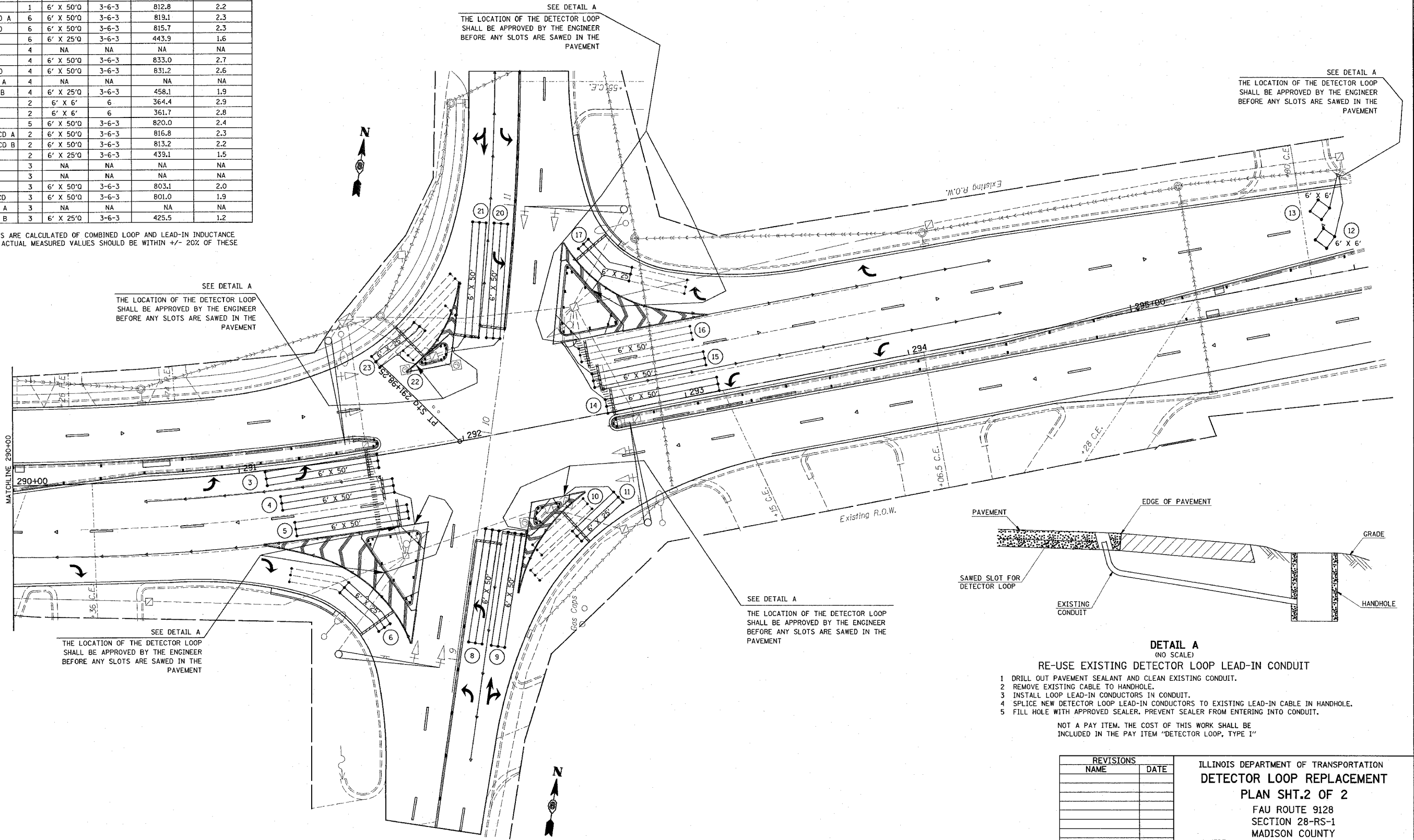

- DETAIL A**
(NO SCALE)
- RE-USE EXISTING DETECTOR LOOP LEAD-IN CONDUIT**
- 1 DRILL OUT PAVEMENT SEALANT AND CLEAN EXISTING CONDUIT.
 - 2 REMOVE EXISTING CABLE TO HANDHOLE.
 - 3 INSTALL LOOP LEAD-IN CONDUCTORS IN CONDUIT.
 - 4 SPLICE NEW DETECTOR LOOP LEAD-IN CONDUCTORS TO EXISTING LEAD-IN CABLE IN HANDHOLE.
 - 5 FILL HOLE WITH APPROVED SEALER. PREVENT SEALER FROM ENTERING INTO CONDUIT.
- NOT A PAY ITEM. THE COST OF THIS WORK SHALL BE INCLUDED IN THE PAY ITEM "DETECTOR LOOP, TYPE 1"

| REVISIONS | |
|-----------|------|
| NAME | DATE |
| | |
| | |
| | |
| | |
| | |
| | |
| | |
| | |
| | |
| | |

ILLINOIS DEPARTMENT OF TRANSPORTATION
DETECTOR LOOP REPLACEMENT
PLAN SHT.2 OF 2
 FAU ROUTE 9128
 SECTION 28-RS-1
 MADISON COUNTY

SCALE: VERT. _____
 HORIZ. _____
 DATE _____ DRAWN BY _____
 CHECKED BY _____

PLOT DATE = 6/30/2005
 FILE NAME = o:\projects\9128\plan\9128sht2.dgn
 PLOT SCALE = 20.0000' / 1" = 1/8" = 1/8" REF