

ROUTE	SECTION	COUNTY	TOTAL SHEETS	SHEET NO.
PARK ROADS	DIST. 8 WSC 2006-1	RANDOLPH	47	1

CONTRACT NO. 76972

INDEX OF SHEETS

- 1 COVER SHEET
- 2-2A SCHEDULE OF QUANTITIES
- 2B GENERAL NOTES AND SUMMARY OF QUANTITIES
- 3 SITE LAYOUT
- 4 SHEET GRID
- 5-39 PLAN SHEETS
- 40 WORLD SHOOTING AND RECREATION COMPLEX MAIN ENTRANCE PLAN
- 41 EVENTS CENTER BUILDING ENTRANCE PLAN
- 42 SHOWER BUILDING AREA PLAN
- 43 EGYPTIAN ELECTRIC SUBSTATION AREA PLAN
- 44 SIGN FOUNDATION DETAILS & BILL OF MATERIALS
- 45 ORNAMENTAL POND WATER PUMP DETAILS

STATE OF ILLINOIS
DEPARTMENT OF TRANSPORTATION
DIVISION OF HIGHWAYS

PROPOSED LANDSCAPE PLANS

PARK ROADS

SECTION DIST. 8 WSC 2006-1

WORLD SHOOTING AND RECREATION COMPLEX

PHASE IV

RANDOLPH COUNTY

C-98-143-05

Plans Prepared By:

KNIGHT
Engineers & Architects
221 North LaSalle Street
SUITE 300
Chicago IL 60601
Phone: (312) 577-3300, Fax (312) 577-3526

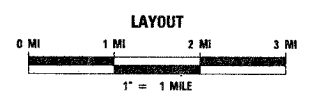
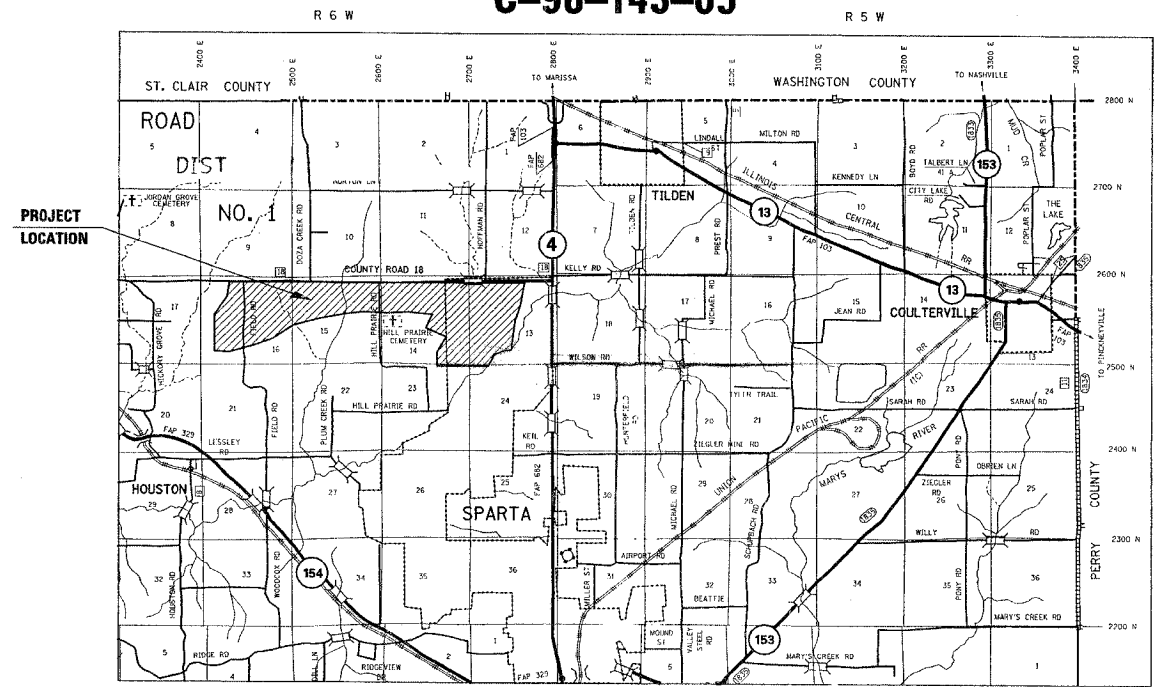
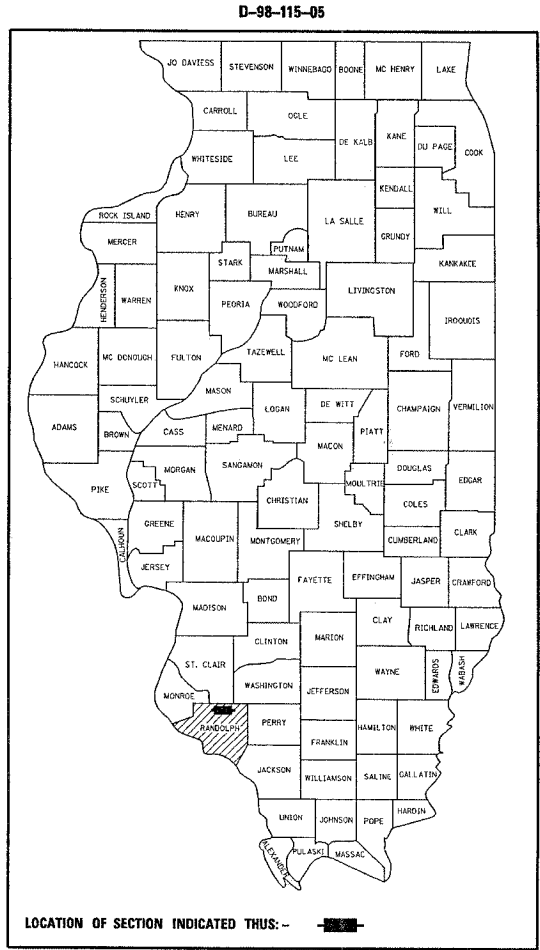

IL STATE PLANE WEST NAD 83
X: 38.18706 Y: -88.75917

MICROFILMED _____
REEL NUMBER _____
AWARDED _____
RESIDENT ENGINEER _____
AS BUILT CHANGES WERE MADE
ON THE FOLLOWING SHEETS

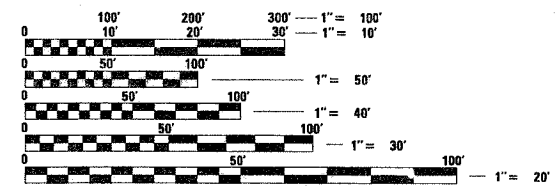

FULL SIZE PLANS HAVE BEEN PREPARED USING STANDARD ENGINEERING SCALES. REDUCED SIZED PLANS WILL NOT CONFORM TO STANDARD SCALES. IN MAKING MEASUREMENTS ON REDUCED PLANS, THE ABOVE SCALES MAY BE USED.

J.U.L.I.E.
JOINT UTILITY LOCATION INFORMATION FOR EXCAVATION
1-800-892-0123

STATE OF ILLINOIS
DEPARTMENT OF TRANSPORTATION
DIVISION OF HIGHWAYS

SUBMITTED Aug 31 20 05
Mary C. Lamm DEPUTY DIRECTOR OF HIGHWAYS
REGION FIVE ENGINEER

October 14, 20 05
Mike Hine ENGINEER OF DESIGN AND ENVIRONMENT

October 14, 20 05
Eric E. Harsh DEPUTY DIRECTOR, DIVISION OF HIGHWAYS



**PRINTED BY THE AUTHORITY
OF THE STATE OF ILLINOIS**

IDNR PLAN CONTACT: GARY ILES (618) 435-8138
IDNR LANDSCAPE ARCHITECT: NED ENRIETTO (618) 435-8138

CONTRACT NO. 76972