

SECTION	COUNTY	TOTAL SHEETS	SHEET NO.
02-00090-00-BT	DUPAGE	117	32
STA. TO STA.			
IDOT PROJECT NO. M-8003(222)			
SALT CREEK GREENWAY TRAIL			

CONTRACT NO. 83713



SIGN PANELS TYPE 1 WITH ALUMINUM SIGN POST, SPECIAL (SEE DETAIL)

**PROP. CURVE NORTH-14**  
 PI STA = 16+529.905  
 N = 581,685.657  
 E = 330,293.966  
 $\Delta = 32^\circ 50' 50''$  (LT)  
 R = 30,000 m  
 T = 8.843 m  
 L = 17.199 m  
 E = 1.276 m

**PROP. CURVE NORTH-16**  
 PI STA = 16+599.898  
 N = 581,621.372  
 E = 330,321.514  
 $\Delta = 10^\circ 20' 45''$  (LT)  
 R = 30,000 m  
 T = 2.679 m  
 L = 6.050 m  
 E = 0.119 m

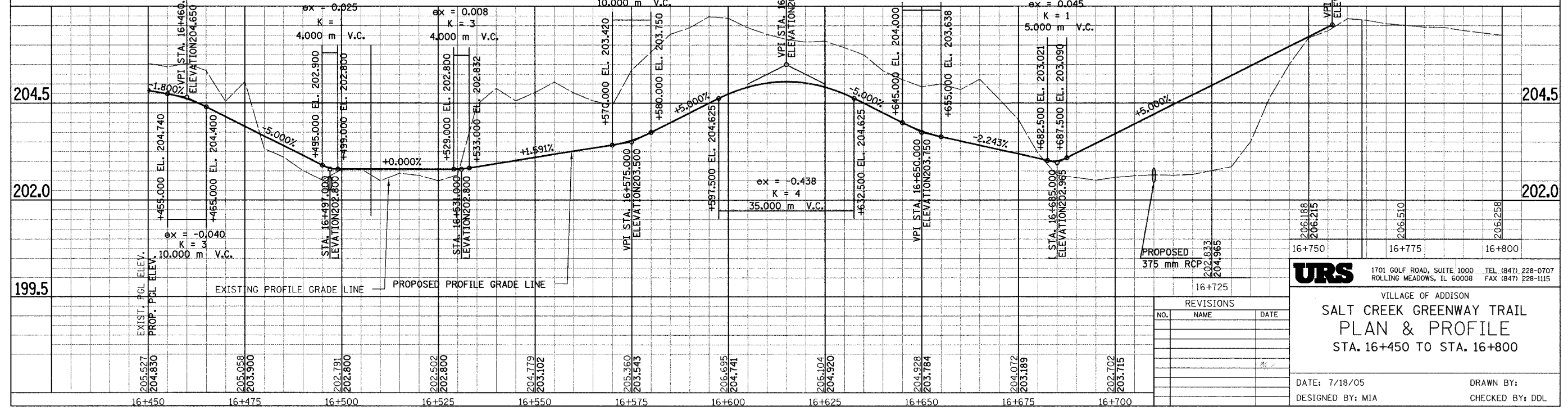
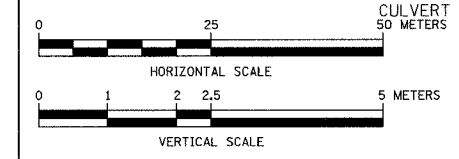
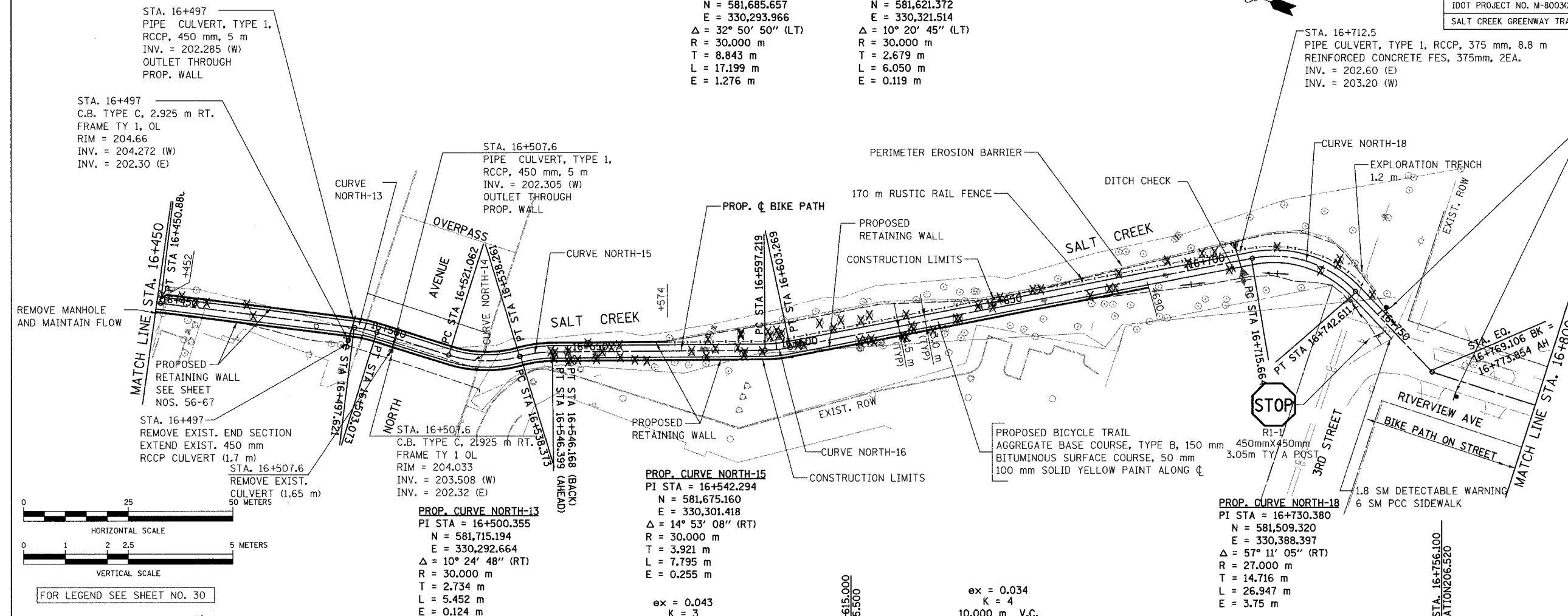

REVISIONS		
NO.	NAME	DATE

**URS** 1701 GOLF ROAD, SUITE 1000 TEL (847) 228-0707  
 ROLLING MEADOWS, IL 60008 FAX (847) 228-1115

VILLAGE OF ADDISON

**SALT CREEK GREENWAY TRAIL  
 PLAN & PROFILE  
 STA. 16+450 TO STA. 16+800**

DATE: 7/18/05 DESIGNED BY: MIA DRAWN BY: CHECKED BY: DDL