

SECTION	COUNTY	TOTAL SHEETS	SHEET NO.
02-00034-00-BT	DUPAGE	108	10
STA.	TO STA.		
IDOT PROJECT NO. M-8003(216)			
SALT CREEK GREENWAY TRAIL			
CONTRACT NO. 83714			

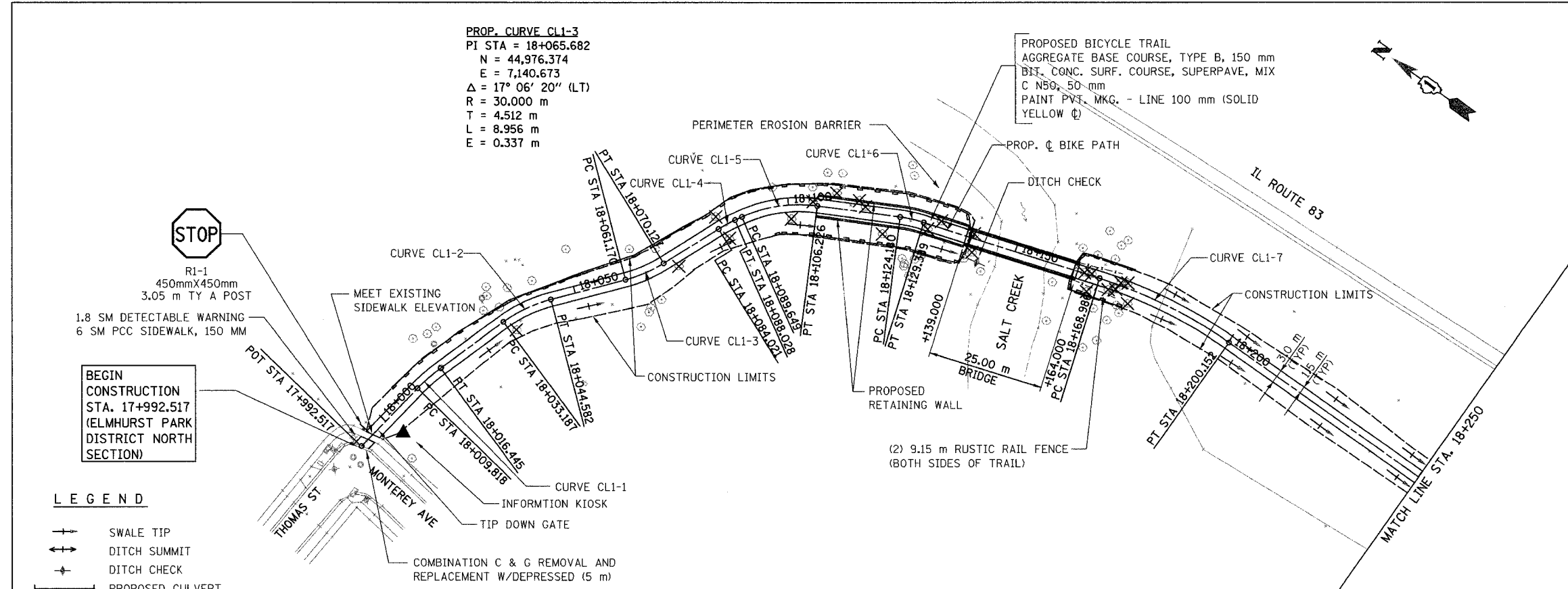

BEGIN CONSTRUCTION STA. 17+992.517 (ELMHURST PARK DISTRICT NORTH SECTION)

- LEGEND**
- SWALE TIP
 - ↔ DITCH SUMMIT
 - ⊕ DITCH CHECK
 - PROPOSED CULVERT
 - - - EXISTING CULVERT
 - ⊙ EXISTING MANHOLE
 - - - EXISTING FENCE
 - ▶ FLARED END SECTION
 - ⊕ INLET AND PIPE PROTECTION
 - ✕ TREE REMOVAL
 - PERIMETER EROSION BARRIER

PROP. CURVE CL1-1	PROP. CURVE CL1-2	PROP. CURVE CL1-4	PROP. CURVE CL1-5	PROP. CURVE CL1-6	PROP. CURVE CL1-7
PI STA = 18+013.139	PI STA = 18+038.954	PI STA = 18+086.028	PI STA = 18+098.155	PI STA = 18+126.791	PI STA = 18+184.696
N = 45,001.065	N = 44,993.341	N = 44,968.708	N = 44,962.695	N = 44,937.178	N = 44,882.312
E = 7,095.193	E = 7,119.841	E = 7,159.592	E = 7,170.130	E = 7,184.060	E = 7,202.613
Δ = 9° 29' 36" (RT)	Δ = 21° 45' 46" (RT)	Δ = 7° 39' 12" (RT)	Δ = 31° 39' 35" (RT)	Δ = 9° 56' 49" (RT)	Δ = 17° 51' 26" (RT)
R = 40,000 m	R = 30,000 m	R = 30,000 m	R = 30,000 m	R = 100,000 m	R = 100,000 m
T = 3,321 m	T = 5,767 m	T = 2,007 m	T = 8,506 m	T = 2,611 m	T = 15,711 m
L = 6,628 m	L = 11,395 m	L = 4,007 m	L = 16,577 m	L = 5,208 m	L = 31,167 m
E = 0.138 m	E = 0.549 m	E = 0.067 m	E = 1.183 m	E = 0.113 m	E = 1.227 m

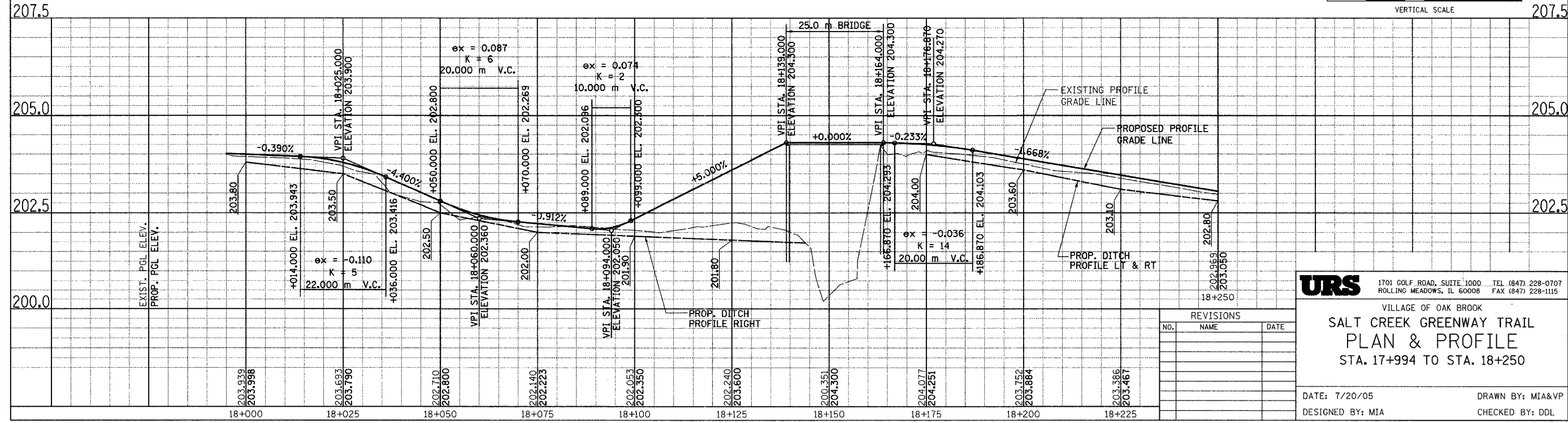
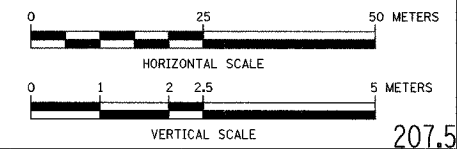

REVISIONS		
NO.	NAME	DATE

URS 1701 GOLF ROAD, SUITE 1000 TEL (847) 228-0707
 ROLLING MEADOWS, IL 60008 FAX (847) 228-1115

VILLAGE OF OAK BROOK

**SALT CREEK GREENWAY TRAIL
 PLAN & PROFILE
 STA. 17+994 TO STA. 18+250**

DATE: 7/20/05 DRAWN BY: MIA&VP
 DESIGNED BY: MIA CHECKED BY: DDL