

F.A.U. RTE.	SECTION	COUNTY	TOTAL SHEETS	SHEET NO.
6371	93-00295-02-PV	MCLEAN	117	21
STA.		TO STA.		
		ILLINOIS		
CONTRACT NO. 87267				

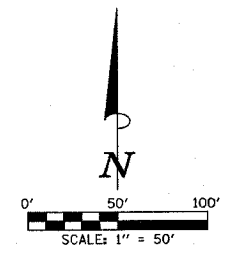

- LEGEND**
- CONSTRUCTION WORK ZONE
 - LIMITS OF PROPOSED CONSTRUCTION
 - TEMPORARY BITUMINOUS PAVEMENT
 - TEMPORARY AGGREGATE ENTRANCE, PATCH, OR ACCESS ROAD
 - BARRICADE OR DRUM
 - DIRECTION OF TRAFFIC
 - SIGN

NOTE:
THE ADDITIONAL TRAFFIC CONTROL DEVICES SHOWN FOR THIS STAGE SHALL BE INCLUDED IN THE CONTRACT LUMP SUM PRICE FOR TRAFFIC CONTROL AND PROTECTION, STANDARD BLR 21, SPECIAL.

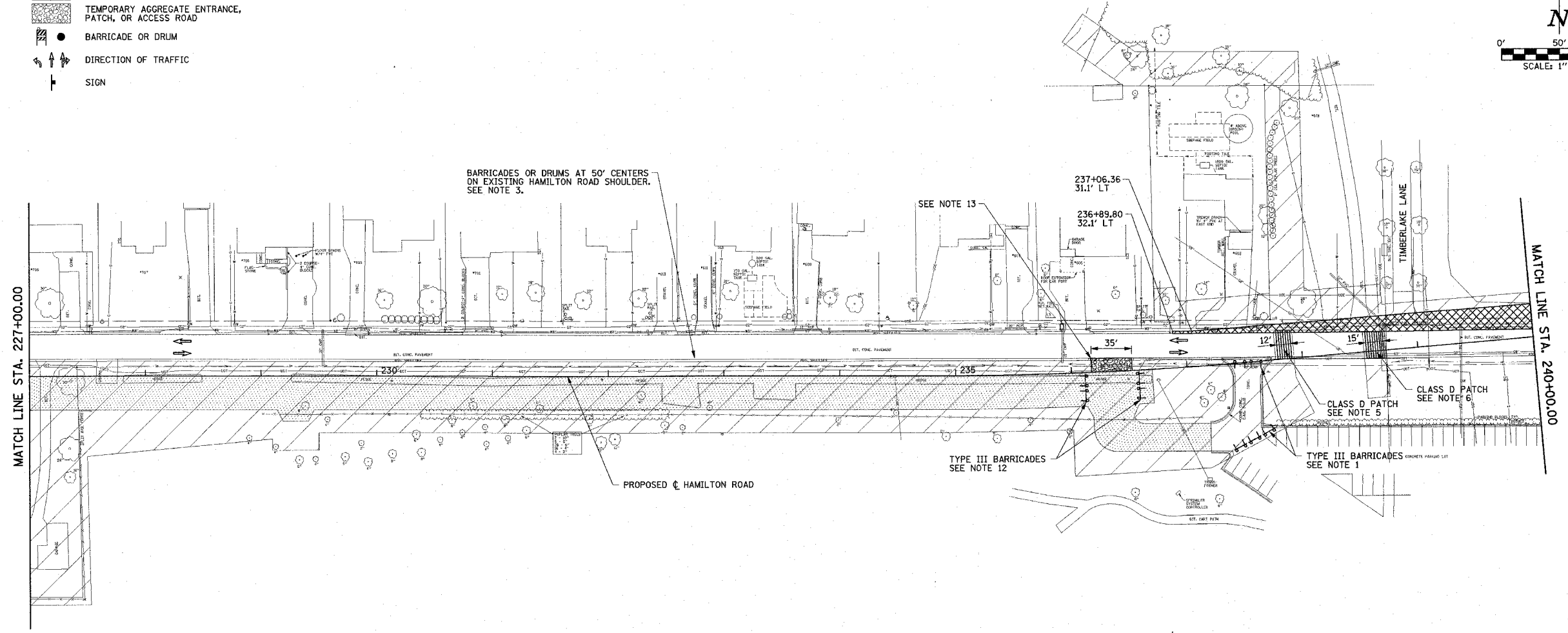

SUGGESTED STAGE I CONSTRUCTION SEQUENCE (AS SHOWN HERE AND ON SHEET NO. 20)
SEE SHEET NO. 20 FOR THE STAGE I CONSTRUCTION SEQUENCE.

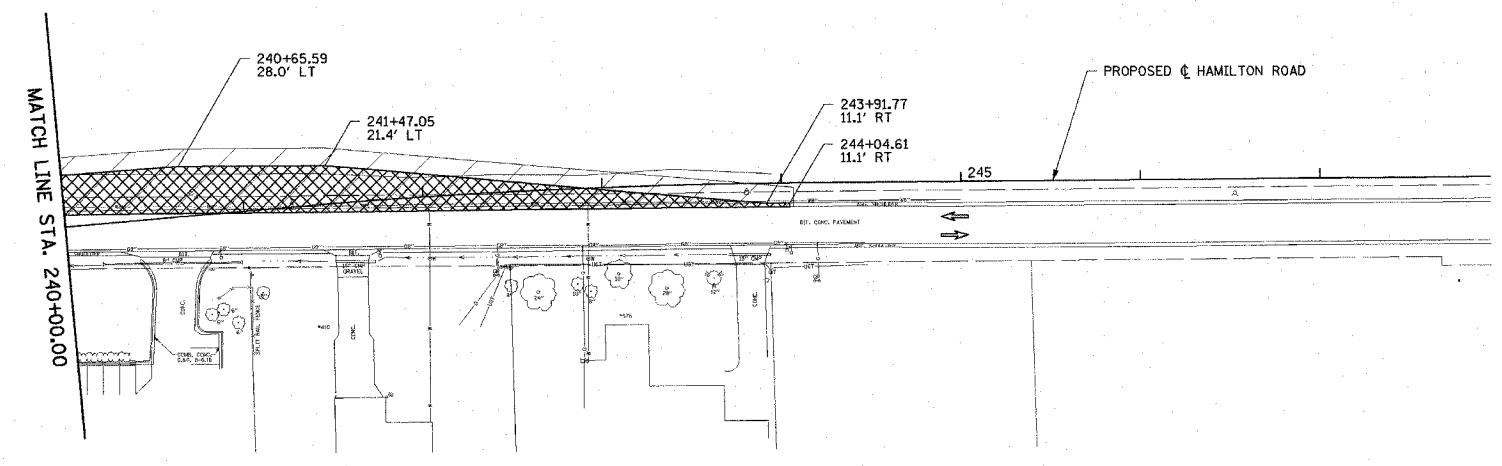

ILLINOIS DEPARTMENT OF TRANSPORTATION
STAGE CONSTRUCTION AND MAINTENANCE OF TRAFFIC PLAN
STAGE I

DATE : 3-05
DRAWN BY : J.A.J.
CHECKED BY : R.L.H.

SCALE : 1"=50'