

NOTE 1  
 EXISTING 8" WATER MAIN TO BE REMOVED FROM STA. 904+57.23 TO STA. 905+14.27. THE COST OF REMOVING THE WATER MAIN SHALL BE CONSIDERED AS INCIDENTAL AND SHOULD BE INCLUDED IN THE COST FOR ABANDONING EXISTING WATER MAIN.

PAVEMENT REMOVAL SCHEDULE					
LOCATION	BIT SURF REM 1 1/2 (SQ YD)	PAVEMENT REM (SQ YD)	DRIVE PAVEMENT REM (SQ YD)	COMB CURB GUTTER REM (FOOT)	SIDEWALK REM (SQ FT)
904+63.5 TO 905+50.0 LT. & RT.	401.8				
905+50.0 TO 910+15.0 LT. & RT.	1700.5				
901+00.0 TO 904+63.5 LT. & RT.		910.4			
901+59.4 RT.			135.6		
903+09.2 RT. TO 903+25.6 RT.			19.7		
903+40.2 LT.			69.4		
906+70.2 RT.			44.0		
904+62.9 RT. TO 904+63.5 RT.				18.0	
904+88.1 RT. TO 905+15.0 RT.				30.6	
904+40.6 LT. TO 905+50.0 LT.				109.4	
905+50.0 LT. TO 906+10.0 LT.				60.0	
906+58.2 RT. TO 906+82.2 RT.				24.0	
903+25.5 RT. TO 903+30.5 RT.					15.8
906+84.6 LT. TO 907+30.0 LT.					176.3
907+00.9 RT. TO 907+55.0 RT.					212.1
<b>TOTAL</b>	<b>2102.3</b>	<b>910.4</b>	<b>268.7</b>	<b>242.0</b>	<b>404.2</b>

**ABANDON EXISTING WATER MAIN**  
 THE EXISTING WATER MAINS ALONG HAMILTON ROAD AND MORRIS AVENUE WITHIN THE PROJECT LIMITS WILL BE ABANDONED IN PLACE INCLUDING THE DOMESTIC WATER SERVICE VALVES, BOXES, AND SERVICE LINES. SEE THE WATER MAIN PLANS FOR ADDITIONAL INFORMATION.

- LEGEND**
- U.P. DND - UTILITY POLE DO NOT DISTURB
  - L.P. DND - LIGHT POLE DO NOT DISTURB
  - U.P. TBRBO - UTILITY POLE TO BE RELOCATED BY OTHERS
  - L.P. TBRBO - LIGHT POLE TO BE RELOCATED BY OTHERS
  - (M) - MAILBOX TO BE RELOCATED
  - (A) - STRUCTURE TO BE ADJUSTED
  - (R) - STRUCTURE TO BE REMOVED
  - (OR) - TREE REMOVAL
  - (TP1) - EXISTING TREE TO BE TRANSPLANTED
  - (Hatched) - BITUMINOUS SURFACE REMOVAL-BUTT JOINT (SEE DETAIL SHEET)
  - (Diagonal Hatched) - BITUMINOUS SURFACE REMOVAL 1/2" (SEE DETAIL SHEET)
  - (Cross-hatched) - PAVEMENT REMOVAL
  - (Horizontal Hatched) - DRIVEWAY PAVEMENT REMOVAL
  - (Vertical Hatched) - COMBINATION CURB AND GUTTER REMOVAL
  - (Dotted) - SIDEWALK REMOVAL
  - (X-X-X) - EXISTING FENCE
  - (X) - FENCE REMOVAL
  - (X) - REMOVAL ITEM (INCIDENTAL TO THE CONTRACT)

**SALVAGING AND TRANSPLANTING TREES, SPECIAL**

ABBREV.	EXISTING STATION	EXISTING OFFSET	EACH
TP48	901+63.0	30.7' LT.	1
TP49	901+93.5	31.9' LT.	1
TP50	902+16.9	30.5' LT.	1
TP51	902+55.1	34.1' LT.	1
TP52	902+86.1	37.3' RT.	1
TP53	903+61.5	37.8' LT.	1
TP54	903+84.6	28.4' LT.	1
TP55	904+32.9	34.1' LT.	1
TP56	904+63.4	32.1' LT.	1
TP57	905+44.5	30.2' LT.	1
TP58	905+55.7	32.5' LT.	1
TP59	905+62.5	33.0' RT.	1
TP60	906+39.1	29.4' LT.	1
TP61	906+59.3	30.0' LT.	1
<b>TOTAL</b>			<b>14</b>

**TREE REMOVAL (6 TO 15 UNITS DIAMETER)**

STATION	OFFSET	UNIT
901+05.5	37.7' LT.	8
901+20.0	34.7' LT.	6
901+34.4	38.3' LT.	6
902+85.3	33.8' LT.	8
903+02.2	35.6' LT.	8
903+65.0	27.7' LT.	6
903+96.8	32.6' LT.	8
904+12.1	32.0' LT.	8
906+69.6	25.6' LT.	10
906+69.9	32.3' LT.	8
<b>TOTAL</b>		<b>76</b>

**TREE REMOVAL (OVER 15 UNITS DIAMETER)**

STATION	OFFSET	UNIT
902+35.6	24.6' RT.	28
902+49.7	22.7' RT.	42
905+05.8	27.5' LT.	30 STUMP
906+13.6	32.6' RT.	18
<b>TOTAL</b>		<b>118</b>

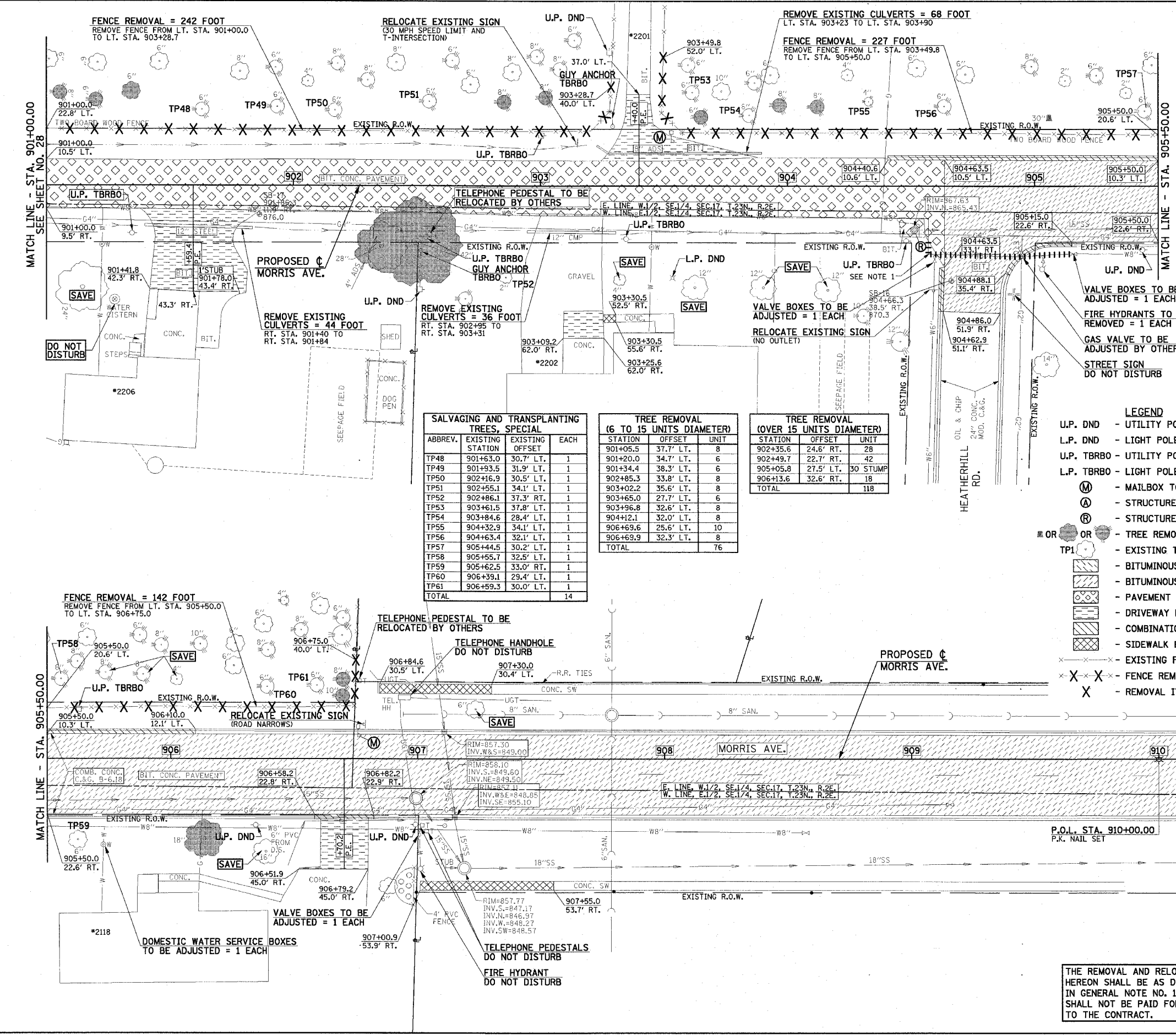

FOR LOCATIONS OF TREES TO BE TRANSPLANTED SEE THE TREE PLANTING PLAN SHEETS.

FOR PROPOSED CONSTRUCTION IN THIS AREA SEE PLAN AND PROFILE SHEET NO'S. 44 & 45.

MAILBOXES SHALL BE RELOCATED AS DIRECTED BY THE ENGINEER IN ACCORDANCE WITH ARTICLE 107.20 OF THE STANDARD SPECIFICATIONS.

SEE PLAN AND PROFILE SHEETS FOR STORM SEWER REMOVAL AND STRUCTURE REMOVAL AND ADJUSTMENT SCHEDULES.

EXISTING PAVEMENTS, CURBS AND GUTTERS, AND SIDEWALKS IN WHICH THE TOP SURFACE IS TO BE JOINED TO THE PROPOSED WORK SHALL BE SO JOINED THROUGH SAW CUT JUNCTURES.

THE REMOVAL AND RELOCATION OF VARIOUS TRAFFIC SIGNS NOTED HEREON SHALL BE AS DIRECTED BY THE ENGINEER AND AS SPECIFIED IN GENERAL NOTE NO. 10 ON THE GENERAL NOTE SHEET. THIS WORK SHALL NOT BE PAID FOR SEPARATELY AND IS CONSIDERED INCIDENTAL TO THE CONTRACT.

ILLINOIS DEPARTMENT OF TRANSPORTATION

**REMOVALS/RELOCATIONS PLAN**

DATE : 3-05  
 DRAWN BY : J.L.B.  
 CHECKED BY : R.L.H.