

SEC. 17, T.23 N., R.2 E., 3rd P.M.
MCLEAN COUNTY, ILLINOIS

| F.A.U. RTE. | SECTION | COUNTY | TOTAL SHEETS | SHEET NO. |
|--------------------|----------------|-------------------|--------------|-----------|
| 6371 | 93-00295-02-PV | MCLEAN | 117 | 75 |
| STA. 901+00.00 | | TO STA. 904+00.00 | | |
| ILLINOIS | | | | |
| CONTRACT NO. 87267 | | | | |

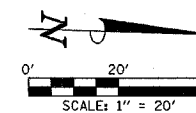

NOTE
SEE STAGE CONSTRUCTION AND MAINTAINANCE
OF TRAFFIC PLANS FOR PLACEMENT OF TEMPORARY
AGGREGATE FROM STA. 903+44.5 LT. TO STA. 904+90.0 LT.

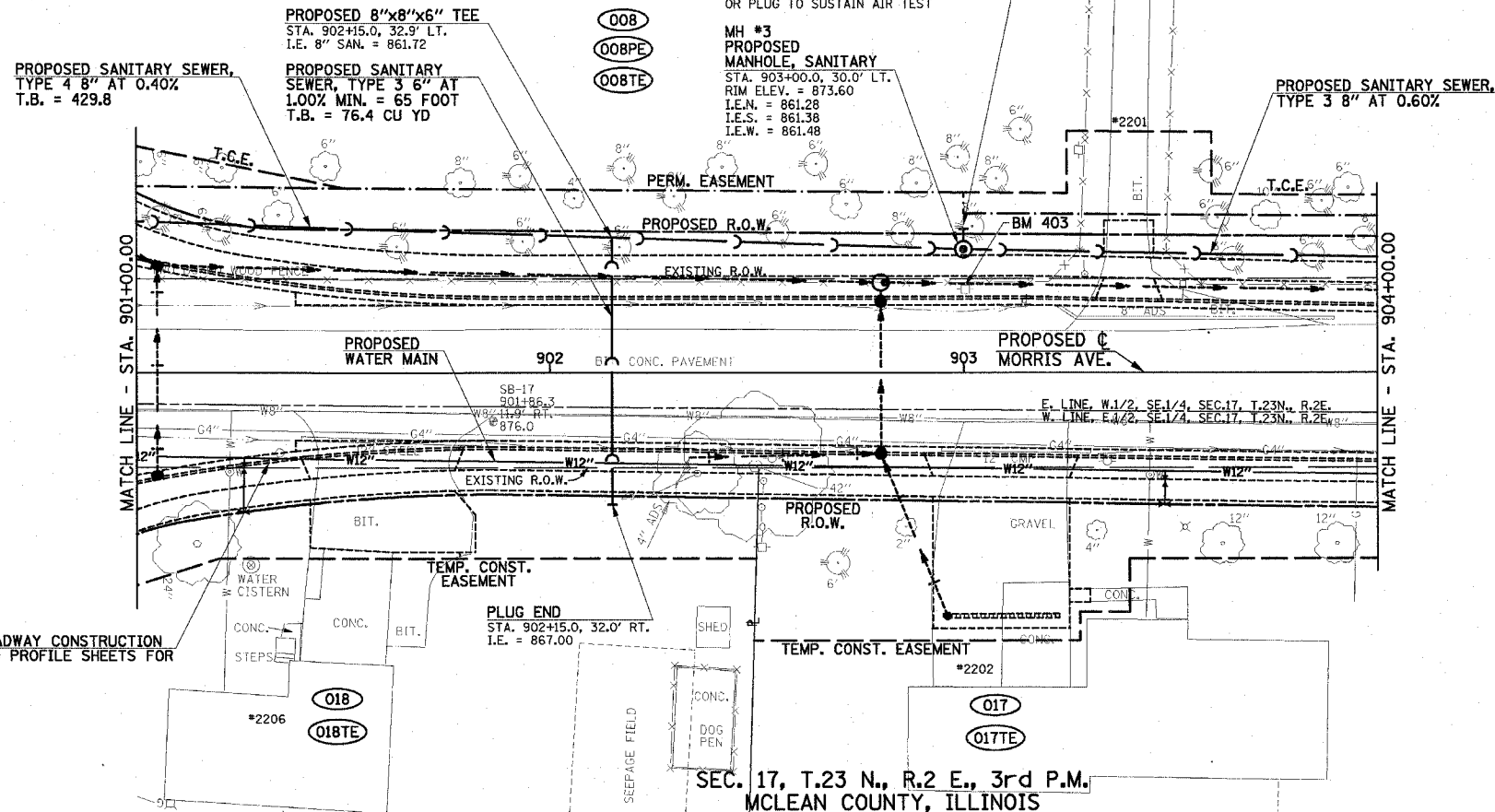

PROPOSED ROADWAY CONSTRUCTION
SEE PLAN AND PROFILE SHEETS FOR
DETAILS.

SEE SCHEDULE OF QUANTITIES FOR
ADDITIONAL INFORMATION.

SEC. 17, T.23 N., R.2 E., 3rd P.M.
MCLEAN COUNTY, ILLINOIS

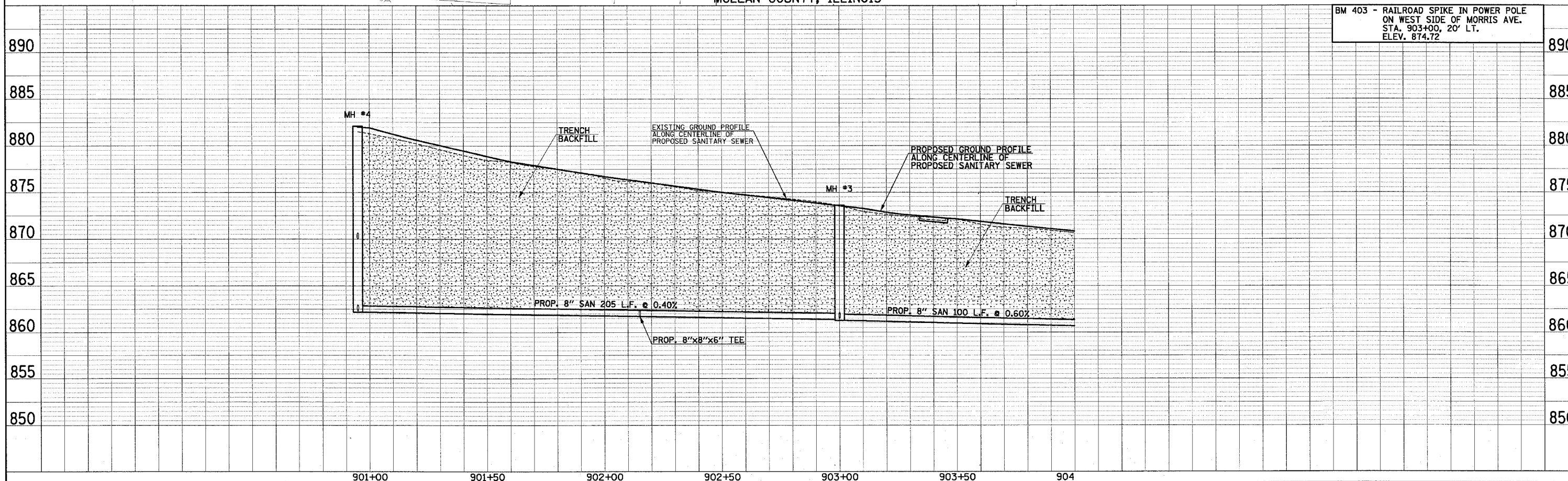

BM 403 - RAILROAD SPIKE IN POWER POLE
ON WEST SIDE OF MORRIS AVE.
STA. 903+00, 20' LT.
ELEV. 874.72

| DATE | BY | REVISION |
|------|----|----------|
| | | |
| | | |
| | | |

| DATE | BY | REVISION |
|------|----|----------|
| | | |
| | | |
| | | |