

FAP RTE	SECTION	COUNTY	TOTAL SHEETS	SHEET NO.
729	342-4	VERMILION	285	9
FED. ROAD DIST. NO.		ILLINOIS FED. AID PROJECT		

CODE NO	PAY ITEM	UNIT	URBAN TOTAL QUANTITY	ROADWAY PCC RECONSTRUCTION US 136 STA 90+268.000 TO STA 91+658.000 N. WALNUT ST. STA 4+009.000 TO STA 4+115.000 80% FEDERAL 20% STATE J000-2A	ROADWAY LIGHTING NON-PARTICIPATING US 136 STA 90+268.000 TO STA 91+658.000 100% DANVILLE Y030-1E	ROADWAY PCC RECONSTRUCTION N WALNUT ST STA 4+009.000 TO STA 4+115.000 100% DANVILLE J000-2A	TRAFFIC SIGNALS WALNUT ST INTERSECTION 80% FEDERAL 10% STATE 10% DANVILLE Y031-1F	TRAFFIC SIGNALS VERMILION INTERSECTION 80% FEDERAL 10% STATE 10% DANVILLE Y031-1F	TRAFFIC SIGNALS HAZEL ST INTERSECTION 80% FEDERAL 10% STATE 10% DANVILLE Y031-1F	TRAFFIC SIGNALS JACKSON ST INTERSECTION 80% FEDERAL 10% STATE 10% DANVILLE Y031-1F	TRAFFIC SIGNALS PARK ST INTERSECTION 80% FEDERAL 13% STATE 7% DANVILLE Y031-1F	TRAFFIC SIGNALS BUCHANAN ST INTERSECTION 80% FEDERAL 10% STATE 10% DANVILLE Y031-1F	HIGHWAY INTERCONNECT BETWEEN WALNUT, VERMILION, HAZEL, JACKSON, PARK, & BUCHANAN STREETS 80% FEDERAL 10% STATE 10% DANVILLE Y032-1F
M7030210	TEMPORARY PAVEMENT MARKING - LETTERS AND SYMBOLS	SQ M	100	100									
M7030220	TEMPORARY PAVEMENT MARKING - LINE 100MM	METER	15,836	15,836									
M7030240	TEMPORARY PAVEMENT MARKING - LINE 150MM	METER	1,092	1,092									
M7030260	TEMPORARY PAVEMENT MARKING - LINE 300MM	METER	57	57									
M7030280	TEMPORARY PAVEMENT MARKING - LINE 600MM	METER	347	347									
M7031000	WORK ZONE PAVEMENT MARKING REMOVAL	SQ M	1,040	1,040									
M7800600	EPOXY PAVEMENT MARKING - LETTERS AND SYMBOLS	SQ M	70	70									
M7800605	EPOXY PAVEMENT MARKING - LINE 100MM	METER	5,471	5,471									
M7800615	EPOXY PAVEMENT MARKING - LINE 150MM	METER	1,092	1,092									
M7800625	EPOXY PAVEMENT MARKING - LINE 300MM	METER	57	57									
M7800640	EPOXY PAVEMENT MARKING - LINE 600MM	METER	292	292									
M7830100	PAVEMENT MARKING REMOVAL	SQ M	994	994									
M8100250	CONDUIT IN TRENCH, 40MM DIA., PVC	METER	945	945			115	130	104	80	100	100	945
M8100260	CONDUIT IN TRENCH, 50MM DIA., PVC	METER	136.0				26	32	33	8	16	21	
M8100270	CONDUIT IN TRENCH, 65MM DIA., PVC	METER	24.0				9			15			
M8100280	CONDUIT IN TRENCH, 75MM DIA., PVC	METER	66.0					14	12	16	5	19	
M8100300	CONDUIT IN TRENCH, 100MM DIA., PVC	METER	42.0				6	5	4		12	15	
M8100310	CONDUIT IN TRENCH, 125MM DIA., PVC	METER	8.0						7	1			
M8100320	CONDUIT IN TRENCH, 150MM DIA., PVC	METER	6.0				2	2				2	
M8100850	CONDUIT, AUGERED 40MM DIA., PVC	METER	81.0										81.0
M8100880	CONDUIT, AUGERED 75MM DIA., PVC	METER	231.0				54	33	38	64	18	24	
M8100900	CONDUIT, AUGERED 100MM DIA., PVC	METER	93.0				30	22			22	19	
M8150200	TRENCH AND BACKFILL FOR ELECTRICAL WORK	METER	1,218.0				149	191	220	135	280	243	
M8731210	ELECTRIC CABLE IN CONDUIT, SIGNAL NO. 14 2C	METER	98.0								98		
M8731220	ELECTRIC CABLE IN CONDUIT, SIGNAL NO. 14 3C	METER	2,237.0				442	368	450	306	276	395	
M8731230	ELECTRIC CABLE IN CONDUIT, SIGNAL NO. 14 4C	METER	1,265.0				405	252	161		90	357	
M8731240	ELECTRIC CABLE IN CONDUIT, SIGNAL NO. 14 5C	METER	1,525.0				273	181	250	162	421	238	
M8731250	ELECTRIC CABLE IN CONDUIT, SIGNAL NO. 14 7C	METER	2,356.0				508	516	453	400	96	383	
M8731700	ELECTRIC CABLE IN CONDUIT, COMMUNICATION NO. 18 3 PAIR	METER	1,266.0										1,266.0
M8731800	ELECTRIC CABLE IN CONDUIT, SERVICE, NO.6 2C	METER	52.0					52					
M8750670	TRAFFIC SIGNAL POST, ALUMINUM 3.65 METER	EACH	5						1	1	3		
M8750690	TRAFFIC SIGNAL POST, ALUMINUM 4.25 METER	EACH	6						2		2	2	
M8750710	TRAFFIC SIGNAL POST, ALUMINUM 4.85 METER	EACH	14				4	4	2	2		2	
M8770710	STEEL COMBINATION MAST ARM ASSEMBLY AND POLE 5.48 METER	EACH	1					1					

*SPECIALTY ITEMS

① REVISED 11/10/05

FAP RTE	SECTION	COUNTY	TOTAL SHEETS	SHEET NO.
729	342-4	VERMILION	285	10
FED. ROAD DIST. NO.		ILLINOIS	FED. AID PROJECT	

CODE NO	PAY ITEM	UNIT	URBAN TOTAL QUANTITY	ROADWAY PCC RECONSTRUCTION US 136 STA 90+268.000 TO STA 91+658.000 N. WALNUT ST. STA 4+009.000 TO STA 4+115.000 80% FEDERAL 20% STATE J000-2A	ROADWAY LIGHTING NON-PARTICIPATING US 136 STA 90+268.000 TO STA 91+658.000 100% DANVILLE Y030-1E	ROADWAY PCC RECONSTRUCTION N WALNUT ST STA 4+009.000 TO STA 4+115.000 100% DANVILLE J000-2A	TRAFFIC SIGNALS WALNUT ST INTERSECTION 80% FEDERAL 10% STATE 10% DANVILLE Y031-1F	TRAFFIC SIGNALS VERMILION INTERSECTION 80% FEDERAL 10% STATE 10% DANVILLE Y031-1F	TRAFFIC SIGNALS HAZEL ST INTERSECTION 80% FEDERAL 10% STATE 10% DANVILLE Y031-1F	TRAFFIC SIGNALS JACKSON ST INTERSECTION 80% FEDERAL 10% STATE 10% DANVILLE Y031-1F	TRAFFIC SIGNALS PARK ST INTERSECTION 80% FEDERAL 13% STATE 7% DANVILLE Y031-1F	TRAFFIC SIGNALS BUCHANAN ST INTERSECTION 80% FEDERAL 10% STATE 10% DANVILLE Y031-1F	TRAFFIC SIGNALS VERMILION ST INTERSECTION 100% DANVILLE SFTY-1B
M8770730	STEEL COMBINATION MAST ARM ASSEMBLY AND POLE 7.92 METER	EACH	1							1			
M8770735	STEEL COMBINATION MAST ARM ASSEMBLY AND POLE 8.53 METER	EACH	1					1					
M8770740	STEEL COMBINATION MAST ARM ASSEMBLY AND POLE 9.14 METER	EACH	1							1			
M8770745	STEEL COMBINATION MAST ARM ASSEMBLY AND POLE 9.75 METER	EACH	3							1		2	
M8770750	STEEL COMBINATION MAST ARM ASSEMBLY AND POLE 10.36 METER	EACH	8				2	2	1	1	2		
M8770755	STEEL COMBINATION MAST ARM ASSEMBLY AND POLE 10.97 METER	EACH	2				1					1	
M8770760	STEEL COMBINATION MAST ARM ASSEMBLY AND POLE 11.58 METER	EACH	3				1			1		1	
M8780100	CONCRETE FOUNDATION, TYPE A	METER	22.9				3.7	3.6	4.5	2.8	4.6	3.7	
M8780200	CONCRETE FOUNDATION, TYPE D	METER	6.6				1.1	1.1	1.1	1.1	1.1	1.1	
M8780400	CONCRETE FOUNDATION, TYPE E 750MM DIAMETER	METER	9.0					6	3				
MX030399	CONCRETE STEP REMOVAL	SQ M	8	8									
MX032094	COAXIAL CABLE IN CONDUIT	METER	1,337.0				251	225	277	138	226	220	
MX032529	SEGMENTAL CONCRETE BLOCK WALL	SQ M	107.2	107.2									
MX032540	VANE DRAINS	METER	178	178									
MX032783	RETAINING WALL REMOVAL	SQ M	18	18									
MX032867	REMOVE AND RESET ORNAMENTAL FENCE	METER	29.6	29.6									
MX873027	ELECTRIC CABLE IN CONDUIT, GROUNDING, NO.6 1C	METER	819.0				160	137	104	124	145	149	
MX878030	CONCRETE FOUNDATION, TYPE E 900MM DIAMETER	METER	58.0				13.6	6.8	6.8	10.4	6.8	13.6	
MZ000990	AGGREGATE FOR TEMPORARY ACCESS	M TON	127	127									
MZ068200	STEEL CASINGS 750MM	METER	33.0	33.0									
X0320872	VIDEO VEHICLE DETECTION SYSTEM	EACH	6				1	1	1	1	1	1	
X0322178	REMOVE EXISTING LIGHT POLE FOUNDATION	EACH	52		52								
X0323405	METAL SECURITY GATE	EACH	1	1									
X7015005	CHANGEABLE MESSAGE SIGN	CAL DA	112	112									
X8801300	SIGNAL HEAD ,POLYCARBONATE, LED, 1-FACE, 3-SECTION, BRACKET MOUNTED	EACH	6						2	1	3	2	
X8801310	SIGNAL HEAD ,POLYCARBONATE, LED, 1-FACE, 3-SECTION, MAST ARM MOUNTED	EACH	26				5	4	3	4	4	6	
X8801350	SIGNAL HEAD ,POLYCARBONATE, LED, 1-FACE, 4-SECTION, MAST ARM MOUNTED	EACH	3						1			2	
X8801400	SIGNAL HEAD ,POLYCARBONATE, LED, 1-FACE, 5-SECTION, MAST ARM MOUNTED	EACH	11				4	4	1	2			
X8801415	SIGNAL HEAD ,POLYCARBONATE, LED, 2-FACE, 3-SECTION, BRACKET MOUNTED	EACH	3						1		2		
X8801435	SIGNAL HEAD ,POLYCARBONATE, LED, 2-FACE, 1-3 SECTION, 1-4 SECTION, BRACKET MOUNTED	EACH	3						1			2	
X8801437	SIGNAL HEAD ,POLYCARBONATE, LED, 2-FACE, 1-3 SECTION, 1-5 SECTION, BRACKET MOUNTED	EACH	11				4	4	1	2			
X8810395	PEDESTRIAN SIGNAL HEAD, POLYCARBONATE, LED, 1-FACE, BRACKET MOUNTED	EACH	24				8	4	2		2	8	
X8810495	PEDESTRIAN SIGNAL HEAD, POLYCARBONATE, LED, 2-FACE, BRACKET MOUNTED	EACH	10					2	3	4	1		
XX005710	PAINT NEW TRAFFIC SIGNAL POST	EACH	16			16							
Z0048665	RAILROAD PROTECTIVE LIABILITY INSURANCE	L SUM	1	1									

①

XX005710 PAINT NEW TRAFFIC SIGNAL POST

*SPECIALTY ITEMS

① Y031 IF

① REVISED 11-01-05

F.A.P. RTE.	SECTION	COUNTY	TOTAL SHEETS NO.	SHEET NO.
729	34Z-4	VERMILION	285	53
STA. 90+120		TO STA. 90+780		
FED. ROAD DIST. NO.		ILLINOIS FED. AID PROJECT		

SEASON 2 STAGE 3-B
AREA 2

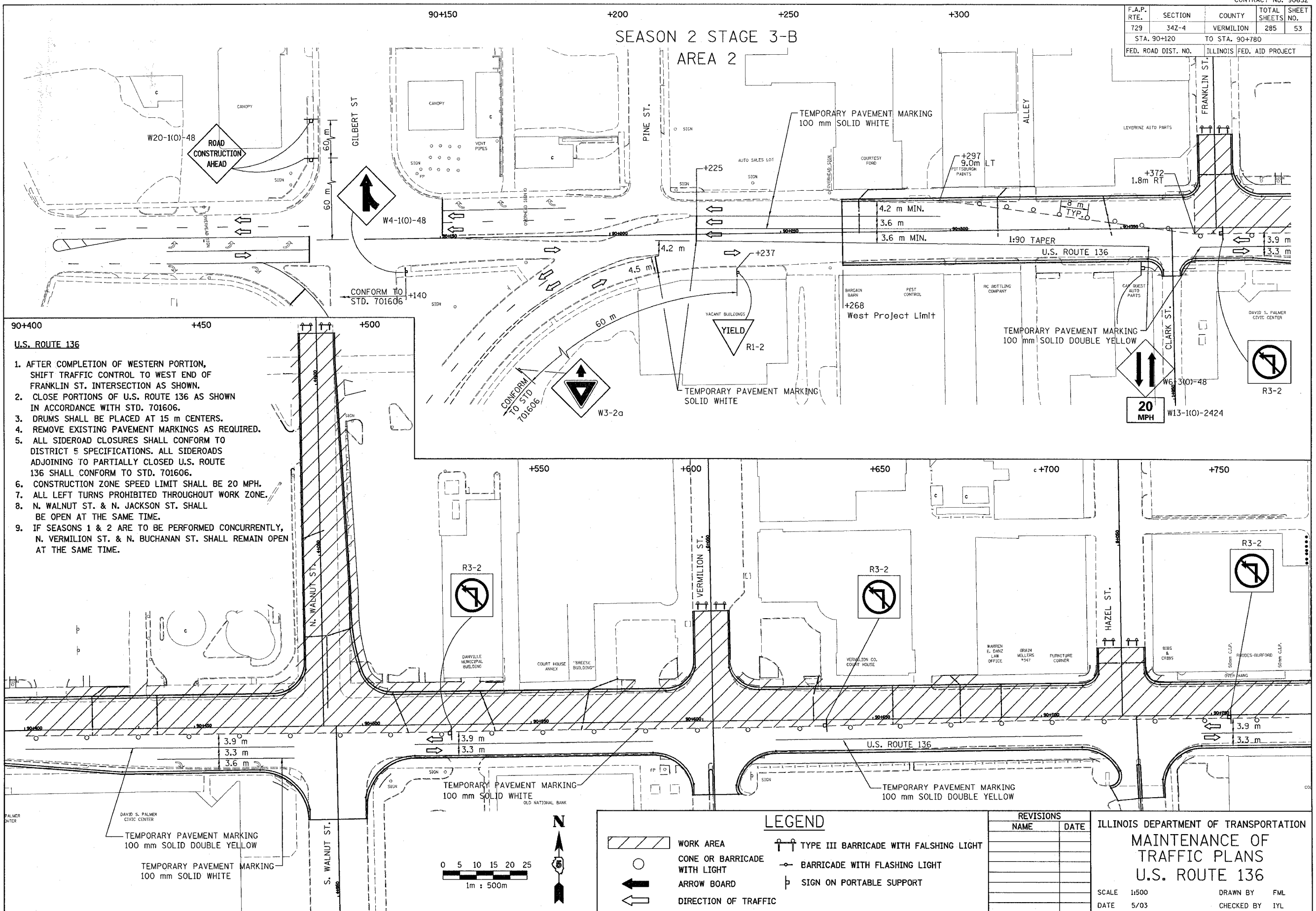

- U.S. ROUTE 136**
1. AFTER COMPLETION OF WESTERN PORTION, SHIFT TRAFFIC CONTROL TO WEST END OF FRANKLIN ST. INTERSECTION AS SHOWN.
 2. CLOSE PORTIONS OF U.S. ROUTE 136 AS SHOWN IN ACCORDANCE WITH STD. 701606.
 3. DRUMS SHALL BE PLACED AT 15 m CENTERS.
 4. REMOVE EXISTING PAVEMENT MARKINGS AS REQUIRED.
 5. ALL SIDEROAD CLOSURES SHALL CONFORM TO DISTRICT 5 SPECIFICATIONS. ALL SIDEROADS ADJOINING TO PARTIALLY CLOSED U.S. ROUTE 136 SHALL CONFORM TO STD. 701606.
 6. CONSTRUCTION ZONE SPEED LIMIT SHALL BE 20 MPH.
 7. ALL LEFT TURNS PROHIBITED THROUGHOUT WORK ZONE.
 8. N. WALNUT ST. & N. JACKSON ST. SHALL BE OPEN AT THE SAME TIME.
 9. IF SEASONS 1 & 2 ARE TO BE PERFORMED CONCURRENTLY, N. VERMILION ST. & N. BUCHANAN ST. SHALL REMAIN OPEN AT THE SAME TIME.

LEGEND

- WORK AREA
- CONE OR BARRICADE WITH LIGHT
- ARROW BOARD
- DIRECTION OF TRAFFIC
- BARRICADE WITH FLASHING LIGHT
- SIGN ON PORTABLE SUPPORT
- TYPE III BARRICADE WITH FLASHING LIGHT

REVISIONS

NAME	DATE

ILLINOIS DEPARTMENT OF TRANSPORTATION
MAINTENANCE OF TRAFFIC PLANS
U.S. ROUTE 136

SCALE 1:500
 DATE 5/03
 DRAWN BY FML
 CHECKED BY IYL