

NOTE: SEE RIGHT OF WAY PLAN SHEETS FOR RIGHT OF WAY AND EASEMENT INFORMATION

PROP. CURVE CURV2
 PI STA. = 113+94.19
 $\Delta = 3^\circ 23' 01''$ (LT)
 $D = 0^\circ 29' 54''$
 $R = 11,500.00'$
 $T = 339.67'$
 $L = 679.14'$
 $E = 5.02'$
 P.C. STA. = 110+54.52
 P.T. STA. = 117+33.66

STEEL PLATE BEAM GUARDRAIL, TYPE A	TERMINAL MARKER, DIRECT APPLIED	R.O.W. MARKER	STEEL TRAFFIC BARRIER TERMINAL, TYPE E
LOCATION	LOCATION	LOCATION	LOCATION
108+64.00 RT TO 119+90.47 RT	108+64.00 RT	117+00.00, 85' LT	119+90.47 RT TO 120+20.47 RT
110+29.00 LT TO 120+05.21 LT	110+29.00 LT	116+00.00, 95' LT	120+05.21 LT TO 120+35.21 LT
123+66.84 RT TO 126+00.00 RT	TOTAL THIS SHEET	120+39.96, 85' LT	123+36.84 RT TO 123+66.84 RT
TOTAL THIS SHEET		123+80.53, 60' LT	TOTAL THIS SHEET
2337	2	126+00.00, 100' RT	5
		TOTAL THIS SHEET	
		5	

STEEL TRAFFIC BARRIER TERMINAL, TYPE 1, SPECIAL
LOCATION
119+98.90, 53.84' LT
TOTAL THIS SHEET
1

STEEL TRAFFIC BARRIER TERMINAL, TYPE 1, SPECIAL, FLARED
LOCATION
108+14.00 RT TO 108+64.00 RT
109+78.00 LT TO 110+29.00 LT
TOTAL THIS SHEET
2

STEEL TRAFFIC BARRIER TERMINAL, TYPE 1, SPECIAL, FLARED
LOCATION
121+16.25, 25' LT
121+16.25, 25' RT
TOTAL THIS SHEET
2

STEEL TRAFFIC BARRIER TERMINAL, TYPE 1, SPECIAL, FLARED
LOCATION
122+16.25, 25' LT
122+16.25, 25' RT
TOTAL THIS SHEET
2

STEEL TRAFFIC BARRIER TERMINAL, TYPE 1, SPECIAL, FLARED
LOCATION
123+16.25, 25' LT
123+16.25, 25' RT
TOTAL THIS SHEET
2

STEEL TRAFFIC BARRIER TERMINAL, TYPE 1, SPECIAL, FLARED
LOCATION
124+16.25, 25' LT
124+16.25, 25' RT
TOTAL THIS SHEET
2

STEEL TRAFFIC BARRIER TERMINAL, TYPE 1, SPECIAL, FLARED
LOCATION
125+16.25, 25' LT
125+16.25, 25' RT
TOTAL THIS SHEET
2

CONTRACT - 91292

F.A.S. DIST.	SECTION	COUNTY	TOTAL SHEET NO.
6-42	99-00124-01-PV	COLES	157
STA. 111+00			TO STA. 126+00
FED. ROAD DIST. NO.		ILLINOIS	FED. AID PROJECT

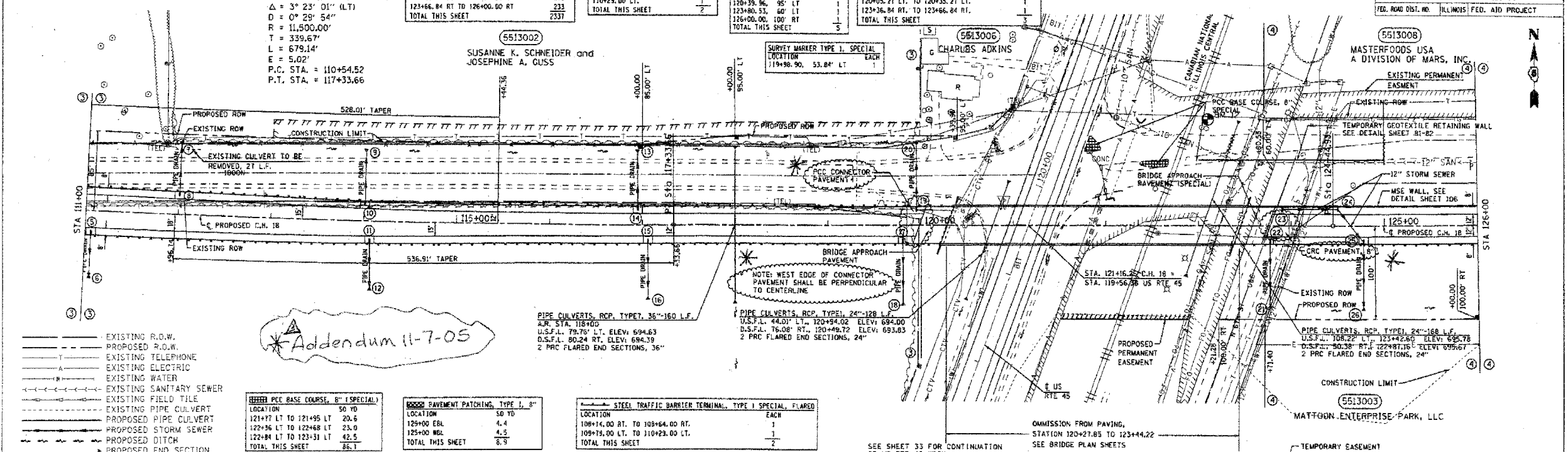

Addendum 11-7-05

- EXISTING R.O.W.
- - - PROPOSED R.O.W.
- - - EXISTING TELEPHONE
- - - EXISTING ELECTRIC
- - - EXISTING WATER
- - - EXISTING SANITARY SEWER
- - - EXISTING FIELD TILE
- - - EXISTING PIPE CULVERT
- - - PROPOSED PIPE CULVERT
- - - PROPOSED STORM SEWER
- - - PROPOSED DITCH
- - - PROPOSED END SECTION

STEEL TRAFFIC BARRIER TERMINAL, TYPE 1, SPECIAL
LOCATION
121+77 LT TO 121+95 LT
122+36 LT TO 122+48 LT
122+84 LT TO 123+31 LT
TOTAL THIS SHEET
56.7

STEEL TRAFFIC BARRIER TERMINAL, TYPE 1, SPECIAL, FLARED
LOCATION
125+00 EBL
125+00 WBL
TOTAL THIS SHEET
8.9

STEEL TRAFFIC BARRIER TERMINAL, TYPE 1, SPECIAL, FLARED
LOCATION
108+14.00 RT TO 108+64.00 RT
109+78.00 LT TO 110+29.00 LT
TOTAL THIS SHEET
2

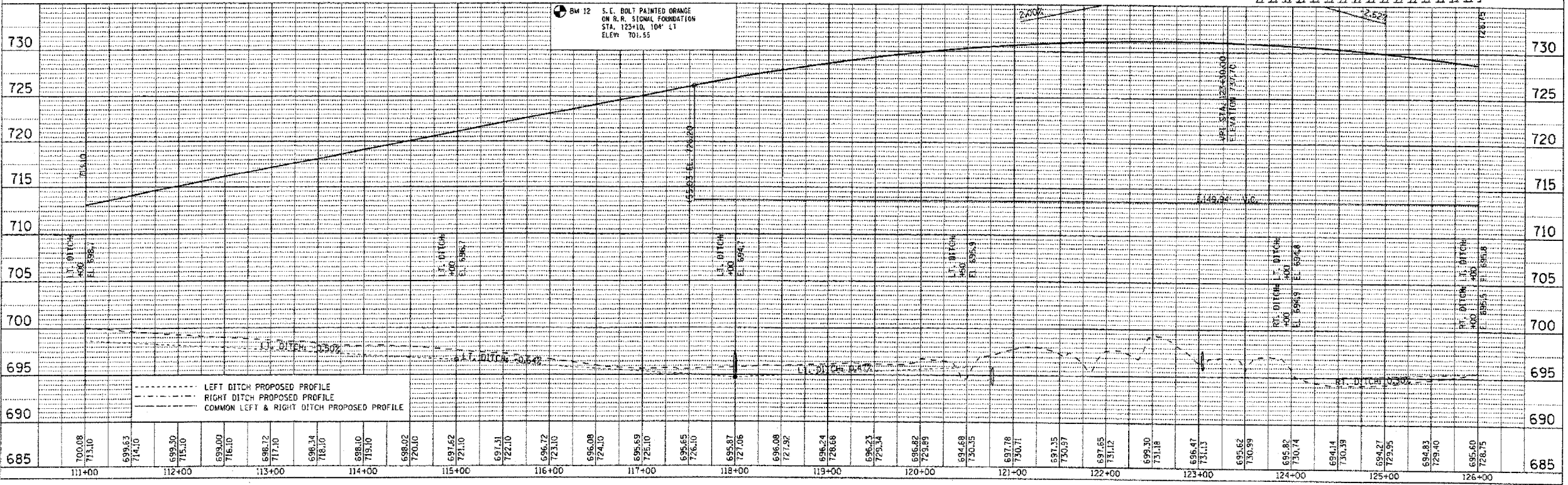

THE UPCHURCH GROUP, INC., 123 NORTH 15TH ST., MATTOON, ILLINOIS 61838, (217) 235-3177 PROFESSIONAL DESIGN FIRM CORPORATION LICENSE NO. 84-003401 STA. 111+00 TO STA. 126+00