

F.A.S. RTE.	SECTION	COUNTY	TOTAL SHEETS	SHEET NO.
642	99-00124-01-PV	COLES	157	38
STA. 126+00 TO STA. 156+00				
FED. ROAD DIST. NO.		ILLINOIS	FED. AID PROJECT	

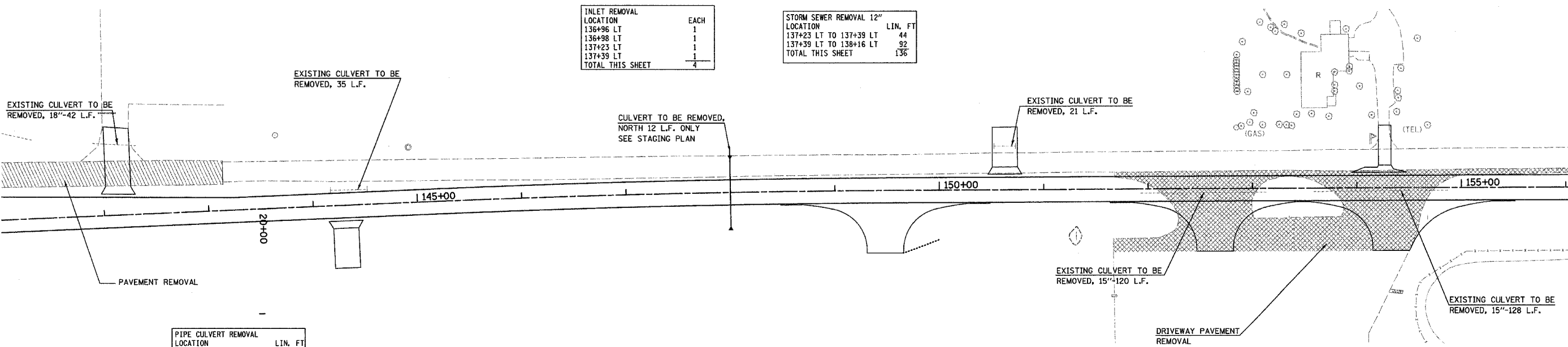
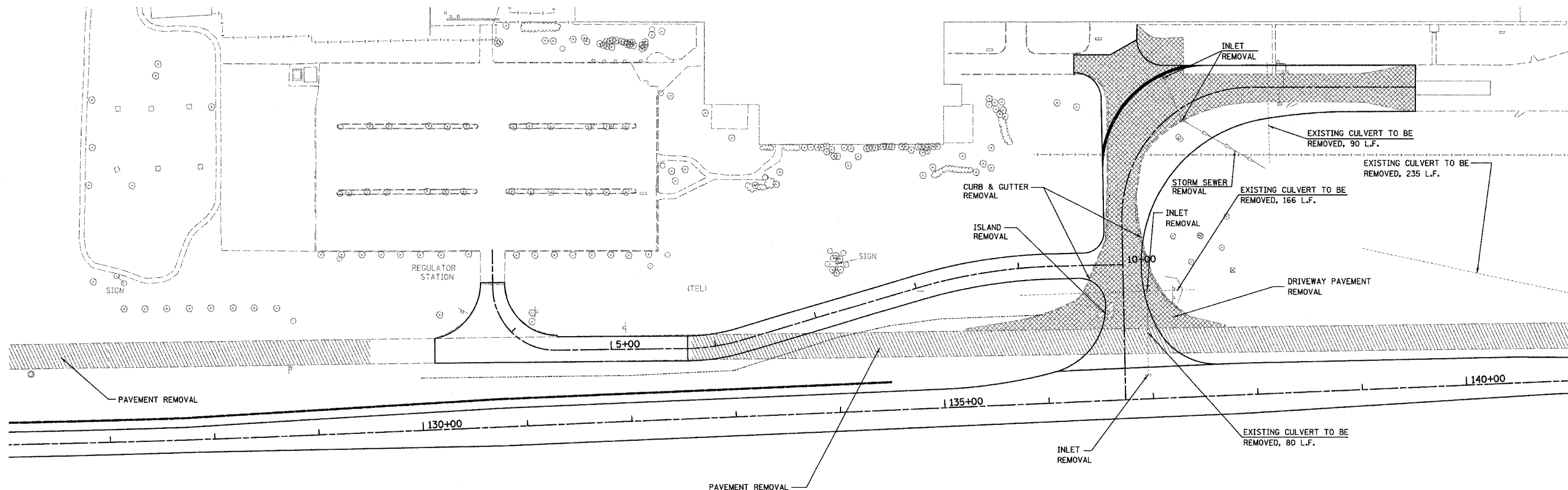

INLET REMOVAL LOCATION	EACH
136+96 LT	1
136+98 LT	1
137+23 LT	1
137+39 LT	1
TOTAL THIS SHEET	4

STORM SEWER REMOVAL 12" LOCATION	LIN. FT
137+23 LT TO 137+39 LT	44
137+39 LT TO 138+16 LT	92
TOTAL THIS SHEET	136

PIPE CULVERT REMOVAL LOCATION	LIN. FT
136+60, LT	166
136+97, LT	80
138+21, LT	90
140+20, LT	235
142+11, LT	42
144+35, LT	35
148+00, LT	12
150+63, LT	21
152+53, RT	120
154+23, RT	128
TOTAL THIS SHEET	929

CONCRETE CURB AND GUTTER REMOVAL LOCATION	LIN. FT.
135+24 LT TO 136+37 LT	353
137+72 LT TO 139+63 LT	479
137+42 LT TO 139+65 LT	222
TOTAL THIS SHEET	1054

DRIVEWAY PAVEMENT REMOVAL LOCATION	SQ. YD.
136+67.00 LT	2719.2
152+63.93 RT	993.3
154+32.48 RT	994.1
TOTAL THIS SHEET	4706.6

ISLAND REMOVAL LOCATION	SQ. FT.
136+60 LT	156.7

PAVEMENT REMOVAL LOCATION	SQ. YD.
126+00 TO 129+50	932.1
132+60 TO 143+14	2805.8
TOTAL THIS SHEET	3737.9

REVISIONS	
NAME	DATE

ILLINOIS DEPARTMENT OF TRANSPORTATION

REMOVAL PLAN

SCALE: VERT. 1" = 50'
HORIZ. 1" = 50'
DATE: #DATE#

DRAWN BY: RLH
CHECKED BY: MED

TUG PROJ. #13197022-5
#FILE#BBREV#
#DATE#