

F.A.P. RTE.	SECTION	COUNTY	TOTAL SHEETS	SHEET NO.
750	(112,113) Y, WRS	FAYETTE	178	18
STA. 204+00	TO STA. 236+00			
FED. ROAD DIST. NO. 7 ILLINOIS FED. AID PROJECT				
CONTRACT NO. 94927				

BM 156 EL. = 584.764 R.R. SPIKE IN P.P. IN NE QUAD. OF INTERSECTION
204+57 41.2' LT. OF IL 185 & TR 1625E (BROWNSTOWN RD.)

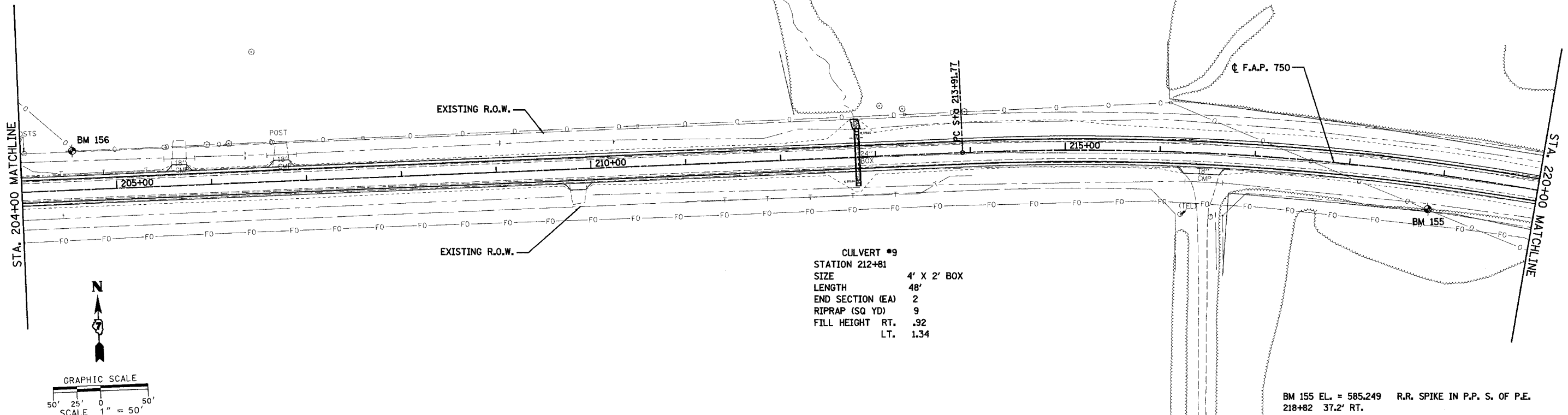

CULVERT #9
 STATION 212+81
 SIZE 4' X 2' BOX
 LENGTH 48'
 END SECTION (EA) 2
 RIPRAP (SQ YD) 9
 FILL HEIGHT RT. .92
 LT. 1.34

BM 155 EL. = 585.249 R.R. SPIKE IN P.P. S. OF P.E.
218+82 37.2' RT.

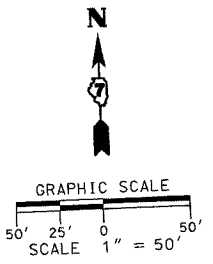

DATE	
BY	
PLAN	
REVISIONS	
NO. 1	
NO. 2	
NO. 3	
NO. 4	
NO. 5	
NO. 6	
NO. 7	
NO. 8	
NO. 9	
NO. 10	
NO. 11	
NO. 12	
NO. 13	
NO. 14	
NO. 15	
NO. 16	
NO. 17	
NO. 18	
NO. 19	
NO. 20	
NO. 21	
NO. 22	
NO. 23	
NO. 24	
NO. 25	
NO. 26	
NO. 27	
NO. 28	
NO. 29	
NO. 30	

PROP. CURVE C6
 PI STA. = 230+71.26
 $\Delta = 60^\circ 44' 40''$ (RT)
 $D = 1^\circ 59' 57''$
 $R = 2,865.80'$
 $T = 1,679.49'$
 $L = 3,038.30'$
 $E = 455.87'$
 $e = 5.4\%$
 P.C. STA. = 213+91.77
 P.T. STA. = 244+30.07

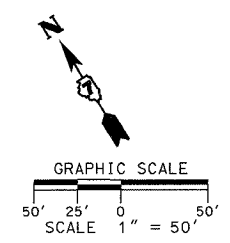
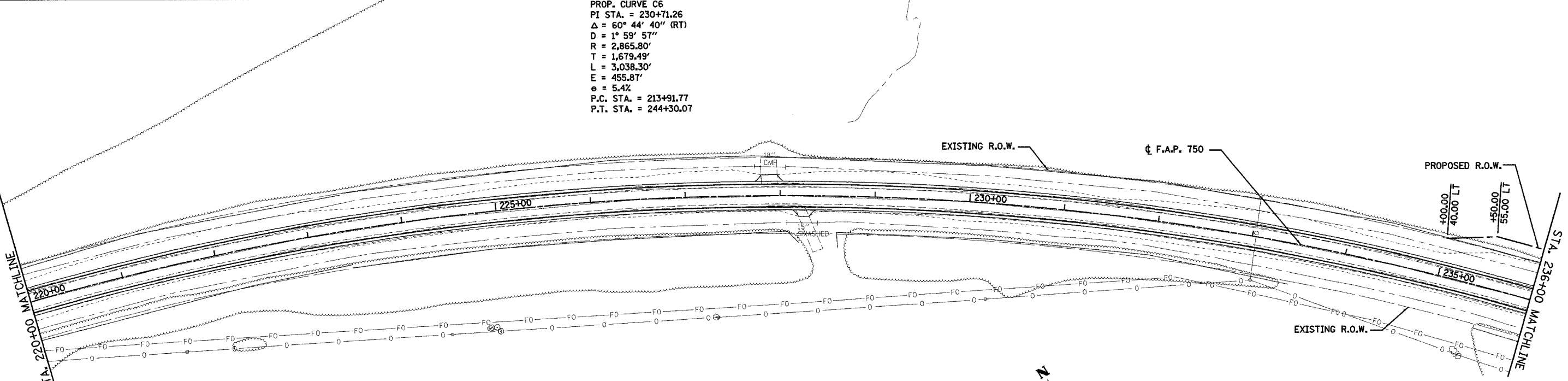

REVISIONS	
NAME	DATE

ILLINOIS DEPARTMENT OF TRANSPORTATION
PLAN SHEETS
SHEET 4 OF 10
 F.A.P. 750 (IL. RTE. 185)
 SECTION 112,113 - FAYETTE CO.
 SCALE: 1"=50'
 DATE JULY 22, 2005
 DRAWN BY CRO
 CHECKED BY RCY

DATE	
BY	
PLAN	
REVISIONS	
NO. 1	
NO. 2	
NO. 3	
NO. 4	
NO. 5	
NO. 6	
NO. 7	
NO. 8	
NO. 9	
NO. 10	
NO. 11	
NO. 12	
NO. 13	
NO. 14	
NO. 15	
NO. 16	
NO. 17	
NO. 18	
NO. 19	
NO. 20	
NO. 21	
NO. 22	
NO. 23	
NO. 24	
NO. 25	
NO. 26	
NO. 27	
NO. 28	
NO. 29	
NO. 30	

J:\2003\030045\0002\civil\phase 2\kdg\dm\p2-dpl\150-4.dgn
 3:37:03 PM 8/1/2005