

NOTES:

- GENERAL OPERATIONAL SAFETY SHALL BE GOVERNED BY FAA AC 150/5370-2E. CONTRACTOR FACILITIES/EQUIPMENT SHALL NOT PENETRATE FAR PART 77 SURFACES (SEE SECTION A-A).**
- CONSTRUCTION ACTIVITIES IN CLASSIFIED AREA.** CLASSIFIED AREAS ARE ALL AREAS WITHIN 200 FEET AND 107 FEET OF RUNWAY AND TAXIWAY CENTERLINES, RESPECTIVELY. NO CONSTRUCTION ACTIVITIES SHALL OCCUR WITHIN CLASSIFIED AREAS OR AREAS BOUNDED BY CLASSIFIED AREAS OF OPEN RUNWAYS/TAXIWAYS, EXCEPT AS PERMITTED BY THE AIRPORT OPERATIONS MANAGER AND THE RESIDENT ENGINEER. TEMPORARY RUNWAY/TAXIWAY DEACTIVATION, PREDICATED ON WIND CONDITIONS, WILL BE ACCOMPLISHED BY ATCT CONTROL PROCEDURES; REACTIVATION WILL OCCUR ON SHORT NOTICE WHEREUPON THE CONTRACTOR WILL VACATE SUCH CLASSIFIED AREAS AND AREAS BOUNDED THEREBY. VACATING SHALL INCLUDE REMOVAL OF ALL CONSTRUCTION EQUIPMENT, MATERIALS, WORKERS AND THE COVERING OF ALL OPEN MANHOLES.
- CONSTRUCTION IN UNCLASSIFIED AREAS.** UNCLASSIFIED AREAS ARE ALL AREAS NOT LOCATED IN CLASSIFIED AREAS. UNRESTRICTED CONSTRUCTION WILL BE PERMITTED IN UNCLASSIFIED AREAS EXCEPT AS REQUIRED HEREIN, IN THE SPECIFICATIONS, AND AS ESTABLISHED IN THE PRE-CONSTRUCTION CONFERENCE.
- CONSTRUCTION IN NAVIGATIONAL AID CRITICAL AREAS.** CONSTRUCTION WILL TAKE PLACE ADJACENT TO GLIDE SLOPE CRITICAL AREAS AS SHOWN ON THIS DRAWING. CONSTRUCTION ACTIVITY WITHIN THESE AREAS WILL BE RESTRICTED WHEN THE RESPECTIVE AREAS ARE IN USE. ACCESS TO THESE AREAS WILL BE SUBJECT TO THE SAME OPERATIONAL CONTROL PROCEDURES AS DESCRIBED IN ABOVE FOR CLASSIFIED AREAS.

- LIMITATION ON CONSTRUCTION.**
 - ALL VEHICLES ARE TO BE PARKED AND SERVICED IN AN AREA DESIGNATED BY THE AIRPORT OPERATOR.
 - OPEN TRENCHES, EXCAVATIONS AND STOCKPILED MATERIAL AT THE CONSTRUCTION SITE SHOULD BE PROMINENTLY MARKED WITH RED OR ORANGE FLAGS AND EQUIPPED WITH FLASHING RED LIGHT UNITS (ACCEPTABLE TO THE AIRPORT OPERATOR AND THE FAA) DURING HOURS OF RESTRICTED VISIBILITY AND/OR DARKNESS.
 - STOCKPILED MATERIAL SHOULD BE CONSTRAINED IN A MANNER TO PREVENT MOVEMENT AS A RESULT OF AIRCRAFT BLAST OR WIND. MATERIAL SHOULD NOT BE STORED NEAR AIRCRAFT TURNING AREAS OR MOVEMENT AREAS.
 - THE TALLEST PIECE OF CONSTRUCTION EQUIPMENT USED WITHIN THE CONSTRUCTION LIMITS (OUTSIDE CLASSIFIED AREAS) WILL BE NO MORE THAN 50' TALL WITHOUT PRIOR APPROVAL OF RESIDENT ENGINEER AND AIRPORT DIRECTOR.
- MARKING AND LIGHTING OF CLOSED OR HAZARDOUS AREAS ON AIRPORTS.** ONCE THE CONTRACTOR BEGINS CONSTRUCTION WITHIN THE AIRFIELD OPERATIONS AREA, THE CONSTRUCTION CONTRACTOR SHALL HAVE A MAN ON CALL 24 HOURS PER DAY FOR EMERGENCY MAINTENANCE OF AIRPORT HAZARD LIGHTING AND BARRICADES. THIS WILL BE DISCUSSED AT THE PRE-CONSTRUCTION CONFERENCE AS AN AGENDA ITEM.
- EXCAVATION AND TRENCHES.** EXCAVATIONS AND OPEN TRENCHES MAY BE PERMITTED WITHIN THE CONSTRUCTION LIMITS OF THIS CONTRACT, PROVIDED THAT THEY ARE ADEQUATELY SIGNED, LIGHTED AND MARKED, EXCEPT THOSE AREAS WHICH SPECIFICALLY REQUIRE WORK DURING SHORT-TERM TAXIWAY SHUTDOWN.

- CONSTRUCTION VEHICLE TRAFFIC.** CONSTRUCTION VEHICLES SHALL NOT CROSS ANY ACTIVE OR INACTIVE RUNWAY WITHOUT ATCT CLEARANCE. ACCESS TO CONSTRUCTION SITES SHALL FOLLOW ROUTES UTILIZING TAXIWAYS, ACCESS AND PERIMETER ROADS, AS SHOWN ON THIS DRAWING AND/OR AS ESTABLISHED IN THE PRE-CONSTRUCTION CONFERENCE. ALL CONSTRUCTION EQUIPMENT AND VEHICLES SHALL BE PARKED OUTSIDE OF ALL CLASSIFIED AREAS, CRITICAL AREAS, RUNWAY APPROACH SURFACES AND WHERE DIRECTED DURING THE PRE-CONSTRUCTION CONFERENCE. ALL CONSTRUCTION EQUIPMENT SHALL BE FLAGGED AND LIGHTED IN ACCORDANCE WITH AC 150/5210-5. CONSTRUCTION ACCESS TO ALL SECURED AREAS WILL BE THROUGH LOCKED GATES OR THOSE MANNED BY SECURITY GUARDS (NORMAL WORKING HOURS AND AS ESTABLISHED DURING THE PRE-CONSTRUCTION CONFERENCE).
- AIRPORT AND AIRCRAFT SURFACE MAINTENANCE.** SOIL, DEBRIS, AND LOOSE MATERIAL DROPPED OR TRUCKED ONTO AIRPORT ROADS, TAXIWAYS, AND SOD SURFACE OR WHICH CAN BE BLOWN ONTO SUCH SURFACES SHALL BE IMMEDIATELY SWEEP OR PICKED UP AND REMOVED OR PLACED INTO CLOSED CONTAINERS AS REQUIRED IN THE SPECIFICATIONS. ANY MATERIALS TRACKED ONTO AIRPORT ROADS SHALL BE SWEEPED OFF AT THE END OF THE DAY.
- CONTRACTOR'S SECURITY CLEARANCE.** THE CONTRACTOR AND HIS EMPLOYEES SHALL SUBMIT TO ALL SECURITY CLEARANCE REQUIREMENTS LISTED IN THE GENERAL PROVISIONS OF THE CONSTRUCTION CONTRACT. HE IS ALSO REQUIRED TO ADHERE TO ALL AIRPORT SECURITY REQUIREMENTS (I.E. SECURITY BADGES). THIS WILL INCLUDE AN EMPLOYMENT HISTORY SUMMARY, FINGERPRINTING, ETC OF ALL EMPLOYEES WITH ACCESS TO THE JOB SITE.
- CONSTRUCTION SAFETY PLAN APPLICABILITY AND RESPONSIBILITIES.** THIS PLAN, WHEN SIGNED BY ALL PARTICIPANTS AT THE PRE-CONSTRUCTION CONFERENCE, BECOMES PART OF THE CONTRACT.

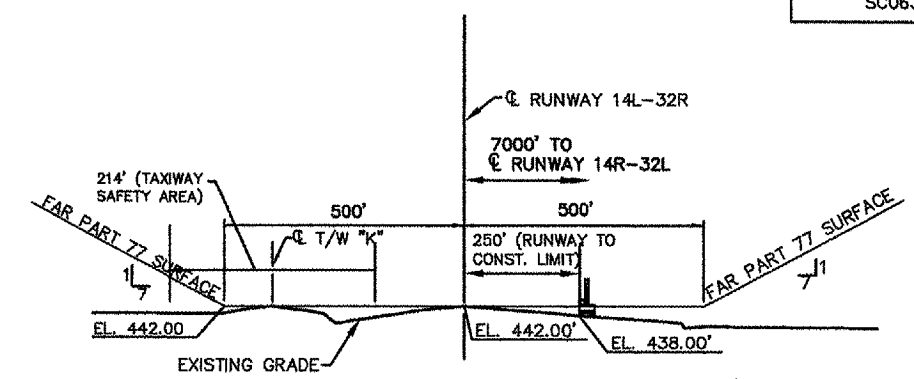

FAR PART 77 SURFACES SECTION A-A
N.T.S.

SURVEY MONUMENTS

DESIGNATION	DESCRIPTION	NORTH	EAST	STATION*	OFFSET	ELEV.
A-2A	ALUM. TABLET	685704.94	2393962.24	131+70.00	330.00 RT	434.42
HUR-1	ALUM. TABLET	687696.68	2396345.05	133+74.71	2768.10 LT	445.20
KDG-BLA3	ALUM. TABLET	684648.28	2396395.23	156+14.84	700.00 LT	440.04
KDG-BLA4	ALUM. TABLET	683356.50	2397627.81	174+00.33	700.00 LT	434.56
KDG-BLA7	BRASS TABLET	687552.99	2393623.66	116+00.00	700.00 LT	445.59
KDG-BLA8	BRASS TABLET	686634.16	2394500.37	128+70.00	700.00 LT	443.54

* @ RUNWAY 14L/32R STATIONS

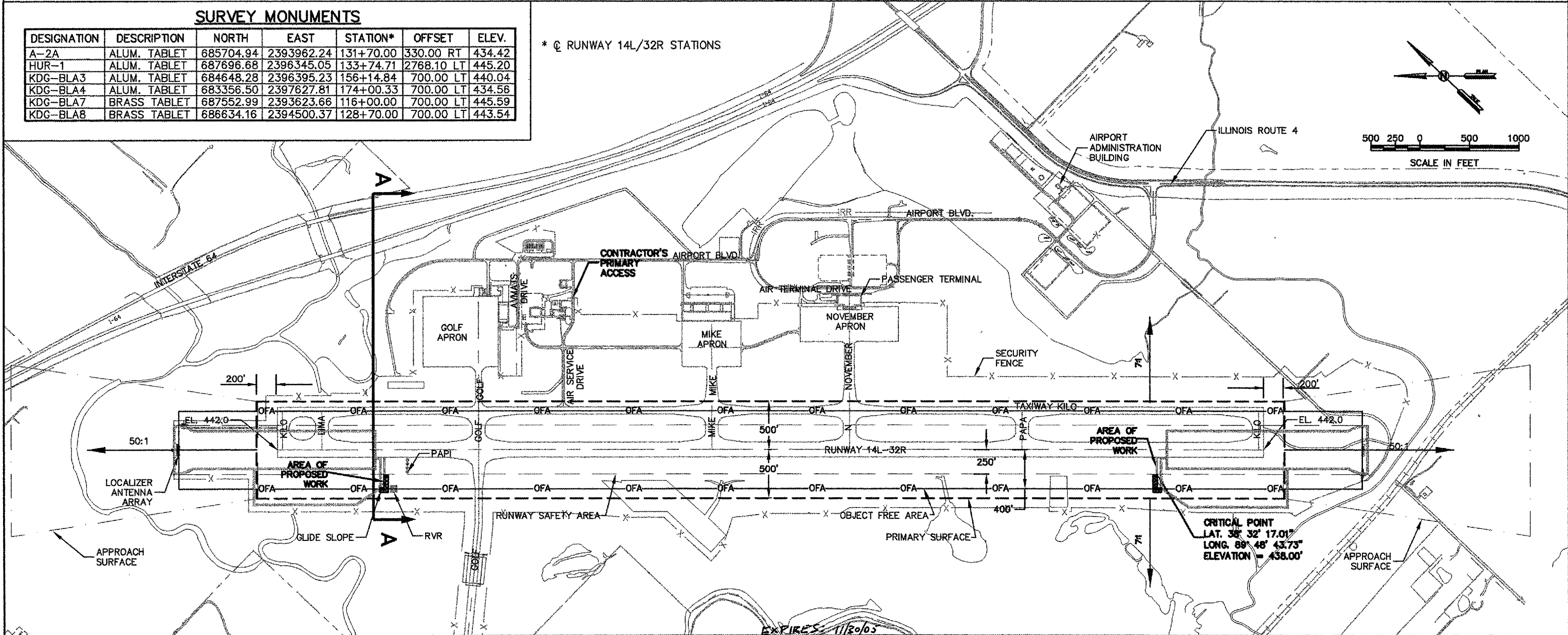

DESIGNED BY: JRK
DRAWN BY: JRK
CHECKED BY: DJT
DATE: 9/23/05

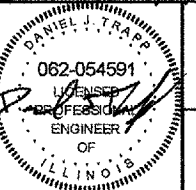

LIGHT SUPPLEMENTAL WIND CONES
1075 Eastgate Drive
O'Fallon, Illinois 62269
PH 618-624-2628
FAX 618-624-2730



CONSTRUCTION SAFETY PLAN

DWG. FILE NAME
84723-C-03
SHEET NO.
3

L:\work\8727\card11006\8727_C-03.dwg, 9/29/2005 12:16:54 PM