

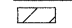

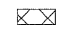







LEGEND:

-  WORK AREA
-  TEMPORARY PAVEMENT
-  TEMPORARY CONCRETE BARRIER
-  ARROW BOARD
-  SIGN
-  DRUM WITH STEADY BURN MONODIRECTIONAL LIGHT
-  DIRECTION INDICATOR BARRICADE WITH STEADY BURN MONODIRECTIONAL LIGHT
-  TYPE II BARRICADE WITH STEADY BURN MONODIRECTIONAL LIGHT
-  TYPE III BARRICADE
-  IMPACT ATTENUATOR, TEMPORARY (NON-REDIRECTIVE, NARROW) TEST LEVEL 3
-  DIRECTION OF TRAFFIC
-  VERTICAL PANEL

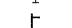
PLAN	SURVEYED	DATE
	ALIGNED	
	CHECKED	
	RT. OF WAY CHECKED	
	NO. _____	
	CADD FILE NAME	

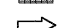

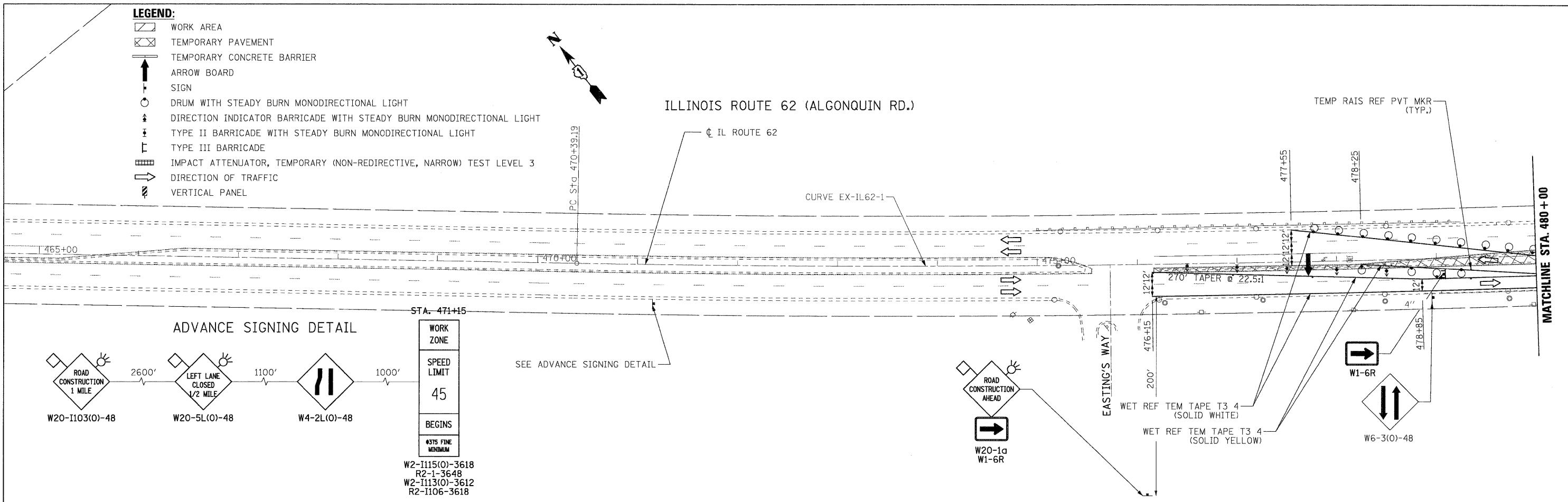
PLAN	SURVEYED	DATE
	ALIGNED	
	CHECKED	
	RT. OF WAY CHECKED	
	NO. _____	
	CADD FILE NAME	

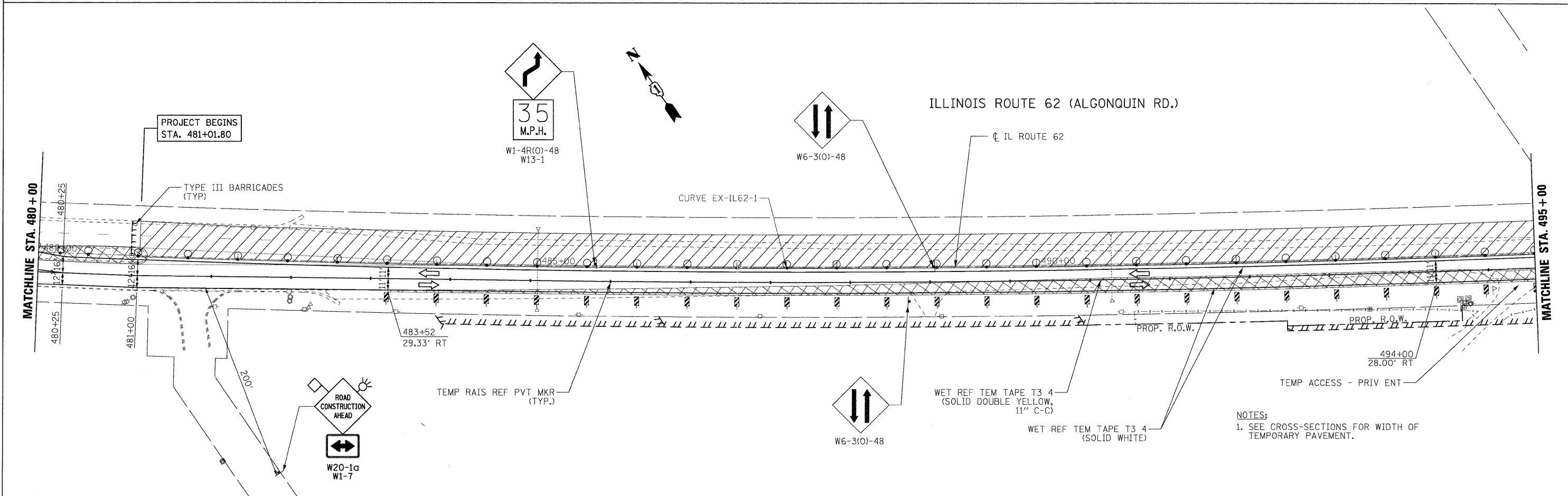

NOTES:
1. SEE CROSS-SECTIONS FOR WIDTH OF TEMPORARY PAVEMENT.

FILE NAME =
...\\D160135-sht-stagingL_01.dgn



DESIGNED	ADW	REVISED	-
DRAWN	ADW	REVISED	-
CHECKED	RJD	REVISED	-
DATE	JUNE 30, 2011	REVISED	-

**STATE OF ILLINOIS
DEPARTMENT OF TRANSPORTATION**

**IL RTE 62 (ALGONQUIN RD.) FROM EASTING'S WAY TO PENNY RD.
SUGGESTED STAGE OF CONSTRUCTION & TRAFFIC CONTROL - STAGE 1**

F.A.P. RTE.	SECTION	COUNTY	TOTAL SHEETS	SHEET NO.
339	116 Y-1-R-1	COOK	122	19
CONTRACT NO. 60135				
ILLINOIS FED. AID PROJECT				

SCALE: 1"=50' SHEET NO. 1 OF 6 SHEETS STA. 465+00 TO STA. 495+00