

PLAN	SURVEYED	DATE
	PLOTTED	BY
	CHECKED	
	RT. OF WAY CHECKED	
	CADD FILE NAME	
	NO.	

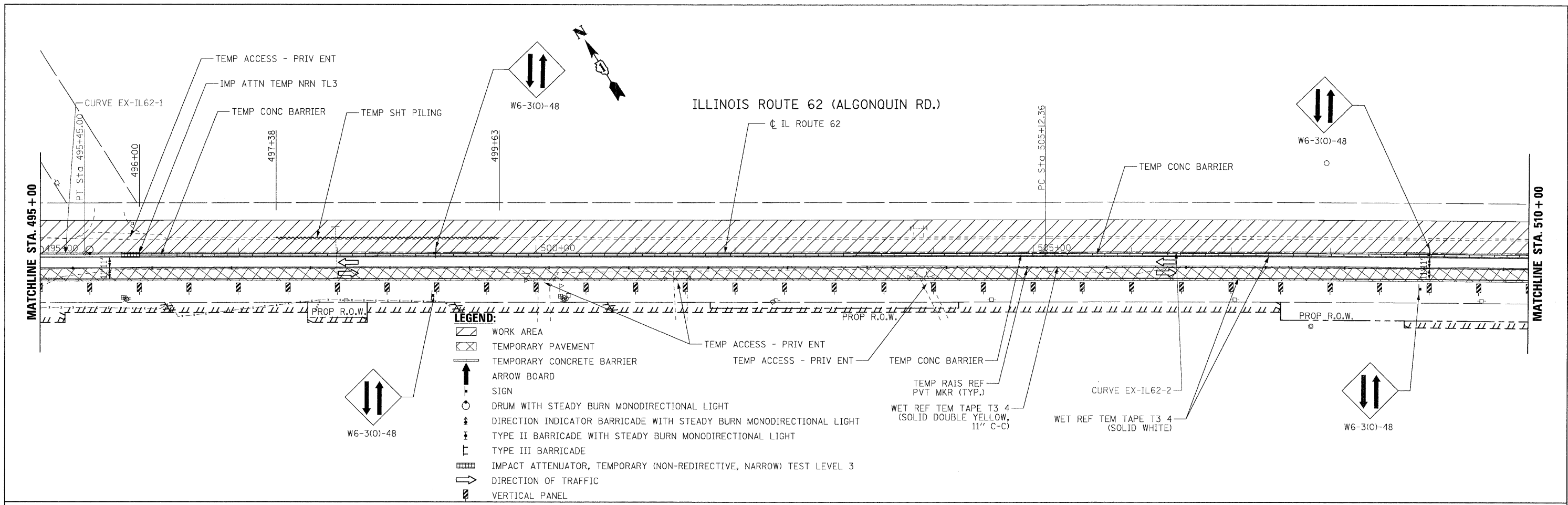

PLAN	SURVEYED	DATE
	PLOTTED	BY
	CHECKED	
	RT. OF WAY CHECKED	
	CADD FILE NAME	
	NO.	

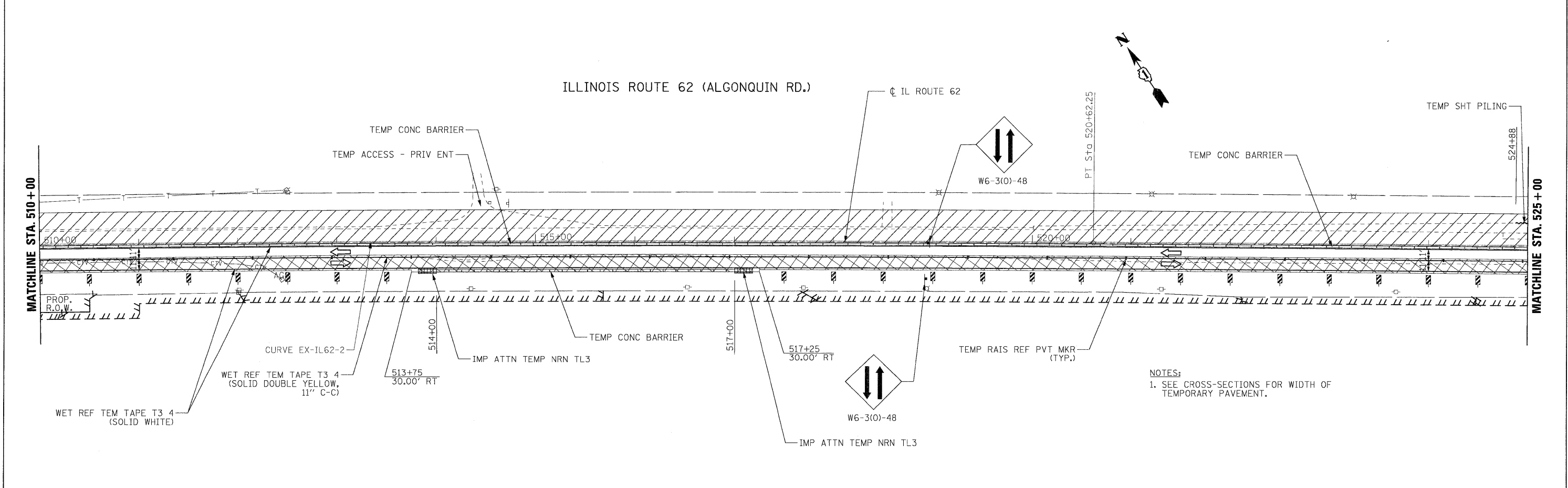

FILE NAME =
 ...\\D160135-sht-staging1.02.dgn

Primera	DESIGNED	ADW	REVISED	-
	DRAWN	ADW	REVISED	-
	CHECKED	RJD	REVISED	-
	DATE	JUNE 30, 2011	REVISED	-

**STATE OF ILLINOIS
 DEPARTMENT OF TRANSPORTATION**

**IL RTE 62 (ALGONQUIN RD.) FROM EASTING'S WAY TO PENNY RD.
 SUGGESTED STAGE OF CONSTRUCTION & TRAFFIC CONTROL - STAGE 1**

SCALE: 1"=50' SHEET NO. 2 OF 6 SHEETS STA. 495+00 TO STA. 525+00

F.A.P. RTE.	SECTION	COUNTY	TOTAL SHEETS	SHEET NO.
339	116 Y-1-R-1	COOK	122	20
CONTRACT NO. 60135				
ILLINOIS FED. AID PROJECT				